



**ACI Spring 2001  
Convention  
Philadelphia, PA  
March 25 - 30, 2001**

***"Constructibility: From Concept to Completion"***

---

## TABLE OF CONTENTS

---

*ACI Spring 2001 Convention  
March 25 - 30, 2001*

*Philadelphia, Pennsylvania*

ACI Board Committees & Chairmen .....	Inside Back Cover
ACI Delaware Valley Chapter Officers .....	12
ACI Delaware Valley Chapter Convention Committee .....	13
ACI President's Welcome .....	7
ACI Sustaining Members .....	4
Awards Breakfast .....	127
Board of Direction .....	3
Certification Programs .....	34
Contractors' Day Session .....	95 & 102
Contractors' Day Luncheon .....	101
Contractors' Day Reception & Forum .....	110
Convention Committee .....	Inside Back Cover
Educational Seminar .....	129
Spring 2001 Educational Seminar Information .....	130
Exhibitor Floor Plan .....	Between 18 & 19
Exhibitor Programs & Hours .....	19
Future ACI Conventions .....	Outside Back Cover
General Information .....	15
General Session .....	128
Guest Tours .....	31
Governor's Welcome .....	8
Hotel Maps .....	Between 18 & 19
Hotel Meeting Room Index .....	17
International Conference .....	9
International Luncheon & Program .....	120
Numeric Committee Listing .....	53
Program at a Glance .....	35
Registration Information & Hours .....	15
Special Events .....	21
Sponsors .....	10
Students' Day .....	23
Student Egg Protection Device Competition .....	60
Student Luncheon .....	81
Technical & Educational Session Highlights .....	59

---

AMERICAN CONCRETE INSTITUTE  
BOARD OF DIRECTION

---

**President**

James O. Jirsa

**Vice Presidents**

Daniel L. Baker  
Terence C. Holland

**Directors**

George B. Barney  
Florian G. Barth  
Charles W. Dolan  
Peter H. Emmons  
Robert A. Epifano  
Per Fidjestøl  
Kenneth C. Hover  
Roy H. Keck  
Randall W. Poston  
Luke M. Snell  
Thomas D. Verti

**Past Presidents**

Richard N. White  
James R. Libby  
Jo Coke

**Executive Vice President**

James G. Toscas

---

AMERICAN CONCRETE INSTITUTE  
SUSTAINING MEMBERS

---



Alslur Concrete  
Equipment, Inc.



Baker Concrete  
Construction, Inc.



Biaxis Corporation



Blue Circle  
CEMENT

Blue Circle Cement



Boral Material  
Technologies Inc.



Construction Technology  
Laboratories



Dayton/Richmond  
Concrete Accessories



Expanded Shale,  
Clay & Slate Institute



Future Tech Consultants



W.R. Grace & Co.



Ground Heaters Inc.



Holnam, Inc.

---

AMERICAN CONCRETE INSTITUTE  
SUSTAINING MEMBERS

---



RESOURCES, INC.  
ISG Resources, Inc.



Kleinfelder, Inc.



Lafarge Canada, Inc.



Lafarge Corporation



Lehigh Portland  
Cement



LONESTAR

Lone Star Industries, Inc.



Master Builders, Inc.



Meadow Burke Products



Municipal Testing  
Laboratories, Inc.

Phoenix Corporation

Phoenix Corporation

---

AMERICAN CONCRETE INSTITUTE  
SUSTAINING MEMBERS

---



Portland Cement  
Association



Precast/Prestressed  
Concrete Institute



RMC Pacific Materials



Seretta Construction, Inc.



SI Concrete Systems



Sika Corporation



Structural Preservation  
Systems, Inc.



Tecvac, Inc.



Testwell Laboratories, Inc.



The Erlin Company



Tru Wall Concrete, Inc.

---

## ACI'S PRESIDENT'S WELCOME

---

ACI MEMBERS, GUESTS, AND SPOUSES



Welcome to Philadelphia!

ACI has the privilege of holding its 2001 Spring Convention in the wonderful city of Philadelphia. So much of our country's history originated in this city and the surrounding area. While you are at the convention renewing acquaintances with old friends and making new ones, you must take advantage of the tours and programs that the local Delaware Valley Chapter has arranged for convention attendees and their guests.

Don't miss the Concrete Mixer – *Building a Nation*. The Philadelphia Convention theme is “Constructibility: From Concept to Completion.” Constructibility comes up in all aspects of concrete technology and there will be technical sessions addressing a variety of issues related to the theme. The Contractors' Day program has been expanded for this convention to include an exposition and product demonstrations along with Contractors' Day sessions.

We know that to attract more people to careers in engineering and science, we need to start early. The Chapter Forum will center around using a science kit for middle school students to acquaint them with concrete and motivate them to learn more about a material used every day but that they know little about.

Marion and I look forward to meeting you at the Spring Convention. We hope you have a great time in Philadelphia.

A handwritten signature in cursive script that reads "Jim Jisa".



COMMONWEALTH OF PENNSYLVANIA  
OFFICE OF THE GOVERNOR  
HARRISBURG

THE GOVERNOR

**GREETINGS:**

It gives me great pleasure to welcome The American Concrete Institute to Philadelphia and the Commonwealth of Pennsylvania.

Pennsylvania is a proud Commonwealth that boasts a past rich in accomplishment and a future full of promise. More than three centuries ago, when William Penn founded Pennsylvania, he created a society built on the ideas of community, individual freedom, and representative self-government. The site of the signing of the Declaration of Independence and the birth place of the United States Constitution, our commonwealth embodies the principles that founded, guided and progressed this nation for more than two centuries. As a Commonwealth, Pennsylvania cherishes the historical, social and cultural arts of our people and communities as emblems of enduring significance and influential character to the entire nation.

As you survey the vast resources, the natural beauty and the friendly people throughout this region, it comes as no surprise that residents and visitors find that there are many truly memorable ways to see and experience Pennsylvania. Visiting Philadelphia and Vicinity will allow you to discover the qualities that make this region such an enriching place to visit – the goodness of its people, the richness of its historical significance, and its geographic diversity. With this area's beauty and vibrancy, I am confident that you will discover a "memory to last a lifetime."

On behalf of all Pennsylvanians, I would like to welcome you to Philadelphia and to the Commonwealth of Pennsylvania. Best wishes for a successful convention and an enjoyable visit.



TOM RIDGE  
Governor



# Call for Papers

ACI 5<sup>th</sup> International Conference  
Cancun, Mexico, December 10-13, 2002

**Theme:** *Innovation in Design with  
Emphasis on Seismic, Wind and  
Environmental Loading and Quality  
Control and Innovation in  
Materials/Hot Weather Concreting*

## **Suggested Topics:**

### **Innovations in Design**

- New Design Methods
- Advances in Flexural Mechanics
- Role of Fibers in HPC to Control Fire Damage

### **Seismic, Wind and Environmental Loading**

- Innovative Designs for Controlling Damage Due to Seismic Loading
- Design Codes: How Codes from Various Countries Differ
- Recent Case Histories of Damage Due to Earthquakes
- Seismic Design for Very Tall Buildings

### **Quality Control and Innovations in Materials/Hot Weather Concreting**

- Quality Control and Quality Assurance in Concrete Construction
- Accelerated Tests for Quality Control
- Control Charts
- New Materials for Construction Including New Fibers, Recycled Concrete and Recycled Tires, Glass, etc.
- Control of High-Performance Concrete
- Hot Weather Concrete: What is New
- Role of Superplasticizers in Hot Weather Concreting
- Performance of High-Performance Concrete Incorporating Fly Ash/Slag/Silica Fume/Pozzolans/Metakaolin for Hot Weather
- Curing Compounds: Can They Be Used for Concrete Incorporating High Volumes of Supplementary Cementing Materials?
- Case Histories
- Specifications and Hot Weather Concreting

**Submission of 200 word abstract  
due by May 15, 2001. Forward abstracts to:**

**Phyllis Erebor, Speaker Manuscript Liaison  
ACI International  
P.O. Box 9094  
Farmington Hills, MI 48333-9094  
Phone 248/848-3784; Fax 248/848-3701  
E-mail PErebor@aci-int.org**

C  
A  
N  
C  
U  
N

---

## CONVENTION SPONSORS

---

### HIGH PERFORMANCE

ACI Delaware Valley Chapter  
Master Builders  
Sika Corporation

### DURABILITY

High Concrete Structures, Inc.  
Oldcastle Precast, Inc.  
New Enterprise S & L

### CURING

Allied Concrete & Supply  
Concrete Contractors Association  
Grace Construction Products  
Re-Steel Supply Company

### CONSOLIDATION

ACI Pittsburgh Area Chapter  
Action Supply  
Admix, Inc.  
Michael J. Boyle  
Concrete Construction Committee  
CVM Engineers  
Euclid Chemical  
Tim Haahs Associates  
Keast & Hood  
Kling Lindquist Partnership  
Nitterhouse Concrete  
Pennonni Associates, Inc.  
Precast Services, Inc.  
Carl Walker

---

## CONVENTION SPONSORS

---

### PLACEMENT

ACI N. California & W. Nevada Chapter  
ACI Georgia Chapter  
ACI Houston Chapter  
ACI Greater Michigan Chapter  
ACI Rocky Mountain Chapter  
ACI San Diego International Chapter  
ACI New Mexico Chapter  
ACI New Jersey Chapter  
ACI Northeast Texas Chapter  
Ammann & Whitney  
Architectural Precast, Inc.  
Ballinger Company  
Concrete Artisans, LLC  
DePaul Concrete Co.  
Eastern Gunite  
John Jaszczak  
Keystone Cement  
A.L. Patterson Company  
USI MidAtlantic  
Valley Forge Laboratories  
H. Wilden Associates  
Wiss Janney Elstner Associates

### CONTRIBUTORS

ACI Southern California Chapter  
ACI NE Ohio Chapter  
Blue Circle Cement  
Hanson Pipe & Products  
A.W. Lookup Company  
NTH Consultants, Ltd.  
Joseph Ware

Sponsors are listed as of  
March 1, 2001

---

**ACI DELAWARE VALLEY  
CHAPTER OFFICERS**

---

**President**

Monica M. Schultes  
Mid-Atlantic Precast Association

**Vice President**

Paul D. Spiegel  
Pennon Associates, Inc.

**Secretary/Treasurer**

Judson F. Vogdes  
General Building Contractors Association

**Board Members**

John B. Cupchak  
B. Pietrini & Sons

Vicki L. Brown  
Widener University

Mark J. Di Pietro  
Oldcastle Precast, Inc.

Edwin W. Drum  
Silvi Concrete

Richard A. Esslinger  
Ewing Cole Cherry Brott

Steve Mitchell  
DePaul Concrete Co.

Joseph N. Ware  
Master Builder Technologies

---

**ACI DELAWARE VALLEY CHAPTER  
CONVENTION COMMITTEE**

---

**Co-Chairmen**

Paul D. Spiegel  
Pennoni Associates, Inc.

David A. VanOcker  
CVM Engineers, Inc.

**Concrete Mixer**

R. Victor Scotese  
L&M Construction Chemicals

Michael J. Ricchezza  
B. Pietrini & Sons

**Contractors' Day/Exhibits**

Michael S. Smith  
Concrete Artisans, LLC

William G. Sebastian  
AmeriSteel

**Fundraising**

John B. Cupchak  
B. Pietrini & Sons

Joseph M. Sharkey  
High Concrete Structures, Inc.

---

**ACI DELAWARE VALLEY CHAPTER  
CONVENTION COMMITTEE**

---

**Guest Program**

David & Lorraine Fielding  
David J. Fielding Co.

**Publicity**

Monica M. Schultes  
Mid-Atlantic Precast Association

**Student Program**

Vicki L. Brown  
Widener University

**Technical Program**

William A. Gillespie  
Kling Lindquist

J. Paul Hobelmann  
Kling Lindquist

**Treasurer**

Helmuth Wilden  
H. Wilden & Associates

The Delaware Valley Chapter  
table will be located in Franklin Hall B.

---

## GENERAL INFORMATION

---

### CONVENTION REGISTRATION

The ACI staff is eager to answer any questions you may have pertaining to the convention. The ACI Registration Desk will be open in the Franklin Hall Foyer during the following hours:

Saturday	2:00 PM - 6:00 PM
Sunday	8:00 AM - 5:30 PM
Monday	8:00 AM - 5:00 PM
Tuesday	8:00 AM - 5:00 PM
Wednesday	8:00 AM - 4:00 PM
Thursday	8:00 AM - 12:00 PM

### EDUCATIONAL SEMINAR REGISTRATION

Friday	7:45 AM - 8:00 AM
--------	-------------------

### NAME BADGES

Name badge ribbons are color coded for identification as follows:

Member:	Navy	Guest:	Tan
Student:	Green	Staff:	Maroon

**Name badges MUST be worn  
to all functions for entrance.**



**ATTENTION ACI MEMBERS!**  
First-time convention  
attendees have a BELL on their badge.  
Please welcome them to ACI!

### ATTENTION CHAIRMEN, SESSION MODERATORS & SPEAKERS

The Speaker Ready Room will be available  
for your use from  
Friday, March 23 – Wednesday, March 28,  
7:00 AM – 7:00 PM,  
Thursday, March 29,  
7:00 AM – 5:00 PM,  
in Conference Suite 2.  
Copying Service, PCs with printers, caramates and  
overheads will be available for your use.



Audio and video taping are strictly prohibited  
without the expressed written consent of the  
speaker.

---

## GENERAL INFORMATION

---

### COFFEE BREAKS

Beverages will be available on Level 4 at the following times:

Sunday	9:00 AM & 2:00 PM
Monday	9:00 AM & 2:00 PM
Tuesday	9:00 AM & 2:00 PM
Wednesday	9:00 AM & 2:00 PM

### ACI ALCOHOL POLICY

All ACI-sponsored receptions will offer nonalcoholic beer and soft drinks. No alcohol will be served to anyone under the age of 21.

### TRANSPORTATION AROUND TOWN

 Taxis are available from the Philadelphia Marriott at the Filbert Street Exit.

### AIRPORT TRANSPORTATION

Shuttle service to the airport is available through USA Limo. The fee is \$8 one way. Advance reservations are recommended. The concierge can assist you in making reservations.

Taxi service to the Philadelphia International Airport is \$20 flat fee fare.

The train is also available for a \$5 one-way fee. From the hotel take the Market Street Exit to the train station.

### FUTURE CONVENTION INFORMATION

If you would like to receive information for future ACI Conventions via e-mail, please e-mail your name and e-mail address to [conventions@aci-int.org](mailto:conventions@aci-int.org).



---

## WHERE'S THAT MEETING ROOM?

---

### Lobby Level

JW's Restaurant JW's

### Level 3

Conference Suite 2 (Speaker Ready Room) CS2

Conference Room 301 301

Conference Room 302 302

Conference Room 303 303

Conference Room 304 304

Conference Room 305 305

Conference Room 306 306

Conference Room 307 307

Conference Room 308 308

Conference Room 309 309

Conference Room 310 310

### Access the following rooms from the Level 3 Skybridge:

Independence Ballroom 1 Ind 1

Independence Ballroom 2 Ind 2

Independence Ballroom 3 Ind 3

Liberty Ballroom A Liberty A

Liberty Ballroom B Liberty B

Liberty Ballroom C Liberty C

PA Conv. Center Grand

Grand Hall

---

## WHERE'S THAT MEETING ROOM?

---

### Level 4

Conference Room 401	401
Conference Room 402	402
Conference Room 403	403
Conference Room 404	404
Conference Room 405	405
Conference Room 406	406
Conference Room 407	407
Conference Room 408	408
Conference Room 409	409
Conference Room 410	410
Conference Room 411	411
Conference Room 412	412
Conference Room 413	413
Conference Room 414	414
Conference Room 415	415

Franklin Hall B  
Franklin Hall Foyer

Franklin B  
ACI Registration

### Level 5

Conference Room 501	501
Conference Room 502	502

Grand Ballroom A	Salon A
Grand Ballroom B	Salon B
Grand Ballroom C	Salon C
Grand Ballroom D	Salon D
Grand Ballroom E	Salon E
Grand Ballroom F	Salon F
Grand Ballroom G	Salon G
Grand Ballroom H	Salon H
Grand Ballroom I	Salon I
Grand Ballroom J	Salon J
Grand Ballroom K	Salon K
Grand Ballroom L	Salon L

LEVEL THREE

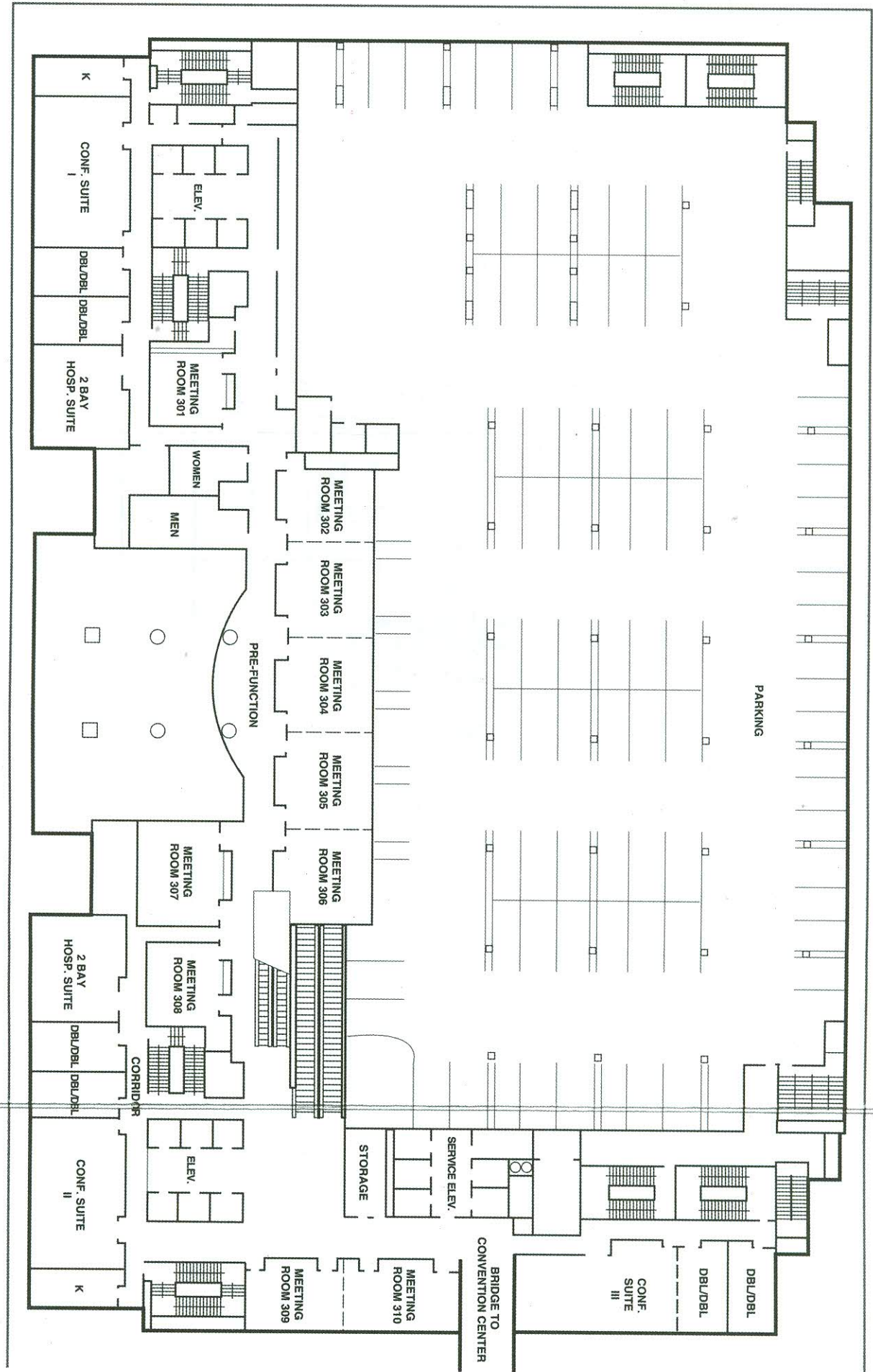

Level Three (cont.)

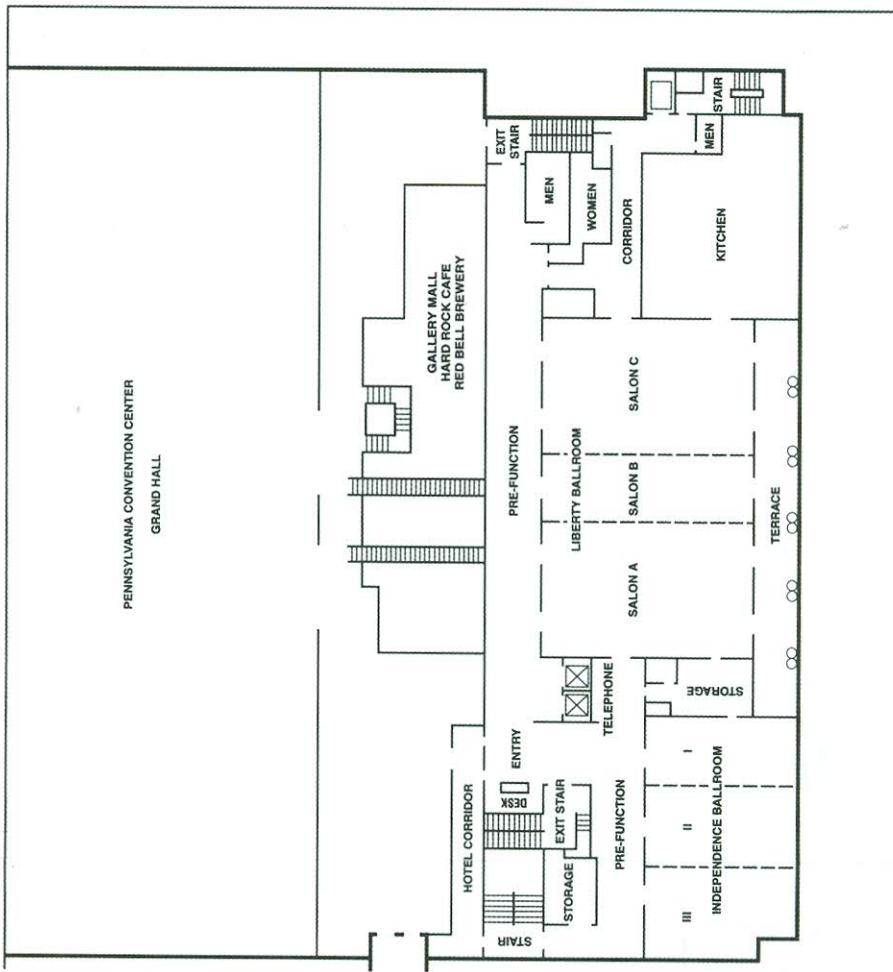

# LEVEL FOUR — FRANKLIN HALL

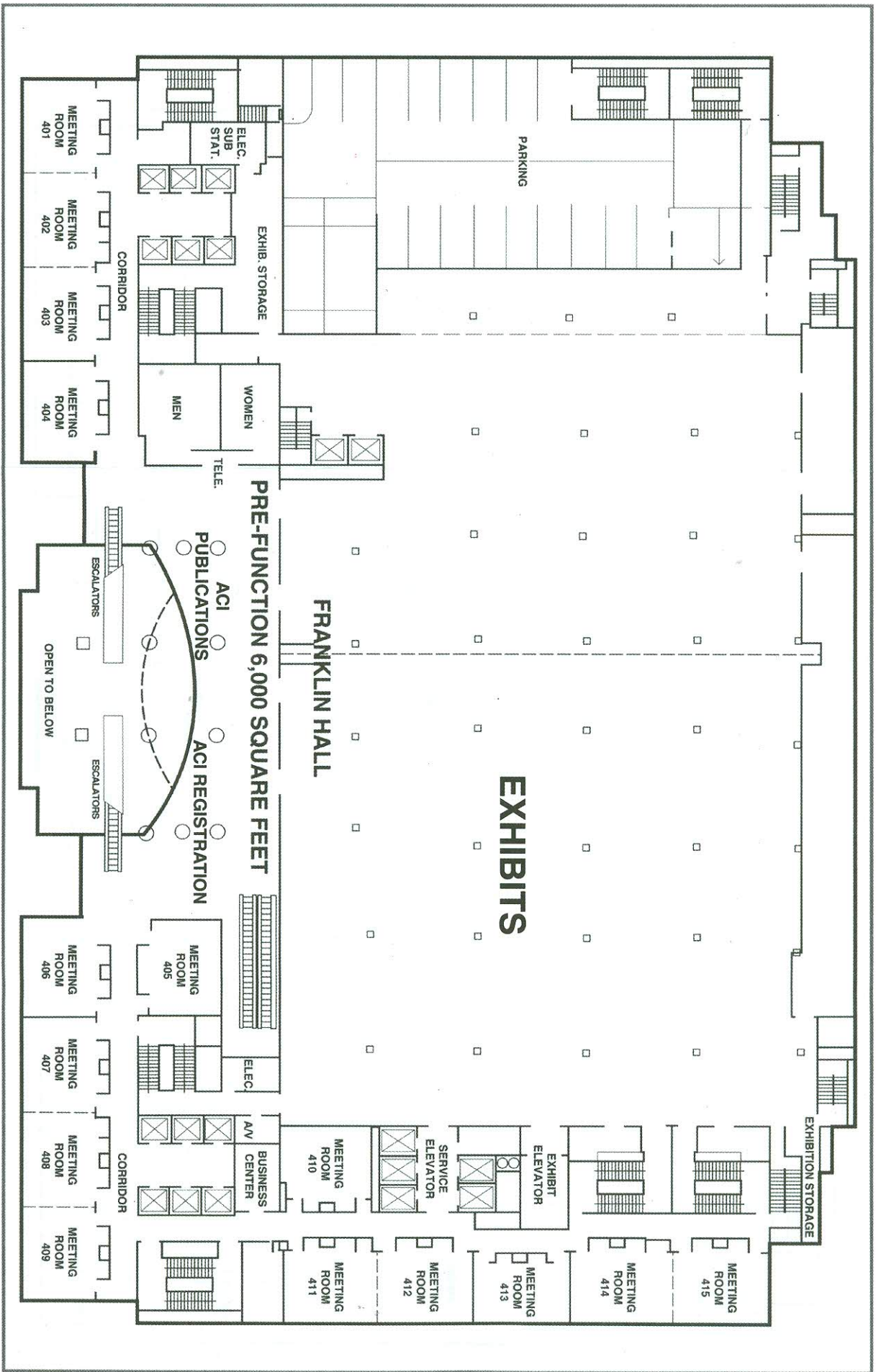

# LEVEL FOUR — FRANKLIN HALL

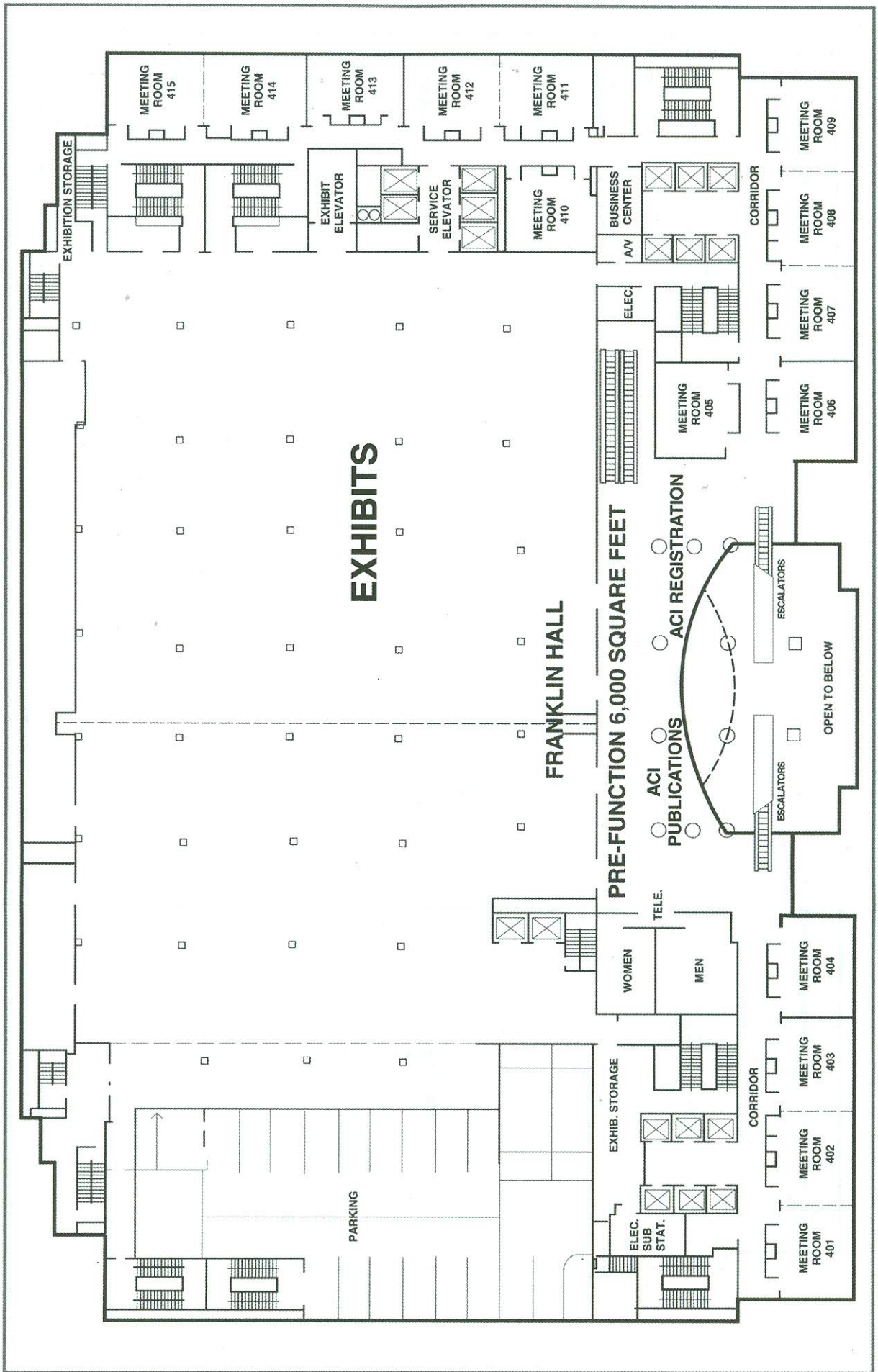

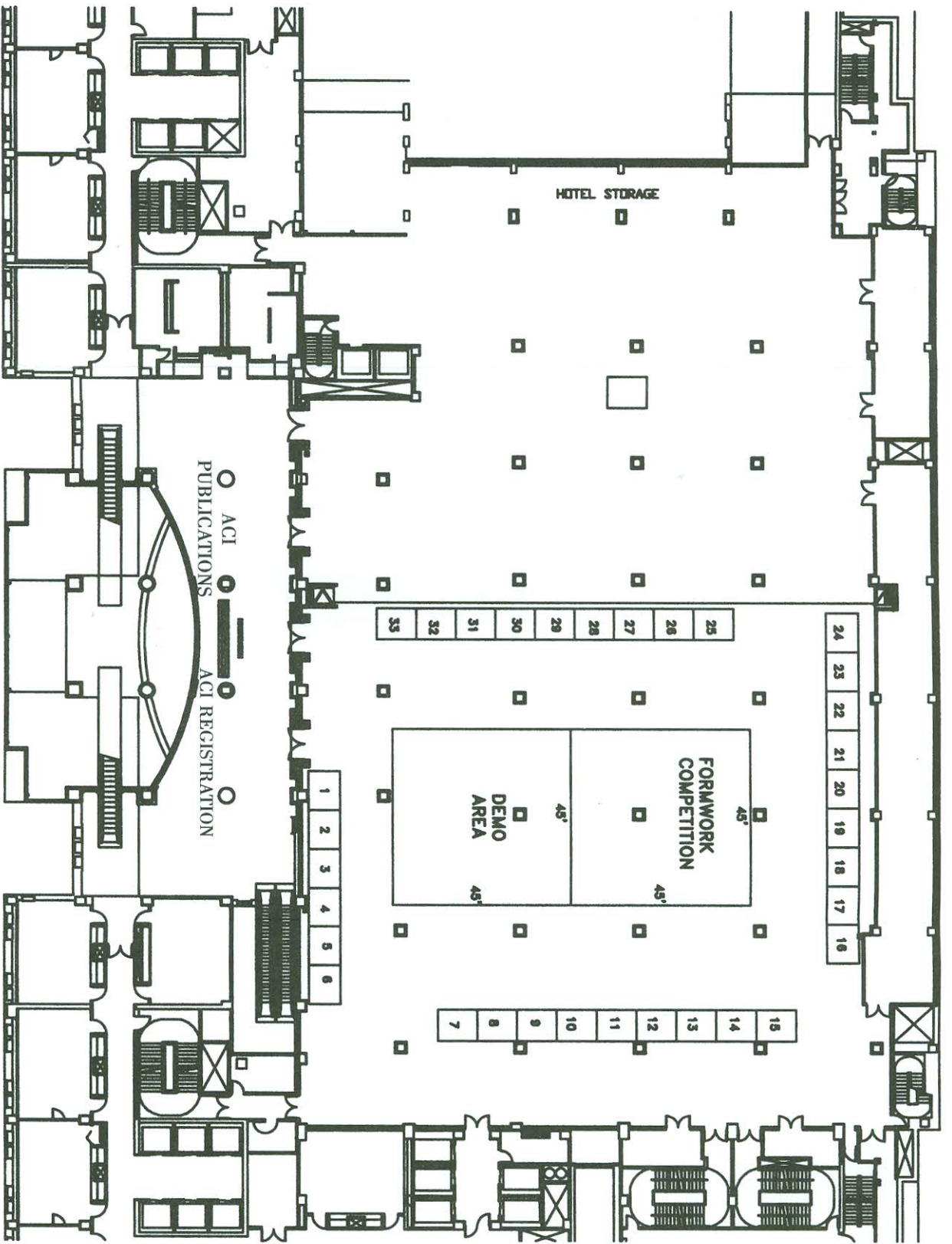

# EXHIBITS

---

## EXHIBITS

---

Sponsored by the ACI Delaware Valley Chapter

Exhibits will be open throughout the convention. Please see the sign outside Franklin Hall B for the dates and times for which exhibits will be open.

Exhibitors are listed as of February 22, 2001. An updated listing will be located outside of Franklin Hall B.

### EXHIBITORS

	Booth Number (s)
<b>ACI Delaware Valley Chapter</b> Philadelphia, Pennsylvania, USA	27
<b>Aquafin, Inc.</b> Columbia, Maryland, USA	12
<b>AXIM Concrete Technology</b> Middlebranch, Ohio, USA	26
<b>Fox Industries, Inc.</b> Baltimore, Maryland, USA	1
<b>Germann Instruments, Inc.</b> Evanston, Illinois, USA	25
<b>IPA Systems, Inc.</b> Philadelphia, Pennsylvania, USA	4
<b>L &amp; M Construction Chemicals</b> Collegeville, Pennsylvania, USA	7
<b>Master Builders Technologies, Inc.</b> Huntington Valley, Pennsylvania, USA	5
<b>SDS Non-Destructive Testing</b> Paso Robles, California, USA	14
<b>Sensors &amp; Software, Inc.</b> Mississauga, Ontario, Canada	16



---

## EXHIBITS

---

### EXHIBITORS *(Continued)*

	Booth Number (s)
Sika Corporation Lyndhurst, New Jersey, USA	3
Silica Fume Association Fairfax, Virginia, USA	2
Soff-Cut International Mocksville, North Carolina, USA	8
Symons Corporation King of Prussia, Pennsylvania, USA	19
Vector Corrosion Technologies Medina, Ohio, USA	13
Vimco, Inc. King of Prussia, Pennsylvania, USA	9
W. R. Grace Cambridge, Massachusetts, USA	6

---

## SPECIAL EVENTS

---

### ATTENTION FUTURE SESSION MODERATORS

#### Session Moderator Orientation Workshops

Sunday, March 25	11:30 AM – 1:00 PM	Salon K
Monday, March 26	11:30 AM – 1:00 PM	Salon K

All moderators of convention sessions are required by TAC and EAC to attend one of these orientation workshops. If you will be a moderator for a session at a future convention, and have not yet attended one of the workshops, please attend either workshop on Sunday or Monday at this convention.

**Sunday, March 25**

### STUDENT EGG PROTECTION DEVICE COMPETITION 1:00 PM – 5:00 PM

Salon I

Sponsored by Committee E801 & the ACI Delaware Valley Chapter

Get “egg-cited” and cheer for your favorite university at the annual ACI Student Egg Protection Device Competition! Remember, today’s students are tomorrow’s concrete industry leaders.

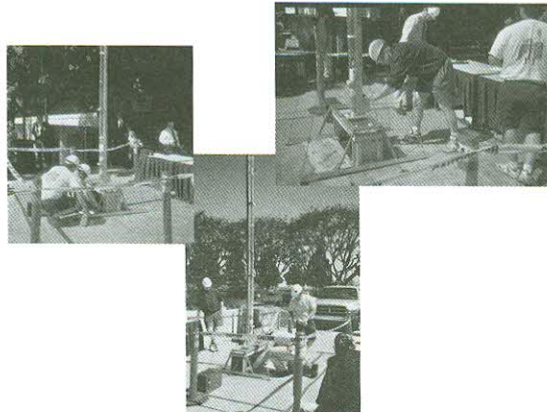

---

## SPECIAL EVENTS

---

**Sunday, March 25**

**WELCOME RECEPTION**  
**6:30 PM – 7:30 PM**

**Salons E - H**

Hosted by the ACI Delaware Valley Chapter & ACI International

Kick off your convention week with this cash bar reception. Meet your friends and colleagues for a cocktail and light refreshments before going to dinner. **Note:** *Beverages for this event must be paid with cash and cannot be charged to your room.*

Don't forget to make your dinner reservations for after the Welcome Reception. Philadelphia has hundreds of great restaurants. See the concierge for assistance.

**HOT TOPIC SESSION:**  
**STRONG QUAKE ROCKS**  
**PACIFIC NORTHWEST**  
**7:30 PM – 9:30 PM**

**Salons C & D**

Sponsored by the Hot Topic Committee

Don't miss this report by five prominent structural engineers from the Seattle area on the Nisqually Earthquake that hit the Pacific Northwest.

Reported as the biggest, this quake rocked the Puget Sound at 10:55 a.m., February 28, 2001. Lasting 30 seconds before subsiding, it registered 6.8 magnitude and was felt as far away as Salt Lake City – 700 miles away!

While no apparent damage of modern buildings was reported, many URM buildings sustained damage. We will hear from the speakers how buildings designed using modern seismic codes and retrofitted buildings performed in this earthquake.

This will be a session you won't want to miss!

*Beverages and refreshments will be available for purchase.*

## SPECIAL EVENTS

Monday, March 26

### STUDENTS' DAY

#### STUDENT ORIENTATION SESSION

Salon I

8:00 AM – 9:00 AM

Sponsored by Committee E801 & the ACI Delaware Valley Chapter

This session, designed for students, is an overview of the American Concrete Institute – what it is, why it exists, and how it functions. Topics will include ACI's mission, strategic plan, organization, technical and education committee structures, and convention format and other issues that are of special interest to students.

At the conclusion of the Orientation Session, mentors will be available to attend committee meetings and technical sessions with interested students. The meetings and sessions are open to all students.

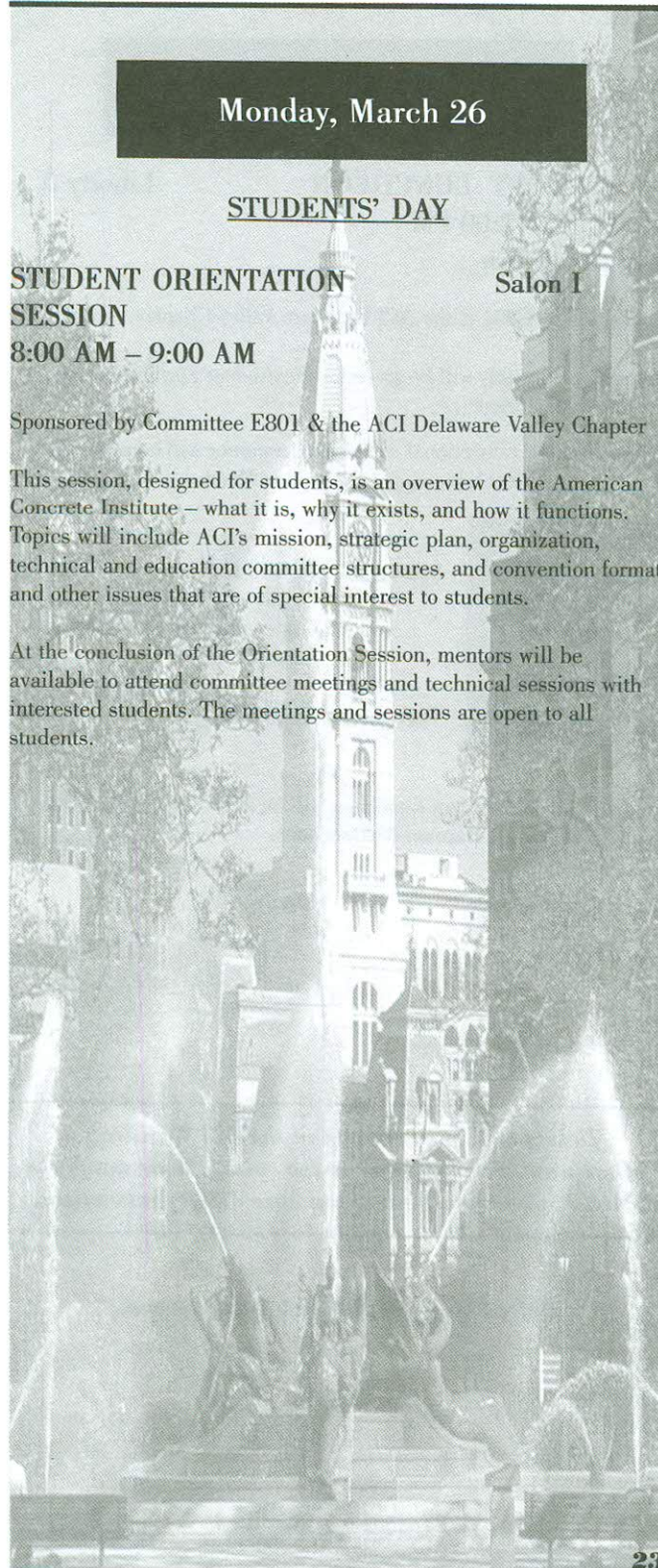

---

## SPECIAL EVENTS

---

Monday, March 26

✓ **STUDENT LUNCHEON** Liberty A  
12:00 PM – 2:00 PM  
\$36 per person

Sponsored by E801 & the ACI Delaware Valley Chapter

After lunch, awards will be given for the Student Egg Protection Device Competition.

In addition, the Educational Activities Committee will honor Om P. Dixit as the “2000 Educational Committee Member of the Year.”



**Speaker:** D. Kirk Harman  
President  
Cagley, Harman & Associates  
King of Prussia, PA

**Topic:** A Case Study in Constructibility

Highlighting the Student Luncheon will be a presentation by Kirk Harman of Cagley, Harman & Associates.

*Tickets may be purchased at the ACI Registration Desk until 24 hours prior to the event. Please notify the ACI Registration Desk if you have dietary restrictions.*

*Refer to page 81 for the luncheon menu.*

✓ Separate Fee Required

---

## SPECIAL EVENTS

---

**Monday, March 26**

**WOMEN IN ACI**

**Ind 3**

**5:00 PM – 6:00 PM**

Join other ACI women for this informal reception and networking opportunity. Refreshments will be served.

**CONCRETE MIXER –**

**Grand**

*Building a Nation*

**6:30 PM – 8:00 PM**

Hosted by the ACI Delaware Valley Chapter

Join us in the Grand Hall at the Reading Train Shed. Enjoy lively conversation with our forefathers and sample hors d'oeuvres and spirits.

Scheduled entertainment for the evening will include:

6:30 PM *The Fralinger String Quartet*

7:30 PM *Mummers*

8:00 PM *Ben Franklin*

**Tuesday, March 27**

**CHAPTER FORUM –**

**Salon I**

*Getting Chapters Involved*

*with Students*

**7:30 AM – 8:30 AM**

Sponsored by the Chapter Activities Committee

It's fun! It's easy! It's educational! Students will be amazed that something they thought of as "heavy" can be used in so many ways.

This session will demonstrate how students react to information presented. This will be a "hands-on" experience for high school and grade school students, who will actually get to make concrete.

A must for chapters who want to get involved in students' activities.

---

## SPECIAL EVENTS

---

**Tuesday, March 27**

**EXPO & DEMONSTRATIONS**                      **Franklin B**  
**9:00 AM – 11:30 AM**  
**2:00 PM – 4:00 PM**

Sponsored by the ACI Delaware Valley Chapter

Don't miss this day-long event held in the exhibit area. Watch product & concrete sampling demonstrations and cheer on engineering teams as they meet during the forming competition. See who will be awarded the Golden Hammer.

Refer to the schedule posted outside Franklin B for the demonstration schedule.

✓ **CONTRACTORS' DAY**                      **Liberty A**  
**LUNCHEON**  
**12:00 PM – 2:00 PM**  
**\$38 per person**

Hosted by: Construction Liaison  
Committee (CLC) & the  
ACI Delaware Valley Chapter

Speaker: Kenneth C. Hover  
Professor  
Cornell University  
Ithaca, NY



Casting durable, air-entrained concrete only begins with mix design and admixtures – it ends with mixing, transport, placing, consolidation, and finishing. Hear how these steps can affect air content and bubble size. The end result depends on construction technique and on testing.

*Tickets may be purchased at the ACI Registration Desk until 24 hours prior to the event. Please notify the ACI Registration Desk if you have dietary restrictions.*

*Refer to page 101 for the luncheon menu.*

✓ Separate Fee Required

---

## SPECIAL EVENTS

---

**Tuesday, March 27**

**CONTRACTORS' DAY  
RECEPTION & FORUM  
4:30 PM – 6:00 PM**

**Franklin B**

Sponsored by the ACI Delaware Valley Chapter, ACI International, and the American Society of Concrete Contractors (ASCC).

Discover the benefits of becoming an ACI member and network with fellow contractors.

This forum will invite nonmembers in attendance to join the ranks of ACI membership. Refreshments will be served.

**HOT TOPIC SESSION:  
SLAB MOISTURE &  
FLOOR-COVERING FAILURES –  
WHO'S TO BLAME?  
6:30 PM – 9:00 PM**

**Salon E**

Sponsored by the Hot Topic Committee & the ACI Delaware Valley Chapter

Moisture emission from concrete slabs and the resulting failure of floor coverings has become a common, perplexing problem to building owners, contractors, specifiers, and manufacturers over the last 10 years. Problems such as blistering of floor tiles and separation of seams have pitted contractors and manufacturers against owners and specifiers. Damage claims and lawsuits are mounting.

The majority of these problems are the result of vapor emission. Learn what causes this and how to avoid such problems. Learn the answer to the question, "Who's to blame for floor moisture problems?"



---

## SPECIAL EVENTS

---

Wednesday, March 28

✓ **INTERNATIONAL  
LUNCHEON & PROGRAM**

**Liberty A**

**12:00 PM – 2:00 PM**

**\$40 per person**

Sponsored by the International Committee (IC)

Moderator: Gajanan M. Sabnis  
Consultant  
Silver Spring, MD



**Speakers:** Wafeek S. Wahby  
Coordinator  
Industrial Tech. Program  
Eastern Illinois University  
Charleston, IL



Jo Coke  
Consultant  
Coke Communications  
Chattanooga, TN

**Topic:** China's Three Gorges Dam

Wafeek Wahby will present a summary of a report on the largest dam in the world – China's Three Gorges Dam. The information and observations were gathered during his visit in the summer of 2000.

The second part of the program will focus on the human side. Jo Coke, past president of ACI, led a People-to-People Ambassadors delegation to China last November, and will present this side of the story.

*Tickets may be purchased at the ACI Registration Desk until 24 hours prior to the event. Please notify the ACI Registration Desk if you have dietary restrictions.*

*Refer to page 120 for the luncheon menu.*

✓ Separate Fee Required

---

## SPECIAL EVENTS

---

Thursday, March 29

✓ **AWARDS BREAKFAST**      **Salons E & F**  
**8:00 AM – 10:00 AM**  
**\$35 per person**



Don't miss out as ACI honors the men and women who have contributed to better constructed facilities. Come meet and congratulate them on their achievements to the concrete industry.

Also join us in saying "Thank you" to those who will join the ranks of Honorary Membership.



*Tickets may be purchased at the ACI Registration Desk until 24 hours prior to the event. Please notify the ACI Registration Desk if you have dietary restrictions.*

*Refer to page 127 for the Awards Breakfast menu.*

✓ **Separate Fee Required**

---

## SPECIAL EVENTS

---

Thursday, March 29

**GENERAL SESSION**  
**10:15 AM – 12:00 PM**

**Salons E & F**

After the Awards Breakfast, plan to attend the Spring 2001 Convention General Session.



**Speaker:** *Richard J. Farley*  
Principal  
Kling Lindquist  
Faculty  
University of Pennsylvania  
Pennsylvania

**Topic:** Philadelphia's Role in the  
Concrete Industry

Now that you've been able to see a little of Philadelphia, come and hear the role the city has had in the advancement of concrete structures. Richard Farley will give an overview, with highlights of four projects from different time periods.



**Speaker:** *James O. Jirsa*  
Professor/Chairman  
Dept. of Civil Engineering  
University of Texas – Austin  
Austin, TX  
President  
ACI International

Hear a short presidential speech by James Jirsa as he gives an overview of his year as President. The new ACI officers will also be announced.

---

## GUEST TOURS

---

Any Day

### Philadelphia Trolley Tour

Sun.: 9:30 am – 4:00 pm

Mon. - Thurs.: 10:00 am – 4:00 pm

*\$18 per person*

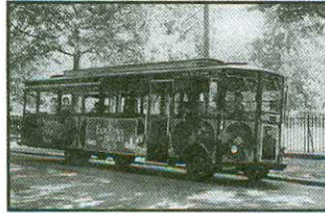

Visit Independence Hall, the Betsy Ross House, Liberty Bell, Antique Row, and many other sites the easy way – ride the Philadelphia Trolley! This fully narrated tour offers on-and-off privileges and lasts from 90 minutes to all day.

*NOTE: Trolley passes are valid for one (1) day only. A second day pass may be purchased for \$6.00. For this purchase, you must turn in your original pass at the end of the day to the trolley operator. Admission to additional attractions not included.*

Monday, March 26

### Historic Homes & City Tavern Tour

9:15 am - 2:30 pm

*\$45 per person*

This tour begins with an overview of two of the finest authentic early American houses. See why the Mount Pleasant Georgian Mansion built in 1763 was described as “the most elegant seat in Pennsylvania.” Then go back in time when you visit the Cedar Grove. This charming 1784 farm house will transport you back to simpler times. Let your taste buds experience the food of 18th century colonial America when you lunch at the Old City Tavern.  
(40 pp minimum)



Mount Pleasant Mansion

*Tickets may be purchased at the ACI Registration Desk until 24 hours prior to the event. Guest tours are nonrefundable.*

---

## GUEST TOURS

---

**Tuesday, March 27**

### **Fonthill & Moravian Tile Works**

**9:15 am – 3:00 pm**

***\$42 per person***

Your trip would not be complete without a visit to Fonthill. This national historic landmark, dubbed the “concrete castle,” was built in 1910 entirely of hand-mixed concrete and contains 44 rooms, 18 fireplaces, 32 stairwells, and more than 200 windows. Visit another hand-mixed concrete marvel, the Moravian Tile Works. This is where the creator of Fonthill, Henry Mercer, produced exquisite tiles and mosaics which adorn floors, walls, and ceilings throughout the world. Later enjoy lunch at the historic Plumsteadville Inn.  
(40 pp minimum)

*NOTE: Comfortable walking shoes are recommended. There are approximately 75-100 steps during this tour.*

**Wednesday, March 28**

### **Brandywine River Museum & Chaddsford Winery**

**9:15 am – 3:00 pm**

***\$38 per person***



**Chaddsford Winery**

Tour through what was once a Civil War era grist mill. The tour will highlight a fine collection of American illustrations in addition to still-life and landscape paintings. A buffet lunch in the museum cafeteria is included, followed by a tour through the 200-year-old colonial barn known as Chaddsford Winery. After walking through the wine-making cellars,

make your way to the wine tasting room to sample the current vintages. (40 pp minimum)

*NOTE: Comfortable walking shoes are recommended.*

*Tickets may be purchased at the ACI Registration Desk until 24 hours prior to the event.  
Guest tours are nonrefundable.*

---

## GUEST TOURS

---

Thursday, March 29

### King of Prussia Mall

9:15 am – 3:00 pm

*\$17 per person*

Ready to shop 'til you drop? Receive a complimentary Signature Savings Booklet when you shop at the King of Prussia "Designer" Mall. With 400 stores to choose from, your trip will include an In Style designer spring fashion show held in the courtyard.

(40 pp minimum)

*Tickets may be purchased at the ACI Registration Desk until 24 hours prior to the event.  
Guest tours are nonrefundable.*

**19,000+**  
**TESTED**  
**44%**  
**GROWTH**  
**4 NEW**  
**PROGRAMS**



**international<sup>®</sup>**  
**certification**

**WHAT A GREAT**  
**YEAR!**

**Thank YOU: Certification Committee  
Members, Local Sponsoring Groups,  
Examiners and Supporters!**

---

## PROGRAM AT A GLANCE

---

Friday, March 23

5:00 PM – 10:00 PM

TAC Technical Activities M1 Ind 1

Saturday, March 24

8:00 AM – 6:00 PM

TAC Technical Activities M2 Ind 1

8:30 AM – 5:00 PM

EAC Educational Activities M1 401

3:00 PM – 5:00 PM

CFTG Centennial Funding TG 403

Sunday, March 25

7:30 AM – 10:00 AM

MEMC Membership 308

8:00 AM – 6:00 PM

TAC RG 1 TAC Review Group 1 Ind 1

TAC RG 2 TAC Review Group 2 302

TAC RG 3 TAC Review Group 3 303

TAC RG 4 TAC Review Group 4 304

8:30 AM – 9:30 AM

341-2 Pier Wall Report 501

8:30 AM – 10:00 AM

440-H FRP Reinforced Concrete 407 & 408

8:30 AM – 11:30 AM

CLC Construction Liaison 305

E601 Seminar Oversight Committee 412

E801 Student Activities Salon I

315-B Constructibility Guidelines 405

335 Composite-Hybrid 306

347 Formwork 310

373 Prestressed/Tendons 415

408 Bond & Development Salon K

546-3 Material Selection Guide 307

8:30 AM – 5:00 PM

551 Tilt-Up 406



---

## PROGRAM AT A GLANCE

---

Sunday, March 25

<b>8:30 AM – 6:30 PM</b>		
313	Bins & Silos	Salon L
<b>9:30 AM – 11:30 AM</b>		
341-1	Bridge Columns Report	501
<b>10:00 AM – 11:30 AM</b>		
E701	Materials for Construction	413
<b>10:00 AM – 1:00 PM</b>		
342	Bridge Evaluation	Salon J
349-1	Materials	401
349-2	Design	402
349-4	Waste Repository Structures	403
355	Anchorage	411
440-C	FRP State of the Art	Ind 2
445-4	Pile Caps	309
<b>10:00 AM – 2:30 PM</b>		
209	Creep & Shrinkage	301
<b>11:30 AM – 1:00 PM</b>		
341-3	Retrofit Report	501
345	Bridge Construction	415
546-1	Underwater Repair	307
549	Thin Reinforced Cementitious	Ind 3
<b>11:30 AM – 1:00 PM <i>Session</i></b>		
	- Session Moderator Orientation Workshop	Salon K
<b>11:30 AM – 1:30 PM</b>		
HTC	Hot Topic	413
<b>12:00 PM – 6:00 PM</b>		
336	Footings	408
<b>1:00 PM – 3:30 PM</b>		
341	Earthquake-Resistant Bridges	501
<b>1:00 PM – 5:00 PM</b>		
362-2	Standard M1	414

---

## PROGRAM AT A GLANCE

---

Sunday, March 25

### 1:00 PM – 5:00 PM *Session*

- Student Egg Protection Device Competition Salon I

### 2:00 PM – 3:30 PM

C630T	Transportation Inspector	411
THPC-B	THPC Durability	401
118	Computers	306
120	History	412
121	Quality Assurance	Ind 2
215	Fatigue	310
365-A	Standard Model Development	309
440-J	FRP Stay-in-Place Formwork	307

### 2:00 PM – 5:00 PM

ANNV	Centennial Activities TG	413
E703	Construction Practices	405
IC	International Committee	404
RCC	Responsibility	305
305	Hot Weather	Salon B
309	Consolidation	Salon A
315	Detailing	403
343	Bridge Design	Ind 3
352	Joints	407
421	Slabs	415

### 2:00 PM – 5:00 PM *Sessions*

- Mechanisms of Concrete Deterioration Salon E
- ★ Seismic Design of Liquid – Containing Structures Salon F
- Safety Assessment of Existing Concrete Structures Salon G

### 2:00 PM – 6:30 PM

349-3	Embedments	402
546-4	Repair Guide	Salon K

---

## PROGRAM AT A GLANCE

---

Sunday, March 25

### 3:30 PM – 5:00 PM

E705	Educational Computer Activities	306
E903	Convention Training	310
THPC-C	THPC Construction	401
325.36	Concrete Pavement Strengths	309
439-C	Welded Splices	301
440-L	FRP Concrete Structures	307

### 3:30 PM – 6:30 PM

445-1	Strut & Tie	Ind 2
-------	-------------	-------

### 4:00 PM – 5:30 PM

506-P	Swimming Pools	412
506-S	Shotcrete Specification	411

### 5:00 PM – 6:30 PM

RAP TG	RAP Task Group	307
123	Research	306
201-C	Sulfate Attack	403
224	Cracking	413
227	Radioactive/Hazardous Mgmt	308
340	Design Aids	401
348	Safety	Salon A
439-B	Mechanical Splices	305
440-D	FRP Research	Ind 3

### 5:00 PM – 8:30 PM

439-A	Wire Reinforcement	301
-------	--------------------	-----

### 6:30 PM – 7:30 PM

Welcome Reception	Salons E -H
-------------------	-------------

### 7:30 PM – 9:30 PM *Session*

- Hot Topic Session: Strong Quake Rocks Pacific Northwest	Salons C & D
---	--------------

### 8:00 PM – 9:30 PM

Faculty Network on Repair	406
---------------------------	-----

---

## PROGRAM AT A GLANCE

---

Monday, March 26

<b>7:00 AM – 8:30 AM</b>		
TMC	TAC Metrication	405
<b>7:00 AM – 8:30 AM Session</b>		
	- Speaker's Training Breakfast: Incorporating Video Clips into PowerPoint Presentations	Salon E
<b>7:30 AM – 11:30 AM</b>		
MKTC	Marketing	415
<b>8:00 AM – 9:00 AM Session</b>		
	- Student Orientation Session	Salon I
<b>8:30 AM – 10:00 AM</b>		
122	Energy Conservation	401
304	Measuring/Mix/Trans/Placing	Salon K
308-S	Specifications	308
<b>8:30 AM – 11:30 AM</b>		
C610	Field Technician	305
C650	Tilt-Up	402
E802	Methods & Materials	404
THPC	TAC High-Performance	501
311	Inspection	303
346	CIP Pipe	310
349	Nuclear Structures	Ind 2
350-1	General & Concrete	414
351-2	Dynamic Mach Foundations	306
439	Steel Reinforcement	Salon J
533	Precast Panels	307
546	Repair	Ind 1
548-E	Structural Design & Analysis	410
<b>8:30 AM – 1:00 PM</b>		
207	Mass Concrete	304
232	Fly-Ash & Natural Pozzolans	Salon L
302	Floor Construction	Salon D
307	Chimneys	411
440-F	FRP Repair	407 & 408

## PROGRAM AT A GLANCE

Monday, March 26

<b>8:30 AM – 3:30 PM</b>		
C660	Shotcrete Nozzleman	406
<b>8:30 AM – 5:00 PM</b>		
350-4	Structural	412
<b>9:00 AM – 10:00 AM</b>		
318	Building Code M1	Salon C
<b>9:00 AM – 12:00 PM Sessions</b>		
	- Research in Progress	Salon H
★	Strength and Constructibility of Concrete Pavements, Overlays, and Repairs: Part 1	Salon E
★	Constructibility of Bridges – Concept to Completion: Part 1	Salon F
	- Technical Committee Chair Training Session	Salon G
<b>10:00 AM – 11:30 AM</b>		
211-E	Evaluation & Adjustment	309
216	Fire Resistance	302
304.6	Volumetric	Salon K
524	Plastering	308
<b>10:00 AM – 1:00 PM</b>		
INT ADV	Internet Advisory	401
318-E	Shear & Torsion M1	Salon C
441	Columns	403
552	Cement Grouting	409
<b>10:30 AM – 12:00 PM</b>		
506-F	Fiber-Reinforced	405
<b>11:30 AM – 1:00 PM</b>		
C620	Laboratory Tech Cert	308
211-D	High Strength	309
231	Early Age	404
301-D	Arctl, Ltwt, Mass, Shrinkage	402
544-S	Student	501
548-D	Sulfur Concrete	410

★ Theme session

---

## PROGRAM AT A GLANCE

---

Monday, March 26

### 11:30 AM – 1:00 PM Session

- Session Moderator	Salon K
Orientation Workshop	

### 11:30 AM – 2:00 PM

RCRC	Reinf Conc Rsch Council	Ind 2
------	-------------------------	-------

### 12:00 PM – 2:00 PM

✓ Student Luncheon	Liberty A
--------------------	-----------

### 1:00 PM – 3:30 PM

506-G	Guide to Shotcrete	301
-------	--------------------	-----

### 1:00 PM – 5:00 PM

362-2	Standard M2	414
-------	-------------	-----

### 2:00 PM – 3:30 PM

E803	Faculty Network Coordinating	408
211-C	No Slump	309
225	Hydraulic Cements	Salon J
229	Controlled Low-Strength	Salon I
350-3	Reinforcement & Devel	411
440-G	FRP Student Education	303
544-A	Steel Fibers	Salon C
544-B	Glass Fibers	501
	Porous Concrete (Formational Mtg)	Salon K

### 2:00 PM – 5:00 PM

C640	Craftsman	304
DLTG	Distance Learning TG	308
SCO	Scholarship Council (ConRef)	307
212	Chemical Admixtures	Salon D
234	Silica Fume	Ind 1
236-A	Mtrl Science - Workability	Salon L
350-11	Specifications	407
351	Equip Foundations	306
370	Dynamic & Vibratory Effects M1	305
375	Wind Loads	405
548-B	Polymer Concrete Overlays	410

✓ Separate fee required

---

## PROGRAM AT A GLANCE

---

Monday, March 26

### 2:00 PM – 5:00 PM Sessions

- |  |         |
|--|---------|
| ★ Strength and Constructibility of Concrete Pavements, Overlays, and Repairs: Part 2 | Salon E |
| - Nondestructive Testing of Mass Concrete Structures                                 | Salon G |
| ★ Constructibility of Bridges – Concept to Completion: Part 2                        | Salon F |
| - Rehabilitation and Repair of Concrete – Hot Industry Issues: Part 1                | Salon H |

### 2:00 PM – 6:30 PM

301-A	General Requirements	310
318-B	Reinforcement/Devel	401
318-C	Serviceability/Safety	402
318-D	Flexure & Axial Loads	403
318-F	Two-Way Slabs	404
350-2	Durability	415
360	Slabs on Ground	Ind 2

### 3:30 PM – 5:00 PM

E702	Designing Concrete Structures	303
214	Strength Tests	Salon I
308-M	Accelerated Curing	411
437	Strength Evaluation	309
444	Experimental Analysis	409
506-C	Certification	406
506-U	Underground Shotcrete	302
544-C	Synthetic Fibers	Salon C
544-D	Natural Fibers	501

### 3:30 PM – 6:00 PM

446	Fracture Mechanics	Salon J
-----	--------------------	---------

### 3:30 PM – 6:30 PM

372	Prestressed/Wire-Wrapped	408
440-K	FRP Material Characteristics	Salon K

★ Theme session

---

## PROGRAM AT A GLANCE

---

Monday, March 26

**5:00 PM – 6:00 PM**

Women in ACI Reception Ind 3

**5:00 PM – 6:30 PM**

236	Material Science	Salon L
308-R	Guide to Curing R1	411
362	Parking Structures	Salon C
445-2	Seismic Shear	308
445-5	Torsion	407
503-A	Polyurethanes for Injection	405
544-F	Testing	Salon I
555	Removal & Reuse	412

**5:30 PM – 6:30 PM**

University of Illinois Alumni Salon A

**6:30 PM – 8:00 PM**

Concrete Mixer – *Building a Nation* Grand

Tuesday, March 27

**7:00 AM – 8:30 AM**

325.9 Design & Constr of Pavements 303

**7:00 AM – 8:30 AM Session**

- Committee Chairman Salon G  
Training Breakfast: Timelines  
& Planning Guidelines

**7:00 AM – 9:00 AM**

TTTC TAC Technology Transfer Salon A

**7:00 AM – 12:00 PM**

EAC Educational Activities M2 405

**7:30 AM – 8:30 AM Session**

- Chapter Forum Salon I  
*Getting Chapters Involved  
with Students*



## PROGRAM AT A GLANCE

Tuesday, March 27

<b>8:00 AM – 9:00 AM</b>		
506-E	Evaluation of Shotcrete	406
<b>8:30 AM – 10:00 AM</b>		
C630	Construction Inspector	308
213-B	By-Product Ltwt Aggregates	407
223-1	Field Measurements	501
350-8	Editorial	413
357	Offshore & Marine	304
440-E	Professional Education	303
504	Joint Sealants	307
544-G	Design & Structural Uses	Salon J
<b>8:30 AM – 11:30 AM</b>		
CAC	Chapter Activities	Ind 2
117	Tolerances	309
201	Durability	Salon D
230	Soil Cement	411
235	Knowledge-Based Systems	408
301-E	Prestressed	409
370	Dynamic & Vibratory Effects M2	305
374	Seismic Design	Ind 1
548	Polymers	Salons K & L
<b>8:30 AM – 1:00 PM</b>		
301-C	Mixtures, Handle, Place, Constr	410
318-A	General Concrete Constr	401
318-E	Shear & Torsion M2	402
318-G	Prestressed Precast	403
318-H	Seismic Provisions	404
332-TG1	Guides Task Group 1	310
350-5	Precast /Prestressed	414
<b>8:30 AM – 2:00 PM</b>		
334	Shells	306
<b>8:30 AM – 5:00 PM</b>		
543	Concrete Piles	412
<b>8:30 AM – 6:30 PM</b>		
350-6	Seismic	415
<b>9:00 AM – 11:00 AM</b>		
506	Shotcreting	Salon C

---

## PROGRAM AT A GLANCE

---

Tuesday, March 27

### 9:00 AM – 11:30 AM

- Expo & Demonstrations Franklin B

### 9:00 AM – 12:00 PM Sessions

- ★ Contractors' Day: Part I; Constructibility – Design to Construction; Problems and Solutions Salon G
- Rehabilitation and Repair of Concrete – Hot Industry Issues; Part 2 Salon H
- ★ Mechanical Splices in Seismic and Blast Applications Salon E
- Evaluation & Rehabilitation of Historic Concrete Bridges Salon F

### 10:00 AM – 11:30 AM

IJBRC	Int'l Joints & Bearings	308
213-A	Ltwt Conc Guide 213 Update	407
223-3	Construction Practices	501
325.31	Design of Concrete Overlays	303
515	Protective Systems	304

### 10:00 AM – 1:00 PM

211-A	Editorial & Rewrite	302
350-7	Tightness Testing	413
435	Deflection	406
544	Fiber-Reinforced	Salon B

### 10:30 AM – 1:00 PM

440-I	FRP Prestressed Concrete	Salon A
-------	--------------------------	---------

### 11:30 AM – 1:00 PM

CRC	Concrete Research Council	Salon J
221	Aggregates	307
223-2	Components	501
325.32	Design of Jointed Pavements	303
554	Bearing Systems	304

★ Theme session

---

## PROGRAM AT A GLANCE

---

Tuesday, March 27

12:00 PM – 2:00 PM		
TAC	Technical Activities M3	Ind 1
12:00 PM – 2:00 PM		
✓	Contractors' Day Luncheon	Liberty A
2:00 PM – 3:30 PM		
213	Lightweight	307
2:00 PM – 4:00 PM		
-	Expo & Demonstrations	Franklin B
2:00 PM – 5:00 PM		
CPC	Certification Programs	308
CC	Convention Committee	405
ConRef	Concrete Res & Education	Salon I
CRSCTG	Conc-Related Software Cert	407
PUBC	Publications	309
124	Concrete Aesthetics	409
222	Corrosion	Salon C
223	Shrinkage-Compensating	Salon K
233	Ground Slag	306
325.1	Roller-Compacted Pavements	303
330	Parking Lots & Site Paving	304
350-9	Education	413
350-10	Hazardous Materials	414
364	Rehabilitation	Salon L
503	Adhesives	305
550	Precast Structures	Salon J

✓ Separate fee required

---

## PROGRAM AT A GLANCE

---

Tuesday, March 27

### 2:00 PM – 5:00 PM Sessions

- ★ Contractors' Day: Part 2; Salon G  
Considerations for Planned Projects –  
Discussion of Constructibility Issues  
from Cast-In-Place, Precast, Design  
and Construction Management Perspectives
- Recent Advances in the Salon E  
Seismic-Resistant Design of  
Concrete Bridges
- ★ Teaching Constructibility Salon F
- Open Paper Session Salon H

### 2:00 PM – 6:30 PM

- 228 Nondestructive Testing 404
- 318 Building Code M2 Salon D
- 332-TG2 Standards Task Group 2 310
- 440 Fiber Reinforced Polymer Salons A & B

### 3:00 PM – 5:00 PM

- 116 Terminology & Notation 403

### 3:00 PM – 6:00 PM

- 332-TG3 Seminars Task Group 3 401

### 3:30 PM – 5:00 PM

- 363-1 SOTA Rewrite 411
- 445-3 Slab Shear 402

### 4:30 PM – 6:00 PM

- Contractors' Reception & Forum Franklin B

### 5:00 PM – 6:30 PM

- 308-HPC HPC Curing 409
- 325 Pavements 303
- 363-2 HSC Definition 411
- 365 Service Life 309

★ Theme session

---

## PROGRAM AT A GLANCE

---

**Tuesday, March 27**

6:00 PM – 10:00 PM  
TRRC      TAC Repair & Rehab      501

6:30 PM  
445-6      Database      Contact Chair

6:30 PM – 9:00 PM *Session*

- Hot Topic Session:      Salon E  
Slab Moisture & Floor-Covering  
Failures – Who's to Blame?

7:30 PM – 10:00 PM *Session*

- 123 Forum: Design      Salon H  
Build vs. Traditional  
Construction

**Wednesday, March 28**

7:00 AM – 10:00 AM  
TSC      TAC Specifications      501

7:30 AM – 5:00 PM  
BOD      Board of Direction M1      Salon D

8:30 AM – 10:00 AM  
301-B      Formwork & Reinforcement      401

8:30 AM – 11:30 AM  
369      Seismic Rehab      310

8:30 AM – 5:00 PM  
350      Environmental Structures      Salon A

---

## PROGRAM AT A GLANCE

---

Wednesday, March 28

### 9:00 AM – 12:00 PM Sessions

- International Standardization & ACI Salon G
- ACI 548 – Polymers in Concrete: The First 30 Years: Part I Salon E
- ★ Quality Assurance and Control of Construction Projects Salon F

### 10:00 AM – 5:00 PM

355-ICBO Intl Congress Bldg Officials 306

### 12:00 PM – 2:00 PM

✓ International Luncheon & Program Liberty A

### 1:00 PM – 6:30 PM

301 Specifications 404

### 2:00 PM – 3:30 PM

211-B Lightweight 501

### 2:00 PM – 4:00 PM

523-A Autoclaved Aerated Concrete 403

### 2:00 PM – 5:00 PM

303 Architectural CIP 307

306 Cold Weather 401

308 Curing 402

363 High Strength Salon L

★ Theme session ✓ Separate fee required

---

## PROGRAM AT A GLANCE

---

Wednesday, March 28

2:00 PM – 5:00 PM *Sessions*

- ACI 548 – Polymers in Concrete: The First 30 Years: Part 2 Salon E
- ★ Constructibility of Shrinkage Compensating Concrete Salon G
- ★ Design and Construction of Durable Parking Structures Salon F

2:00 PM – 5:30 PM

445 Shear & Torsion Salon B

2:00 PM – 6:30 PM

332 Residential Concrete Salon K

423 Prestressed Salon J

3:30 PM – 6:00 PM

211 Proportioning Salon C

4:00 PM – 6:30 PM

523 Cellular Concrete 403

Thursday, March 29

8:00 AM – 10:00 AM

✓ Awards Breakfast Salons E & F

10:15 AM – 12:00 PM

General Session Salons E & F

2:00 PM – 5:00 PM

BOD Board of Direction M2 Salon D

★ Theme session ✓ Separate fee required

---

## PROGRAM AT A GLANCE

---

Friday, March 30

7:45 AM – 5:00 PM *Session*

- ✓ ACI Educational  
Seminar: Controlled Low-Strength  
Materials (CLSM)

Salon D

✓ Separate fee required





## NUMERIC COMMITTEE LISTING

(M)=Meeting                      (TG)=Task Group                      (WG)=Work Group

COMM	COMMITTEE TITLE	DAY	TIME	ROOM
ANNV	Centennial Activities TG	Sun	2:00p - 5:00p	413
BOD	Board of Direction M1	Wed	7:30a - 5:00p	Salon D
BOD	Board of Direction M2	Thu	2:00p - 5:00p	Salon D
CAC	Chapter Activities	Tue	8:30a - 11:30a	Ind 2
CC	Convention Committee	Tue	2:00p - 5:00p	405
CFTG	Centennial Funding TG	Sat	3:00p - 5:00p	403
CLC	Construction Liaison	Sun	8:30a - 11:30a	305
ConRef	Concrete Res & Education	Tue	2:00p - 5:00p	Salon I
CPC	Certification Programs	Tue	2:00p - 5:00p	308
CRC	Concrete Research Council	Tue	11:30a - 1:00p	Salon J
CRSCTG	Conc-Related Software Cert	Tue	2:00p - 5:00p	407
C610	Field Technician	Mon	8:30a - 11:30a	305
C620	Laboratory Tech Cert	Mon	11:30a - 1:00p	308
C630	Construction Inspector	Tue	8:30a - 10:00a	308
C630T	Transportation Inspector	Sun	2:00p - 3:30p	411
C640	Craftsman	Mon	2:00p - 5:00p	304
C650	Tilt-Up	Mon	8:30a - 11:30a	402
C660	Shotcrete Nozzleman	Mon	8:30a - 3:30p	406
DLTG	Distance Learning TG	Mon	2:00p - 5:00p	308
EAC	Educational Activities M1	Sat	8:30a - 5:00p	401
EAC	Educational Activities M2	Tue	7:00a - 12:00p	405
E601	Seminar Oversight Committee	Sun	8:30a - 11:30a	412
E701	Materials for Construction	Sun	10:00a - 11:30a	413
E702	Designing Concrete Structures	Mon	3:30p - 5:00p	303
E703	Construction Practices	Sun	2:00p - 5:00p	405
E705	Educational Computer Activities	Sun	3:30p - 5:00p	306
E801	Student Activities	Sun	8:30a - 11:30a	Salon I
E802	Methods & Materials	Mon	8:30a - 11:30a	404
E803	Faculty Network Coordinating	Mon	2:00p - 3:30p	408
E903	Convention Training	Sun	3:30p - 5:00p	310
HTC	Hot Topic	Sun	11:30a - 1:30p	413
IC	International Committee	Sun	2:00p - 5:00p	404
JBRC	Int'l Joints & Bearings	Tue	10:00a - 11:30a	308
INTADV	Internet Advisory	Mon	10:00a - 1:00p	401
MEMC	Membership	Sun	7:30a - 10:00a	308
MKTC	Marketing	Mon	7:30a - 11:30a	415
PUBC	Publications	Tue	2:00p - 5:00p	309
RAP TG	RAP Task Group	Sun	5:00p - 6:30p	307
RCC	Responsibility	Sun	2:00p - 5:00p	305
RCRC	Reinf Conc Rsch Council	Mon	11:30a - 2:00p	Ind 2
SCO	Scholarship Council (ConRef)	Mon	2:00p - 5:00p	307
TAC	Technical Activities M1	Fri	5:00p - 10:00p	Ind 1
TAC	Technical Activities M2	Sat	8:00a - 6:00p	Ind 1
TAC	Technical Activities M3	Tue	12:00p - 2:00p	Ind 1
TAC RG 1	TAC Review Group 1	Sun	8:00a - 6:00p	Ind 1
TAC RG 2	TAC Review Group 2	Sun	8:00a - 6:00p	302
TAC RG 3	TAC Review Group 3	Sun	8:00a - 6:00p	303
TAC RG 4	TAC Review Group 4	Sun	8:00a - 6:00p	304
THPC	TAC High-Performance	Mon	8:30a - 11:30a	501
THPC-B	THPC Durability	Sun	2:00p - 3:30p	401
THPC-C	THPC Construction	Sun	3:30p - 5:00p	401
TMC	TAC Metrication	Mon	7:00a - 8:30a	405
TSC	TAC Specifications	Wed	7:00a - 10:00a	501
TTTC	TAC Technology Transfer	Tue	7:00a - 9:00a	Salon A
TRRC	TAC Repair & Rehab	Tue	6:00p - 10:00p	501
116	Terminology & Notation	Tue	3:00p - 5:00p	403
117	Tolerances	Tue	8:30a - 11:30a	309
118	Computers	Sun	2:00p - 3:30p	306
120	History	Sun	2:00p - 3:30p	412
121	Quality Assurance	Sun	2:00p - 3:30p	Ind 2

## NUMERIC COMMITTEE LISTING

COMM	COMMITTEE TITLE	DAY	TIME	ROOM
122	Energy Conservation	Mon	8:30a - 10:00a	401
123	Research	Sun	5:00p - 6:30p	306
124	Concrete Aesthetics	Tue	2:00p - 5:00p	409
201	Durability	Tue	8:30a - 11:30a	Salon D
201-C	Sulfate Attack	Sun	5:00p - 6:30p	403
207	Mass Concrete	Mon	8:30a - 1:00p	304
209	Creep & Shrinkage	Sun	10:00a - 2:30p	301
211	Proportioning	Wed	3:30p - 6:00p	Salon C
211-A	Editorial & Rewrite	Tue	10:00a - 1:00p	302
211-B	Lightweight	Wed	2:00p - 3:30p	501
211-C	No Slump	Mon	2:00p - 3:30p	309
211-D	High Strength	Mon	11:30a - 1:00p	309
211-E	Evaluation & Adjustment	Mon	10:00a - 11:30a	309
212	Chemical Admixtures	Mon	2:00p - 5:00p	Salon D
213	Lightweight	Tue	2:00p - 3:30p	307
213-A	Ltwt Conc Guide 213 Update	Tue	10:00a - 11:30a	407
213-B	By-Product Ltwt Aggregates	Tue	8:30a - 10:00a	407
214	Strength Tests	Mon	3:30p - 5:00p	Salon I
215	Fatigue	Sun	2:00p - 3:30p	310
216	Fire Resistance	Mon	10:00a - 11:30a	302
221	Aggregates	Tue	11:30a - 1:00p	307
222	Corrosion	Tue	2:00p - 5:00p	Salon C
223	Shrinkage-Compensating	Tue	2:00p - 5:00p	Salon K
223-1	Field Measurements	Tue	8:30a - 10:00a	501
223-2	Components	Tue	11:30a - 1:00p	501
223-3	Construction Practices	Tue	10:00a - 11:30a	501
224	Cracking	Sun	5:00p - 6:30p	413
225	Hydraulic Cements	Mon	2:00p - 3:30p	Salon J
227	Radioactive/Hazardous Mgmt	Sun	5:00p - 6:30p	308
228	Nondestructive Testing	Tue	2:00p - 6:30p	404
229	Controlled Low-Strength	Mon	2:00p - 3:30p	Salon I
230	Soil Cement	Tue	8:30a - 11:30a	411
231	Early Age	Mon	11:30a - 1:00p	404
232	Fly Ash & Natural Pozzolans	Mon	8:30a - 1:00p	Salon L
233	Ground Slag	Tue	2:00p - 5:00p	306
234	Silica Fume	Mon	2:00p - 5:00p	Ind 1
235	Knowledge-Based Systems	Tue	8:30a - 11:30a	408
236	Material Science	Mon	5:00p - 6:30p	Salon L
236-A	Mtrl Science - Workability	Mon	2:00p - 5:00p	Salon L
301	Specifications	Wed	1:00p - 6:30p	404
301-A	General Requirements	Mon	2:00p - 6:30p	310
301-B	Formwork & Reinforcement	Wed	8:30a - 10:00a	401
301-C	Mixtures, Handle, Place, Constr	Tue	8:30a - 1:00p	410
301-D	Arctl, Ltwt, Mass, Shrinkage	Mon	11:30a - 1:00p	402
301-E	Prestressed	Tue	8:30a - 11:30a	409
302	Floor Construction	Mon	8:30a - 1:00p	Salon D
303	Architectural CIP	Wed	2:00p - 5:00p	307
304	Measuring/Mix/Trans/Placing	Mon	8:30a - 10:00a	Salon K
304.6	Volumetric	Mon	10:00a - 11:30a	Salon K
305	Hot Weather	Sun	2:00p - 5:00p	Salon B
306	Cold Weather	Wed	2:00p - 5:00p	401
307	Chimneys	Mon	8:30a - 1:00p	411
308	Curing	Wed	2:00p - 5:00p	402
308-HPC	HPC Curing	Tue	5:00p - 6:30p	409
308-M	Accelerated Curing	Mon	3:30p - 5:00p	411
308-R	Guide to Curing R1	Mon	5:00p - 6:30p	411
308-S	Specifications	Mon	8:30a - 10:00a	308
309	Consolidation	Sun	2:00p - 5:00p	Salon A
311	Inspection	Mon	8:30a - 11:30a	303
313	Bins & Silos	Sun	8:30a - 6:30p	Salon L
315	Detailing	Sun	2:00p - 5:00p	403
315-B	Constructibility Guidelines	Sun	8:30a - 11:30a	405
318	Building Code M1	Mon	9:00a - 10:00a	Salon C

## NUMERIC COMMITTEE LISTING

COMM	COMMITTEE TITLE	DAY	TIME	ROOM
318	Building Code M2	Tue	2:00p - 6:30p	Salon D
318-A	General Concrete Constr	Tue	8:30a - 1:00p	401
318-B	Reinforcement/Devel	Mon	2:00p - 6:30p	401
318-C	Serviceability/Safety	Mon	2:00p - 6:30p	402
318-D	Flexure & Axial Loads	Mon	2:00p - 6:30p	403
318-E	Shear & Torsion M1	Mon	10:00a - 1:00p	Salon C
318-E	Shear & Torsion M2	Tue	8:30a - 1:00p	402
318-F	Two-Way Slabs	Mon	2:00p - 6:30p	404
318-G	Prestressed Precast	Tue	8:30a - 1:00p	403
318-H	Seismic Provisions	Tue	8:30a - 1:00p	404
325	Pavements	Tue	5:00p - 6:30p	303
325.1	Roller-Compacted Pavements	Tue	2:00p - 5:00p	303
325.9	Design & Constr of Pavements	Tue	7:00a - 8:30a	303
325.31	Design of Concrete Overlays	Tue	10:00a - 11:30a	303
325.32	Design of Jointed Pavements	Tue	11:30a - 1:00p	303
325.36	Concrete Pavement Strengths	Sun	3:30p - 5:00p	309
330	Parking Lots & Site Paving	Tue	2:00p - 5:00p	304
332	Residential Concrete	Wed	2:00p - 6:30p	Salon K
332-TG1	Guides Task Group 1	Tue	8:30a - 1:00p	310
332-TG2	Standards Task Group 2	Tue	2:00p - 6:30p	310
332-TG3	Seminars Task Group 3	Tue	3:00p - 6:00p	401
334	Shells	Tue	8:30a - 2:00p	306
335	Composite-Hybrid	Sun	8:30a - 11:30a	306
336	Footings	Sun	12:00p - 6:00p	408
340	Design Aids	Sun	5:00p - 6:30p	401
341	Earthquake-Resistant Bridges	Sun	1:00p - 3:30p	501
341-1	Bridge Columns Report	Sun	9:30a - 11:30a	501
341-2	Pier Wall Report	Sun	8:30a - 9:30a	501
341-3	Retrofit Report	Sun	11:30a - 1:00p	501
342	Bridge Evaluation	Sun	10:00a - 1:00p	Salon J
343	Bridge Design	Sun	2:00p - 5:00p	Ind 3
345	Bridge Construction	Sun	11:30a - 1:00p	415
346	CIP Pipe	Mon	8:30a - 11:30a	310
347	Formwork	Sun	8:30a - 11:30a	310
348	Safety	Sun	5:00p - 6:30p	Salon A
349	Nuclear Structures	Mon	8:30a - 11:30a	Ind 2
349-1	Materials	Sun	10:00a - 1:00p	401
349-2	Design	Sun	10:00a - 1:00p	402
349-3	Embedments	Sun	2:00p - 6:30p	402
349-4	Waste Repository Structures	Sun	10:00a - 1:00p	403
350	Environmental Structures	Wed	8:30a - 5:00p	Salon A
350-1	General & Concrete	Mon	8:30a-11:30a	414
350-2	Durability	Mon	2:00p - 6:30p	415
350-3	Reinforcement & Devel	Mon	2:00p - 3:30p	411
350-4	Structural	Mon	8:30a - 5:00p	412
350-5	Precast/Prestressed	Tue	8:30a - 1:00p	414
350-6	Seismic	Tue	8:30a - 6:30p	415
350-7	Tightness Testing	Tue	10:00a - 1:00p	413
350-8	Editorial	Tue	8:30a - 10:00a	413
350-9	Education	Tue	2:00p - 5:00p	413
350-10	Hazardous Materials	Tue	2:00p - 5:00p	414
350-11	Specifications	Mon	2:00p - 5:00p	407
351	Equip Foundations	Mon	2:00p - 5:00p	306
351-2	Dynamic Mach Foundations	Mon	8:30a - 11:30a	306
352	Joints	Sun	2:00p - 5:00p	407
355	Anchorage	Sun	10:00a - 1:00p	411
355-ICBO	Intl Congress Bldg Officials	Wed	10:00a - 5:00p	306
357	Offshore & Marine	Tue	8:30a - 10:00a	304
360	Slabs on Ground	Mon	2:00p - 6:30p	Ind 2
362	Parking Structures	Mon	5:00p - 6:30p	Salon C

## NUMERIC COMMITTEE LISTING

COMM	COMMITTEE TITLE	DAY	TIME	ROOM
362-2	Standard M1	Sun	1:00p - 5:00p	414
362-2	Standard M2	Mon	1:00p - 5:00p	414
363	High Strength	Wed	2:00p - 5:00p	Salon L
363-1	SOTA Rewrite	Tue	3:30p - 5:00p	411
363-2	HSC Definition	Tue	5:00p - 6:30p	411
364	Rehabilitation	Tue	2:00p - 5:00p	Salon L
365	Service Life	Tue	5:00p - 6:30p	309
365-A	Standard Model Development	Sun	2:00p - 3:30p	309
369	Seismic Rehab	Wed	8:30a - 11:30a	310
370	Dynamic & Vibratory Effects M1	Mon	2:00p - 5:00p	305
370	Dynamic & Vibratory Effects M2	Tue	8:30a - 11:30a	305
372	Prestressed/Wire-Wrapped	Mon	3:30p - 6:30p	408
373	Prestressed/Tendons	Sun	8:30a - 11:30a	415
374	Seismic Design	Tue	8:30a - 11:30a	Ind 1
375	Wind Loads	Mon	2:00p - 5:00p	405
408	Bond & Development	Sun	8:30a - 11:30a	Salon K
421	Slabs	Sun	2:00p - 5:00p	415
423	Prestressed	Wed	2:00p - 6:30p	Salon J
435	Deflection	Tue	10:00a - 1:00p	406
437	Strength Evaluation	Mon	3:30p - 5:00p	309
439	Steel Reinforcement	Mon	8:30a - 11:30a	Salon J
439-A	Wire Reinforcement	Sun	5:00p - 8:30p	301
439-B	Mechanical Splices	Sun	5:00p - 6:30p	305
439-C	Welded Splices	Sun	3:30p - 5:00p	301
440	Fiber Reinforced Polymer	Tue	2:00p - 6:30p	Salons A & B
440-C	FRP State of the Art	Sun	10:00a - 1:00p	Ind 2
440-D	FRP Research	Sun	5:00p - 6:30p	Ind 3
440-E	Professional Education	Tue	8:30a - 10:00a	303
440-F	FRP Repair	Mon	8:30a - 1:00p	407 & 408
440-G	FRP Student Education	Mon	2:00p - 3:30p	303
440-H	FRP Reinforced Concrete	Sun	8:30a - 10:00a	407 & 408
440-I	FRP Prestressed Concrete	Tue	10:30a - 1:00p	Salon A
440-J	FRP Stay-in-Place Formwork	Sun	2:00p - 3:30p	307
440-K	FRP Material Characteristics	Mon	3:30p - 6:30p	Salon K
440-L	FRP Concrete Structures	Sun	3:30p - 5:00p	307
441	Columns	Mon	10:00a - 1:00p	403
444	Experimental Analysis	Mon	3:30p - 5:00p	409
445	Shear & Torsion	Wed	2:00p - 5:30p	Salon B
445-1	Strut & Tie	Sun	3:30p - 6:30p	Ind 2
445-2	Seismic Shear	Mon	5:00p - 6:30p	308
445-3	Slab Shear	Tue	3:30p - 5:00p	402
445-4	Pile Caps	Sun	10:00a - 1:00p	309
445-5	Torsion	Mon	5:00p - 6:30p	407
445-6	Database	Tue	6:30p	Contact Chair
446	Fracture Mechanics	Mon	3:30p - 6:00p	Salon J
503	Adhesives	Tue	2:00p - 5:00p	305
503-A	Polyurethanes for Injection	Mon	5:00p - 6:30p	405
504	Joint Sealants	Tue	8:30a - 10:00a	307
506	Shotcreting	Tue	9:00a - 11:00a	Salon C

## NUMERIC COMMITTEE LISTING

COMM	COMMITTEE TITLE	DAY	TIME	ROOM
506-C	Certification	Mon	3:30p - 5:00p	406
506-E	Evaluation of Shotcrete	Tue	8:00a - 9:00a	406
506-F	Fiber-Reinforced	Mon	10:30a - 12:00p	405
506-G	Guide to Shotcrete	Mon	1:00p - 3:30p	301
506-P	Swimming Pools	Sun	4:00p - 5:30p	412
506-S	Shotcrete Specification	Sun	4:00p - 5:30p	411
506-U	Underground Shotcrete	Mon	3:30p - 5:00p	302
515	Protective Systems	Tue	10:00a - 11:30a	304
523	Cellular Concrete	Wed	4:00p - 6:30p	403
523-A	Autoclaved Aerated Concrete	Wed	2:00p - 4:00p	403
524	Plastering	Mon	10:00a - 11:30a	308
533	Precast Panels	Mon	8:30a - 11:30a	307
543	Concrete Piles	Tue	8:30a - 5:00p	412
544	Fiber-Reinforced	Tue	10:00a - 1:00p	Salon B
544-A	Steel Fibers	Mon	2:00p - 3:30p	Salon C
544-B	Glass Fibers	Mon	2:00p - 3:30p	501
544-C	Synthetic Fibers	Mon	3:30p - 5:00p	Salon C
544-D	Natural Fibers	Mon	3:30p - 5:00p	501
544-F	Testing	Mon	5:00p - 6:30p	Salon I
544-G	Design & Structural Uses	Tue	8:30a - 10:00a	Salon J
544-S	Student	Mon	11:30a - 1:00p	501
546	Repair	Mon	8:30a - 11:30a	Ind 1
546-1	Underwater Repair	Sun	11:30a - 1:00p	307
546-3	Material Selection Guide	Sun	8:30a - 11:30a	307
546-4	Repair Guide	Sun	2:00p - 6:30p	Salon K
548	Polymers	Tue	8:30a - 11:30a	Salons K & L
548-B	Polymer Concrete Overlays	Mon	2:00p - 5:00p	410
548-D	Sulfur Concrete	Mon	11:30a - 1:00p	410
548-E	Structural Design & Analysis	Mon	8:30a - 11:30a	410
549	Thin Reinforced Cementitious	Sun	11:30a - 1:00p	Ind 3
550	Precast Structures	Tue	2:00p - 5:00p	Salon J
551	Tilt-Up	Sun	8:30a - 5:00p	406
552	Cement Grouting	Mon	10:00a - 1:00p	409
554	Bearing Systems	Tue	11:30a - 1:00p	304
555	Removal & Reuse	Mon	5:00p - 6:30p	412
	Porous Concrete (Formational Mtg)	Mon	2:00p - 3:30p	Salon K
	Faculty Network on Repair	Sun	8:00p - 9:30p	406



---

**SUNDAY, MARCH 25**

---

**11:30 AM – 1:00 PM**

**SESSION MODERATOR  
ORIENTATION WORKSHOP**

**Salon K**

Sponsored by Committee E903

Session Moderator: *David G. Kittridge*  
Principal Engineer  
Maitland, FL

The purpose of this workshop is to review the session moderator's role in leading quality sessions at ACI conventions. The review includes the Session Moderator Orientation Packet and the duties of the ACI session moderator. You will also learn how to motivate your speakers and the best methods of communicating with ACI.

This workshop will also be presented on **Monday, March 26,**  
**11:30 AM – 1:00 PM** in Salon K.

All moderators of convention sessions are required by TAC and EAC to attend one of these orientation workshops. If you will be a moderator for a session at a future convention, and have not yet attended one of the workshops, please attend this session on Sunday or Monday.



---

## SUNDAY, MARCH 25

---

1:00 PM – 5:00 PM

**STUDENT EGG  
PROTECTION DEVICE  
COMPETITION**

Salon I

Sponsored by Committee E801 & the ACI Delaware Valley Chapter

Session Moderator: *DJ Belarbi*  
Professor  
Dept. of Civil Engineering  
University of Missouri - Rolla  
Rolla, MO

Session Co-Moderator: *Vicki L. Brown*  
Professor  
Widener University  
Dept. of Civil Engineering  
Chester, PA

**Introduction** 1:00  
*DJ Belarbi*, Professor, Dept. of Civil  
Engineering, University of Missouri - Rolla,  
Rolla, MO

**Egg Protection Device Competition** 1:10

---

SUNDAY, MARCH 25

---

2:00 PM – 5:00 PM

**MECHANISMS OF  
CONCRETE DETERIORATION**

Salon E

Sponsored by Committee 236

Session Moderator: *Kevin J. Folliard*  
Assistant Professor  
Dept. of Civil Engineering  
University of Texas  
Austin, TX

Session Co-Moderator: *David Trejo*  
Assistant Professor  
Dept. of Civil Engineering  
Texas A&M University  
College Station, TX

**Introduction** 2:00  
*Kevin J. Folliard*, Assistant Professor,  
Dept. of Civil Engineering, University of  
Texas, Austin, TX

**Alkali-Silica Reaction** 2:05  
*Michael D. A. Thomas*, Associate  
Professor, Dept. of Civil Engineering,  
University of Toronto, Toronto, ONT,  
Canada

**Freezing and Thawing** 2:35  
*Jacques Marchand*, Professor,  
Dept. of Civil Engineering, Laval  
University, Quebec, QUE, Canada

**Corrosion of Reinforcing Steel** 3:05  
*Thomas Devine*, Professor/Chair,  
Dept. of Materials Science, University  
of California - Berkeley, Berkeley, CA

**Sulfate Attack** 3:35  
*Niels Thaulow*, Technical Director,  
RJ Lee Group, Inc., Monroeville, PA

**Shrinkage Cracking** 4:05  
*Kenneth C. Hover*, Professor, Dept. of  
Civil Engineering, Cornell University, Ithaca, NY

**Durability Roundtable** 4:35

---

## SUNDAY, MARCH 25

---

2:00 PM – 5:00 PM

★ **SEISMIC DESIGN OF  
LIQUID-CONTAINING STRUCTURES**

Salon F

Sponsored by Committee 350

Session Moderator: *Nicholas A. Legatos*  
Vice President  
Manager of Engineering  
Preload Inc.  
Hauppauge, NY

Session Co-Moderator: *Charles S. Hanskat*  
Regional Marketing Manager  
DYK, Inc.  
El Cajon, CA

**Introduction** 2:00  
*Charles S. Hanskat*, Regional  
Marketing Manager, DYK, Inc.,  
El Cajon, CA

**Basic Theory** 2:10  
*Nicholas A. Legatos*, Vice President,  
Manager of Engineering, Preload Inc.,  
Hauppauge, NY

**Lateral Force** 2:55  
*M. Reza Kianoush*, Professor, Dept.  
of Civil Engineering, Ryerson Polytechnic  
University, Toronto, ONT, Canada

**Design Examples –  
Rectangular Tanks** 3:30  
*Lawrence G. Mrazek*, LGM Engineers, LLC,  
St. Louis, MO

**Seismic Design of  
Liquid-Containing Structures;  
Design Examples – Circular Tanks** 4:15  
*Larry M. Tabat*, Manager, Structural  
Design, Malcolm Pirnie, Inc., White  
Plains, NY and *Michele M. Zielinski*,  
Project Engineer - Structural Design  
Services, Malcolm Pirnie, Inc., White  
Plains, NY

★ Theme session

---

SUNDAY, MARCH 25

---

2:00 PM – 5:00 PM

**SAFETY ASSESSMENT  
OF EXISTING CONCRETE  
STRUCTURES**

Salon G

Sponsored by Committee 348

Session Moderator: *Andrew Scanlon*  
Professor  
Dept. of Civil Engineering  
Pennsylvania State University  
University Park, PA

Session Co-Moderator: *Hani H. Nassif*  
Assistant Professor  
Dept. of Civil Engineering  
Rutgers University  
Piscataway, NJ

**Probabilistic Approaches to Safety  
Assessment of Existing Concrete  
Structures** 2:00

*Andrew Scanlon*, Professor, Dept.  
of Civil Engineering, Pennsylvania State  
University, University Park, PA

**Existing Bridge Evaluation Criteria  
in the Canadian Highway Bridge  
Design Code** 2:30

*Michael F. Bartlett*, Associate Professor,  
Dept. of Civil & Environmental Engineering,  
University of Western Ontario, London,  
ONT, Canada; *Darrel P. Gagnon*, Senior  
Engineer, Buckland and Taylor, Ltd.,  
North Vancouver, BC, Canada; and  
*Akhilesh C. Agarwal*, Private Consultant,  
Brampton, ONT, Canada

**Measured Live Load in Prestressed  
Concrete Girder Bridges for Safety  
Assessment** 3:00

*Jeffrey A. Laman*, Assistant Professor,  
Dept. of Civil Engineering, Pennsylvania State  
University, University Park, PA

---

SUNDAY, MARCH 25

---

2:00 PM – 5:00 PM

**SAFETY ASSESSMENT  
OF EXISTING CONCRETE  
STRUCTURES** *(Continued)*

**Structural Safety Assessment of  
Ferrocement Sections Under  
Flexural Loads** 3:30

*Hani H. Nassif*, Assistant Professor,  
Dept. of Civil Engineering, Rutgers University,  
Piscataway, NJ

**Resistance Models for Structural  
Safety Assessment of R/C  
Structures** 4:00

*Andrzej S. Nowak*, Professor,  
Dept. of Civil Engineering, University  
of Michigan, Ann Arbor, MI and  
*Maria M. Szerszen*, Assistant  
Research Scientist, Dept. of Civil Engineering,  
University of Michigan, Ann Arbor, MI

**Reliability-Based Assessment of  
Existing Bridges** 4:30

*Joan R. Casas*, Professor, Dept. of  
Civil Engineering, Catalunya Technical  
University, Barcelona, Spain

---

## SUNDAY, MARCH 25

---

6:30 PM – 7:30 PM

### WELCOME RECEPTION

Salons E - H

Hosted by the ACI Delaware Valley Chapter & ACI International

Kick off your convention week with this cash bar reception. Meet your friends and colleagues for a cocktail and light refreshments before going to dinner.

Don't forget to make your dinner reservations for after the Welcome Reception. Philadelphia has hundreds of great restaurants. See the concierge for assistance.

*Note: Beverages for this event must be paid with cash and cannot be charged to your room.*

---

SUNDAY, MARCH 25

---

7:30 PM – 9:30 PM

**HOT TOPIC SESSION:  
STRONG QUAKE ROCKS  
PACIFIC NORTHWEST**

**Salons C & D**

Sponsored by the Hot Topic Committee

Moderator: *H. S. Lew*  
Senior Structural Engineer  
Natl Inst of Stds/Tech  
Gaithersburg, MD

*Speakers to be announced*

Don't miss this report by five prominent structural engineers from the Seattle area on the Nisqually Earthquake that hit the Pacific Northwest.

Reported as the biggest, this quake rocked the Puget Sound at 10:55 a.m. on February 28, 2001. Lasting 30 seconds before subsiding, it registered 6.8 magnitude and was felt as far away as Salt Lake City – 700 miles away!

While no apparent damage of modern buildings was reported, many URM buildings sustained damage. We will hear from the speakers how buildings designed using modern seismic codes and retrofitted buildings performed in this earthquake.

This will be a session you won't want to miss!

*Beverages and refreshments will be  
available for purchase.*

---

MONDAY, MARCH 26

---

7:00 AM – 8:30 AM

**SPEAKER'S TRAINING  
BREAKFAST: INCORPORATING  
VIDEO CLIPS INTO  
POWERPOINT PRESENTATIONS**

Salon E

Sponsored by Committee E903

Session Moderator: *Richard P. Bohan*  
Director of Education and Training  
Portland Cement Assn.  
Skokie, IL

Session Co-Moderator: *James M. Shilstone, Jr.*  
President  
Shilstone Companies, Inc.  
Dallas, TX

**Coffee and pastries will be served  
at 7:00 AM for the first 50 people.**

First there were black and white overheads. Then came slides and color. Still the masses were bored and yearned for more excitement. Finally came the advent of PowerPoint; but the computers crashed. Now, for the first time ever comes VIDEO! Before your very eyes watch this first-time ever presentation in real-time, live-action, full-motion, wide-screen videography. See how video clips and animation can be effortlessly and seamlessly placed into a PowerPoint presentation to get the maximum effect desired.



---

## MONDAY, MARCH 26

---

8:00 AM – 9:00 AM

### STUDENT ORIENTATION SESSION      Salon I

Sponsored by Committee E801 & the ACI Delaware Valley Chapter

Session Moderator:      *DJ Belarbi*  
Professor  
Dept. of Civil Engineering  
University of Missouri - Rolla  
Rolla, MO

Session Co-Moderator:      *Vicki L. Brown*  
Professor  
Widener University  
Dept. of Civil Engineering  
Chester, PA

This session, designed for students, is an overview of the American Concrete Institute – what it is, why it exists, and how it functions. Topics will include ACI's mission, strategic plan, organization, technical and education committee structures, convention format, and other issues that are of special interest to students.

#### **Mentor Program**

At the conclusion of the Orientation Session, mentors will be available to attend committee meetings and technical sessions with interested students. The meetings and sessions are open to all students.

---

# MONDAY, MARCH 26

---

9:00 AM – 12:00 PM

## RESEARCH IN PROGRESS

Salon H

Sponsored by Committee 123

Session Moderator: *Pawan R. Gupta*  
Consulting Engineer  
Halsall Assocs., Ltd.  
Toronto, ONT, Canada

Session Co-Moderator: *W. Jason Weiss*  
Assistant Professor  
Dept. of Civil Engineering  
Purdue University  
West Lafayette, IN

### Introduction

9:00

*Pawan R. Gupta*, Consulting Engineer,  
Halsall Assocs., Ltd., Toronto, ONT,  
Canada

### Presentation of ACI-James

9:01

#### Instruments Student Award for

#### Research in Nondestructive Testing

*Ki Ho Choi*, Consultant, James Instruments,  
Chicago, IL and *Stephen Pessiki*, Associate  
Professor, Dept. of Civil & Environmental  
Engineering, Lehigh University, Bethlehem, PA  
will present the ACI-James Instruments  
Student Award to *Cindy K. Shaw*, Graduate  
Assistant, Dept. of Civil Engineering, University  
of Louisville, Louisville, KY; *Kolluru Subramaniam*,  
Assistant Professor, Dept. of Civil Engineering,  
City University of New York, New York, NY;  
*J. P. Mohsen*, Associate Professor, Dept. of  
Civil Engineering, University of Louisville,  
Louisville, KY; *K. C. Willard*, Graduate Assistant,  
Dept. of Civil Engineering, University of  
Louisville, Louisville, KY; and *Surendra P. Shah*,  
Director, Advanced Cement Based Materials,  
Northwestern University, Evanston, IL for the paper  
titled "Nondestructive Technique for Monitoring  
Strength Gain in Highway Structures."

---

## MONDAY, MARCH 26

---

9:00 AM – 12:00 PM

**RESEARCH IN PROGRESS** (Continued)

**Influence of Tension Strain on  
Buckling in Reinforced Concrete  
Columns** 9:15

*Mervyn Kowalsky*, Assistant Professor,  
Dept. of Civil Engineering, North Carolina  
State University, Raleigh, NC and  
*Matthew J. Moyer*, Graduate Research  
Assistant, Dept. of Civil Engineering, North  
Carolina State University, Raleigh, NC

**Tests of Headed Bar Anchorages in  
Nodes and Lap Slices** 9:30

*Michael K. Thompson*, Graduate  
Research Assistant, Ferguson Structural  
Engineering Laboratory, University of Texas –  
Austin, Austin, TX; *James O. Jirsa*,  
Professor, Dept. of Civil Engineering, University  
of Texas – Austin, Austin, TX; and  
*John E. Breen*, Professor, Ferguson  
Structural Engineering Laboratory, University  
of Texas – Austin, Austin, TX

**Shear Strength of FRP  
Reinforced Concrete Beams** 9:45

*A. Koray Tureyen*, Graduate  
Research Assistant, Dept. of  
Civil Engineering, Purdue University,  
West Lafayette, IN and *Robert J. Frosch*,  
Assistant Professor, Dept. of Civil Engineering,  
Purdue University, West Lafayette, IN

**The Interface Between Concrete  
and Bonded Composite in Combined  
Tension and Shear** 10:00

*Stephen J. Kurtz*, Assistant Professor,  
Dept. of Civil & Environmental  
Engineering, University of Missouri – Columbia,  
Columbia, MO and *Michael Ash*,  
Honors Student, Dept. of Civil Engineering,  
University of Missouri – Columbia,  
Columbia, MO

9:00 AM – 12:00 PM

RESEARCH IN PROGRESS

(Continued)

**Degradation in the Polyester Resin Matrix and E-Glass FRP Bars Embedded in Concrete** 10:15  
*Mohindra S. Thakur*, Graduate Student, Dept. of Civil Engineering, Stevens Institute of Technology, Hoboken, NJ and *Khondokar Y. Billah*, Associate Professor, Dept. of Civil Engineering, Stevens Institute of Technology, Hoboken, NJ

**The Influence of Clamping Stresses on the Shear Response of Concrete Beams** 10:30  
*Almila Uzel*, Graduate Research Assistant, Dept. of Civil Engineering, University of Toronto, Toronto, ONT, Canada; *Evan C. Bentz*, Assistant Professor, Dept. of Civil Engineering, University of Toronto, Toronto, ONT, Canada; and *Michael P. Collins*, Professor, Dept. of Civil Engineering, University of Toronto, Toronto, ONT, Canada

**Fire Testing of FRP Strengthened Concrete Beams** 10:45  
*Luc R. Taerwe*, Professor of Concrete Structures, Director, Dept. of Structural Engineering, Magnel Laboratory for Concrete Research, Ghent University, Ghent, Belgium; *Hendrik Blontrock*, Doctoral Researcher, Dept. of Structural Engineering, Magnel Laboratory of Concrete Research, Ghent University, Ghent, Belgium; and *Paul Vandeveld*, Professor, Dept. of Flow, Heat and Combustion Mechanics, Ghent University, Ghent, Belgium

---

## MONDAY, MARCH 26

---

9:00 AM – 12:00 PM

**RESEARCH IN PROGRESS** (Continued)

**Moisture Control in Concrete Slabs** 11:00

**Using an Innovative Technique**

*Johan L. Silfwerbrand*, Professor,  
Dept. of Structural Engineering, Royal  
Institute of Technology, Stockholm,  
Sweden and *Jonatan Paulsson-Tralla*,  
Stockholm Konsult, Stockholm, Sweden

**Experimental and Analytical** 11:15

**Investigation of Reinforced  
Concrete Slabs with Corroded Bars**

*P. N. Balaguru*, Professor, Dept. of  
Civil Engineering, Rutgers University,  
Piscataway, NJ and *Lan Chung*, Professor,  
Dept. of Civil Engineering, Dan-kook University,  
Seoul, South Korea

**Mechanical and Shrinkage** 11:30

**Characteristics of Concrete Containing  
Ultra-Fine Fly Ash**

*Kolluru Subramaniam*, Assistant Professor,  
Dept. of Civil Engineering, City University of  
New York, New York, NY; *Roman Gromotka*,  
Dipl. Ing., Basic Engrg (BE-CV), Krupp  
Uhde GmbH/Thyssenkrupp AG, Dortmund,  
Germany; *Surendra P. Shah*, Director,  
Advanced Cement-Based Materials, Dept. of  
Civil Engineering, Northwestern University,  
Evanston, IL; *Karthikeyan H. Obla*,  
Engineering Supervisor, R & D, Boral  
Material Technologies, Inc., San Antonio, TX;  
and *Russell Hill*, Vice President, Technology  
Development Group, Boral Material  
Technologies, Inc., San Antonio, TX

**Freezing and Thawing Resistance** 11:45

**of Dry Compacted Segmental  
Retaining Wall Units**

*Kevin A. MacDonald*, Vice President,  
Engineering Services Dept., Cemstone  
Concrete Products, Mendota Heights, MN  
and *Mark R. Lukkarila*, Chief Petrographer,  
Braun Intertec Corporation, Minneapolis, MN

9:00 AM – 12:00 PM

★ **STRENGTH AND  
CONSTRUCTIBILITY OF  
CONCRETE PAVEMENTS,  
OVERLAYS, AND REPAIRS:  
PART 1**

Salon E

Sponsored by Committee 325

Session Moderator: *Norbert J. Delatte*  
Assistant Professor  
Dept. of Civil & Environmental Engineering  
University of Alabama - Birmingham  
Birmingham, AL

Session Co-Moderator: *Neeraj Buch*  
Assistant Professor  
Dept. of Civil & Environmental Engineering  
Michigan State University  
East Lansing, MI

**Introduction** 9:00  
*Norbert J. Delatte*, Assistant Professor,  
Dept. of Civil & Environmental Engineering,  
University of Alabama - Birmingham,  
Birmingham, AL

**The Concrete Mixture – The Key to  
Pavement Construction Economy  
and Long-Term Performance** 9:05  
*James M. Shilstone, Sr.*, Chairman,  
The Shilstone Companies, Inc., Dallas, TX  
and *James M. Shilstone, Jr.*, President,  
The Shilstone Companies, Inc., Dallas, TX

**Jointed Concrete Pavements for  
Streets and Local Roads** 9:35  
*Dan G. Zollinger*, Associate Professor,  
Dept. of Civil Engineering, Texas A&M  
University, College Station, TX

★ Theme session

---

## MONDAY, MARCH 26

---

9:00 AM – 12:00 PM

★ **STRENGTH** (Continued)  
**AND CONSTRUCTIBILITY**  
**OF CONCRETE PAVEMENTS,**  
**OVERLAYS, AND REPAIRS:**  
**PART 1**

**Investigation of Dowel Bar** 10:05  
**Retrofitting on PCC Pavement**  
**Responses**

*Jacob E. Hiller*, Graduate Research  
Assistant, Dept. of Civil & Environmental  
Engineering, University of Illinois, Urbana, IL  
and *Neeraj Buch*, Assistant Professor,  
Dept. of Civil Engineering, Michigan State  
University, East Lansing, MI

**Evaluation of Non-Metallic Fiber** 10:35  
**Reinforced Concrete in New Full**  
**Depth PCC Pavements**

*Clifford N. MacDonald*, Technical Service  
Specialist, Corrosion Protection Dept.,  
3M Company, St. Paul, MN;  
*Venkataswamy Ramakrishnan*, Regent's  
Distinguished Professor, Dept. of Civil Engineering,  
South Dakota School of Mines & Technology,  
Rapid City, SD; *Daniel Strand*, Project  
Engineer, Research Dept., South Dakota  
Dept. of Transportation, Pierre, SD; and  
*K. P. Ramesh*, Doctoral Student, South Dakota  
School of Mines & Technology, Rapid City, SD

**Effect of Curing and Other Factors** 11:05  
**on Early-Age Cracking**

*Erika E. Holt*, Research Scientist,  
VTT Building Technology, Technical  
Research Centre of Finland, Espoo,  
Finland; *Markku Leivo*, Group Manager,  
Concrete and Stone Materials Group,  
VTT Building Materials Division,  
Technical Research Centre of Finland,  
Espoo, Finland; and *Donald J. Janssen*,  
Associate Professor, Dept. of Civil Engineering,  
University of Washington, Seattle, WA

★ Theme session

---

MONDAY, MARCH 26

---

9:00 AM – 12:00 PM

★ STRENGTH (Continued)  
AND CONSTRUCTIBILITY  
OF CONCRETE PAVEMENTS,  
OVERLAYS, AND REPAIRS:  
PART 1

Concrete Pavement Performance 11:35  
in the Southeast U.S.

*Norbert J. Delatte*, Assistant Professor,  
Dept. of Civil & Environmental Engineering,  
University of Alabama - Birmingham,  
Birmingham, AL



---

## MONDAY, MARCH 26

---

9:00 AM – 12:00 PM

★ **CONSTRUCTIBILITY** Salon F  
**OF BRIDGES – CONCEPT TO**  
**COMPLETION: PART 1**

Sponsored by Committees 343 & 345

Session Moderator: *Alan B. Matejowsky*  
Senior Structural Engineer  
Parsons Brinckerhoff Quade and Douglas  
Austin, TX

Session Co-Moderator: *Jeffrey P. Wouters*  
Senior Engineer  
WDP & Associates, Inc.  
Austin, TX

**Design and Construction of** 9:00  
**I-15/US 95 Interchange (The Spaghetti**  
**Bowl)**  
*Juan Murrilo*, Senior Vice President,  
Parsons Brinckerhoff Quade and Douglas,  
San Francisco, CA

**Strengthening of Pile-Supported** 9:30  
**Concrete Aircraft Taxiways Over**  
**Water**  
*Frank B. Krupicka*, Associate Structural  
Engineer, Engineering Dept., The Port  
Authority of NY & NJ, New York, NY;  
*Joseph M. Englot*, Chief Structural Engineer,  
Engineering Dept., The Port Authority  
of NY & NJ, New York, NY; and  
*Ralph J. D'Apuzzo*, Senior Engineer,  
Engineering Dept., The Port Authority of  
NY & NJ, New York, NY

**Cable-Stayed Erection of Concrete** 10:00  
**Arch Bridges**  
*W. Scott McNary*, Vice President,  
Finley McNary Engineers, Inc.,  
Broomfield, CO and *Thomas W. Stelmack*,  
Regional Bridge Engineer, Finley McNary  
Engineers, Inc., Broomfield, CO

★ Theme session

9:00 AM – 12:00 PM

★ **CONSTRUCTIBILITY** (Continued)  
**OF BRIDGES – CONCEPT TO**  
**COMPLETION: PART 1**

US 183 Elevated Expressway 10:30  
Construction

*Dean Van Landuyt*, Senior Design  
Engineer, Bridge Division, Texas  
Dept. of Transportation, Austin, TX

The Lindbergh Bridge: 11:00  
Rehabilitation of A Historic  
Open Spandrel Arch Bridge

*David A. Whong*, Project Manager,  
McCormick, Taylor & Associates,  
Malvern, PA and *Sandra G. Detterline*,  
Project Manager, McCormick, Taylor  
& Associates, Malvern, PA

Reconstructing Salt Lake City's 11:30  
I-15 with Design-Build Options

*Robert B. Anderson*, Senior Structural  
Engineer, URS Corporation, Tampa, FL

---

## MONDAY, MARCH 26

---

9:00 AM – 12:00 PM

**TECHNICAL COMMITTEE** Salon G  
**CHAIR TRAINING SESSION**

Sponsored by the Technical Activities Committee

Session Moderator: *Julio A. Ramirez*  
Professor/Assistant Head  
Graduate Programs  
School of Civil Engineering  
Purdue University  
West Lafayette, IN

Session Co-Moderator: *Om P. Dixit*  
Vice President  
DMJM + Harris, Inc.  
New Orleans, LA

*Timothy L. Moore*  
Senior Engineer  
San Diego Gas & Electric  
San Diego, CA

**Introduction** 9:00

*Julio A. Ramirez*, Professor/Assistant  
Head, Graduate Programs, School of  
Civil Engineering, Purdue University,  
West Lafayette, IN

**Getting Your Act Together** 9:05

*Sharon L. Wood*, Professor, Dept.  
of Civil Engineering, University of  
Texas - Austin, Austin, TX

**How to Run a Committee Meeting** 9:25

*Sharon L. Wood*, Professor, Dept.  
of Civil Engineering, University of  
Texas - Austin, Austin, TX

**How to Build Your Committee** 9:40

*Om P. Dixit*, Vice President,  
DMJM + Harris, Inc., New Orleans, LA

**Developing and Submitting  
Committee Documents** 10:00

*Julio A. Ramirez*, Professor/Assistant  
Head, Graduate Programs, School of Civil  
Engineering, Purdue University, West Lafayette, IN

---

MONDAY, MARCH 26

---

9:00 AM – 12:00 PM

**TECHNICAL COMMITTEE** (Continued)  
**CHAIR TRAINING SESSION**

**Balloting Committee Documents** 10:25  
*Charles W. Dolan*, Professor, Dept.  
of Civil Engineering, University of Wyoming,  
Laramie, WY

**TAC Document Review** 10:55  
*Nicholas J. Carino*, Research  
Structural Engineer, National Institute  
of Standards and Technology,  
Gaithersburg, MD

**How to Develop Technical Sessions** 11:15  
*Nicholas J. Carino*, Research  
Structural Engineer, National Institute  
of Standards and Technology,  
Gaithersburg, MD

**ACI Staff Support** 11:35  
*Om P. Dixit*, Vice President,  
DMJM + Harris, Inc., New Orleans, LA

**Questions & Answers** 11:45

---

## MONDAY, MARCH 26

---

11:30 AM – 1:00 PM

SESSION MODERATOR Salon K  
ORIENTATION WORKSHOP

Sponsored by Committee E903

Session Moderator: *David G. Kittridge*  
Principal Engineer  
Maitland, FL

The purpose of this workshop is to review the session moderator's role in leading quality sessions at ACI conventions. The review includes the Session Moderator Orientation Packet and the duties of the ACI session moderator. You will also learn how to motivate your speakers and the best methods of communicating with ACI.

This workshop will also be presented on Sunday, March 25,  
11:30 AM – 1:00 PM in Salon K.

All moderators of convention sessions are required by TAC and EAC to attend one of these orientation workshops. If you know that you will be a moderator for a session at a future convention, and have not yet attended one of the workshops, please attend this session on Sunday or Monday.

---

MONDAY, MARCH 26

---

12:00 PM – 2:00 PM

✓ STUDENT LUNCHEON  
\$36 per person

Liberty A

Sponsored by E801 & the ACI Delaware Valley Chapter

After lunch, awards will be given for the Student Egg Protection Device Competition.



Speaker: D. Kirk Harman  
President  
Cagley, Harman & Associates  
King of Prussia, PA

Topic: A Case Study in Constructibility

Mr. Harman is the president of the engineering firm Cagley, Harman & Associates, which was the structural engineer for the Philadelphia Marriott Hotel. He will review the constructibility challenges the design team encountered on the project and the engineering solutions implemented to address those challenges.

As a special part of the luncheon,  
the Educational Activities Committee will  
honor Om P. Dixit as the  
“2000 Educational Committee Member of the Year.”

*MENU*

*Caesar Salad  
Grilled Tuscan Chicken with  
Natural Sauce and Red Onion Marmalade  
Chef Selection of Pasta  
Sauteed Zucchini and Squash  
Fresh Baked Rolls and Butter  
Spice Cake with Caramelized Peaches  
and Fresh Whipped Cream  
Coffee, Tea, Decaf  
Ice Tea*

*Tickets may be purchased at the ACI Registration Desk  
until 24 hours prior to the event. Please notify the ACI  
Registration Desk if you have any dietary restrictions.*

✓ Separate fee required

---

MONDAY, MARCH 26

---

2:00 PM – 5:00 PM

★ STRENGTH AND  
CONSTRUCTIBILITY OF  
CONCRETE PAVEMENTS,  
OVERLAYS, AND REPAIRS:  
PART 2

Salon E

Sponsored by Committee 325

Session Moderator: *Norbert J. Delatte*  
Assistant Professor  
Dept. of Civil & Environmental Engineering  
University of Alabama - Birmingham  
Birmingham, AL

Session Co-Moderator: *Neeraj Buch*  
Assistant Professor  
Dept. of Civil & Environmental Engineering  
Michigan State University  
East Lansing, MI

**Introduction** 2:00  
*Norbert J. Delatte*, Assistant Professor,  
Dept. of Civil & Environmental Engineering,  
University of Alabama - Birmingham,  
Birmingham, AL

**Accelerated Load Facility (ALF)** 2:05  
**Test of Ultra-Thin Whitetopping**  
*James A. Sherwood*, FHWA, Office of Research,  
Development and Technology, McLean, VA;  
*Mauricio Ruiz*, Project Manager, Transtec  
Consultants, Austin, TX; *Robert Rasmussen*,  
Chief Engineer/Vice President, Transtec Consultants,  
Austin, TX; and *Xicheng Qi*, Highway Engineer,  
Salut, Inc., Beltsville, MD

**High-Performance Bonded Concrete** 2:35  
**Overlays**  
*Norbert J. Delatte*, Assistant Professor,  
Dept. of Civil & Environmental Engineering,  
University of Alabama - Birmingham,  
Birmingham, AL

★ Theme session

2:00 PM – 5:00 PM

★ STRENGTH AND  
CONSTRUCTIBILITY OF  
CONCRETE PAVEMENTS,  
OVERLAYS, AND REPAIRS:  
PART 2

(Continued)

Corps of Engineers Experience  
with Partially Bonded Overlays 3:05  
*David Pittman*, Deputy Director,  
Geotechnical and Structures Laboratory,  
U.S. Army Engineer Research and  
Development Center, Vicksburg, MS

Rehabilitation of Deteriorated 3:35  
Bridge Decks with Ultra-Thin  
High-Performance Fiber-Reinforced  
Concrete Overlays  
*Venkataswamy Ramakrishnan*, Regent's  
Distinguished Professor, Dept. of Civil Engineering,  
South Dakota School of Mines and Technology,  
Rapid City, SD; *Clifford N. MacDonald*,  
Technical Service Specialist, Corrosion Protection  
Dept., 3M Company, St. Paul, MN; *Daniel Strand*,  
Project Engineer, Research Dept., South Dakota  
Department of Transportation, Pierre, SD; and  
*K. P. Ramesh*, Doctoral Student, South Dakota  
School of Mines & Technology, Rapid City, SD

Towards a Mechanistic Design 4:05  
Procedure for Bonded Concrete  
Overlays  
*Ramy S. Abdalla*, Graduate Research  
Assistant, Dept. of Civil & Environmental  
Engineering, University of Alabama – Birmingham,  
Birmingham, AL

★ Theme session



---

MONDAY, MARCH 26

---

2:00 PM – 5:00 PM

★ STRENGTH AND  
CONSTRUCTIBILITY OF  
CONCRETE PAVEMENTS,  
OVERLAYS, AND REPAIRS:  
PART 2

(Continued)

First UTW Runway at Savannah  
Tennessee

4:35

*Greg Dean*, Executive Director,  
ACPA - SE, Cary, NC; *Jim Norris*,  
Tennessee Consultant, ACPA - SE,  
Murfreesboro, TN; *Ron Fitzgerald*,  
Project Manager, Aeronautics Division,  
Tennessee Department of Transportation,  
Nashville, TN; and *Tony Mancini*,  
Vice President, Barge Waggoner  
Sumner & Cannon, Nashville, TN

2:00 PM – 5:00 PM

**NONDESTRUCTIVE  
TESTING OF MASS  
CONCRETE STRUCTURES**

Salon G

Sponsored by Committees 207 & 228

Session Moderator: *William F. Kepler*  
Civil Engineer  
Material Engineering & Research Laboratory  
U.S. Bureau of Reclamation  
Denver, CO

Session Co-Moderator: *Caroline Mohorovic*  
Civil Engineer  
Material Engineering & Research Laboratory  
U.S. Bureau of Reclamation  
Denver, CO

**Introduction** 2:00  
*William F. Kepler*, Civil Engineer,  
Material Engineering & Research Laboratory,  
U.S. Bureau of Reclamation, Denver, CO

**Ultrasonic Methods for Mass  
Concrete Assessment: The Benefits  
and the Pitfalls** 2:10  
*Bernard H. Hertlein*, Associate, Head,  
Nondestructive Testing & Geophysics  
Group, STS Consultants, Ltd.,  
Vernon Hills, IL

**Reclamation's Experience with  
Nondestructive Testing of Mass  
Concrete Structures** 2:30  
*William F. Kepler*, Civil Engineer,  
Material Engineering & Research Laboratory,  
U.S. Bureau of Reclamation, Denver, CO;  
*Caroline Mohorovic*, Civil Engineer,  
Material Engineering & Research Laboratory,  
U.S. Bureau of Reclamation, Denver, CO;  
and *Erin Gleason*, U.S. Bureau of  
Reclamation, Materials Engineering & Research  
Laboratory, Denver, CO

---

## MONDAY, MARCH 26

---

2:00 PM – 5:00 PM

### NONDESTRUCTIVE TESTING OF MASS CONCRETE STRUCTURES

(Continued)

#### Sonic Pulse Velocity Testing to Assess Condition of a Concrete Dam

2:50

*Edward (Ned) D. Billington*, Associate,  
AG&E-Schnabel, Greensboro, NC;  
*Dennis A. Sack*, Project Manager,  
Olson Engineering, Inc., Wheat Ridge, CO;  
and *Larry D. Olson*, President/Principal  
Engineer, Olson Engineering, Inc.,  
Wheat Ridge, CO

#### Nondestructive Evaluation of Concreting Problems in Some Large-Volume Structures

3:10

*Allen G. Davis*, Senior Principal Engineer,  
Manager, Nondestructive Evaluation,  
Construction Technology Labs, Inc.,  
Skokie, IL and *Malcolm K. Lim*, Project  
Manager, Construction Technology  
Labs, Inc., Skokie, IL

#### Application of NDT Techniques to Some Mass Concrete Structures Problems

3:30

*Jamal Rhazi*, Research Engineer,  
Dept. of Civil Engineering, University of  
Sherbrooke, Sherbrooke, QUE, Canada

#### NDE Applications for Concrete Dams

3:50

*Larry D. Olson*, President/Principal  
Engineer, Olson Engineering, Inc.,  
Wheat Ridge, CO

2:00 PM – 5:00 PM

★ **CONSTRUCTIBILITY** Salon F  
**OF BRIDGES: CONCEPT TO**  
**COMPLETION: PART 2**

Sponsored by Committees 343 & 345

Session Moderator: *Alan B. Matejowsky*  
Senior Structural Engineer  
Parsons Brinckerhoff Quade and Douglas  
Austin, TX

Session Co-Moderator: *Jeffrey P. Wouters*  
Senior Engineer  
WDP & Associates, Inc.  
Austin, TX

**Reconstruction of the Pierce** 2:00  
**Elevated Expressway Using**  
**Precast Elements**

*Kenny Ozuna*, Assistant District  
Bridge Engineer, Houston District,  
Texas Department of Transportation,  
Houston, TX

**Spliced Pretensioned/** 2:30  
**Post-Tensioned Precast Concrete**  
**Bridges**

*George N. Tsiouvaras*, Associate,  
Carter & Burgess, Inc., Denver, CO  
and *Harry J. Jasper*, Associate,  
Carter & Burgess, Inc., Denver, CO

**The Big I Interchange in** 3:00  
**Albuquerque**

*Ralph J. Salamie*, Project Manager,  
Kiewit, Albuquerque, NM

**Long Span Post-Tensioned Concrete** 3:30  
**Haunched Slab Bridges**

*Loren R. Risch*, Bridge Design  
Engineer, State Bridge Office, Kansas  
Department of Transportation, Topeka, KS

---

## MONDAY, MARCH 26

---

2:00 PM – 5:00 PM

★ **CONSTRUCTIBILITY** (Continued) ★  
**OF BRIDGES: CONCEPT TO**  
**COMPLETION: PART 2**

**Combination of Cast-in-Place** 4:00  
**and Precast Concrete Elements**  
**in Bridge Construction**

*Jaro Simek*, Associate Bridge Engineer,  
Engineering Department, Caltrans,  
Fair Oaks, CA

**Development of Longer Prestressed** 4:30  
**Concrete Girders with Incremental**  
**Prestressing**

*Man Yop Han*, Professor, Dept. of Civil  
Engineering, Ajou University, Kyonggido,  
Korea and *Eui Seung Hwang*, Professor,  
Dept. of Civil Engineering, Kyunghee University,  
Kyonggido, Korea

★ Theme session

2:00 PM – 5:00 PM

**REHABILITATION AND  
REPAIR OF CONCRETE –  
HOT INDUSTRY ISSUES:  
PART 1**

Salon H

Sponsored by Committee 364

Session Moderator: *Douglas Burke*  
Materials Engineer  
Naval Facilities Engineering Service Center  
(NFESC)  
Port Hueneme, CA

**Shrinkage-Compensating  
Mechanisms of Repair Materials** 2:00  
*Benoit Bissonnette*, Research Associate,  
Dept. of Civil Engineering, Laval University,  
Sainte-Foy, QUE, Canada

**Some Concerns with Repair of  
Cracks in Concrete and Concrete  
Repair** 2:30  
*Tate Coverdale*, Director, Product  
Technologies, Research and Development  
Dept., Master Builders, Inc.,  
Cleveland, OH

**Experiences in Rehabilitation  
of Concrete in Egypt Using FRP** 3:00  
*Ibrahim M. Mahfouz*, Professor,  
Dept. of Structural Engineering, Vice Dean,  
Faculty of Engineering, Zagazig University,  
Cairo, Egypt

**Pull-Off Bond Test – A Quality  
Control Tool** 3:30  
*James E. McDonald*, Research Civil  
Engineer, Corps of Engineers,  
Vicksburg, MS and *Alexander M. Vaysburd*,  
Principal, Vaycon Consulting, Baltimore, MD

---

MONDAY, MARCH 26

---

2:00 PM – 5:00 PM

REHABILITATION AND  
REPAIR OF CONCRETE –  
HOT INDUSTRY ISSUES:  
PART 1

(Continued)

Galvanic Protection for Rebar in  
Concrete Repair 4:00

*J. Chris Ball*, Vector Corrosion  
Technologies, Medina, OH and  
*David W. Whitmore*, Vice President,  
Vector Corrosion Technologies,  
Winnipeg, MAN, Canada

Technical Data Guide 4:30  
Specification

*Fred R. Goodwin*, Senior Development  
Scientist, Master Builders, Inc.,  
Cleveland, OH

---

**MONDAY, MARCH 26**

**5:00 PM – 6:00 PM**

**WOMEN IN ACI**

**Ind 3**

Join other ACI women for this informal reception and networking opportunity. Refreshments will be served.





---

MONDAY, MARCH 26

---

6:30 PM – 8:00 PM

CONCRETE MIXER –  
*Building a Nation*

Grand

Hosted by the ACI Delaware Valley Chapter

Join us in the Grand Hall at the Reading Train Shed. Enjoy lively conversation with our forefathers while sampling hors d'oeuvres and spirits.

Scheduled entertainment for the evening will include:



6:30 PM  
*The Fralinger String  
Quartet*

7:30 PM  
*Mummers*

8:00 PM  
*Ben Franklin*

---

TUESDAY, MARCH 27

---

7:00 AM – 8:30 AM

**COMMITTEE CHAIRMAN  
TRAINING BREAKFAST:  
TIMELINES & PLANNING  
GUIDELINES**

Salon G

Sponsored by Committee E903

Session Moderator: *David G. Kittridge*  
Principal Engineer  
Maitland, FL

Coffee and pastries will be served at  
7:00 AM for the first 50 people.

A plan is nothing without a timeline. This session is a must for committee chairmen who want to learn about realistic timelines and planning guidance.

ACI committee chairmen won't want to miss out on this unique opportunity to "get a clue" by getting a plan.

---

## TUESDAY, MARCH 27

---

7:30 AM – 8:30 AM

**CHAPTER FORUM –**  
*Getting Chapters Involved  
with Students*

Salon I

Sponsored by the Chapter Activities Committee

Session Moderator: *Richard D. Stehly*  
Principal  
American Engineering Testing, Inc.  
St. Paul, MN

**A Concrete Way to Reach the** 7:30  
**the Local Community**  
*Clifford N. MacDonald*, Technical  
Service Specialist, 3M, St. Paul, MN  
and *Robert J. MacDonald*, Vigilant  
Enterprise, Inver Grove Heights, MN

**Reaching Out to the Next** 8:00  
**Generation: Concrete Kits for Kids**  
*Luke M. Snell*, Professor of Construction  
and Director, Concrete Construction  
Resource Unit, Southern Illinois  
University, Edwardsville, IL and  
*Billie G. Snell*, Research Assistant and  
Educational Specialist, Concrete  
Construction Resource Unit, Southern  
Illinois University, Edwardsville, IL

### PARTICIPANTS

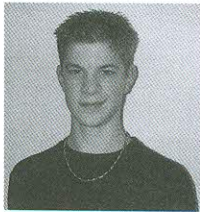

*Robert J. MacDonald*  
Vigilant Enterprise  
Inver Grove Heights, MN



*Nathaniel Brown*  
Fugett Middle School  
West Chester, PA



*Peter Byrne*  
Fugett Middle School  
West Chester, PA

9:00 AM – 12:00 PM

★ **CONTRACTORS' DAY:** Salon G  
**PART 1; CONSTRUCTIBILITY –  
DESIGN TO CONSTRUCTION;  
PROBLEMS & SOLUTIONS**

Sponsored by the ACI Delaware Valley Chapter

Session Moderator: *William A. Gillespie*  
Senior Structural Engineer  
Kling Lingquist  
Philadelphia, PA

Session Co-Moderator: *J. Paul Hobelmann*  
Structural Design Principal/Associate  
Kling Lindquist  
Washington, DC

**Constructibility Issues in the** 9:00  
**Field Erection of Precast/Prestressed  
Concrete**

*Aaron M. Vnuk*, Project Manager,  
Precast Services, Inc., Twinsburg, OH

**Constructibility of Precast/Prestressed** 9:30  
**Concrete: Keys to the Successful  
Precast/Prestressed Concrete Projects**

*Douglas L. Lorah*, Vice President,  
High Concrete Structures, Inc.,  
Denver, PA

**Constructibility – The Concrete** 10:00  
**Contractor**

*Al E. Engleman*, Owner, Engleman  
Construction, Inc., Macungie, PA

**Constructibility – Impact on** 10:30  
**Concrete Mix Designs**

*Ross S. Martin*, Vice President,  
Baker Concrete, Construction, Naples, FL

**Designing for Constructibility** 11:00

*Allen J. Hulshizer*, Consulting  
Structural Engineer, Glenside, PA

**Constructibility – Concept to Completion** 11:30

*Frank O'Connor*, Vice President/Project  
Executive, Turner Construction Company,  
Philadelphia, PA

★ Theme session

---

TUESDAY, MARCH 27

---

9:00 AM – 12:00 PM

**REHABILITATION AND  
REPAIR OF CONCRETE –  
HOT INDUSTRY ISSUES:  
PART 2** Salon H

Sponsored by Committee 364

Session Moderator: *Michael L. Brainerd*  
Principal  
Simpson Gumpertz Heger, Inc.  
Arlington, MA

**Worldwide Concrete Repair  
Manual – 2002** 9:00  
*Peter H. Emmons*, President,  
Structural Preservation Systems,  
Hanover, MD

**ACI Recent Activities in  
Concrete Repair/Rehabilitation** 9:30  
*Randall W. Poston*, Principal,  
WDP & Associates, Inc., Austin, TX

**Modulus of Elasticity of Repair  
Material – How Important Is It?  
Point of View** 10:00  
*Pritpal S. Mangat*, Head, Civil Engineering  
and Constr., Sheffield, United Kingdom;  
*James Warner*, Consulting Engineer,  
Mariposa, CA; and *Alexander M. Vaysburd*,  
Principal, Vaycon Consulting, Baltimore, MD

**How to Minimize Cost Overruns  
on Concrete Repair Projects** 10:30  
*Ronald E. Heffron*, Partner,  
Han-Padron Associates, Long Beach, CA  
and *Douglas Burke*, Materials Engineer,  
Naval Facilities Engineering Service Center  
(NFESC), Port Hueneme, CA

**Floor Coatings for Aviation  
Facilities** 11:00  
*Dave Gaughen*, Research Chemist,  
Naval Facilities Engineering Service  
Center (NFESC), Port Hueneme, CA

---

TUESDAY, MARCH 27

---

9:00 AM – 12:00 PM

★ **MECHANICAL SPLICES  
IN SEISMIC AND BLAST  
APPLICATIONS**

Salon E

Sponsored by Committees 370 & 439

Session Moderator: *Hanns U. Baumann*  
President  
Baumann Engineering  
Newport Beach, CA

Session Co-Moderator: *Allen J. Hulshizer*  
Consulting Structural Engineer  
Glenside, PA

**Introduction** 9:00  
*Hanns U. Baumann*, President,  
Baumann Engineering,  
Newport Beach, CA

**Relationship Between Strength  
and Ductility for Mechanical  
Splices** 9:05  
*Conrad Paulson*, Consultant, Wiss  
Janney Elstner Assocs., Chicago, IL

**ACI 439 Seismic Splice  
Performance Report Considerations** 9:30  
*Allen J. Hulshizer*, Consulting Structural  
Engineer, Glenside, PA

**The Performance of Mechanical  
Splices Under Monotonic and  
Cyclic Loading** 9:50  
*Steven L. McCabe*, Chairman, Dept. of  
Civil Engineering and Environmental  
Engineering, University of Kansas,  
Lawrence, KS and *B. Ge*, Doctoral Candidate,  
Dept. of Civil Engineering and Environmental  
Engineering, University of Kansas, Lawrence, KS

★ Theme session

9:00 AM – 12:00 PM

★ **MECHANICAL SPLICES  
IN SEISMIC AND BLAST  
APPLICATIONS** (Continued)

**Strength, Utility, Economic and  
Schedule Achievements with  
Mechanical Splices** 10:10

*Allen J. Hulshizer*, Consulting Structural  
Engineer, Glenside, PA

**Performance of Mechanical  
Connections of 2/3 Scaled  
SIFCON Hinges Tested** 10:30

**Under Quasi-Static Loading**  
*Bryan Wood*, BE&K Engineering and  
Construction, Birmingham, AL and  
*John Hanson*, Distinguished Professor,  
Dept. of Civil Engineering, North Carolina State  
University, Raleigh, NC

**Recent Advances in the Design  
and Construction of Precast Concrete  
Seismic Resistant Systems for  
High-Rise Buildings, Tall Retaining  
Walls and Long Span Bridges** 10:50

*Hanns U. Baumann*, President, Baumann  
Engineering, Newport Beach, CA

**Suggested Improvements in  
Seismic and Blast Design** 11:10

*Bob Smith*, Erico International, Solon, OH;  
*L. Colarusso*, Erico International,  
Solon, OH; and *W. Gene Corley*,  
Vice President, Construction Technology  
Labs, Inc., Skokie, IL

**Technical Assessment of  
Mechanical Splices in Blast  
Resistant Concrete Structures** 11:30

*William H. Zehrt*, Chief, Structural  
Branch, U.S. Army Engineering and  
Support Center - Huntsville,  
Huntsville, AL

9:00 AM – 12:00 PM

**EVALUATION &  
REHABILITATION OF  
HISTORIC CONCRETE  
BRIDGES**

Salon F

Sponsored by Committee 342

Session Moderator: *Om P. Dixit*  
Vice President  
DMJM+Harris, Inc.  
New Orleans, LA

Session Co-Moderator: *Angel E. Herrera*  
CMA Architects & Engineers  
San Juan, PR

**Guidelines for Preservation of  
Historic Concrete Bridges** 9:00

*Deborah Slaton*, Architect Conservator,  
Wiss Janney Elstner Associates, Inc.,  
Northbrook, IL and *Gary J. Klein*,  
Principal, Wiss Janney Elstner  
Associates, Inc., Northbrook, IL

**Evaluation and Retrofit of  
Historic Concrete Arch Bridges  
in California** 9:30

*Ahmad Abdel-Karim*, Senior Bridge  
Engineer, DMJM+Harris, Sacramento,  
CA; *Thomas R. Barnard*, Vice President,  
DMJM+Harris, Sacramento, CA; and  
*Neil Harris*, Vice President, DMJM+Harris,  
Sacramento, CA

**Load Testing Marsh Arch Bridges** 10:00

*F. Wayne Klaiber*, Professor, Dept. of  
Civil & Constr. Engineering, Iowa  
State University, Ames, IA and  
*Terry J. Wipf*, Professor, Dept. of Civil &  
Constr. Engineering, Iowa State University,  
Ames, IA



---

TUESDAY, MARCH 27

---

9:00 AM – 12:00 PM

**EVALUATION &  
REHABILITATION OF  
HISTORIC CONCRETE  
BRIDGES**

(Continued)

**Evaluation of Historic Arch  
Bridges in Spain**

10:30

*Joan Ramon Casas*, Professor, Dept. of  
Civil Engineering, Technical University of  
Catalunya, Barcelona, Spain

**Repair and Upgraded Historic  
Bridge Decks with Carbon/Epoxy  
Laminates**

11:00

*Ayman S. Mosallam*, Professor, Division  
of Engineering, California State University,  
Fullerton, CA and *Medhat A. Haroun*,  
Professor, Dept. of Civil and Environmental  
Engineering, University of California, Irvine, CA

**Swedish Bridges – A Forgotten  
Cultural Treasure**

11:30

*Johan L. Silfwerbrand*, Professor,  
Dept. of Structural Engineering, Royal  
Institute of Technology, Stockholm,  
Sweden

---

TUESDAY, MARCH 27

---

12:00 PM – 2:00 PM

✓ **CONTRACTORS' DAY LUNCHEON**    Liberty A  
\$38 per person

Hosted by: The Construction Liaison Committee (CLC) & the  
ACI Delaware Valley Chapter

Speaker: *Kenneth C. Hover*  
Professor  
Cornell University  
Ithaca, NY



Topic: Air Entrainment in  
Concrete: Constructibility  
Issues

Casting durable, air-entrained concrete only begins with mix design and admixtures – it ends with mixing, transport, placing, consolidation, and finishing. Hear how these steps can affect air content and bubble size. The end result depends on construction technique and on testing.

**MENU**

*Field Greens with Tomatoes, Black Olives, Red Onion  
and Basil Vinaigrette*  
*Grilled Filet Mignon with Balsamic Demi Glace  
and Red Onion Confit*  
*Baked Potato and Seasonal Vegetables*  
*Fresh Baked Rolls and Butter*  
*Cheesecake*  
*Coffee, Tea, Decaf*  
*Ice Tea*

*Tickets may be purchased at the ACI Registration Desk  
until 24 hours prior to the event. Please notify the ACI  
Registration Desk if you have any dietary restrictions.*

✓ Separate fee required

2:00 PM – 5:00 PM

★ **CONTRACTORS' DAY:  
PART 2; CONSIDERATIONS  
FOR PLANNED PROJECTS –  
DISCUSSION OF CONSTRUCTIBILITY  
ISSUES FROM CAST-IN-PLACE,  
PRECAST, DESIGN AND CONSTRUCTION  
MANAGEMENT PERSPECTIVES**

Salon G

Sponsored by the ACI Delaware Valley Chapter

Session Moderator: *William A. Gillespie*  
Senior Structural Engineer  
Kling Lindquist  
Philadelphia, PA

Session Co-Moderator: *J. Paul Hobelmann*  
Structural Design Principal/Associate  
Kling Lindquist  
Washington, DC

This afternoon session will be a panel discussion featuring the speakers from the morning session. A brief summary of each speaker's presentation will be given followed by an open question and answer period with the audience.

★ Theme session

**2:00 PM – 5:00 PM**

**RECENT ADVANCES IN  
THE SEISMIC-RESISTANT  
DESIGN OF CONCRETE BRIDGES**

**Salon E**

Sponsored by Committee 341

Session Moderator     *Eric B. Williamson*  
Assistant Professor  
Dept. of Civil Engineering  
University of Texas  
Austin, TX

Session Co-Moderator:     *Sarah L. Billington*  
Assistant Professor  
Dept. of Civil & Environmental Engineering  
Cornell University  
Ithaca, NY

**Improved Seismic Details for  
Concrete Highway Bridges**     **2:00**  
*James E. Roberts*, Chief Deputy  
Director, Operations, California Department  
of Transportation, Sacramento, CA

**Seismic Strategies for Long  
Jointless Bridges**     **2:30**  
*Paul Gauvreau*, Principal, J. Muller  
International Bridge Engineers,  
New York, NY

**Screening, Seismic Evaluation and  
Retrofit of Concrete Cantilever  
Retaining Walls**     **3:00**  
*Kenneth L. Fishman*, Geotechnical  
Engineer, McMahan & Mann Consulting  
Engrs., P.C., Buffalo, NY

**Uncertainties in Performance  
Estimates of RC Bridge Columns**     **3:30**  
*Marc Eberhard*, Associate Professor,  
Dept. of Civil & Environmental Engineering,  
University of Washington, Seattle, WA

---

TUESDAY, MARCH 27

---

2:00 PM – 5:00 PM

**RECENT ADVANCES IN  
THE SEISMIC-RESISTANT  
DESIGN OF CONCRETE BRIDGES**

*(Continued)*

**Assessing the Effectiveness of  
Reducing Seismic Vulnerability by  
a Program of Bridge Pier Wrapping** 4:00  
*Neil M. Hawkins*, Professor Emeritus,  
Dept. of Civil Engineering, University of  
Illinois – Urbana-Champaign,  
Urbana, IL and *Qun (Joan) Zhong*,  
Predoctoral Research Assistant,  
Dept. of Civil Engineering, University of  
Illinois – Urbana, Champaign,  
Urbana, IL

**Seismic Response of Vertically  
Post-Tensioned Substructures** 4:30  
*Sarah L. Billington*, Assistant  
Professor, Dept. of Civil & Environmental  
Engineering, Cornell University, Ithaca, NY  
and *Wing-Pin Kwan*, Design Engineer,  
Leslie E. Robertson and Associates,  
New York, NY

2:00 PM – 5:00 PM

★ TEACHING  
CONSTRUCTIBILITY

Salon F

Sponsored by Committee E802

Session Moderator: *Douglas B. Cleary*  
Associate Professor  
Dept. of Civil & Environmental Engineering  
Rowan University  
Glassboro, NJ

**Introduction** 2:00  
*Douglas B. Cleary*, Associate Professor,  
Dept. of Civil & Environmental Engineering,  
Rowan University, Glassboro, NJ

**What is Wrong with This Picture?** 2:05  
**A Constructibility Review from  
the Trenches**  
*Wern-Ping (Nick) Chen*, Director  
of Engineering, Sverdrup Civil, Inc.,  
Boston, MA

**Diminishing Constructibility** 2:30  
**Exposure Stifles Student's  
Introduction into the Design Field**  
*Allen J. Hulshizer*, Consulting  
Structural Engineer, Glenside, PA

**A Software Program for Teaching  
Concrete Acceptance** 2:55  
*Luke M. Snell*, Professor, Construction,  
Director, Concrete Construction Research  
Unit, Southern Illinois University –  
Edwardsville, Edwardsville, IL and  
*Jerry B. Weinberg*, Assistant Professor,  
Computer Science Dept., Southern  
Illinois University – Edwardsville,  
Edwardsville, IL

**Reinforcement Detailing and How it  
Affects Constructibility** 3:20  
*P. N. Balaguru*, Professor, Rutgers  
University, Dept. of Civil & Environmental  
Engineering, Piscataway, NJ and  
*Andrew J. Foden*, Senior Structural Engineer,  
Parsons Brinckerhoff, Princeton, NJ

★ Theme session

2:00 PM – 5:00 PM

★ TEACHING  
CONSTRUCTIBILITY

(Continued)

Constructibility Issues – Information Transfer in the Concrete Construction Industry – The Contractors' Perspective  
*Judson F. Vogdes*, Director of Education,  
General Building Contractors Association,  
Philadelphia, PA 3:45

Design & Construction of a Reinforced Concrete Cross in Honduras 4:10  
*Shawn P. Gross*, Assistant Professor,  
Dept. of Civil & Environmental Engineering,  
Villanova University, Villanova, PA and  
*David W. Dinehart*, Assistant Professor,  
Dept. of Civil & Environmental Engineering,  
Villanova University, Villanova, PA

Group Discussion 4:35

2:00 PM – 5:00 PM

OPEN PAPER SESSION

Salon H

Sponsored by Committee 123

Session Moderator: *Daniel A. Kuchma*  
Assistant Professor  
Dept. of Civil & Environmental Engineering  
University of Illinois  
Urbana, IL

Session Co-Moderator: *JoAnn P. Browning*  
Assistant Professor  
Dept. of Civil & Environmental Engineering  
University of Kansas  
Lawrence, KS

**Introduction** 2:00

*Daniel A. Kuchma*, Assistant  
Professor, Dept. of Civil & Environmental  
Engineering, University of Illinois, Urbana, IL

**Hysteretic Modeling of  
Slab-Column Connections** 2:05

*Ian N. Robertson*, Associate Professor,  
Dept. of Civil Engineering, University of  
Hawaii, Honolulu, HI and *Brian Enomoto*,  
Research Assistant, Dept. of Civil Engineering,  
University of Hawaii, Honolulu, HI

**Behavior and Modeling of  
Variably Confined Concrete** 2:30

*Kent A. Harries*, Assistant Professor,  
Dept. of Civil & Environmental Engineering,  
University of South Carolina,  
Columbia, SC and *Gayatri Kharel*,  
Graduate Research Assistant,  
Dept. of Civil & Environmental Engineering,  
University of South Carolina,  
Columbia, SC



2:00 PM – 5:00 PM

OPEN PAPER SESSION

(Continued)

Failure Criteria for 2:55  
Plate Delamination in

Composite-Strengthened Beams

*Stephen J. Kurtz*, Assistant Professor,  
Dept. of Civil & Environmental Engineering,  
University of Missouri – Columbia,  
Columbia, MO and *P. N. Balaguru*,  
Professor, Dept. of Civil & Environmental  
Engineering, Rutgers University,  
Piscataway, NJ

Controlled Bond Failure of 3:20  
Glass Fiber-Reinforced Polymers

(GFRP) Reinforcing Bars in Concrete

*Stavroula J. Pantazopoulou*, Professor,  
Dept. of Civil Engineering, Demokritus  
University of Thrace, Xanthi, Greece and  
*Souzana P. Tastani*, Research Engineer, Dept.  
of Civil Engineering, Demokritus University  
of Thrace, Xanthi, Greece

Composite Behavior of Precast 3:45  
Concrete Sandwich Wall Panels

*Alexandar J. Mlynarczyk*, Project  
Engineer, Wiss Janney Elstner  
Associates, Princeton Junction, NJ  
and *Stephen Pessiki*, Associate Professor,  
Dept. of Civil & Environmental Engineering,  
Lehigh University, Bethlehem, PA

2:00 PM – 5:00 PM

OPEN PAPER SESSION

(Continued)

**Structural Monitoring of a  
Prestressed Concrete Girder  
Bridge and a Quay Wall with  
Bragg Grating Sensors**

4:10

*Luc R. Taerwe*, Professor/Director,  
Dept. of Structural Engineering, Magnel  
Laboratory for Concrete Research,  
Ghent University, Ghent, Belgium;  
*Wim Moerman*, Research Assistant,  
Dept. of Structural Engineering, Magnel  
Laboratory for Concrete Research,  
Ghent University, Ghent, Belgium;  
*Wim De Waele*, Research  
Assistant, Dept. of Mechanical  
Constr. & Production, Mechanics of  
Materials & Structures, Ghent University,  
Ghent, Belgium; *Joris Degrieck*, Professor,  
Dept. of Mechanical Constr. & Production,  
Mechanics of Materials & Structures,  
Ghent University, Ghent, Belgium;  
*Roel Baets*, Professor, INTEC, Ghent  
University, Ghent, Belgium; and  
*Michiel Callens*, Engineer, Dept. of the  
Flemish Community, Dept. of Environment  
& Infrastructure, Ghent, Belgium

**Beam-Bending Method for  
Measuring Permeability of Cement  
and Mortar**

4:35

*Wilasa Vichit-Vadakan*, Graduate  
Student, Dept. of Civil & Environmental  
Engineering, Princeton University, Princeton, NJ  
and *George W. Scherer*, Professor, Dept.  
of Civil & Environmental Engineering,  
Princeton University, Princeton, NJ

---

**TUESDAY, MARCH 27**

---

**4:30 PM – 6:00 PM**

**CONTRACTORS' DAY  
RECEPTION & FORUM**

**Franklin B**

Sponsored by the ACI Delaware Valley Chapter, ACI International,  
and the American Society of Concrete Contractors (ASCC).

This forum and reception will invite nonmembers in attendance to  
discover the benefits of and join the ranks of ACI membership.

6:30 PM – 9:00 PM

**HOT TOPIC SESSION:** Salon E  
**SLAB MOISTURE &  
FLOOR-COVERING FAILURES –  
WHO'S TO BLAME?**

Sponsored by the Hot Topic Committee & the ACI Delaware Valley Chapter

Session Moderator: *Woodward L. Vogt*  
President  
Paradigm Consultants, Inc.  
Houston, TX

Session Co-Moderator: *Paul D. Spiegel*  
Director of Constr. Services  
Pennoni Associates, Inc.  
Bridgeport, PA

**Overview of Floor Moisture and the Problems it Causes** 6:30  
*Ward R. Malisch*, Senior Managing  
Director, ACI International,  
Farmington Hills, MI

**Case Studies** 6:50  
*Brian J. Pashina*, Consultant,  
Wiss, Janney, Elstner Associates, Inc.,  
Minneapolis, MN

**Test Methods** 7:20  
*Scott M. Tarr*, Senior Engineer,  
Construction Technology Labs, Inc.,  
Skokie, IL

**Prevention** 8:00  
*Bruce A. Suprenant*, Vice President,  
Engineering and Technical Services,  
Baker Concrete Construction,  
Boulder, CO

**Questions and Answers** 8:30

---

## TUESDAY, MARCH 27

---

7:30 PM – 10:00 PM

**123 FORUM: DESIGN  
BUILD vs. TRADITIONAL  
CONSTRUCTION**

Salon H

Sponsored by Committee 123

Session Moderator: *Mohammad S. Khan*  
Vice President  
Professional Service Industries, Inc.  
Fairfax, VA

Session Co-Moderator: *Jan Olek*  
Associate Professor  
Dept. of Civil Engineering  
Purdue University  
West Lafayette, IN

**Introduction** 7:30  
*Mohammad S. Khan*, Vice President,  
Professional Service Industries, Inc.,  
Fairfax, VA

**Design-Build in the Private Sector** 7:35  
*Andrew A. Signore*, President,  
Design-Build Institute of America/  
Pennsylvania Chapter, Lafayette Hill, PA

**Design-Build Promotes Innovation** 7:45  
*Thomas D. Verti*, President, Charles  
Pankow Builders, Ltd., Altadena, CA

**Do It Right The First Time** 7:55  
*G.P. (Jum) Horst*, Director of Design/Build  
Services, Baker Concrete Construction, Inc.,  
Monroe, OH

**Design-Build – Improvement for  
Project Delivery** 8:05  
*Earl L. Neiderhiser*, District Engineer,  
Engineering District 9-0, Pennsylvania Dept.  
of Transportation, Hollidaysburg, PA

---

TUESDAY, MARCH 27

---

7:30 PM – 10:00 PM

**123 FORUM: DESIGN  
BUILD vs. TRADITIONAL  
CONSTRUCTION**

*(Continued)*

**Quality Incentives in Traditional  
Construction** 8:15

*Tom Scott*, Construction Operations  
Engineer, Federal Highway Administration,  
Sterling, VA

**The Viability of Traditional Project  
Delivery Methods in the Design-Build  
World** 8:25

*Andrew J. Savage*, Associate Principal,  
Daniel, Mann, Johnson & Mendenhall,  
Arlington, VA

**Questions and Answers** 8:35

---

## WEDNESDAY, MARCH 28

---

9:00 AM – 12:00 PM

### INTERNATIONAL STANDARDIZATION & ACI Salon G

Sponsored by ISO Technical Committee-71 and 318

Session Moderator: *John E. Breen*  
Al-Rashid Chair  
Dept. of Civil Engineering  
University of Texas  
Ferguson Structural Engineering Laboratory  
Austin, TX

Session Co-Moderator: *W. Gene Corley*  
Vice President  
Construction Technology Labs, Inc.  
Skokie, IL

#### Introduction 9:00

*John E. Breen*, Al-Rashid Chair, Dept. of  
Civil Engineering, University of Texas,  
Ferguson Structural Engineering Laboratory,  
Austin, TX

#### ISO TC-71 – An Overview 9:10

*James R. Cagley*, President,  
Cagley & Associates, Rockville, MD

#### Performance and Assessment 9:35

**Requirements – Umbrella Code**  
*W. Gene Corley*, Vice President,  
Construction Technology Labs, Inc.,  
Skokie, IL

#### Simplified Design Standards for 10:05

**Concrete Structures – An Overview**  
*Nelson Sanchez*, ICONTEC, Colombia  
and *Luis E. Garcia*, Partner/President,  
Projects y Disenos Ltda, Bogota,  
Colombia

9:00 AM – 12:00 PM

**INTERNATIONAL** (Continued)  
**STANDARDIZATION & ACI**

**Specific Design Examples for  
Simplified Design Approach** 10:35  
*Luis E. Garcia*, Partner/President,  
Projects y Disenos Ltda, Bogota,  
Colombia

**Geotechnical Design – A Simplified  
Design Approach** 11:05  
*Augusto A. Espinosa*, Geotechnical  
Engineer, AREAS Ltda, Bogota,  
Colombia

**Test Methods for Concrete –  
ISO TC-71/SC1 Documents** 11:35  
*Mony Ben-Bassat*, Technion National  
Building Research Institute, Haifa,  
Israel and *Lia Fischer*, Civil Engineer,  
Senior Standardization Officer, The  
Standards Institution of Israel,  
Tel Aviv, Israel



---

## WEDNESDAY, MARCH 28

---

9:00 AM – 12:00 PM

**ACI 548 – POLYMERS IN  
CONCRETE: THE FIRST 30  
YEARS: PART 1**

Salon E

Sponsored by Committee 548

Session Moderator: *Richard C. Prusinski*  
Principal  
Polymer Concrete Consultants, Intl.  
Bloomfield Hills, MI

Session Co-Moderator: *David W. Fowler*  
Professor  
Dept. of Civil Engineering  
International Center for Aggregate Research  
University of Texas – Austin  
Austin, TX

**Introduction** 9:00  
*Richard C. Prusinski*, Principal,  
Polymer Concrete Consultants, Intl.,  
Bloomfield Hills, MI

**History of ACI Committee 548** 9:05  
**The First 30 Years**  
*James T. Dikeou*, Consultant,  
Englewood, CO

**50 Year History of Polymers** 9:25  
**in Concrete – A Review**  
*Wafeek S. Wahby*, Associate  
Professor/Coordinator, Industrial  
Technology Program, School of  
Technology, Eastern Illinois University,  
Charleston, IL

**Polymer Concrete – Where We** 10:00  
**Have Been**  
*David W. Fowler*, Professor, Dept. of  
Civil Engineering, International Center for  
Aggregate Research, University of Texas –  
Austin, Austin, TX

9:00 AM – 12:00 PM

**ACI 548 – POLYMERS IN  
CONCRETE: THE FIRST  
30 YEARS: PART 1**

(Continued)

**Polymer Concrete Coatings  
for Wastewater Facilities**

10:40

*Cumaraswamy Vipulanandan*, Professor,  
Dept. of Civil Engineering, University of  
Houston, Houston, TX and *Jie Liu*,  
Post Doctor Fellow, University of Houston,  
Houston, TX

**The Story of How Polyester  
Highway and Bridge Decks  
Went From Experimentation to  
the State of the Art**

11:10

*James E. Maass*, Senior Manager,  
Reichhold Chemical Co., Research  
Triangle, NC

**Precasting with Polymer  
Concrete – The Anatomy of  
a Dome**

11:40

*Constantin M. Bodea*, President,  
Metro Cast Corp., Westland, MI

---

## WEDNESDAY, MARCH 28

---

9:00 AM – 12:00 PM

★ **QUALITY ASSURANCE  
AND CONTROL OF  
CONSTRUCTION PROJECTS**

Salon F

Sponsored by Committee 121

Session Moderator: *Anthony R. Ameruso*  
Senior Vice President  
Ferrara Bros. Building Materials Corp.  
Flushing, NY

Session Co-Moderator: *Stephen Marchese*  
President  
Future Tech Consultants  
Mineola, NY

**Introduction**

*Anthony R. Ameruso*, Senior Vice  
President, Ferrara Bros. Building  
Materials Corp., Flushing, NY

9:00

**Concrete Product & Quality  
Management Via the Internet**  
*Farro F. Radjy*, President, Digital  
Site Systems, Inc., Pittsburgh, PA

9:05

**Concrete Quality Control and  
Quality Assurance – Some  
Reflections**  
*V. Mohan Malhotra*, Scientist Emeritus,  
NRCAN, CANMET, Ottawa, ONT,  
Canada

9:25

**Controlling Concrete Quality –  
Yesterday, Today & Tomorrow**  
*Ken W. Day*, Director, Concrete  
Advice Pty., Ltd., Croydon, VIC,  
Australia

9:50

**Concrete Quality Assurance &  
Control – The Industry Today**  
*Ken Gendrich*, Director of Research  
& Development, Product Department,  
Command Data, Inc., Birmingham, AL

10:15

★ Theme session

9:00 AM – 12:00 PM

★ **QUALITY ASSURANCE  
AND CONTROL OF  
CONSTRUCTION PROJECTS**

*(Continued)*

**Ready Mix Quality Assurance –  
A Producer's Perspective** 10:45  
*Thomas L. Carter*, Technical  
Services Manager, Concrete Products  
Division, Teichert Materials,  
Sacramento, CA

**Concrete QA/QC Specifying,  
Testing & Accepting Concrete –  
The Port Authority of NY & NJ  
Experience** 11:10  
*Casimir Bognacki*, Manager,  
Materials Engineering Department,  
Port Authority of NY & NJ, Jersey City,  
NY

**Questions & Answers** 11:35

★ **Theme session**

---

## WEDNESDAY, MARCH 28

---

12:00 PM – 2:00 PM

✓ **INTERNATIONAL  
LUNCHEON & PROGRAM**  
\$40 per person

Liberty A

Sponsored by the International Committee (IC)

**Moderator:** *Gajanan M. Sabnis*  
Consultant  
Silver Spring, MD



**Speaker:** *Wafeek S. Wahby*  
Coordinator  
Industrial Tech. Program  
Eastern Illinois University  
Charleston, IL

**Topic:** China's Three Gorges Dam

Technology is being challenged and stretched to the limit as never before. Wafeek Wahby will present a summary of a report on the largest dam in the world – China's Three Gorges Dam. The information and observations were gathered during his visit in the summer of 2000. This was a study of the massive project as it hit the halfway mark of its second and most critical stage.



**Speaker:** *Jo Coke*  
Consultant  
Coke Communications  
Chattanooga, TN

The second part of the program will focus on the human side. Almost a million people (out of 1.3 billion) will be displaced by the dam and relocated into new cities. Jo Coke, past president of ACI, led a People-to-People Ambassadors delegation to China last November, and will present this side of the story.

---

WEDNESDAY, MARCH 28

---

12:00 PM – 2:00 PM

✓ INTERNATIONAL (Continued)  
LUNCHEON & PROGRAM

*MENU*

*Balsamic Salad*

*Grilled Swordfish*

*Wild Rice*

*Seasonal Vegetables*

*Fresh Baked Rolls and Butter*

*Kahlua Chocolate Cake Topped with Chocolate Ganache*

*Red or White Wine*

*Coffee, Tea, Decaf*

*Ice Tea*

Tickets may be purchased at the ACI Registration Desk until 24 hours prior to the event. Please notify the ACI Registration Desk if you have any dietary restrictions.

✓ Separate fee required

2:00 PM – 5:00 PM

ACI 548 – POLYMERS IN  
CONCRETE: THE FIRST 30  
YEARS: PART 2

Salon E

Sponsored by Committee 548

Session Moderator: *Richard C. Prusinski*  
Principal  
Polymer Concrete Consultants, Intl.  
Bloomfield Hills, MI

Session Co-Moderator: *David W. Fowler*  
Professor  
Dept. of Civil Engineering  
International Center for Aggregate Research  
University of Texas – Austin  
Austin, TX

**Introduction** 2:00  
*Albert O. Kaeding*, Vice President of  
Engineering, CDR Systems Corp.,  
Ormond Beach, FL

**Development and Applications** 2:02  
**of Various Polymer Concrete**  
**Engineered Materials**  
*Jack J. Fontana*, President,  
Polycrete, Inc., Waverly, NY

**Long-Term Durability of Acrylic** 2:30  
**Modified Cementitious Concrete**  
*Donald A. Schmidt*, Group Leader,  
Technical Services, Rohm and Haas, Co.,  
Spring House, PA

**Impregnation of the Dworshak** 3:00  
**Dam**  
*Ernest K. Schrader*, Consultant,  
Schrader Consulting, Walla Walla, WA

2:00 PM – 5:00 PM

ACI 548 – POLYMERS IN CONCRETE: THE FIRST 30 YEARS: PART 2 *(Continued)*

Self-Repair Epoxy Modified Mortar for Rehabilitation and Strengthening Applications Using FRP 3:40

*Mahmoud Reda Taha*, Structural Engineer, Stantec Consulting, Ltd., Calgary, ALB, Canada

Long-Term Durability of Sulfur Concrete in Harsh Chemical Environments 4:00

*Garth J. Fallis*, Director, Technical Services, Vector Construction Group, Winnipeg, MAN, Canada

Development of Polymer-Impregnated Concrete 4:30

*Glenn W. DePuy*, Consultant, Denver, CO



---

## WEDNESDAY, MARCH 28

---

2:00 PM – 5:00 PM

★ **CONSTRUCTIBILITY OF SHRINKAGE COMPENSATING CONCRETE** Salon G

Sponsored by Committee 223

Session Moderator: *Karl J. Bakke*  
Sales Engineer  
Kalman Floor Company  
Evergreen, CO

**Introduction** 2:00  
*Karl J. Bakke*, Sales Engineer,  
Kalman Floor Company, Evergreen, CO

**A Study of Bridge Decks Built Using Shrinkage-Compensating Concrete** 2:05  
*Michael J. Boyle*, Vice President,  
Valley Forge Laboratories, Inc., Devon, PA

**Constructibility and Performance of Various Dowel Systems** 2:35  
*Ernest K. Schrader*, Consultant,  
Schrader Consulting, Walla Walla, WA

**Shrinkage-Compensating Post-Tensioned Concrete at Orange County California Airport** 3:05  
*Edward K. Rice*, President, CTS  
Cement Manufacturing Company,  
Los Angeles, CA

**Constructibility of High-Quality Industrial Concrete Floors Using Shrinkage-Compensating Concrete** 3:35  
*Carl N. Ytterberg*, President, Kalman  
Floor Company, Evergreen, CO

**Containment Structures Built with Shrinkage-Compensating Concrete** 4:05  
*Lawrence J. Valentine*, Principal  
Engineer, Ashland Chemical Company,  
Columbus, OH

**Shrinkage-Compensating Concrete in South America** 4:35  
*William F. Perenchio*, Senior Consultant,  
Wiss, Janney, Elstner Associates, Inc.,  
Northbrook, IL

★ Theme session

2:00 PM – 5:00 PM

★ **DESIGN AND CONSTRUCTION OF DURABLE PARKING STRUCTURES** Salon F

Sponsored by Committee 362

Session Moderator: *Thomas J. Downs*  
President  
BKBM Engineers  
Minneapolis, MN

Session Co-Moderator: *Thomas G. Weil*  
Dispenser Operations Manager  
W. R. Grace & Co.  
Cambridge, MA

**Introduction** 2:00  
*Thomas J. Downs*, President,  
BKBM Engineers, Minneapolis, MN

**Structural System Selection** 2:05  
**Tables of Parking Structures**  
*Anthony P. Chrest*, Corporate Chief  
Engineer and Senior Vice President,  
Walker Parking Consultants,  
Kalamazoo, MI

**Precast Pretopped Parking** 2:35  
**Structures – Making Them Last**  
*Thomas J. D'Arcy*, President,  
Consulting Engineers Group,  
San Antonio, TX

**Design Constraints for the** 3:05  
**Midfield Terminal Parking Garage**  
*Erich L. Martz*, Technical Manager,  
HNTB Corporation, Kansas City, MO

**Durability Analysis Methods for** 3:35  
**New Parking Structure Design**  
*H. Carl Walker*, CEO, Carl Walker, Inc.,  
Kalamazoo, MI and *Mark A. Postma*,  
Director of Restoration, Carl Walker, Inc.,  
Kalamazoo, MI

---

WEDNESDAY, MARCH 28

---

2:00 PM – 5:00 PM

★ DESIGN AND CONSTRUCTION (Continued)  
OF DURABLE PARKING  
STRUCTURES

Quality Assurance During  
Construction 4:05

*Martin B. Mikula*, President,  
Mikula Group, Inc., Madison, VA

Today & Tomorrow's Testing of  
Yesterday's Structures 4:35

*Boris Dragunsky*, President,  
Universal Construction Testing,  
Highland Park, IL

★ Theme session

---

THURSDAY, MARCH 29

---

8:00 AM – 10:00 AM

✓ AWARDS BREAKFAST

Salons E & F

\$35 per person

Don't miss out as ACI honors the men and women of the concrete industry who have contributed to better constructed facilities. Come meet and congratulate them on their achievements.

Also be there as we say "Thank you" to those who will join the ranks of Honorary Membership.

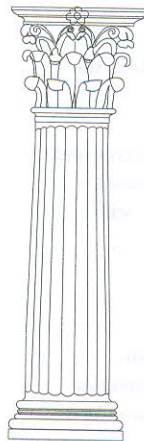

*MENU*

*Fresh Fruit and Berry Goblet  
Topped with Crisp Granola  
Served with Raspberry Sauce  
Breakfast Casserole  
Sausage  
Assortment of Pastries  
Coffee, Tea, Decaf  
Orange Juice*

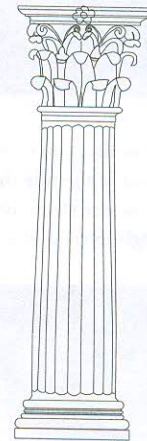

Tickets may be purchased at the ACI Registration Desk until 24 hours prior to the event. Please notify the ACI Registration Desk if you have any dietary restrictions.

✓ Separate fee required

---

## THURSDAY, MARCH 29

---

10:15 AM – 12:00 PM

### GENERAL SESSION

Salons E & F

After the Awards Breakfast, plan to attend the Spring 2001 Convention General Session.



**Speaker:** *Richard J. Farley*  
Principal  
Kling Lindquist  
Faculty  
University of Pennsylvania  
Pennsylvania

**Topic:** Philadelphia's Role in the  
Concrete Industry

Now that you've been able to see a little of Philadelphia, come and hear of the role that Philadelphia has had in the advancement of concrete structures. Richard Farley will give an overview, with highlights of four projects from different time periods.



**Speaker:** *James O. Jirsa*  
Professor/Chairman  
Dept. of Civil Engineering  
University of Texas – Austin  
Austin, TX  
President  
ACI International

Hear a short presidential speech by James O. Jirsa as he gives an overview of his year as President. Also included during the General Session will be the announcement of new ACI officers.

---

FRIDAY, MARCH 30

---

7:45 AM – 5:00 PM

ACI EDUCATIONAL SEMINAR

✓ **CONTROLLED** Salon D  
**LOW-STRENGTH MATERIALS (CLSM)**

Sponsored by ACI International & the ACI Delaware Valley Chapter

**SEMINAR INSTRUCTORS**

*Frank A. Kozeliski*  
President/Materials Engineer  
Gallup Sand & Gravel Co.  
Gallup, NM

*Bruce W. Ramme*  
Principal Engineer  
Fossil Operations Business Unit  
Wisconsin Electric Power Company  
Milwaukee, WI

Gain a better understanding of Controlled Low-Strength Materials (also known as Flowable Fill), how and where it can be used, how it is tested, produced, and can be specified. Through this seminar you will familiarize yourself with CLSM; learn the properties of CLSM in plastic, in-service, and hardened states; understand how to specify and order CLSM mixtures; and deal with construction issues including mixing, transporting, and quality control.

Registration opens	7:45 AM
Session I starts	8:00 AM
Lunch	Noon
Session II starts	1:00 PM
Seminar Ends	5:00 PM

**FREE PUBLICATIONS**

This seminar is worth 7.5 PDHs or 0.75 CEUs. The following publications (\$122.00 value) are also included free of charge with this seminar:

ACI 229R-99 (Controlled Low-Strength Materials)  
ACI SP-150 (94) (Controlled Low-Strength Materials)  
ASTM STP 1331 (The Design and Application of Controlled Low-Strength Materials).

Continental breakfast, lunch, and refreshment breaks are included in your registration fee.

✓ Separate fee required

---

## EDUCATIONAL SEMINARS

---

### SPRING 2001

Stop by the convention registration area for an informational flyer. To register or for more detailed information, call the Seminar Registrar at 248/848-3815, fax 248/848-3801, or email [jgill@aci-int.org](mailto:jgill@aci-int.org). You can also visit the ACI Seminar Website at [www.concreteseminars.com](http://www.concreteseminars.com).

**SLABS ON GRADE** -- Seminar will cover planning and selection of slabs on grade, slab subsurface considerations, thickness design procedures, specifications, and construction to achieve proper floor slab tolerances, special concerns for design details and materials, and prevention of problems.

Includes two FREE publications worth \$160.00.

Greenville, SC / May 25  
Houston, TX / May 9  
Los Angeles, CA / April 12  
Seattle, WA / May 1  
Wichita, KS / April 18

**CONCRETE REPAIR BASICS** – This seminar covers condition surveys, repair techniques, repair materials, cracks and joints, application of repair techniques, and case studies.

Includes five FREE publications worth \$150.50.

Albany, NY / May 24  
Des Moines, IA / May 16  
El Paso, TX / April 19  
Ft. Myers, FL / April 25  
Indianapolis, IN / May 9  
New Orleans, LA / April 12  
Phoenix, AZ / June 15

**REPAIR OF CONCRETE WORKSHOP** – This two-day workshop is an in-depth “How-to” on reliable concrete repairs: Determine causes of concrete deterioration, prepare for concrete repair, concrete repair techniques, review research advancements, and actual case histories.

Includes five FREE publications worth \$154.50.

Atlanta, GA / April 5 & 6  
Boston, MA / May 10 & 11  
Dallas, TX / April 12 & 13

---

## EDUCATIONAL SEMINARS

---

**SHOTCRETE FOR REPAIR** – This seminar will cover how and when to best use shotcrete, the specification and mix design process, quality control, and inspection. Also covered are shooting techniques, fresh and hardened properties of the materials used, equipment, and many other aspects of shotcrete technology.

Includes five FREE publications worth \$140.50.

Birmingham, AL / April 25

Las Vegas, NV / May 2

Tulsa, OK / April 11

Washington, DC / May 16

**REINFORCED CONCRETE DESIGN** – This two-day seminar will cover design concepts and safety provisions, flexural strength of members, serviceability, shear strength of beams, development of reinforcement, combined bending and axial compression, length effects on columns, design of two-way slabs and plates, footings, and designing for seismic forces.

Includes three FREE publications worth \$277.50.

Chicago, IL / April 30 & May 1

Cleveland, OH / June 4 & 5

Denver, CO / April 26 & 27

New Brunswick, NJ / April 3 & 4

New York, NY / May 21 & 22

Tampa, FL / May 14 & 15

**CONCRETE PARKING LOTS AND SITE PAVING** – Learn how to design, specify, and construct economical and long lasting concrete parking lots and site elements such as driveways, truck lanes, sidewalks, curbs, gutters, and architectural concrete.

Includes four FREE publications worth \$122.00

Albuquerque, NM / May 3

Detroit, MI / May 17

Little Rock, AR / April 19

Miami, FL / May 9

Oklahoma City, OK / April 12

Pittsburgh, PA / May 15

San Antonio, TX / April 4

Williamsburg, VA / April 25



---

## EDUCATIONAL SEMINARS

---

### TROUBLESHOOTING CONCRETE

**CONSTRUCTION** – Learn how to minimize problems with fresh concrete, slabs, vertical concrete, and structural concrete. Discussion to include techniques used to determine the causes of a problem in the field and in the laboratory, including visual observations, nondestructive testing, petrography, and chemical tests.

Includes five FREE publications worth \$174.50.

Atlanta, GA / June 8  
Charlotte, NC / June 13  
Houston, TX / April 11  
Kansas City, MO / May 23  
Nashville, TN / May 8  
Portland, OR / April 30  
St. Louis, MO / May 22

### CONTROLLED LOW-STRENGTH

**MATERIALS (CLSM)** – An intensive seminar on applications, properties, and materials for high quality Controlled-Low Strength Materials (CLSM), also known as flowable fill. To be covered are specifying and construction techniques for economical mixing, transporting, placing, and quality control.

Includes three FREE publications worth \$122.00.

Charlotte, NC / April 18  
Dallas, TX / May 10  
Las Vegas, NV / June 7  
Philadelphia, PA / March 30

**318-99 BUILDING CODE** -- An intensive seminar on the significant changes in the *ACI 318-99 Building Code Requirements for Structural Concrete*. Learn each change, why it was made, and work through real-life examples.

Includes four FREE publications worth \$232.50.

Macon, GA / May 7  
Miami, FL / April 5  
San Francisco, CA / April 17

---

## EDUCATIONAL SEMINARS

---

**PRACTICAL CONCRETE MATERIALS** – This seminar will cover the quality material selection and specifying of concrete and concrete materials including cements, slag, fly ash, silica fume, blended cements, aggregates, and chemical admixtures. Also included is an overview of various testing procedures for fresh concrete, the proper evaluation of test results, and what to do when test results are unacceptable.

Includes four FREE publications worth \$146.50.

Baltimore, MD / April 3  
Grand Rapids, MI / April 24  
Orlando, FL / April 17  
San Francisco, CA / May 22

**FIBER-REINFORCED CONCRETE** – This seminar will cover the use of synthetic, steel, glass, and natural fibers in concrete. An overview of the various types of fibers will be presented, the mechanics of fiber reinforcement, techniques for mixing in concrete, placing, finishing, and examples in application.

Includes four FREE publications worth \$167.00.

Austin, TX / April 24  
Cincinnati, OH / April 20  
Jacksonville, FL / May 2  
Los Angeles, CA / June 5  
Salt Lake City, UT / April 13

# NOTES



## BOARD COMMITTEES AND CHAIRMEN

Certification Programs	Thomas O. Malerk
Chapter Activities	Richard D. Stehly
Commemorative Lecture	Richard N. White
Concrete Research Council	David W. Fowler
Construction Liaison	Brad D. Inman
Convention	Rita K. Oglesby
Educational Activities	Jon I. Mullarky
Fellows Nomination	Catherine E. French
Financial Advisory	Robert A. Epifano
Honorary Membership	James R. Libby
Hot Topics	Woodward L. Vogt
International Committee	Richard D. Stehly
International Joints & Bearings	Barrie Atkinson
Internet Advisory	James (Jay) M. Shilstone, Jr.
Marketing	James S. Pierce
Membership	Clifford N. MacDonald
Paper Awards	Jo Coke
Personal Awards	James S. Pierce
Publications	Sharon L. Wood
Responsibility in Conc Constr	William M. Klorman
Scholarship	Bertold E. Weinberg
Standards Board	Richard N. White
Technical Activities	Charles W. Dolan
Young Member Award	Kelly M. Page

## CONVENTION COMMITTEE

Rita K. Oglesby, Chairman

Nick P. Bada	William E. Rushing, Jr.
Thomas B. Battles	Margaret A. Hanson Reed
Christopher Crouch	Elizabeth S. Jordan
Charles W. Dolan	Debrethann R. Orsak
Laurel M. Dovich	Thomas D. Verti
John C. Hukey	Woodward L. Vogt
LaGrit F. (Sam) Morris	Donald T. Ward

Renée J. McAdams, Secretary

**FUTURE  
ACI  
CONVENTIONS**

**Fall 2001 Convention**  
*Concrete of the Future*  
**October 28 - November 2, 2001**  
Wyndham Anatole  
Dallas, Texas

**Spring 2002 Convention**  
*A Concrete-Driven Renaissance*  
**April 21 - 26, 2002**  
Marriott Renaissance Center  
Detroit, Michigan

**Fall 2002 Convention**  
**October 27 - November 1, 2002**  
Pointe at South Mountain Resort  
Phoenix, Arizona



**international**<sup>®</sup>

**ACI International**  
P.O. Box 9094  
Farmington Hills, MI 48333-9094  
Phone: 248-848-3700  
Fax: 248-848-3701

Member Services  
Phone: 248-848-3800  
Fax: 248-848-3801

Thank you for attending the  
ACI Spring 2001 Convention.  
See you in Dallas!