

Marriott Rivercenter – 3rd Floor

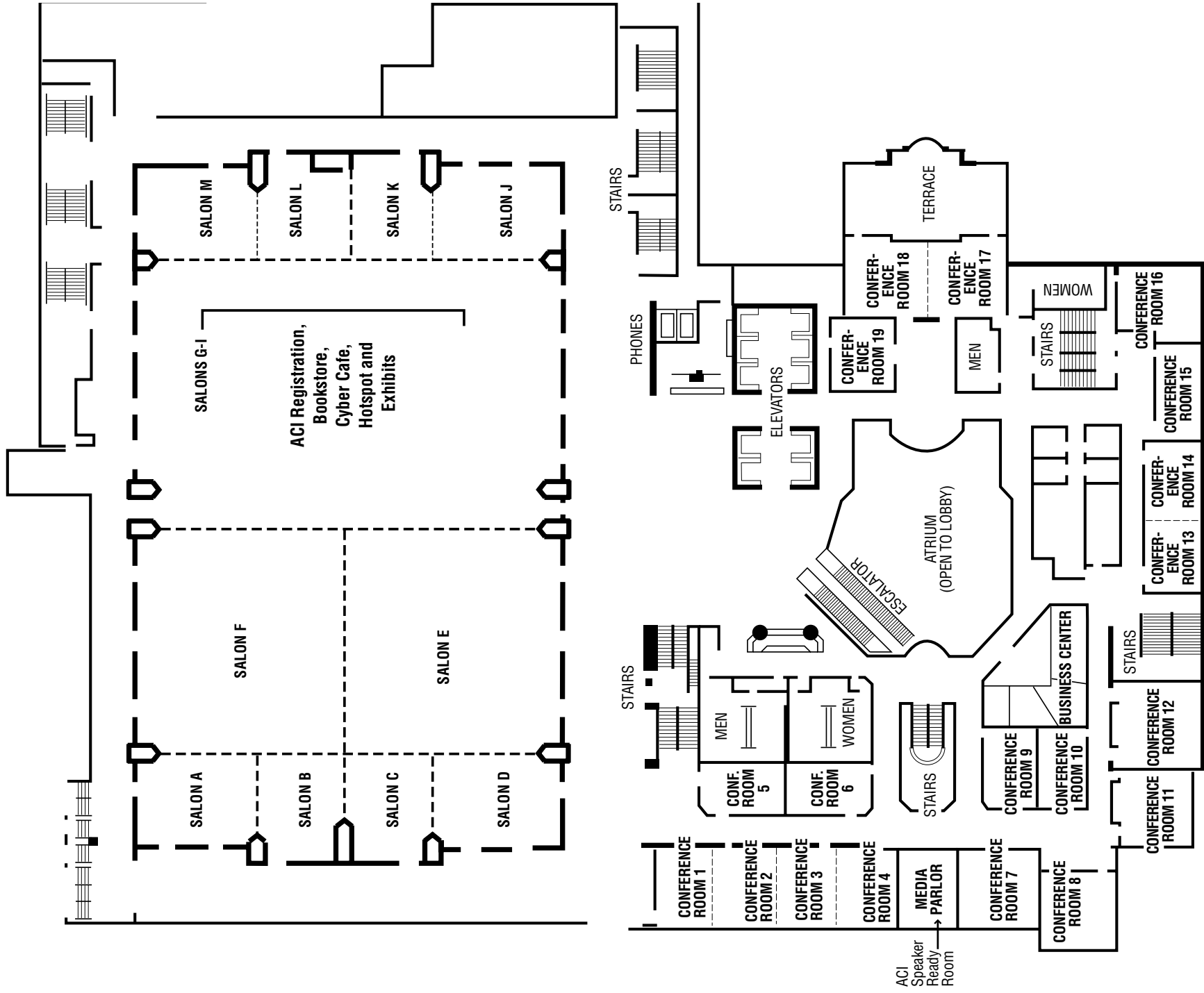

Marriott Rivercenter – Exhibitor Area

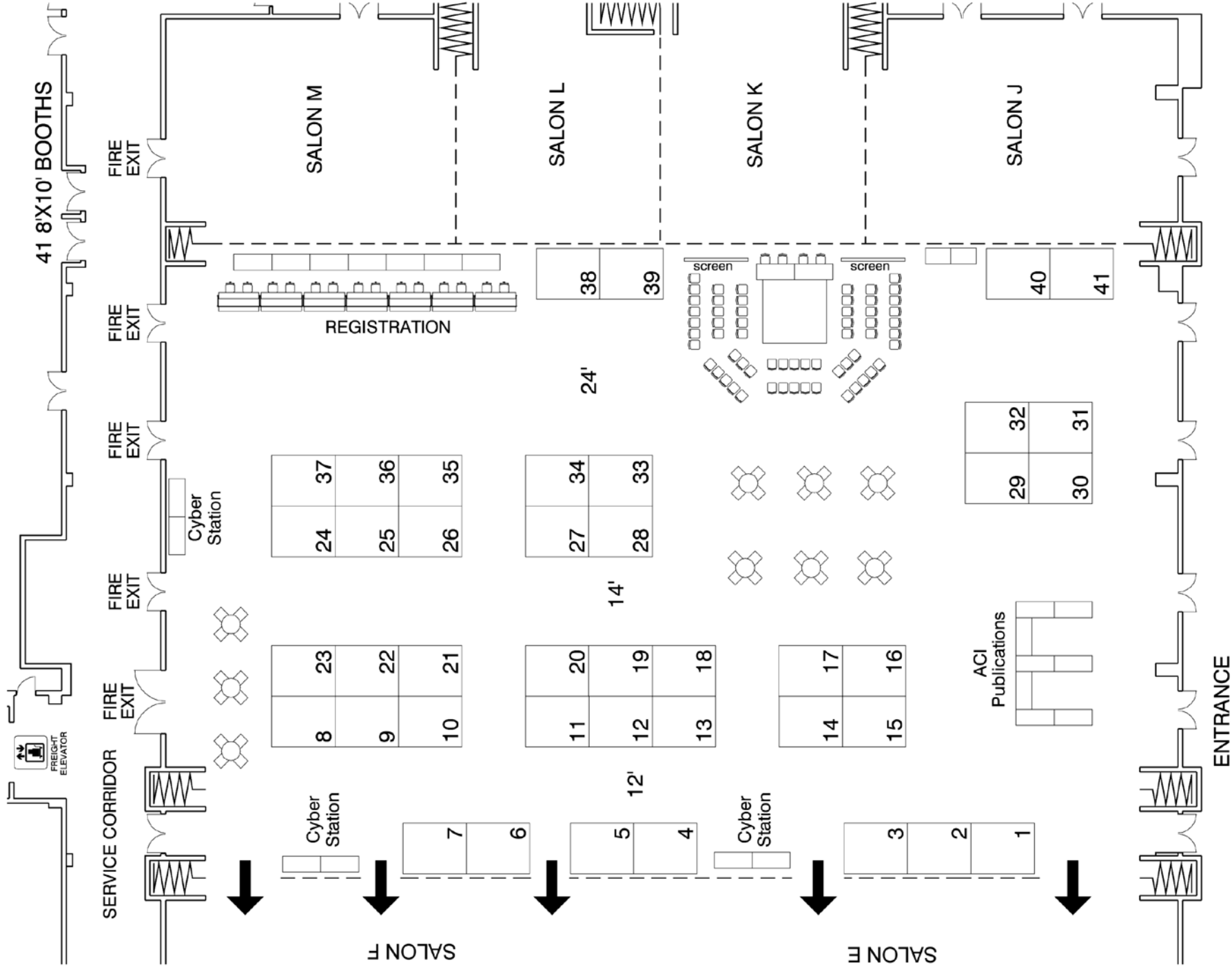

Session Attendance Tracking Form for the ACI Spring 2009 Convention

San Antonio, TX • March 15-19, 2009

Use this form to track your attendance at ACI sessions. This form can be submitted to state boards that allow self-reporting of Continuing Education activities as evidence of participation. In most cases, 1 contact hour is equal to 1 Professional Development Hour (PDH). Check with your state board for acceptance criteria. *Please note: ACI does not track and cannot provide documentation confirming attendee participation or attendance at any ACI session held during the Convention.*

Instructions: Check off each session you attended and write in the number of PDH credits you earned for each day.

Remember that 1 PDH is equal to a contact hour (nominal) of instruction or presentation, rounded down to the nearest half-hour.

SUNDAY, MARCH 15, 2009

2:00 PM-5:00 PM **3 PDH**

- Methodology for Live Load Distribution for Bridge Evaluation (342)
- Transition from Fluid to Solid: Reexamining the Behavior of Concrete at Early Ages, Part 1 (231)
- Seismic Design of Punching Shear Reinforcement in Flat Plates(421)
- Residential Concrete Foundations-Science and Practice Can Coexist, Part 1 (332)
- Improving the Infrastructure with Roller-Compacted Concrete Pavements (327 & 325)

7:30 PM-10:00 PM **2.5 PDH**

- Hot Topic Session: Minimum Pavement Cracking? Design and Construction (ACI San Antonio Chapter)

MONDAY, MARCH 16, 2009

9:00 AM-12:00 PM **3 PDH**

- Research in Progress (123)
- Residential Concrete Foundations—Science and Practice Can Coexist, Part 2 (332)
- Transition from Fluid to Solid: Reexamining the Behavior of Concrete at Early Ages, Part 2 (231)
- Serviceability of Concrete Members Reinforced with Internal/External FRP Reinforcement, Part 1 (440, 435, & 224)
- Building Sustainability with Slag Cement (233 & 130)

2:00 PM-5:00 PM **3 PDH**

- The Practice and Placement of Structural Concrete in Seismic Design of Bridge Infrastructure (341)
- What's This Report For? Using Engineering Reports to Make a Decision (E702)
- Consolidation: Back to the Basics in the 21st Century (309)
- Behavior of Concrete Transportation Structures Under Blast and Impact (370)
- Developing Innovative Solutions for Design and Construction of Precast/Prestressed Concrete Structures (550)

7:30 PM-10:00 PM **2.5 PDH**

- 123 Forum (123)

TUESDAY, MARCH 17, 2009

9:00 AM-12:00 PM **3 PDH**

- Contractors' Day Session, Part 1 (ACI San Antonio Chapter)
- Design Methods for Non-Traditional ICF's (560)
- Constructability of SCC (237)
- Serviceability of Concrete Members Reinforced with Internal/External FRP Reinforcement, Part 2 (440,435, & 224)
- Early Age Test Methods for Performance Specifications (236 & 231)

2:00 PM-5:00 PM **3 PDH**

- Open Paper Session (123)
- Contractors' Day Session, Part 2 (ACI San Antonio Chapter)
- Overlays for Bridges (345)
- Concrete Thixotropy and Implication on Performance of SCC (238 & 236)
- Concrete the Sustainable Material Choice in Practice, Part 1 (BAC-SD & 130)

WEDNESDAY, MARCH 18, 2009

9:00 AM-12:00 PM **3 PDH**

- Tech Notes: Applications for Silica-Fume Concrete (234)
- Application of Soil Cement Technologies (230)
- Concrete the sustainable Material Choice in Practice, Part 2 (BAC-SD & 130)
- Curing Concrete (308)

Enter your name and address here

DAILY PDH TOTALS AVAILABLE

Total Completed on Sunday, 3/15/09 _____

Total Completed on Monday, 3/16/09 _____

Total Completed on Tuesday, 3/17/09 _____

Total Completed on Wednesday, 3/18/09 _____

Total Number of PDHs Completed _____