

American Concrete Institute
 David L Lawrence Convention Center
 Pittsburgh, Pennsylvania
 October 24-28, 2010

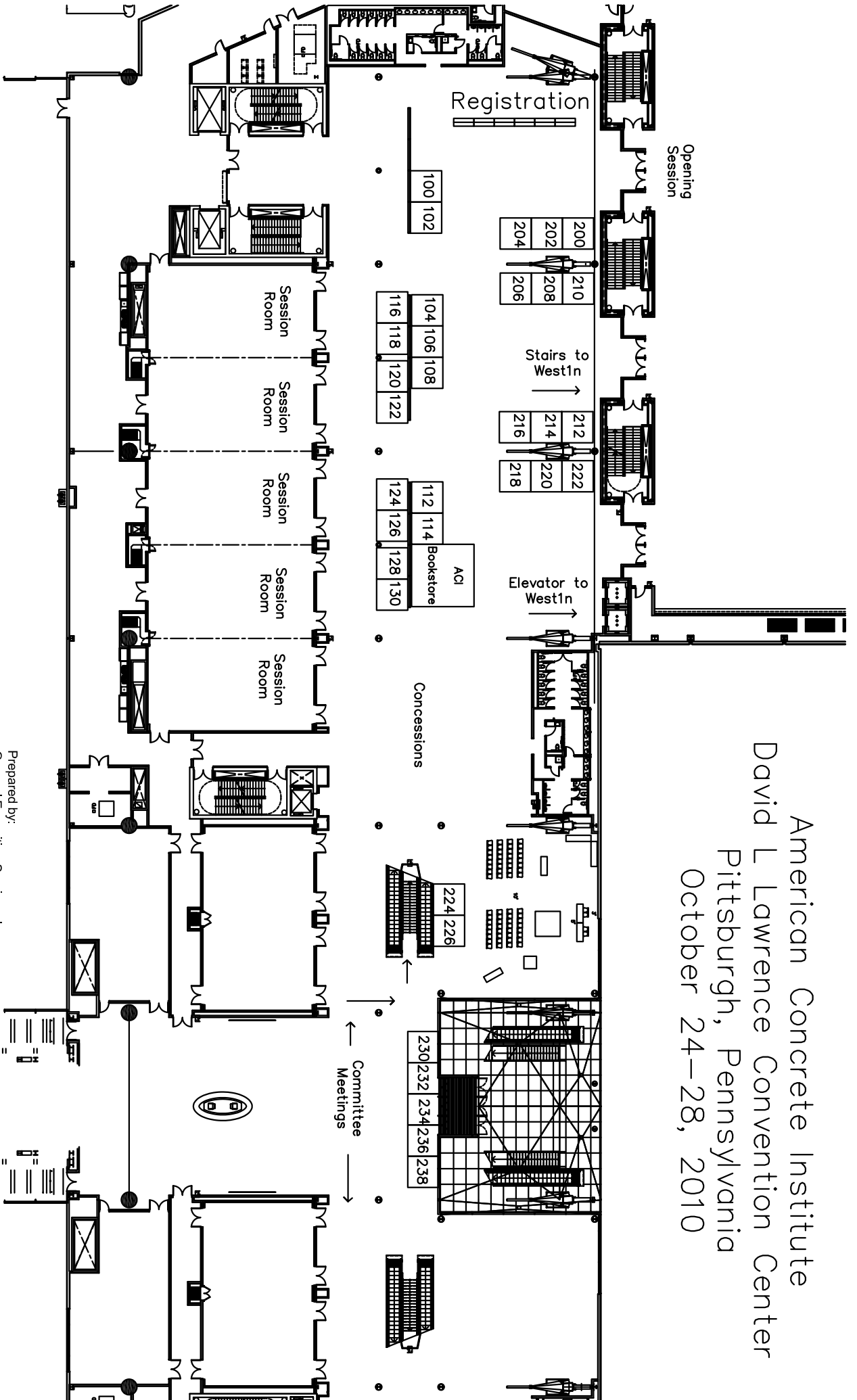

Please note: Every effort has been made to ensure the accuracy of all the information contained on the floorplan. However, no warranties are made with respect to this floorplan. If the location of building columns, utilities or other architectural components of the building is a factor in the construction or usage of an exhibit, it is the sole responsibility of the exhibitor to physically inspect the facility to verify all dimensions and locations.

Prepared by:
 General Exposition Services, Inc.
 610-495-8866 - 610-495-8870 Fax
 Info@generalexposition.com
 8.11.2010 LC

31 - 10x10 Booths