

**American
Concrete
Institute**

**60th Annual
Convention
March 2-5, 1964
Rice Hotel
Houston, Texas**



**Progress through
Knowledge**

BOARD OF DIRECTION

President

ROGER H. CORBETTA

Vice-Presidents

BRYANT MATHER AND A. ALLAN BATES

Directors

ARTHUR R. ANDERSON

DELMAR L. BLOEM

G. E. BURNETT

SAMUEL HOBBS

CLYDE E. KESLER

J. D. LINDSAY

GEORGE H. NELSON

C. P. SISS

ANTON TEDESKO

J. NEILS THOMPSON

WILLIAM R. WAUGH

HUBERT WOODS

Past Presidents

JOE W. KELLY

LEWIS H. TUTHILL

RAYMOND C. REESE

Executive Secretary*

WILLIAM A. MAPLES

TECHNICAL ACTIVITIES COMMITTEE

(In charge of convention program and of technical publications)

J. J. SHIDELER, *Chairman*

ROGER H. CORBETTA, *Ex-Officio*

WILLIAM A. MAPLES, *Secretary**

ARTHUR R. ANDERSON

S. D. BURKS

G. E. BURNETT

A. T. HERSEY

CLYDE E. KESLER

PAUL F. RICE

* Address

AMERICAN CONCRETE INSTITUTE

P.O. Box 4754, Redford Station

Detroit, Michigan 48219

CONVENTION REGISTRATION

Monday – Thursday, March 2-5

8:00 a.m. – 5:00 p.m.

in Grand Foyer, Second Floor

Registration Fee – \$5.00

All ladies and **registered** nonmember visitors are welcome to attend technical sessions, Awards Luncheon, and social activities.

See bulletin board in registration area for special announcements.

TECHNICAL COMMITTEE CHAIRMEN BREAKFASTS

7:30 a.m. Monday – Breakfast for chairmen of 100 and 200 Group Technical Committees (by invitation) in Neches Room.

7:30 a.m. Tuesday – Breakfast for chairmen of 500 Group Technical Committees (by invitation) in Neches Room.

Note: No special breakfasts scheduled for chairmen of 300 and 400 Group Technical Committees

NOTES FOR PROGRAM PARTICIPANTS

7:30 a.m. Wednesday – Breakfast for program participants (by invitation) in Neches Room.

8:00 a.m. Thursday – Breakfast for Research Session participants (by invitation) in Neches Room.

Upon recognition by the Chairman, a discussor will please state his name distinctly and go to the nearest microphone so that he may be heard by all.

A "Convention Review" will be published in the News Letter section of the May 1964 ACI JOURNAL.

ACI CONVENTION AND PRESS HEADQUARTERS

Comal and Pecos Rooms

SPECIAL EVENTS

Educational-Technical Exhibits . . . Monday through Thursday in exhibit hall. Have your program card (inside back flap) stamped to qualify for valuable door prizes.

Photographic Exhibit of unusual and outstanding concrete structures, Monday through Thursday.

Ladies' Program . . . See schedule elsewhere in this program book.

Architectural Design Competition . . . Winning sketch and four honorable mention entries on display beginning Tuesday.

Ice-Breaker Buffet . . . 6:30 p.m., Tuesday, Grand Ballroom. Buy your ticket, \$2.00 per person, from local committee, convention registration area.

University of Illinois Alumni Breakfast . . . 7:45 a.m. Wednesday, Sabine Room. Tickets, \$2.35 per person, may be purchased in convention registration area from local committee.

Awards Luncheon and Installation of new ACI Officers . . . 12:15 p.m. Wednesday, Grand Ballroom. Purchase tickets by 9:30 a.m. Wednesday at the convention registration desk. \$4.00 per person.

Inspection Trip . . . 9:30 a.m. Friday. Conducted bus tour will leave main entrance of hotel for three-hour trip to construction projects of special interest. Included will be complex highway interchanges, a multi-story architectural concrete apartment, an office building with exposed aggregate exterior and 80' span prestressed beams, the Rice University campus, and the 66,000-seat capacity domed stadium—the world's largest air-conditioned sports stadium and new home of Houston's major league football and baseball teams. Tickets, \$1.50 per person, may be purchased from local committee. Ladies invited.

TECHNICAL COMMITTEE MEETINGS

All meetings are open except those indicated as executive or closed sessions. Meeting topics are in italics.

Sunday Afternoon, March 1

2:00 p.m. — 5:00 p.m.

Committee	Meeting Room
441 Reinforced Concrete Columns <i>(Executive Group only)</i>	Gold

Monday Morning, March 2

9:00 a.m. — 12:00 Noon

(except where noted)

— Board Committee on Coordination <i>(Closed meeting)</i>	Board (9:30 a.m.)
201 Durability <i>(2nd draft of "Guide to a Condition Survey of Concrete in Service")</i>	El Vaquero
213 Lightweight Aggregates <i>(5 chapters of "Guide for Structural Lightweight Concrete")</i>	Trinity
315 Detailing Reinforced Concrete Structures <i>(Final revisions to Detailing Manual; discussion of proposed prestressed-precast section)</i>	Stinson
333 Composite Structures <i>(Research reports; revisions to Tentative Recommendations)</i>	Neches (9:30 a.m.)
334 Shell Structures <i>(Closed meeting)</i>	*
408 Bond Stress <i>(Subcommittee progress; research)</i>	Cougar
421 Reinforced Concrete Slabs <i>(Development of new design code)</i>	Persian
428 Limit Design <i>(Subcommittee reports; program for Miami Symposium)</i>	Gold
504 Joint Sealants <i>(Task Group only)</i>	*
506 Pneumatically Applied Mortar <i>(Draft of proposed recommended practice)</i>	Sabine
512 Precast Structural Concrete	Silver

*These rooms are on upper floors of hotel. Please check bulletin board at registration desk for specific room number.

Monday Afternoon, March 2

2:00 p.m. — 5:00 p.m.

Committee	Meeting Room
— Board Committee on Chapter Activities (Closed meeting)	Board
115 Research (Executive Group Only)	*
213, Subcommittee 1 Lightweight Aggregates ("Guide for Structural Lightweight Concrete")	Trinity
214 Evaluation of Strength Tests (Revision of committee report; correlation of cores vs. cylinders)	Silver
311 Inspection (Revision of Inspection Manual; Code of Concrete Inspection)	Green
315 Detailing Reinforced Concrete Structures (Final revisions to Detailing Manual; discussion of proposed prestressed-precast section)	Stinson
322 Structural Plain Concrete (Revised draft of Recommended Building Code Requirements for Structural Plain Concrete)	Gold
334 Shell Structures (Closed Meeting)	*
408 Bond Stress (Subcommittee progress; research)	Cougar
439 High-Strength Reinforcement	El Vaquero
441 Reinforced Concrete Columns (Progress of subcommittees)	Persian
503 Adhesives for Concrete	Neches
504 Joint Sealants (Task Group only)	*
506 Pneumatically Applied Mortar (Draft of proposed recommended practice)	Sabine

Monday Evening, March 2

7:00 p.m.

— Board Committee on International Activities (Closed meeting)	Gold
207 Mass Concrete	El Vaquero
213, Subcommittee 4 Lightweight Aggregates (Closed meeting)	Trinity

*These rooms are on upper floors of hotel. Please check bulletin board at registration desk for specific room number.

Committee

Meeting Room

302	Concrete Floors	Neches
317	Reinforced Concrete Design Handbook (Closed meeting)	Board
334	Shell Structures (Closed meeting)	*
423	Prestressed Concrete (Closed meeting)	*
441	Reinforced Concrete Columns (Progress of subcommittees)	Persian

Tuesday Morning, March 3

9:00 a.m. — 12:00 Noon

(except where noted)

—	Chapter Forum	Trinity
116	Nomenclature (Progress of committee work)	*
209	Creep and Volume Changes (Creep and shrinkage of plain concrete; new research)	*
216 & Board Committee on Fire Resistance	Fireproofing Structures (Closed meeting)	Green
306	Winter Concreting (Winter curing requirements; use of calcium chloride)	Persian
307	Reinforced Concrete Chimneys (Committee approval of draft of revised specification)	*
325	Design of Concrete Pavements (Reports of Subcommittees 1 and 6)	Silver
412	Arches (Research into elastoplastic behavior of arches)	Stinson
423	Prestressed Concrete (Closed meeting)	*
426	Shear and Diagonal Tension (Future work, subcommittee assignments)	Cougar
437	Strength Evaluation of Structures (Closed meeting)	*
515	Coatings (Report on coatings for prevention of chemical attack)	El Vaquero

*These rooms are on upper floors of hotel. Please check bulletin board at registration desk for specific room number.

Committee	Meeting Room
517	Low Pressure Steam Curing (<i>Proposed recommended practice, committee report, steam-curing projects at PCA</i>) Gold
531	Concrete Masonry Structures (<i>Research needs, review of chapters in "Recommended Practice" on structural design and wall movements</i>) Sabine
533	Precast Panels (<i>Symposium program outline</i>) Neches (9:30 a.m.)

Tuesday Afternoon, March 3

2:00 p.m. — 5:00 p.m.

	Ad Hoc Committee on Computers	Silver
103	Monographs (<i>Closed meeting</i>)	Board
211	Proportioning Concrete Mixes (<i>Revisions of 613-54; proposed standard, "Recommended Practice for Selecting Proportions for No-Slump Concrete"</i>)	Trinity
212	Admixtures (<i>Preparation of Recommended Practices</i>)	El Vaquero
216	Fireproofing Structures	Green
344	Circular Prestressed Structures (<i>Review of recommendation</i>)	Stinson
423	Prestressed Concrete (<i>Closed meeting</i>) *	
435	Deflection of Structures (<i>Revision of committee report; progress of committee questionnaire</i>)	Neches
437	Strength Evaluation of Structures (<i>Closed meeting</i>) *	
422	Lateral Forces on Multistory Frames (<i>Discussion of reports, committee membership, approximate methods vs. computer method</i>)	Cougar
504	Joint Sealants (<i>Final draft of committee paper, "Current Practices for Joint Sealants"</i>)	Sabine

*These rooms are on upper floors of hotel. Please check bulletin board at registration desk for specific room number.

Committee	Meeting Room
516	High Pressure Steam Curing (<i>Committee report</i>) Persian
523	Insulating and Cellular Concretes (<i>First draft of "Recommended Practice for Cast-in-Place Low Density Concrete"; proposed "Recommended Practice" for precast products</i>) Gold
543	Concrete Piles (<i>Discussion of slip forms, temperature recording devices; expanding committee membership</i>) *

Tuesday Evening, March 3

6:30 p.m.

Ice-Breaker Buffet in Grand Ballroom. Buy your tickets, \$2.00 per person, from local committee in convention registration area.

Tuesday Evening, March 3

8:00 p.m.

— ASCE Committee on Masonry and Reinforced Concrete (*Administrative Committee and Task Committee chairmen only*) Gold

Wednesday Afternoon, March 4

2:00 p.m. — 5:00 p.m.

318 ACI Building Code Sabine

Wednesday Evening, March 4

7:00 p.m.

318 ACI Building Code Sabine

*These rooms are on upper floors of hotel. Please check bulletin board at registration desk for specific room number.

AWARDS LUNCHEON

12:15 p.m.

GRAND BALLROOM

Presentation of Awards

HENRY C. TURNER MEDAL to

CHESTER P. SIESS

"For notable research and committee service on structural members and fundamental properties of reinforced concrete"

ALFRED E. LINDAU AWARD to

ALFRED L. PARME

"For important contributions to the development and American adoption of advanced design in reinforced concrete, especially for thin shells"

HENRY L. KENNEDY AWARD to

RAYMOND C. REESE

"For outstanding leadership and technical contributions in the extensive and exacting revision of the ACI Building Code"

WASON MEDAL FOR RESEARCH to

J. J. HROMADIK

For his paper "Column Strength of Long Piles" published in the June 1962 ACI JOURNAL

WASON MEDAL FOR "THE MOST MERITORIOUS PAPER" to

PAUL FISCHER

For his paper "Differential Temperature Moments in Rigid Frames" published in the June 1962 ACI JOURNAL

CONSTRUCTION PRACTICE AWARD to

JOSEPH R. PROCTOR, JR.

For his paper "Economics of Formwork Planning" published in the June 1962 ACI JOURNAL

Announcement of Election to Honorary Membership

ULRICH FINSTERWALDER

KIYOSHI MUTO

BYRAM W. STEELE

Announcement of Student Winners in Architectural Design Competition

Presentation of ACI Charter to Houston and North East Texas Chapters

Recognition of Retiring Officers

Report of Tellers and Introduction of New Officers

Presentation of Memento to Retiring President

FIRST GENERAL SESSION

9:00 a.m. — 11:45 a.m.

Grand Ballroom

CHAIRMAN

H. E. Bovay, Jr.

President

Bovay Engineers, Inc.
Houston, Texas

Invocation

Presidential Address

Roger H. Corbetta

President

American Concrete Institute
& Chairman of the Board
Corbetta Construction Company, Inc.
New York, New York

Proposed ACI Standard: Recommended Practice for Concrete Inspection

Samuel D. Burks

Manager, Construction
Chemicals Division

W. R. Grace and Company
Dewey and Almy Chemical
Division
San Leandro, California

1963 Skopje Earthquake

Walter E. Kunze

Director of Promotion Planning
and Engineering Services

Portland Cement Association
Chicago, Illinois

Structural Damage Caused by the 1963 Skopje Earthquake

Mete A. Sozen

Professor of Civil Engineering

University of Illinois
Urbana, Illinois

The Cement and Concrete Reference Laboratory

J. R. Dize

Manager

Cement and Concrete Reference
Laboratory
U.S. Department of Commerce
National Bureau of Standards
Washington, D. C.

The New ACI Publications Policy

William A. Maples

Executive Secretary

American Concrete Institute
Detroit, Michigan

ROOM LOCATOR MAP FOR RICE HOTEL

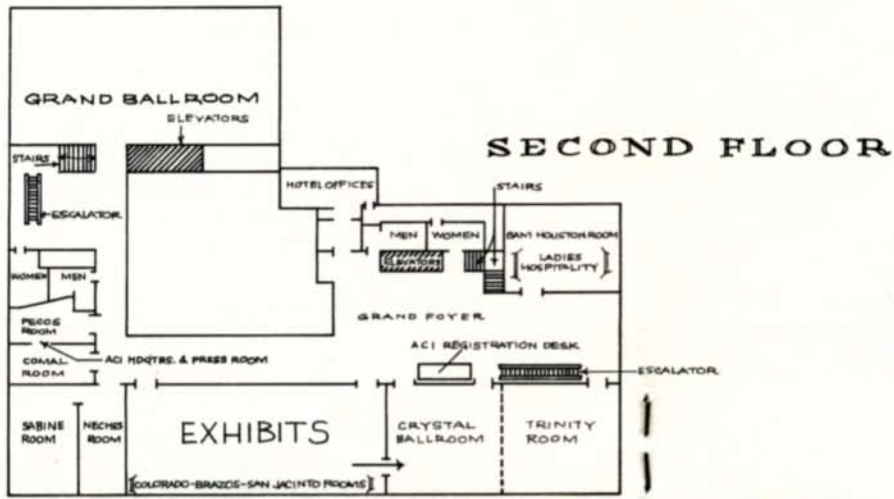

Note: Rooms for some technical committee meetings on Monday and Tuesday are located on other floors. Refer to convention registration desk for location of these meetings.

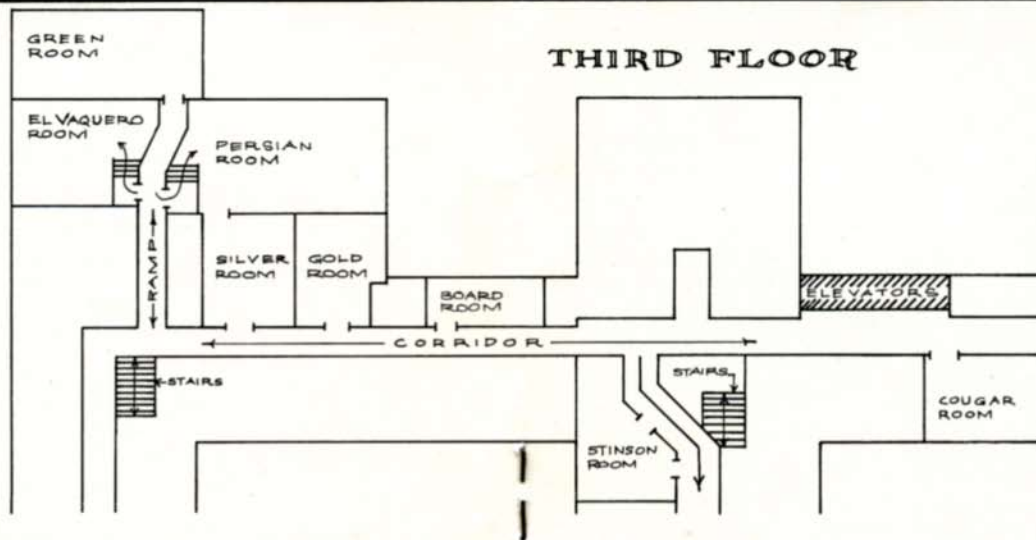

CONCURRENT SESSION

(1) SYMPOSIUM ON CREEP OF CONCRETE

2:00 p.m. — 5:00 p.m.

Crystal Ballroom—Trinity Room

CHAIRMAN

Adam M. Neville
Vice Chairman,
ACI Committee 209

Factors in Creep and Its Prediction

Bernard L. Meyers
Assistant Professor of
Civil Engineering
University of Missouri
Columbia, Missouri

Adam M. Neville
Chairman, Div. of Engineering
University of Alberta
Calgary, Alberta

Mechanisms of Creep in Concrete

Clyde E. Kesler
Professor
Department of Theoretical
and Applied Mechanics
College of Engineering
University of Illinois
Urbana, Illinois

Some Factors in the Analysis of Time-Dependent Behavior of Reinforced Concrete

Boris Bresler
Chairman
Division of Structural Engineering
and Structural Mechanics
College of Engineering

Lawrence G. Selna
College of Engineering
University of California
Berkeley, California

Effects of Creep and Shrinkage on the Behavior of Reinforced Concrete Members

Adrian Pauw
Chairman & Professor
Bernard L. Meyers
Assistant Professor
Department of Civil Engineering
University of Missouri
Columbia, Missouri

CONCURRENT SESSION

(2) SYMPOSIUM ON PRECAST CONCRETE WALL PANELS

2:00 p.m. — 5:00 p.m.

Grand Ballroom

CHAIRMAN

William A. Cordon
Chairman, ACI Committee 533
& Associate Professor of
Civil and Irrigation Engineering
Utah State University
Logan, Utah

Activities and Objectives of Committee 533

Harry T. Swanson
Manager, Atlas White & Lumnite Sales
Universal Atlas Cement Division
U. S. Steel Corporation
New York, New York

Past and Future of Precast Concrete Wall Panels

T. W. Hunt
Decorative Concrete Specialist
Portland Cement Association
Chicago, Illinois

Design of Precast Concrete Wall Panels

Victor F. Leabu
Chief Structural Engineer
Giffels & Rossetti, Inc.
Detroit, Michigan

Fabrication and Erection of Precast Concrete Wall Panels

Phillip W. Gutmann
Manager, Technical Division
Medusa Portland Cement Company
Cleveland, Ohio

Bowing, Warpage and Movement of Precast Concrete Wall Panels

Sheng Pao Sheng
Consulting Engineer
Williamstown, West Virginia

Materials and Tests for Precast Concrete Wall Panels

J. A. Hanson
Senior Development Engineer
Portland Cement Association
Research and Development Laboratories
Skokie, Illinois

Daniel P. Jenny
Chief Engineer
Expanded Shale Clay and
Slate Institute
Washington, D. C.

CONCURRENT SESSION

(1) CONSTRUCTION SESSION

9:00 a.m. — 11:30 a.m.

Grand Ballroom

CHAIRMAN

G. E. Burnett
Chief Research Scientist
U. S. Bureau of Reclamation
Denver, Colorado

Construction Features of Free Form Thin Concrete Shell for Eastman Kodak Pavilion, 1964-65 New York World's Fair

Lev Zetlin
Consulting Engineer
Lev Zetlin & Associates
New York, New York

New Possibilities in the Construction of Prestressed Concrete Bridges

Ulrich Finsterwalder
Chief Engineer and Director
Dyckerhoff & Widmann K. G.
Munich, West Germany

Precast Barrel Shell Roof for Seattle Port Authority Transit Sheds

Robert F. Mast
Structural Consultant
Anderson, Birkeland, Anderson & Mast
Tacoma, Washington

15 Years of Slip-Form Concrete Paving

Gordon K. Ray
Manager
Harold J. Halm
Construction Engineer
Paving Bureau
Portland Cement Association
Chicago, Illinois

CONCURRENT SESSION

(2) DESIGN SESSION

9:00 a.m. — 12:00 Noon

Crystal Ballroom—Trinity Room

CHAIRMAN

James A. Morcom
Structural Field Engineer
Portland Cement Association
Houston, Texas

Design of Morrow Point Dam

Loyd R. Scrivner
Technical Assistant to Head,
Concrete Dams Section
Office of the Chief Engineer
U. S. Bureau of Reclamation
Denver, Colorado

High Strength Reinforcing Steel in Bridges

E. L. Hardeman
Senior Bridge Engineer
Texas Highway Department
Waco, Texas

Development Length for Large High Strength Reinforcing Bars

Phil M. Ferguson
Professor of Civil Engineering
J. Neils Thompson
Director, Balcones Research Center
University of Texas
Austin, Texas

Column Details under the 1963 ACI Building Code

Donald E. Anderson
Edward S. Hoffman
The Engineers Collaborative
Chicago, Illinois

RESEARCH SESSION

2:00 p.m. — 5:00 p.m.

Grand Ballroom

This annual open meeting of ACI Committee 115, Research, differs from general sessions in that the information is not released for publication. Request is made that the proceedings be regarded as CONFIDENTIAL.

CHAIRMAN

Chester P. Siess
(Chairman, ACI Committee 115)
Professor of
Civil Engineering
University of Illinois
Urbana, Illinois

Stephen J. Chamberlin
(Secretary, ACI Committee 115)
Professor of Theoretical
and Applied Mechanics
Iowa State University
Ames, Iowa

Michael A. Cassaro
Department of Civil Engineering
University of Florida
Gainesville, Florida

John F. Brothie
Senior Research Officer
Division of Building Research
Commonwealth Scientific and
Industrial Research Organization
Highett, Victoria, Australia

Boris Bresler
Chairman
Division of Structural Engineering
and Structural Mechanics
College of Engineering
University of California
Berkeley, California

C. L. Hulsbos
Research Professor of
Civil Engineering
Lehigh University
Bethlehem, Pennsylvania

**Evaluation of Static,
Dynamic, and Fatigue
Failure of Plain Concrete**

Don A. Linger
Professor of
Civil Engineering
University of Arizona
Tucson, Arizona

**Shear Bond Strength
between Aggregate and Paste:
Effects on Microcracking
and Fracture**

Bengt B. Broms
Associate Professor
of Civil Engineering

Michael A. Taylor
Former Research
Assistant

George Winter
Professor and Head
Structural Engineering
Department
Cornell University
Ithaca, New York

**Effects of Concrete
Parameters on
Crack Propagation**

James E. Lott
Research Associate
Department of Theoretical
and Applied Mechanics
University of Illinois
Urbana, Illinois

**Controlling Rapid Drying
of Fresh Concrete
by Evaporation Retardation**

William A. Cordon
Associate Professor of Civil
and Irrigation Engineering

J. Derle Thorpe
Assistant Research Engineer
Engineering Experiment Station
Utah State University
Logan, Utah

**Horizontal Shear Connection
in Composite Concrete
Beams**

**Properties of Fresh and
Hardened Concrete in Bridge
Decks as Affected by
Finishing Methods**

Howard Newlon, Jr.
Highway Research Engineer
Virginia Council of Highway
Investigation and Research
Charlottesville, Virginia

LADIES' PROGRAM

Registration in Ladies' Hospitality Room: the Sam Houston Room, 2nd floor. The Hospitality Room is open daily from 9:30 a.m. to 3:30 p.m., Monday through Thursday.

Monday, March 2

9:30 a.m. Registration and Get-Acquainted Coffee in Hospitality Room.

Tuesday, March 3

6:30 p.m. Attend the Ice-Breaker Buffet with your husband, Grand Ballroom. \$2.00 per person.

Wednesday, March 4

12:15 p.m. Awards Luncheon in Grand Ballroom. Ladies invited. \$4.00 per person.

2:30 p.m. Bus tour for ladies immediately following the Awards Luncheon. \$3.00 per person.

Thursday, March 5

12:00 Noon. Ladies' luncheon at Houston Club. \$5.00 per person.

Friday, March 6

9:30 a.m. Ladies invited to Inspection Trip. Conducted bus tour leaves the Main Street entrance of the Rice Hotel for 3-hour tour of construction projects including new highway interchanges, apartment and office buildings, Rice University campus, and 66,000-seat domed stadium—world's largest air-conditioned sports stadium for major league baseball and football. \$1.50 per person.

LADIES COMMITTEE

MRS. H. E. BOVAY, JR., *Chairman*
MRS. JAMES A. MORCOM
MRS. R. O. GRIMES
MRS. LUTHER E. BELL

HOUSTON CONVENTION COMMITTEES

GENERAL CHAIRMAN

H. E. BOVAY, JR.

VICE CHAIRMEN

JAMES A. MORCOM
R. O. GRIMES

SECRETARY

G. L. CUBBISON

TREASURER

STRATO BATMANIS

PROGRAM COMMITTEE (ADVISORY)

JAMES R. SIMS

PUBLICITY COMMITTEE

LUTHER E. BELL, *Chairman*
WILLIAM V. WARD
PHIL D. BARNARD

MEMBERSHIP COMMITTEE

WALTER P. EASTWOOD

INSPECTION TRIPS COMMITTEE

HERBERT M. SHILSTONE, JR., *Chairman*
EDWARD C. JANCIK

LADIES' ENTERTAINMENT COMMITTEE

MRS. H. E. BOVAY, JR., *Chairman*
MRS. JAMES A. MORCOM
MRS. R. O. GRIMES
MRS. LUTHER E. BELL

EDUCATIONAL CONTACTS COMMITTEE

ARDIS H. WHITE, *Chairman*
NAT W. KRAHL

EXHIBITS & DISPLAYS COMMITTEE

RONALD L. DE VIES, *Local Coordinator*

FINANCE COMMITTEE

A. J. MALLOY, *Chairman*
JOHN J. DAY, JR.
V. S. SKINNER

HOTEL & ENTERTAINMENT REGISTRATION COMMITTEE

JAMES A. CUMMINS, *Chairman*
J. RICHARD BRODERICK
GEORGE J. PAUL

ACI DOOR PRIZE CARD

To qualify for daily door prize drawings, visit the Educational-Technical Exhibits and have card rubber-stamped with corresponding booth numbers at each exhibit booth. Deposit card in Door Prize Drawing Box at registration desk. You need not be present at drawings to win, but give complete identification below.

1-2	3	4-5	6-7	8
9-10	11	12	13	14
15	16	17	18	19
20	21	22	23	24-25
26	27	28	29	30
31	32	33	34	

Name _____

Home Address _____

Hotel & Room No. _____

EXHIBIT HOURS

Mon., Mar. 2—2:00 p.m.-6:00 p.m. Wed., Mar. 4—10:00 a.m.-6:00 p.m.
 Tues., Mar. 3—10:00 a.m.-6:00 p.m. Thurs., Mar. 5—9:00 a.m.-5:00 p.m.

HOUSTON CONVENTION EXHIBITORS

The Educational-Technical Exhibits hold the answer to your concrete design construction problems. Visit the Exhibits daily to find out what's new in materials, equipment and services—and at the same time qualify for valuable door prizes.

Booth No(s)

- 1-2 Sika Chemical Corp., Passaic, N. J.
- 3 Protex Industries, Inc., Denver, Colo.
- 4-5 The Patent Scaffolding Co., Inc., Long Island City, N. Y.
- 6-7 United States Steel Corp., Pittsburgh, Pa.
- 8 Stressteel Corp., Wilkes-Barre, Pa.
- 9-10 National Gypsum Co., Buffalo, N. Y.
- 11 Architectural Concrete Consultants, Inc., Houston, Tex.
- 12 Rainhart Co., Austin, Tex.
- 13 Kwik-Mix Co., Port Washington, Wis.
- 14 Gateway Erectors, Inc., Chicago, Ill.
- 15 Thiokol Chemical Corp., Trenton, N. J.
- 16 The Prescon Corp., Corpus Christi, Tex.
- 17 Marathon, Division of American Can Co., Neenah, Wis.
- 18 The Master Builders Co., Cleveland, O.
- 19 Joseph T. Ryerson & Son, Inc., Chicago, Ill.
- 20 Sonoco Products Co., Hartsville, S. C.
- 21 Intrusion-Prepakt, Inc., Cleveland, O.
- 22 Griffolyn Co., Inc., Houston, Tex.
- 23 Erico Products, Inc., Cleveland, O.
- 24-25 W. R. Grace & Co., Dewey and Almy Chemical Division, Cambridge, Mass.
- 26 Mas Con Supply Co., Denver, Colo.
- 27 Vacuum Concrete Corporation of America, Philadelphia, Pa.
- 28 Molded Fiber Glass Co., Ashtabula, O.
- 29 True Gun-All Division, Detroit Tool Engineering Co., Lebanon, Mo.
- 30 Durox Management Co., Lake Elmo, Minn.
- 31 Richmond Screw Anchor Co., Inc., Brooklyn, N. Y.
- 32 Edoco Technical Products, Inc., Long Beach, Calif.
- 33 Jayhawk Fibre Form Co., Lawrence, Kans.
- 34 The Hausman Steel Co., Detroit, Mich.

CONTRIBUTOR

Hunt Process Corporation—Southern, Ridgeland, Miss.

EXHIBIT HOURS

Monday, March 2—2:00 p.m. - 6:00 p.m.

Tuesday, March 3—10:00 a.m. - 6:00 p.m.

Wednesday, March 4, 10:00 - 6:00 p.m.

Thursday, March 5—9:00 a.m. - 5:00 p.m.