

59<sup>TH</sup> ANNUAL  
CONVENTION

AAGU

MARCH 4-7, 1963

Atlanta Biltmore Hotel

ATLANTA, GEORGIA



PROGRAM

## BOARD OF DIRECTION

### President

RAYMOND C. REESE

### Vice-Presidents

ROGER H. CORBETTA AND BRYANT MATHER

### Directors

ARTHUR R. ANDERSON

A. ALLAN BATES

G. E. BURNETT

BRUCE E. FOSTER

BEN C. GERWICK, JR.

J. D. LINDSAY

JAMES A. MCCARTHY

C. P. SIESS

ANTON TEDESKO

J. NEILS THOMPSON

WILLIAM R. WAUGH

HUBERT WOODS

### Past Presidents

PHIL M. FERGUSON

JOE W. KELLY

LEWIS H. TUTHILL

### Secretary-Treasurer\*

WILLIAM A. MAPLES

## TECHNICAL ACTIVITIES COMMITTEE

(In charge of convention program and of technical publications)

CLYDE E. KESLER, *Chairman*

RAYMOND C. REESE, *Ex-Officio*

WILLIAM A. MAPLES, *Secretary\**

ARTHUR R. ANDERSON

G. E. BURNETT

A. T. HERSEY

WALTER J. MCCOY

PAUL F. RICE

JOSEPH J. SHIDELER

### \*Address

**AMERICAN CONCRETE INSTITUTE**

P.O. Box 4754, Redford Station

Detroit 19, Michigan

## CONVENTION REGISTRATION

**Monday—Thursday, March 4-7**

**8:00 a.m.—5:00 p.m. in Georgian Ballroom**

**Registration Fee — \$5.00**

All ladies and **registered** nonmember visitors are welcome to attend technical sessions, Awards Luncheon, and social activities.

**See bulletin board in registration area for special notices.**

## TECHNICAL COMMITTEE CHAIRMEN BREAKFASTS

**7:30 a.m. Monday**—Breakfast for chairmen of 300 Group Technical Committees (by invitation) in Empire Room

**7:30 a.m. Tuesday**—Breakfast for chairmen of 400 Group Technical Committees (by invitation) in Mezzanine Room

## NOTES FOR PROGRAM PARTICIPANTS

**7:30 a.m. Wednesday**—Breakfast for program participants (by invitation) in Room 10, Mezzanine Floor

**8:00 a.m. Thursday**—Breakfast for Research Session participants (by invitation) in Room 10, Mezzanine Floor

Upon recognition by the Chairman, a discussor will please state his name distinctly and go to the nearest microphone so that he may be heard by all.

A "Convention Review" will be published in the News Letter section of the May 1963 ACI JOURNAL.

## ACI CONVENTION AND PRESS HEADQUARTERS

Room 2, Mezzanine Floor

## SPECIAL EVENTS

**Exhibits** . . . Monday through Thursday in Georgian Ballroom and Exhibit Hall. Have your program card (inside back flap) stamped to qualify for valuable door prizes

**Ladies' Program** . . . See schedule elsewhere in this program book

**Cocktail Party** . . . 6:30 p.m., Tuesday, Empire Room. Your registration badge is your admission

**University of Illinois Alumni Breakfast** . . . 7:45 a.m. Wednesday, Room 1015

**Awards Luncheon** . . . 12:15 p.m., Wednesday, Empire Room. Purchase tickets by 10:00 a.m. Wednesday at the main convention registration desk.

**Post-Convention Tours** for Friday, March 8. (Tickets on sale in registration area)

Tour of Atlanta (4½ hours). Depart hotel 10:00 a.m. Tour includes Cyclorama, Stone Mountain, State Capitol, Emory University and Georgia Tech campuses, Lenox Square Shopping Center, and residential areas. \$3.60; box lunch optional \$1.75

Optional Concrete Construction Tour (2½ hours). Leave hotel 11:00 a.m. Tour includes housing project, Harper School, Southern Cement plant, Marquette Cement distributing plant, and Trust Company of Georgia Branch building. \$1.75

Optional Tour of Athens, Ga. (4½ hours). Depart hotel 10:30 a.m. Tour includes inspection of University of Georgia Pharmacy Building and Coliseum Project (under construction). \$2.00; box lunch optional \$1.75

## TECHNICAL COMMITTEE MEETINGS

All meetings are open except those indicated as executive or closed sessions. Meeting topics are in italics.

**Monday Morning, March 4**

**9:00 a.m. — 12:00 Noon**

Committee	Meeting Room
115	Research ( <i>Executive committee only—closed meeting</i> ) Ivory
207	Mass Concrete ( <i>Organization of project relating to design and construction of non-hydraulic structures</i> ) Mezzanine
209	Creep and Volume Changes in Concrete ( <i>Symposium on creep at 1964 ACI convention; ASTM test methods</i> ) Beige
213	Lightweight Aggregates and Lightweight Aggregate Concrete ( <i>Reorganization and new assignments</i> ) #10
301 (401)	Specifications for Structural Concrete ( <i>Final revisions for TAC and Standards Committee</i> ) #5 & #6
308 (612)	Recommended Practice for Curing Concrete ( <i>Revisions to previous report—Title No. 55-9</i> ) #1012
315	Detailing Reinforced Concrete Structures ( <i>Proposed revisions to Detailing Manual, ACI 315-57</i> ) #1009
322	Design of Structural Plain Concrete ( <i>Selection of subcommittee chairmen; schedule for collection of additional data and for final draft</i> ) Green
333	Design and Construction of Composite Structures, Joint ACI-ASCE Committee ( <i>Research and subcommittee reports</i> ) #1008
441 (341)	Reinforced Concrete Columns, Joint ACI-ASCE Committee ( <i>Closed meeting</i> ) #1015
442 (342)	Lateral Forces on Multistory Buildings ( <i>Reports, objective of committee, and format of final report</i> ) #1016
531 (331)	Structures of Concrete Masonry Units ( <i>Drafts of reports</i> ) #1010
Chapter Activities Committee	Chapter activities ( <i>Open to chapter officers only</i> ) #1007

Monday Afternoon, March 4

2:00 p.m. — 5:00 p.m.

Committee	Meeting Room
116	Nomenclature ( <i>Discussion of glossary; appointment of chairman</i> ) Mezzanine
Subcommittee 2 of 211 (613)	Recommended Practice for Proportioning Concrete Mixes ( <i>Proportioning of No-Slump Concrete</i> ) #1009
Subcommittee 1 of 213	Lightweight Aggregates and Lightweight Aggregate Concrete ( <i>Chapter assignments for Guide</i> ) #10
221 (621)	Aggregates ( <i>Discussion of future activities</i> ) #1012
Subcommittee 5 of 325	Structural Design of Concrete Pavements for Highways and Airports ( <i>Revisions to ACI Standard 325-58</i> ) Ivory
334	Concrete Shell Structures ( <i>Closed meeting</i> ) #1011
408 (208)	Bond Stress ( <i>Progress reports of various projects</i> ) #1007
423 (323)	Prestressed Concrete, Joint ACI-ASCE Committee ( <i>New committees; discussion of Chapter 26, ACI Building Code</i> ) #1010
437 (337)	Strength Evaluation of Existing Concrete Structures ( <i>Organization and mission of subcommittees</i> ) Green
439 (339)	High-Strength Reinforcement for Concrete ( <i>Report on provisions in new Building Code; research reports</i> ) Beige
441 (341)	Reinforced Concrete Columns, Joint ACI-ASCE Committee ( <i>Long-range problems and proposed activities of subcommittees</i> ) #1015
503 (403)	Adhesives for Concrete ( <i>Research reports; discussion of ACI "Guide for Use of Epoxy Compounds with Concrete"</i> ) #1008
504 (404)	Joint Sealants ( <i>Performance requirements and types of joints used in concrete construction</i> ) #1016
516 (716)	High Pressure Steam Curing ( <i>Discussion of revised committee report</i> ) #5 & #6

Monday Evening, March 4

7:00 p.m.

Committee	Meeting Room
Subcommittee 4 of 213	Lightweight Aggregates and Lightweight Aggregate Concrete ( <i>Task force reports</i> ) #10
318	Standard Building Code ( <i>Closed meeting</i> ) #1016
334	Concrete Shell Structures ( <i>Closed meeting</i> ) #1011
515 (616)	Coatings for Concrete ( <i>Draft of report</i> ) #1010
517 (717)	Practice in Low-Pressure Steam Curing ( <i>Committee report; research required; preparation of recommended practice</i> ) #1008
Chapter Activities Committee	Chapter Forum #1012

Do a Better Job in Concrete

... Visit the Educational-Technical Exhibits Daily

## Tuesday Morning, March 5

9:00 a.m. — 12:00 Noon

Committee	Meeting Room
201 Durability of Concrete in Service ( <i>Future activities</i> )	Beige
Subcommittee 2 of 213 Lightweight Aggregates and Lightweight Aggregate Concrete ( <i>Task force reports</i> )	#10
215 Fatigue of Concrete ( <i>Discussion of research, fatigue requirements in Building Code, and Bibliography</i> )	#3
307 (505) Design and Construction of Reinforced Concrete Chimneys ( <i>First draft of revised chimney specifications</i> )	#1007
334 Concrete Shell Structures	#1011
347 (622) Formwork for Concrete ( <i>Future role of committee</i> )	#1009
428 (328) Limit Design ( <i>Recent developments; subcommittee reports; plans for 1964 conference on limit design</i> )	#1012
435 (335) Deflection of Concrete Building Structures ( <i>Proposed new work to follow completion of two current reports</i> )	Mezzanine
436 (336) Combined Footings ( <i>Future program and membership</i> )	#5 & #6
438 (338) Torsion ( <i>Discussion of draft of tentative recommended practice, current researches, foreign codes, and organization of subcommittees</i> )	#1015
504 (404) Joint Sealants ( <i>Performance requirements and types of joints used in concrete construction</i> )	#1016
506 (805) Application of Mortar by Pneumatic Pressure ( <i>Subcommittee reports</i> )	#1010
533 (633) Precast Panels ( <i>Subcommittee reports</i> )	#1008
543 (343) Concrete Piles ( <i>Progress report</i> )	Green
Monograph Committee ( <i>Closed meeting</i> )	Ivory

## Tuesday Afternoon, March 5

2:00 p.m. — 5:00 p.m.

Committee	Meeting Room
211 (613) Recommended Practice for Proportioning Concrete Mixes ( <i>Revisions to ACI Standard 613-54</i> )	Beige
212 Admixtures ( <i>Preparation of recommended practices for certain types of admixtures</i> )	#10
214 Evaluation of Results of Strength Tests of Concrete ( <i>Appendix to ACI Standard 214-57; survey report</i> )	#3
216 Fireproofing or Fire Protection of Structures ( <i>Discussion of outline for proposed "Guide;" further programming</i> )	#5 & #6
311 (611) Inspection of Concrete ( <i>Discussion of check list for batch plants and series of practical illustrated articles</i> )	Green
313 (714) Concrete Bins and Silos ( <i>Bin construction</i> )	Ivory
317 Reinforced Concrete Design Handbook ( <i>Revisions to Handbook</i> )	#1009
344 Circular Prestressed Concrete Structures ( <i>First draft of proposed recommended practice</i> )	#1015
421 (321) Design of Reinforced Concrete Slabs, Joint ACI-ASCE Committee ( <i>Closed meeting</i> )	#1007
428 (328) Limit Design, Joint ACI-ASCE Committee ( <i>Recent developments; subcommittee reports; plans for 1964 conference on limit design</i> )	#1012
512 (712) Precast Structural Concrete Design and Construction, Joint ACI-ASCE Committee ( <i>Discussion of committee report</i> )	#1016
523 (623) Cellular Concretes ( <i>Discussion of new mission; reorganization of subcommittees</i> )	#1010

## Tuesday Afternoon, March 5

4:00 p.m.

302 (402) Concrete Floor Finishes ( <i>This meeting will follow finishing demonstration at Whitley Construction Company plant in Decatur, Ga., from 1:00 to 4:00 p.m. Buses leave hotel at 12:30 p.m. Sign up for trip at Registration Desk — registration on first come, first served basis</i> )	Mezzanine
---	-----------

**AWARDS LUNCHEON**

**12:15 p.m.**

**EMPIRE ROOM**

**Presentation of Awards**

**HENRY C. TURNER MEDAL to**

CHARLES H. SCHOLER

*"For his great and foresighted contributions to concrete technology and his inspiration of new thinking and improvements in concrete"*

**ALFRED E. LINDAU AWARD to**

CARL A. MENZEL

*"For his pioneering contribution to reinforced concrete design through the development of a modern deformed reinforcing bar"*

**HENRY L. KENNEDY AWARD to**

IVAN L. TYLER

*"For more than 25 years of conscientious service as chairman or member of a number of Institute technical committees which significantly contributed to the knowledge of concrete as a material"*

**WASON MEDAL FOR RESEARCH to**

ELMO C. HIGGINSON

*For his paper "Effect of Steam Curing on the Important Properties of Concrete," published in the September 1961 ACI JOURNAL*

**WASON MEDAL FOR "THE MOST MERITORIOUS PAPER" to**

M. O. WITHEY

*Awarded posthumously for his paper "Fifty-year Compression Test of Concrete," published in the December 1961 ACI JOURNAL*

**CONSTRUCTION PRACTICE AWARD to**

ARTHUR R. ANDERSON

AND

A. T. WADELICH

*For their paper "Prestressed and Precast Concrete Building at Boeing Plant," published in the July 1961 ACI JOURNAL*

**Announcement of Election to Honorary Membership**

SOLOMON C. HOLLISTER

MAXWELL M. UPSON

**Recognition of Retiring Officers**

**Report of Tellers and Introduction of New Officers**

**Presentation of Memento to Retiring President**

**FIRST GENERAL SESSION**

**9:00 a.m. — 12:00 Noon**  
**Exhibit Hall Meeting Room**

**CO-CHAIRMEN**

**George H. Nelson**  
President

Law Engineering Testing  
Company  
Atlanta, Georgia  
& Chairman  
Atlanta Convention Committee

**Raymond C. Reese**  
Principal

Raymond C. Reese Associates  
Consulting Engineers  
Toledo, Ohio  
& President,  
American Concrete Institute

**Retiring President's Address**

**Raymond C. Reese**

**Revisions to the Institute Bylaws**

**Bryant Mather**  
Chairman of  
Board Committee  
on Bylaws  
Revision

**Proposed Revisions to ACI Standard 318-56, "Building Code Requirements for Reinforced Concrete"**

**Raymond C. Reese**  
Chairman  
ACI Committee 318

**Technical Committee Progress Reports**  
**(As time allows)**

**MODERATOR**  
**Samuel H. Henry**  
Technical Director  
American Concrete Institute

# ACI CONVENTION AREA

## ROOM LOCATOR MAP FOR ATLANTA BILTMORE HOTEL

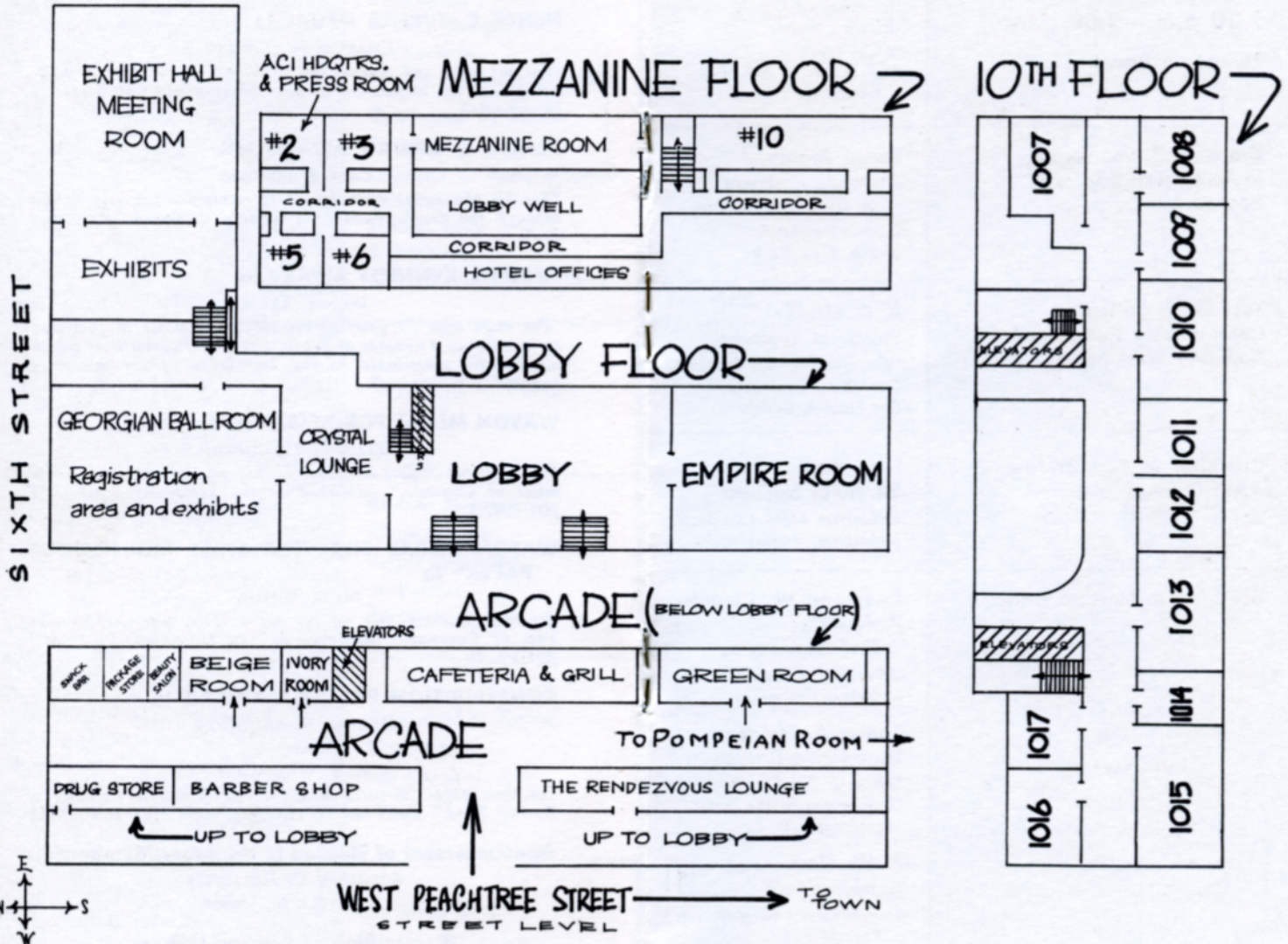

<b>CONCURRENT SESSION</b>	<b>CHAIRMAN</b> <b>Clyde E. Kesler</b> Professor of Theoretical & Applied Mechanics College of Engineering University of Illinois Urbana, Illinois & Chairman ACI Technical Activities Committee
<b>(1) CRACKING IN CONCRETE</b>  <b>2:30 p.m.—5:00 p.m.</b>  <b>Pompeian Room</b>	
<b>Cracking Phenomenon in Reinforced Concrete Beams</b>	<b>Bengt Broms</b> Associate Professor of Civil Engineering Cornell University Ithaca, New York
<b>Test Investigation of Continuously Reinforced Concrete Pavements</b>	<b>R. C. Elstner</b> Structural Engineer Wiss, Janney and Associates Consulting Engineers Des Plaines, Illinois
<b>Cracking in Test Bridges—AASHO Road Test</b>	<b>Ivan Viest</b> Structural Engineer Bethlehem Steel Company Bethlehem, Pennsylvania
<b>Cracking in Norfolk Dam</b>	<b>Raymond W. Clough</b> Professor of Civil Engineering University of California Berkeley, California  <b>James A. Rhodes</b> Engineering Division Office of Chief of Engineers Department of the Army Washington, D. C.  <b>F. W. Sims</b> Chief Foundations and Materials Branch U.S. Army Engineer District, Little Rock Little Rock, Arkansas

<b>CONCURRENT SESSION</b>	<b>CHAIRMAN</b> <b>William R. Waugh</b> Chief, Concrete Branch Office of Chief of Engineers Department of the Army Washington, D. C.
<b>(2) CONSTRUCTION PROBLEMS</b>  <b>2:30 p.m.—5:00 p.m.</b>  <b>Exhibit Hall Meeting Room</b>	
<b>Formwork for Concrete</b>	<b>Paul F. Rice</b> Technical Director Concrete Reinforcing Steel Institute Chicago, Illinois
<b>Tolerances in Building Construction</b>	<b>Arthur R. Anderson</b> Partner Anderson, Birkeland & Anderson Tacoma, Washington  <b>Roger H. Corbetta</b> Chairman of the Board Corbetta Construction Company New York, New York  <b>Raymond C. Reese</b> Principal Raymond C. Reese Associates Toledo, Ohio
<b>Atlanta Merchandise Mart: Combined Precast and Cast-in-Place Concrete Building</b>	<b>Virgil D. Skipper</b> Vice-President MacDougald-Warren, Inc. Atlanta, Georgia
<b>New Concrete Is Not for Burning—The Investigation and Repair of Damage to Concrete Caused by Formwork and Falsework Fires</b>	<b>Peter Smith</b> Senior Materials Engineer Materials and Research Section Ontario Department of Highways Toronto, Ontario



**CONCURRENT SESSION****(1) CONSTRUCTION****9:00 a.m. — 12:00 Noon****Exhibit Hall Meeting Room****CHAIRMAN****Roger H. Corbetta**

Chairman of the Board

Corbetta Construction Company

New York, New York

&amp; Vice President,

American Concrete Institute

**Precast Prestressed Flat Plate Motel Structure in Minneapolis****Ross H. Bryan**

Consulting Engineer

Nashville, Tennessee

**Multistory Building Framed in Precast, Prestressed, and Cast-in-Place Concrete****Hal W. Birkeland**

Partner

Anderson, Birkeland &amp; Anderson

Tacoma, Washington

**Structural Lightweight Concrete****Frank G. Erskine**

Managing Director

**Daniel P. Jenny**

Chief Engineer

Expanded Shale Clay and

Slate Institute

Washington, D. C.

**Construction of Shell for Chapel of Priory School, St. Louis****Timothy McCarthy**

Vice-President

McCarthy Brothers Construction

Company

St. Louis, Missouri

**CONCURRENT SESSION****(2) BEHAVIOR OF MEMBERS AND FRAMES****9:00 a.m. — 12:00 Noon****Pompeian Room****CHAIRMAN****James A. McCarthy**

Professor of

Civil Engineering

University of Notre Dame

Notre Dame, Indiana

**The Restrained Long Concrete Column as a Part of a Rectangular Frame****John E. Breen**

Associate Professor of

Civil Engineering

**Phil M. Ferguson**

Professor of

Civil Engineering

University of Texas

Austin, Texas

**Behavior of Reinforced Concrete Frames Subjected to Repeated Reversible Loads****Vitelmo V. Bertero**

Associate Professor of

Civil Engineering

University of California

Berkeley, California

**George McClure**

Instructor of Civil Engineering

Montana State College

Bozeman, Montana

**Structural Model of Multistory Flat Plate Building****Jack R. Janney**

Associate

Wiss, Janney and Associates

Consulting Engineers

Des Plaines, Illinois

**High Strength Bars as Column Reinforcement****Eivind Hognestad**

Manager

Structural Development Section

Research and Development

Laboratories

Portland Cement Association

Skokie, Illinois

<p><b>RESEARCH SESSION</b></p> <p><b>2:00 p.m. — 5:00 p.m.</b></p> <p><b>Exhibit Hall Meeting Room</b></p> <p>This annual open meeting of ACI Committee 115, Research, differs from general sessions in that the information is not released for publication. Request is made that the proceedings be regarded as CONFIDENTIAL.</p>	<p><b>CHAIRMAN</b></p> <p><b>Chester P. Siess</b> (Chairman, ACI Committee 115) Professor of Civil Engineering University of Illinois Urbana, Illinois</p> <p><b>S. J. Chamberlin</b> (Secretary, ACI Committee 115) Professor of Engineering Mechanics Iowa State University Ames, Iowa</p>	<p><b>Use of Infrared Absorption to Characterize Compounds of Interest in Cement Chemistry</b></p>	<p><b>C. M. Hunt</b> National Bureau of Standards Washington, D. C.</p>
<p><b>Concrete Prepared with Lightweight Aggregates</b></p>	<p><b>D. O. Woolf</b> Chief, Concrete Section Bureau of Public Roads Washington, D. C.</p>	<p><b>Bearing Strength of Precast Concrete Column Brackets.</b></p>	<p><b>L. B. Kriz</b> <b>C. H. Rath</b> Associate Development Engineers Research and Development Laboratories Portland Cement Association Skokie, Illinois</p>
<p><b>Effect of Coarse Aggregate on the Drying Shrinkage of Concrete</b></p>	<p><b>John R. Wilson</b> Manager of Research Laboratory National Ready Mixed Concrete Association Washington, D. C.</p>	<p><b>Shear Strength of Members of Circular Cross Sections</b></p>	<p><b>Roger Diaz de Cossio</b> Professor of Engineering National University of Mexico Mexico City, Mexico</p>
<p><b>Influence of Cement Paste Content on Creep of Concrete</b></p>	<p><b>A. M. Neville</b> Professor of Civil Engineering University of Saskatchewan Saskatoon, Saskatchewan, Canada</p>	<p><b>Fatigue Failure of Prestressed Concrete Beams</b></p>	<p><b>F. S. Ople, Jr.</b> Fritz Engineering Laboratory Lehigh University Bethlehem, Pennsylvania</p>
<p><b>Ultra-Strength Concrete</b></p>	<p><b>Thomas B. Kennedy</b> Chief, Concrete Division U.S. Army Engineer Waterways Experiment Station Jackson, Mississippi</p>	<p><b>An Experimental Study of the Properties of Yield at a Point in a Concrete Slab with Isotropic Reinforcing on the Tension Side Only</b></p>	<p><b>Robert M. Dinnat</b> School of Civil Engineering Georgia Institute of Technology Atlanta, Georgia</p>

## LADIES' PROGRAM

### Monday, March 4

**9:00 to 11:30 a.m. Empire Room.** Registration and Get-Acquainted Coffee. Board buses in front of Biltmore Hotel at 11:30 for luncheon and fashion show at Yohannan's Restaurant followed by shopping on the Mall at Lenox Square. Board buses at 3:15 p.m. for return to Biltmore.

### Tuesday, March 5

**9:30 a.m.** Board buses in front of Biltmore for Continental Breakfast at Rich's Department Store at 10:00 a.m. followed by shopping at Rich's Department Store. (Either trolleys or taxis are available for return to hotel on your own, as not everybody will shop the same length of time.)

**6:30 p.m.** Cocktail Party — Empire Room

### Wednesday, March 6

**9:00 a.m. to 11:30 a.m.** Coffee in Rooms 1008 & 1009

**12:15 p.m.** Awards Luncheon — Empire Room

**1:30 to 4:00 p.m.** Bridge (if desired) and coffee

### Thursday, March 7

**10:00 a.m.** Board buses in front of hotel for brunch at the Coach House. Tour of Atlanta Art Museum which has on display "Whistler's Mother" and other famous paintings.

**1:30 to 4:00 p.m.** Coffee in Rooms 1008 & 1009

### Friday, March 8

Go with your husbands on one of 3 post-convention tours. See Special Events page elsewhere.

## LADIES COMMITTEE

MRS. GEORGE H. NELSON, *Chairman*

MRS. V. D. SKIPPER, *Co-Chairman*

MRS. DAVENPORT STEWARD  
MRS. J. D. MCFARLAN  
MRS. RICHARD HOLLEY  
MRS. T. Z. CHASTAIN  
MRS. KARL DECKER  
MRS. OTTO FREI  
MRS. LANE WILCOX  
MRS. W. C. LAW

MRS. W. G. SANDERS  
MRS. JACK NUNN  
MRS. SAM E. HYDE, JR.  
MRS. F. W. SCHUTZ  
MRS. D. A. POLYCHROME  
MRS. CLINTON JONES  
MRS. W. M. COOLIDGE  
MRS. B. B. ROTHSCHILD

MRS. I. E. MORRIS

## ATLANTA CONVENTION COMMITTEE

### GENERAL CHAIRMAN

GEORGE H. NELSON

### EXHIBITS AND FINANCE COMMITTEE

V. D. SKIPPER, *Chairman*

EDWARD ESTES, JR., *Co-Chairman*

### PUBLICITY COMMITTEE

DAVENPORT STEWARD, *Chairman*

HARRY MITCHELL, *Co-Chairman*

### REGISTRATION AND ROSTER COMMITTEE

J. D. MCFARLAN, *Co-Chairman*

RICHARD HOLLEY, *Co-Chairman*

### MEMBERSHIP PROMOTION COMMITTEE

T. Z. CHASTAIN, *Chairman*

KARL DECKER, *Co-Chairman*

### INSPECTION TRIPS COMMITTEE

OTTO FREI, *Chairman*

LANE WILCOX, *Co-Chairman*

W. C. LAW

### HOUSE COMMITTEE

W. G. SANDERS, *Chairman*

JACK NUNN, *Co-Chairman*

SAM E. HYDE, JR.

### EDUCATIONAL CONTACTS COMMITTEE

F. W. SCHUTZ, *Chairman*

D. A. POLYCHROME, *Co-Chairman*

### SOCIAL EVENTS COMMITTEE

CLINTON JONES, *Chairman*

W. M. COOLIDGE, JR., *Co-Chairman*

B. B. ROTHSCHILD

### LADIES ENTERTAINMENT COMMITTEE

MRS. GEORGE H. NELSON, *Chairman*

MRS. V. D. SKIPPER, *Co-Chairman*



# ATLANTA CONVENTION

## EXHIBITORS & CONTRIBUTORS

Keep up with latest developments in concrete technology, materials, equipment and services. Visit the Exhibits daily in the Georgian Ballroom and Exhibit Hall.

### Booth No(s)

- 1 Allen Terry Co., Salt Lake City, Utah
- 2 American Steel & Wire Division of U.S. Steel, Pittsburgh, Pa.
- 3 Concrete Accessories Corp., Zelienople, Pa.
- 12 Erico Products, Inc., Cleveland, Ohio
- 13 Tectum Corp., Columbus, Ohio
- 14-25 Sonneborn Building Products, Inc., New York, N. Y.
- 26 Joseph T. Ryerson & Son, Inc., Chicago, Ill.
- 27 Marathon, Division of American Can Corp., Neenah, Wis.
- 28 Chicago Fly Ash Co. & Associated Companies
- 29 Vacuum Concrete Corp. of America, Philadelphia, Pa.
- 30 Calcium Chloride Institute, Washington, D. C.
- 31 L. F. Popell Co., Inc., Miami, Fla.
- 32 Sonoco Products Co., Hartsville, S. C.
- 32A Azar Manufacturing Co., Inc., Chatsworth, Calif.
- 33 The Master Builders Co., Cleveland, Ohio
- 34 Gateway Erectors, Inc., Chicago, Ill.
- 35 Sika Chemical Corp., Passaic, N. J.
- 36 The Prescon Corp., Corpus Christi, Tex.
- 37 Lee Turzillo Contracting Co., Brecksville, Ohio
- 38-41 Bethlehem Steel Co., Inc., Bethlehem, Pa.
- 39 Molded Fiber Glass Co., Ashtabula, Ohio
- 40 Intrusion-Prepakt, Inc., Cleveland, Ohio
- 42 Meadow Steel Products, Inc., Birmingham, Ala.
- 43 Protex Industries, Inc., Denver, Colo.

### CONTRIBUTORS

American Concrete Pipe Association  
Dewey and Almy Chemical Division, W. R. Grace & Company  
Hunt Process Corporation — Southern