

56th Annual ACI Convention



Hotel Commodore
New York City
March 14-17, 1960

AMERICAN CONCRETE INSTITUTE

BOARD OF DIRECTION

President

PHIL M. FERGUSON

Vice-Presidents

JOE W. KELLY AND LEWIS H. TUTHILL

Secretary-Treasurer*

WILLIAM A. MAPLES

Directors

ARSHAM AMIRIKIAN
WILLIAM H. ARMSTRONG
S. J. CHAMBERLIN
ROGER H. CORBETTA
GEORGE C. ERNST
E. A. FINNEY
ROBERT C. JOHNSON
BRYANT MATHER
WALTER J. MCCOY
RAYMOND C. REESE
C. D. WAILES, JR.
CEDRIC WILLSON

Past Presidents

FRANK KEREKES

WALTER H. PRICE

DOUGLAS MCHENRY

TECHNICAL ACTIVITIES COMMITTEE

(In charge of convention program and of technical publications)

WALTER J. MCCOY, *Chairman*
PHIL M. FERGUSON, *Ex-Officio*
WILLIAM A. MAPLES, *Secretary**
G. E. BURNETT
E. A. FINNEY
CLYDE E. KESLER
BRYANT MATHER
MICHAEL V. PREGNOFF
JOSEPH J. SHIDELER

* Address

AMERICAN CONCRETE INSTITUTE

P. O. Box 4754, Redford Station
Detroit 19, Michigan

CONVENTION REGISTRATION

Monday — Thursday

March 14-17, 1960

9:00 a.m.—5:00 p.m. Daily

Registration Fee — \$5.00

All ladies and **registered** nonmember visitors are welcome to attend technical sessions, Awards Luncheon, and social activities.

See bulletin board for special notices

TECHNICAL COMMITTEE MEETINGS

See pages 4, 5 and 6 and bulletin board at registration desk for time and location.

NOTES FOR PROGRAM PARTICIPANTS

8:00 a.m. Tuesday — Breakfast for all scheduled program participants in general convention sessions (By Invitation) Parlor A.

Upon recognition by the Chairman, a discussor will please state his name distinctly and go to the nearest microphone so that he may be heard by all.

A "Convention Review" will be published in the News Letter section of the ACI JOURNAL.

**ACI CONVENTION AND PRESS
HEADQUARTERS — PARLOR G**

TECHNICAL COMMITTEE MEETINGS

(Visitors welcome at all meetings except at executive and closed sessions.)

Sunday, March 13

9:00 a.m.—5:00 p.m.

Committee	Meeting Room
326 Shear and Diagonal Tension, Joint ACI-ASCE	103

Monday, March 14

9:00 a.m.—12:00 Noon

201 Durability of Concrete in Service	Parlor A
207 Properties of Mass Concrete	Parlor D
208 Bond Stress	103
213 Properties of Lightweight Aggregates and Lightweight Aggregate Concrete	W. Ballroom Parlor
213 Subcommittee 1	W. Ballroom Parlor
216 Fireproofing or Fire Protection of Structures (also p.m.)	Parlor E
331 Structures of Masonry Units	Parlor B
334 Concrete Shell Structures	Parlor C
335 Deflection of Concrete Building Structures	Parlor F
336 Combined Footings	104
621 Aggregates	102
622 Formwork for Concrete	Club Suite East
712 Precast Structural Concrete Design and Construction, Joint ACI-ASCE (See also p.m.)	Club Suite West

Monday, March 14

2:00 — 5:00 p.m.

116 Nomenclature	South Room
209 Creep in Concrete	104
213 Subcommittee 2	Parlor D
Subcommittee 3	Parlor D

216 Fireproofing or Fire Protection of Structures	Parlor E
318 Standard Building Code, Subcommittee 2 Subcommittee 15	Parlor B Parlor F
324 Precast Reinforced Concrete, Thin Sections	102
401 Specifications for Structural Concrete	Parlor A
611 Inspection of Concrete	Parlor C
613 Proportioning Concrete Mixes	W. Ballroom Parlor
613 Subcommittee on No Slump Concrete	W. Ballroom Parlor
712 Precast Structural Concrete Design and Construction — Joint ACI-ASCE	Club Suite West
714 Concrete Bins and Silos	Club Suite East
716 High Pressure Steam Curing	E. Ballroom Parlor

Monday, March 14

7:00 p.m.

318 Standard Building Code (closed session)	South Room
Concrete Construction in the USSR and Poland (Slide Films)	Parlors B & C

Tuesday, March 15

9:00 a.m.—12:00 Noon

115 Research (Executive Group only)	Parlor D
212 Admixtures	South Room
213 Subcommittee 4	W. Ballroom Parlor
213 Properties of Lightweight Aggregates and Lightweight Aggregate Concrete	W. Ballroom Parlor
214 Evaluation of Results of Strength Tests of Concrete	Parlor E
318 Standard Building Code, Subcommittee 8	103
328 Limit Design, Joint ACI-ASCE	E. Ballroom Parlor
339 Allowable Stresses in Reinforcement	Parlor F
505 Design and Construction of Reinforced Concrete Chimneys	Parlor A

609	Consolidation of Concrete	Parlor B
612	Curing Concrete	Parlor C
623	Cellular Concrete	Club Suite West
717	Low-Pressure Steam Curing Chapter Representatives	Club Suite East 102

Wednesday, March 16

7:00 p.m.

318	Standard Building Code (closed session)	South Room
-----	--	------------

NEW YORK CONVENTION COMMITTEE

General Committee

ROGER H. CORBETTA — <i>Chairman</i>	
ADMIRAL JOHN J. MANNING (Ret.) — <i>Treasurer</i>	
DUGALD J. CAMERON — <i>Secretary</i>	
MAX ABRAMOVITZ	FRANK KELLY
BOYD ANDERSON	BROTHER AMANDUS LEO
W. A. BLAHA	ROBERT K. LOCKWOOD
WALDO G. BOWMAN	WILLIAM J. MCINTOSH
GEORGE N. COHEN	J. C. MCCLURE
CLAYTON L. DAVIS	M. J. McMILLAN
FRED J. DRISCOLL	A. F. MOORE
WILLIAM EIPEL	WILLIAM H. MUESER
GEORGE F. FERRIS	H. T. NOYES
A. L. GLASSETT	EMIL H. PRAEGER
ERNST GRUENWALD	ANTON TEDESKO
ELLIOT A. HALLER	MAXWELL UPSON
MRS. ELLIOT A. HALLER	CARL YOUNGDAHL

Special Committees

Entertainment

M. J. McMILLAN — *Chairman*
Local Committee Members

Publicity

FRED J. DRISCOLL — *Chairman*
REAR ADM. MARTIN W. KEHART EMIL H. PRAEGER

Membership Promotion

DR. JACOB FELD — *Chairman*
MAX ABRAMOVITZ ERNST GRUENWALD
PETER R. FOSS L. D. LONG
W. J. MCGINNISS

Inspection Trips

ELLIOT A. HALLER — *Chairman*
BOYD ANDERSON JOHN M. KYLE
GREGORY E. BROOKS FREDERICK S. MERRITT
JAMES E. HALPIN WILLIAM H. MUESER
WILLIAM W. KARL R. G. WATSON

Ladies Program

MRS. ELLIOT A. HALLER — *Chairman*
MISS HELEN E. CASEY MRS. H. T. NOYES
MRS. HELEN LABAHN MRS. GEORGE F. PAVARINI
MRS. ROBERT K. LOCKWOOD MRS. WALTER PRICE
MRS. JOHN J. MANNING MRS. RAYMOND C. REESE
MRS. DOUGLAS MCHENRY MISS ROSETTE TARRICONE
MRS. M. J. McMILLAN MISS THELMA WEISS

Educational

BROTHER AMANDUS LEO — *Chairman*
MILTON ALPERN WILLIAM S. LALONDE, JR.
ADM. W. MACK ANGAS (Ret.) ROBERT W. MCLOUGHLIN
SIDNEY BORG JAMES MICHALOS
JEWEL M. GARRELTS CHARLES E. SCHAFFNER
OLINDO GROSSI ESMOND SHAW
PAUL HARTMAN JAMES GROTE VANDERPOOL
JOSEPH WIENFELD

Exhibits

ROBERT K. LOCKWOOD — *Chairman*
WILLIAM GRIFFIN DAN MORRIS
JAMES NOONAN

Finance

GEORGE F. FERRIS — *Chairman*
ROGER H. CORBETTA WILLIAM H. MUESER
ADM. JOHN J. MANNING H. T. NOYES

NOTES

FIRST GENERAL SESSION

Tuesday, March 15

2:00 p.m.—5:00 p.m.

President's Address — PHIL M. FERGUSON,
University of Texas

Appointment of Tellers to canvass ballots

Committee Reports:

Committee 326
Shear and Diagonal Tension
EIVIND HOGNESTAD, *Chairman*

Committee 401
Specifications for Structural Concrete
GEORGE H. NELSON, *Chairman*

Committee 609
Consolidation of Concrete
JOSEPH J. WADDELL, *Chairman*



6:00 p.m.

Cocktail Party

Grand Ballroom

This party is presented with the compliments of the New York committee. Wear your badge; it is your ticket of admission.

Wednesday, March 16
9:00 a.m.—12:00 Noon
WEST BALLROOM

CONCURRENT

(1) MODEL TESTS

JOE W. KELLY, *Chairman*

Testing Rigid Frame Bridge Model to Ultimate Load

C. S. WU
California Institute of Technology

A. A. PAP
and

D. H. PLETTA
Virginia Polytechnic Institute

Structural Models Evaluate Behavior of Concrete Dams

JEROME M. RAPHAEL
University of California

Glen Canyon Dam Structural Model Tests

GEORGE C. ROUSE
U. S. Bureau of Reclamation

Experiments with Thin-Shell Structural Models

J. L. WALING
and
LONGIN B. GRESZCZUK
Purdue University

Wednesday, March 16
9:00 a.m.—12:00 Noon
GRAND BALLROOM

SESSIONS

(2) HIGHWAYS

LEWIS H. TUTHILL, *Chairman*

Air-Entrained Concrete After 20 Years

E. A. FINNEY
and
RAY DURFEE
Michigan State Highway Department

Continuous Placement of Concrete on Three-Span Continuous Units of Bruckner Highway

H. B. BRITTON
State of New York Department of Public Works

The AASHO Road Test—A Background Report

FRANK H. SCRIVNER
(presented by W. R. Hudson)
AASHO Road Test

Gravel Beneficiation in Michigan

F. E. LEGG, JR.
University of Michigan
and
W. W. McLAUGHLIN
Michigan State Highway Department

ACI CONVENTION AREA HOTEL COMMODORE

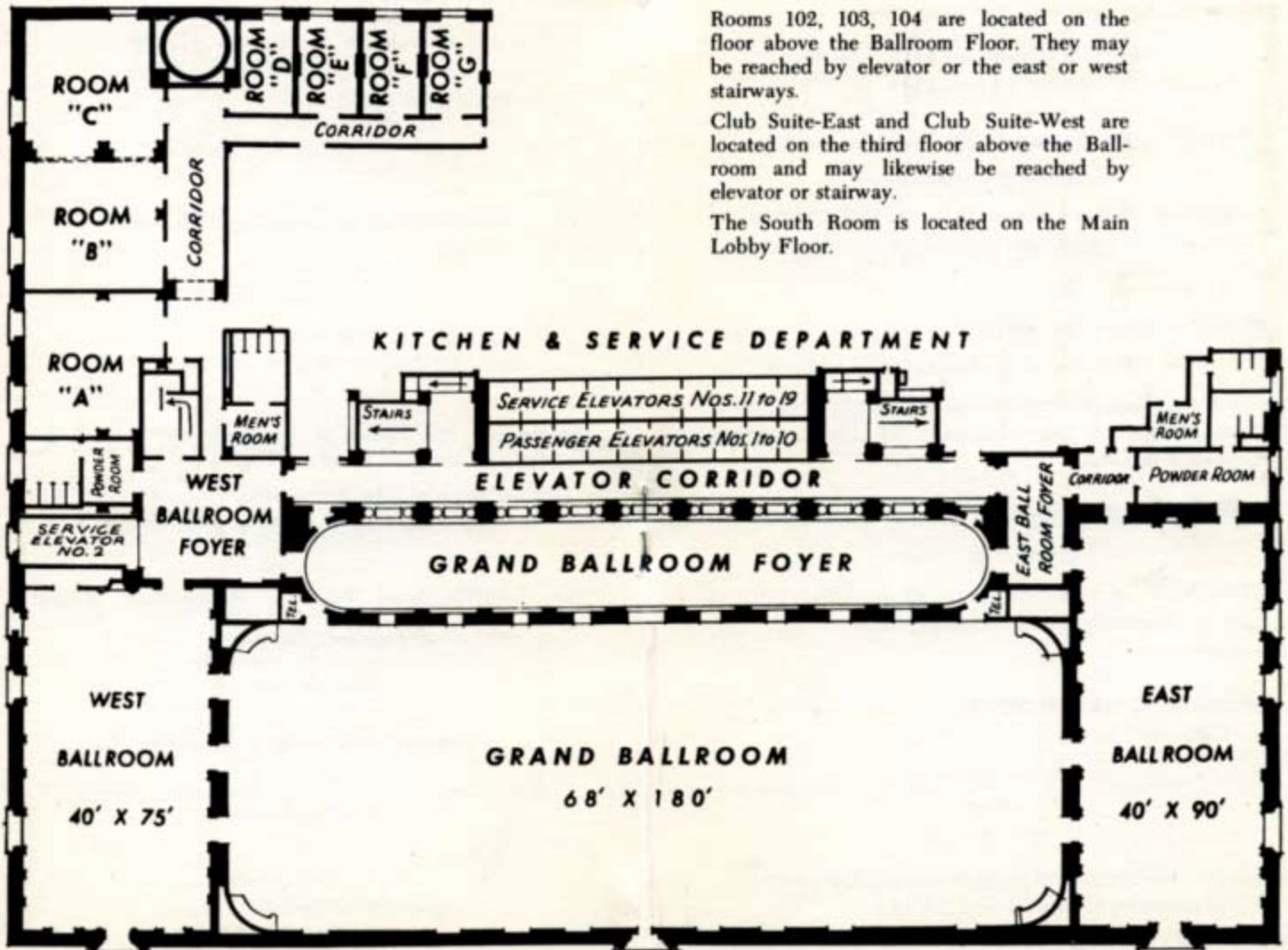

Rooms 102, 103, 104 are located on the floor above the Ballroom Floor. They may be reached by elevator or the east or west stairways.

Club Suite-East and Club Suite-West are located on the third floor above the Ballroom and may likewise be reached by elevator or stairway.

The South Room is located on the Main Lobby Floor.

Wednesday, March 16
AWARDS LUNCHEON

12:15 p.m.

GRAND BALLROOM

Presentation of Awards
by
President Ferguson on behalf of the
Board of Direction

HENRY C. TURNER MEDAL to

HARRISON F. GONNERMAN

"In recognition of his numerous and outstanding contributions to concrete technology through research and administration."

HENRY L. KENNEDY AWARD to

HARRY C. DELZELL

"In recognition of his outstanding contributions to the advancement of the objectives of the American Concrete Institute."

ALFRED E. LINDAU AWARD to

ARTHUR R. LORD

"Originator of reinforced concrete building tests; a pioneer authority in the development of flat slab construction."

LEONARD C. WASON MEDAL for "Noteworthy Research" to

BORIS BRESLER
and
K. S. PISTER

for the work reported in their paper (Proceedings V. 55, September, 1958 ACI JOURNAL).

"Strength of Concrete Under Combined Stresses."

LEONARD C. WASON MEDAL for "The Most Meritorious Paper" of ACI Proceedings V. 55 (July, August, September and October 1958 ACI JOURNALS).

JAMES E. BACKSTROM

RICHARD W. BURROWS

HARRY L. FLACK

RICHARD C. MIELENZ

and

VLADIMIR E. WOLKODOFF

for their four-part paper:

"Origin, Evolution, and Effects of the Air Void System in Concrete."

CONSTRUCTION PRACTICE AWARD to

J. F. CAMELLERIE

for his paper (Proceedings V. 55, April 1959 ACI JOURNAL).

"Slip Form Details and Techniques"

Announcement of Election to Honorary Membership

WILLIAM LERCH

CHARLES H. SCHOLER

Presentation of Plaque to Retiring President

Report of Tellers and Introduction of New Officers

Wednesday, March 16

2:30 p.m.—5:00 p.m.

WEST BALLROOM

CONCURRENT

(1) MATERIALS

FRANK KEREKES, *Chairman*

Effect of Incomplete Consolidation on Pulse Velocity, Modulus of Elasticity, and Compressive and Flexural Strength of Concrete

M. F. KAPLAN

South African Council of Scientific and Industrial Research

Freeze-Thaw Resistance of Concrete Made with Lightweight Aggregates

PAUL KLIEMER

Portland Cement Association

Effect of Maximum Size of Coarse Aggregate on Properties of Concrete

STANTON WALKER

and

D. L. BLOEM

National Ready Mixed Concrete Association

Concrete-Making Properties of a Portland Blast Furnace Slag Cement Made with High-Magnesia Blast-Furnace Slag

N. STUTTERHEIM

National Building Research Institute

South African Council for Scientific and Industrial Research

Wednesday, March 16

2:30 p.m.—5:00 p.m.

GRAND BALLROOM

SESSIONS

(2) DESIGN AND STRUCTURAL RESEARCH

DOUGLAS MCHENRY, *Chairman*

**High Strength Reinforcement in Concrete Structures
Preliminary Report of Committee 339**

ROBERT SAILER

U. S. Bureau of Reclamation

Shrinkage and Creep in Concrete

INGE LYSE

University of Norway

Effect of Draped Reinforcement on Behavior of Prestressed Concrete Beams

J. G. MACGREGOR

M. A. SOZEN

and

C. P. SISS

University of Illinois

Ultimate Strength Design

A. L. PARME

Portland Cement Association

Thursday, March 17
9:00 a.m.—12:00 Noon
GRAND BALLROOM

CONCURRENT

(1) RESTORATION OF DETERIORATED CONCRETE

(Committee 201 Symposium)

HUBERT WOODS, *Chairman*

Conventional Methods of Repairing Concrete

LEWIS H. TUTHILL
California State Department of Water Resources

Repair of Concrete Pavements

EARL J. FELT
Portland Cement Association

The Prepakt Concrete Method

RAYMOND E. DAVIS
Consulting Engineer

Use of Epoxy Adhesives

BAILEY TREMPER
California Division of Highways

Pneumatically Applied Mortar

O. N. KULBERG
Southern California Edison Co.

Thursday, March 17
9:00 a.m.—12:00 Noon
WEST BALLROOM

SESSIONS

(2) DESIGN AND CONSTRUCTION

RAYMOND C. REESE, *Chairman*

Welding of Reinforcing Steel Between Precast Concrete Units

J. NEILS THOMPSON
HUDSON MATLOCK
and
A. A. TROPAC
University of Texas

Effect of Floor Concrete Strength on Column Strength

CLYDE E. KESLER
ROBERT E. WOODS
and
ALBERT C. BIANCHINI
University of Illinois

Shear Strength of Reinforced Concrete Beams Without Web Reinforcement

JOHN E. BOWER
United States Steel Corp.
and
I. M. VIEST
AASHTO Road Test

Design and Construction of New Pier 40

DAVID P. BILLINGTON
Roberts and Schaefer Company

Thursday, March 17, 2:00 p.m.—5:00 p.m.

GRAND BALLROOM

RESEARCH SESSION

GEORGE W. WASHA, *Chairman*

S. J. CHAMBERLIN, *Secretary*

This Annual Open Meeting of ACI Committee 115 differs from general sessions in that the information is not released for publication. Request is made that proceedings be regarded as CONFIDENTIAL. Attendance at the session is the only sure way of being informed of the many future developments in concrete. A group of short papers will be presented on research techniques and preliminary results of investigations now in progress.

Effect of High Temperatures on Concrete Made with Different Aggregates—N. G. Zoldners, Canadian Department of Mines and Technical Surveys.

Turbo-Jet Engine Exhaust Impinging upon Concrete—William R. Lorman, U. S. Naval Civil Engineering Laboratory.

Insulating Concrete—Thomas W. Reichard, National Bureau of Standards.

"High-Low-Lift" Mass Concreting—T. G. Clendenning, Hydro-Electric Power Commission of Ontario.

Anti-shrinking Agents in Mortar and Concrete—Myron G. Brown, Michigan State Highway Department.

Effects of Restraint on the Expansion Caused by Alkali-Aggregate Reaction—Thomas B. Kennedy, U. S. Corps of Engineers.

Moisture Migration Through Concrete Slab-on-Ground Construction—Harold W. Brewer, Portland Cement Association.

Correlation between Flexural and Tensile Splitting Strength of Concrete—I. Narrow, U. S. Corps of Engineers.

Mechanism of Autogenous Healing in Concrete—Floyd O. Slate, Cornell University.

Stress Corrosion Failures in Prestressed Concrete—Mirko Robin Ros, Zurich, Switzerland.

Investigation of Multiple Panel Reinforced Concrete Floor Slabs—Mete A. Sozen, University of Illinois.

Development of a Simple Criterion for Determining Ultimate Strength of Columns Subjected to Compression Combined with Unsymmetrical Bending—Boris Bresler, University of California.

SPECIAL EVENTS

Exhibits Monday through Thursday in East Ballroom

Field trip to George Washington Bridge and Guggenheim Museum Tues., March 15
(See poster near Registration Desk for time)

Cocktail Party (complimentary)..... 6 p.m., Tues., March 15,
Grand Ballroom

Field trip to Idlewild Airport and Kips Bay housing project..... Thurs., March 17
(See poster near Registration Desk for time)

Theater tickets: A limited number of tickets to several stage shows are available to ACI conventioners at box office prices.

LADIES PROGRAM

Monday, March 14

Coffee Hour — Mezzanine 9:00 to 11:30 A.M.

Fashion Show and Luncheon
Persian Room, Hotel Plaza 12:30 P.M.

Tours thru Rockefeller Center, Empire State Bldg.,
Radio City Music Hall, Museums, etc.

Tuesday, March 15

Uptown Tour of Manhattan 9 A.M. to 2 P.M.

Luncheon at Patricia Murphy's
Candlelight Room — Yonkers Luncheon Stop on Tour

Wednesday, March 16

Coffee Hour — Mezzanine 9:00 to 11:30 A.M.

Luncheon at United Nations
Delegates Dining Room 11:45 A.M.

Tour of United Nations Immediately following
luncheon.

Thursday, March 17

Coffee Hour — Mezzanine 9:00 A.M.

Downtown Tour of Manhattan 10:30 A.M.

Luncheon at Fraunces Tavern Luncheon Stop on Tour

Tours thru Rockefeller Center, Empire State Bldg.,
Radio City Music Hall, Museums, etc.

NOTE: Use of Mezzanine from 9:00 to 11:30 A.M. available to Ladies attending Convention from Monday thru Wednesday, March 14 thru 16.

NOTES

NOTES

NEW YORK CONVENTION EXHIBITORS

Visit the Exhibits every day, Monday through Thursday, in the East Ballroom.

Booth No.	Company
1-3	The Master Builders Company
4	Water Seals, Inc.
5	Vibro-Plus Corporation
6	American Pecco
7	Raymond Concrete Pile Company
8-9	Sonneborn Chemical and Refining Corporation
10	Elgood Concrete Forms
11	Richmond Screw Anchor Company, Inc.
12	Rex-Spanall, Inc.
13	Fireproof Products
14	The Clipper Manufacturing Company
17-18	Autolene Lubricants Company
19	Expanded Shale Clay & Slate Institute
20	Johns-Manville Products Corporation
21-22	Sika Chemical Corporation
23	Chicago Fly Ash Company
24	Hugh F. Fenlon
27	The Patent Scaffolding Co., Inc.
28-29	Sonoco Products Company
	Precrete, Inc.