

and all that Jazz!

1996 FALL CONVENTION



NEW ORLEANS

THEME:
DISASTER MITIGATION



THEME SESSIONS:

- Aerated Concrete Performance in Disasters
- Strength Evaluation Following a Disaster
- Bridge Evaluation in Disaster Mitigation
- Blast-Resistant Design I & II

FERGUSON LECTURE:

- Self-Compacting High-Performance Concrete

OTHER EVENTS:

- 35 Additional Technical and Educational Sessions
- 250 Committee Meetings
- Contractors' Day
- Educational Seminar: 1995 Changes in the 318 Building Code
- Student Day
- Rap Breakfast
- General Session
- Concrete Mixer
- Guest Program



November 3-8, 1996

**HYATT REGENCY
NEW ORLEANS**

**AMERICAN CONCRETE
INSTITUTE
BOARD OF DIRECTION**

President
James S. Pierce

Vice Presidents
**Richard N. White
James R. Libby**

Directors
**John H. Clark
W. Gene Corley
Douglas W. Deno
C. Terry Dooley
Luis E. Garcia
David P. Gustafson
Terence C. Holland
Merlyn Isaak
Frederick L. Moreadith
B. Duke Pointer
Philip T. Seabrook
James K. Wight**

Past Presidents
**George C. Hoff
Dean E. Stephan
Robert F. Mast**

Executive Vice President
George F. Leyh

**SUSTAINING MEMBERS OF THE
AMERICAN CONCRETE
INSTITUTE**

Baker Concrete Construction, Inc.
Monroe, Ohio

W. R. Grace & Co.
Cambridge, Massachusetts

Holnam, Inc.
Dundee, Michigan

Lafarge Canada, Inc.
Montréal, Québec

**Lafarge Corporation, Great
Lakes Region**
Southfield, Michigan

Lone Star Industries, Inc.
Stamford, Connecticut

Master Builders, Inc.
Cleveland, Ohio

Phoenix Corporation
Honolulu, Hawaii

Portland Cement Association
Skokie, Illinois

Precast/Prestressed Concrete Institute
Chicago, Illinois

LOUISIANA CHAPTER CONVENTION COMMITTEE

Chairman

Om P. Dixit
Burk-Kleinpeter, Inc.

Vice-Chairman

William E. Rushing, Jr.
Waldemar S. Nelson & Co.

Special Advisors

Janmarie Hornack
ChemCraft, Inc.

Peter G. Snow
Consultant

Treasurer

Donald F. Meyn
Delta Testing & Inspection

Finance

Charles N. Kahn, Jr.
Dixie Building Materials Co., Inc.

Thomas M. Smith
Design Engineering, Inc.

William Sewell
City of New Orleans

Mike Choudhry
Rahman and Associates, Inc.

Social Events

Robert A. Turner
Department of Public Works, St. Bernard Parish

Roy A. Glapion
Citywide Testing & Inspections, Inc.

Timothy M. Ruppert
Morphy, Makofski, Inc.

Contractor Relations
Adam Mehn
Burk-Kleinpeter, Inc.

Frank Stritzinger
T. L. James Construction

Calvin J. Zenor
Delta Testing & Inspection

LOUISIANA CHAPTER CONVENTION COMMITTEE

Guest Program
Suresh I. Shah
Burk-Kleinpeter, Inc.

Angela L. DeSoto
U.S. Army Corps of Engineers

Ashwini Y. Pandit
Dept. of Public Works, Jefferson Parish

Shirley Kleinpeter
Burk-Kleinpeter, Inc.

Technical Program
Robert B. Anderson
Anderson Consulting Engineers

Masood Rasoulian
Louisiana Transportation Center

Student Program
John L. Niklaus
Tulane University

Dale A. Phillips
Waldemar S. Nelson & Co.

Michael Folse
University of New Orleans

Publicity
Kenneth J. Meyn
Delta Testing & Inspection

Wayne Peterson
Schrenk & Peterson

William B. Haensel, Jr.
Krebs, Lasalle, Lemieux Consultants, Inc.

LOUISIANA CHAPTER OFFICERS

President

René A. Chopin, III
Burk-Kleinpeter, Inc.

Vice President

Shashikant M. Suthar
Fromerz Engineers, Inc.

Past President

Darrell F. Elliot
Master Builders

Secretary

Richard S. Owens
Owens & Sons, Inc.

Treasurer

William E. Rushing, Jr.
Waldemar S. Nelson & Co., Inc.

Board Members

Mark A. Cheek
URS Consultants

Mike A. Choudhry
Rahman & Associates, Inc.

Kerwin E. Julien
Julien Engineering & Consulting, Inc.

J. Craig Marks
Professional Service Industry, Inc.

Kenneth J. Meyn
Delta Testing & Inspection

Brian A. Patin
Post Tension Slabs, Inc.

CONVENTION SPONSORS

REX

ACI Louisiana Chapter

BACCHUS

Holnam, Inc.
Master Builders, Inc.
W. R. Grace & Co.
Waldemar's, Nelson & Co., Inc.

ZULU

Blue Circle Cement
Boh Brothers Construction
Burk-Kleinpeter, Inc.
Fibermesh Company
LaFarge Corporation
Louisiana Industries

ENDYMION

August Contractors
ACI Florida Suncoast Chapter
ACI Georgia Chapter
ACI National Capital Chapter
ACI Northeast Texas Chapter
ACI New Mexico Chapter
ACI New Rocky Mountain Chapter
ACI Southern California Chapter
Angelle Concrete
Design Engineering, Inc.
Modjeski-Masters
Owens and Sons, Inc.

THOTH

AA Price
ACI El Paso International Chapter
Alpha Testing & Inspection
Badeaux & Associates, Inc.
Big River Industries, Inc.
Building Specialities
Carlo Ditta, Inc.
Citywide Testing & Inspection
Concrete Controls, Inc.
Delta Testing & Inspection
Dixie Building Materials Co., Inc.
Eustis Engineering, Co.
Evans-Graves Engineers
Charles N. Kahn, Jr.

CONVENTION SPONSORS

THOTH

Koltz Equipment Co.
Kulkarni Consultants
N-Y & Associates, Inc.
Nairn Concrete Services, Inc.
Peter Judlin, Inc.
Professional Construction Services, Inc.
Rahman & Associates
Rio Grande Portland Cement, Corp.
Smith Materials & Equipment Co., Inc.
URS Consultants

ARGUS

ACI Florida First Coast Chapter
ACI New Jersey Chapter
ACI San Antonio, Texas Chapter
Cajun Concrete Services, Inc.
Gulf Coast Pre-stress, Inc.
Heck Industries, Inc.
Huval & Associates
Jeffery, Thomas, Avegno, Inc.
Linfield, Hunter & Junius, Inc.
Mike Choudhry
Morphy Makofsky, Inc.
Theo Industrials
Schrenk & Peterson Consulting Engineers, Inc.
Tycer Ready Mix, Inc.

The American Concrete Institute
and the
ACI Louisiana Chapter
deeply appreciate their support.

Note: These were the sponsors as of
October 11, 1996. Please check the sign
at the Registration Area for
additional sponsors.



MARC H. MORIAL
MAYOR

CITY OF NEW ORLEANS

1300 Perdido Street, Room 2E10
New Orleans, Louisiana 70112
(504) 565-6400
Fax (504) 565-6423

As Mayor of the City of New Orleans, I am delighted to welcome the American Concrete Institute to one of the most enchanting cities in the world. I know the people of New Orleans will make you feel more friend than stranger of this Crescent City, nestled in a deep bend of the Mississippi River.

Encircled by the river, Lake Pontchartrain, bayous, swamps, marshes and wetlands, New Orleans, evolved along ridges, or "cheniers" as they were called, marked by grand Live Oak and tall Magnolia trees. Our unique history, combining French, Spanish, African and many other European and Caribbean influences, lives today through our endless varieties of architecture, music and food. Whether it's our "snowballs" or "po-boy" sandwiches or artfully created "new" New Orleans cuisine, design your own personal food fest.

New Orleans is many cities within one. Be sure to experience not only our famed French Quarter, but our many other distinct neighborhoods. Use the streetcar to see the majesty of the homes in the Garden District, on the way to our world renowned Audubon Zoo. Visit the 18th century plantation homes along Bayou St. John that lead you to the doorstep of the New Orleans Museum of Art, itself a gateway to the natural beauty of City Park and Lake Pontchartrain.

In the heart of our business district the "New Downtown" has sprung up, bordered by the Riverwalk Festival Marketplace at the Riverfront, and the New Orleans Centre, a regional shopping mall at the Superdome. There you will also find new art galleries, music clubs, elegant hotels, and, of course, great restaurants.

The song "Do you know what it means to miss New Orleans," was written not just for people from New Orleans, but for visitors as well. We know that having welcomed you once, we will welcome you again.

A handwritten signature in black ink, appearing to read "Marc H. Morial".

Marc H. Morial
Mayor, City of New Orleans



M. J. "MIKE" FOSTER, JR.
GOVERNOR

State of Louisiana

OFFICE OF THE GOVERNOR

Baton Rouge

70804-9004

Dear Concrete Institute Members:

Welcome to Louisiana! On behalf of the people of our great state, I am pleased to extend our most cordial greetings and hospitality.

We are delighted that you have chosen New Orleans for your 1996 Semi-Annual Fall North American Meeting. I invite you to witness firsthand the attractions of our incredible state. No other state can boast the gamut from natural waterways and wetlands, to the birth of Zydeco music and incomparable cuisine from the highest rated restaurants in the country.

People in Louisiana pride themselves on their great historic and cultural diversity. I look forward to the opportunity to share that pride with you, so that you may experience the many flavors, sites and sounds that make New Orleans such a special city.

Again, I wish you great success with your conference.

With kind regards, I am

Sincerely,

A handwritten signature in black ink, appearing to read "M. J. Foster, Jr.", written over a horizontal line.

M.J. "Mike" Foster, Jr.

cs/jk

Welcome to New Orleans:

Convention time is here once again!



And time for ACI members and their guests to gather once more,

. . . renew old friendships and hopefully establish new ones,
. . . stop to assist anyone who seems “lost,”
. . . exchange views and ideas on current trends,
. . . absorb facts on the latest concrete technology,
. . . debate methods and concepts which lead to better concrete,
. . . partake of tasty hors d’oeuvres and other treats at a friendly social,
. . . listen to intriguing technical discussions about a current design method or other innovations,
. . . try to decide which meetings to attend at the expense of forgoing those you don’t have time for,
. . . corner a few committee members to try to convert them to your point of view,
. . . grab a little time for shopping and/or taking in a few sights,
. . . and on . . . and on . . . and on . . . a hundred other things to do at an Institute convention, resulting in a very busy six days for all here in the “Big Easy” that is New Orleans.

You know — it’s an ACI convention!

If you’re an old member, like me, do what you’ve always done! If this is your first convention, join all the learning experiences—and fun. If you need any help, just holler.

It’s ACI convention time — enjoy!!!!

You’re among friends!

A handwritten signature in black ink that reads "Jim".

James S. Pierce
President
ACI International

Visit the ACI Web Site!

Information on ACI Products and Services:

* ACI Membership * New ACI Publications * ACI Telephone Directory *
Certification * Conventions * Education and Seminars * Technical Committees *
Chapters * *Concrete International* * Journals and Separate Publications * Other
Online Resources

Check Us Out Today!

<http://www.aci-int.inter.net>

TABLE OF CONTENTS

ACI FALL CONVENTION November 3 - 8, 1996 New Orleans, Louisiana

Theme: **DISASTER MITIGATION**

ACI Board of Direction	2
ACI Louisiana Chapter	6
ACI Louisiana Chapter Convention Committee	4-5
ACI President's Welcome Letter	11
ACI Sustaining Members	3
ACI Web Site	12
CA Quick Search	41
Certification Information	55
Contractors' Day and Luncheon	74-76
Convention Committee	107
Daily Events	25-34
Educational Activities Committee	107
Educational Calendar	42-43
Educational Seminar	101
Educational Videotapes	44-45
Future Conventions	108
General Information	14
General Session	86
Guest Program	22-24
Hotel Maps	17-18
Hotel Meeting Room Indexes	16
International Conference 1997	46
MCP CD-Rom Demonstration	15
Moonlight on the Mississippi Dinner Cruise	84
New Orleans Welcome Letter	9-10
New Publications	54
Numerical Committee Listing	35-40
Personal Log	102-106
RAP Breakfast	85
Registration Information	14
Special Events	20-21
Sponsors	7-8
Standards Presentation	87
Students' Day	57
Student Program	47
Technical Activities Committee	107
Technical and Educational Sessions/Forum	47-100

GENERAL INFORMATION

CONVENTION REGISTRATION INFORMATION

The ACI staff is eager to answer any questions you may have pertaining to the convention. Our Registration Desk is open to serve you during the following hours:

Saturday	1:00 PM - 5:00 PM
Sunday	10:00 AM - 5:00 PM
Monday	7:30 AM - 5:00 PM
Tuesday	8:00 AM - 5:00 PM
Wednesday	8:00 AM - 5:00 PM
Thursday	8:00 AM - 5:00 PM

SEMINAR REGISTRATION

Friday, November 8 8:00 AM - 8:30 AM

BADGES

Wear your badge on the right side at all times. (In shaking hands, the eyes normally fall at the shoulder level on the right side of the individual being greeted.) The convention badges are color coded for identification as follows:

Member:	White	Student:	Blue
Nonmember:	Peach	Guest:	Beige
Fellow:	White		

Note: Badges will be required to attend all social events.

Flash photography can be disturbing to other attendees. Please refrain from this activity during sessions.

The **Speaker Ready Room** is located in the Dauphine Room, on the 4th Floor of the Hyatt Regency New Orleans.

Suggested Attire: For meetings, business attire. For the Concrete Mixer, business attire and for other evening social events, business or evening attire.

ATTENTION STUDENTS! LEGAL DRINKING AGE IS 21. If you attend social events and you have not reached legal drinking age, please do not request any alcoholic beverages.

GET ANSWERS TO YOUR CONCRETE QUESTIONS . . . *fast!*

. . . FROM THE MOST COMPREHENSIVE
SET OF DOCUMENTS AVAILABLE ON
CONCRETE TECHNOLOGY.

ACI's *Manual of Concrete Practice* is available on compact disk. The new 1996 MCP CD-ROM contains both DOS and Windows versions. It uses sophisticated, yet easy-to-use search software to access the most comprehensive set of documents available on concrete technology in an instant. Save time looking for any ACI document referenced in project specifications. Instantly retrieve every reference that exists on your subject.

INCLUDES LATEST VERSIONS OF COMMITTEE REPORTS!

Some of the up-to-date specifications you'll find in the 1996 MCP CD-ROM:

- 318/318R-95 The new *Building Code Requirements for Structural Concrete*, approved in August 1995. Some highlights of the revised *Code*:
 - Minimum flexural reinforcement requirements are tied to concrete strength
 - Expanded section on precast concrete
 - New seismic requirements
 - Revised design provisions for torsion
 - A new chapter on Structural Plain Concrete
- 301-96 *Standard Specifications for Structural Concrete*, effective January 1, 1996
- 506.2-95 *Specifications for Shotcrete*
- 228.1R-95 *In-Place Methods to Estimate Concrete Strength*
- Four new committee reports

NOW USE MCP IN WINDOWS™ DEMONSTRATIONS SCHEDULED DURING THE CONVENTION

See how the new MCP CD-ROM Windows™ version will provide you with the solid information found in the Manual of Concrete Practice. Demonstrations have been conveniently scheduled during the convention in the Royale Room at the Hyatt Regency New Orleans. Please note that space is limited. Demonstrations will be held hourly on the half hour. Seize this "hands on" opportunity!

MONDAY

7:30AM - 11:30AM
1:30PM - 5:30PM

TUESDAY

7:30AM - 11:30AM
1:30PM - 5:30PM

ATTEND A DEMO AND RECEIVE A FREE ACI MOUSE PAD!

WHERE'S THAT MEETING ROOM

Hyatt Regency New Orleans

Ashland	4th Floor
Audubon	2nd Floor
Buena Vista	4th Floor
Burgundy A	4th Floor
Burgundy B	4th Floor
Burgundy C	4th Floor
Cabildo A	2nd Floor
Cabildo B	2nd Floor
Cabildo C	2nd Floor
Carrollton	2nd Floor
Dauphine	4th Floor
Delgado	2nd Floor
Elmwood	4th Floor
Elysian Fields	2nd Floor
Esplanade A	2nd Floor
Esplanade B	2nd Floor
Esplanade C	2nd Floor
Gentilly	2nd Floor
Kenilworth	4th Floor
LaSalle AB*	7th Floor
Magnolia	4th Floor
Poydras A	2nd Floor
Poydras B	2nd Floor
Prytania	2nd Floor
Rampart	4th Floor
Regency A	3rd Floor
Regency B	3rd Floor
Regency C	3rd Floor
Regency D	3rd Floor
Regency E	3rd Floor
Regency F	3rd Floor
Regency G	3rd Floor
Regency H	3rd Floor
Regency South Foyer	3rd Floor
Rosedown	4th Floor
Royale	4th Floor
Toulouse	2nd Floor
Versailles	4th Floor

*LaSalle AB is located on the 7th Floor of the Lanai Section of the Hyatt. This room can be accessed through special elevators located on the lobby level to the left of the hotel registration desk and on the 3rd floor level.

HOTEL FLOOR MAP

SECOND LEVEL MEETING ROOMS

HIATT REGENCY NEW ORLEANS



GES
Exposition
Services
a hilti.com company

05/31/24

HOTEL FLOOR MAP

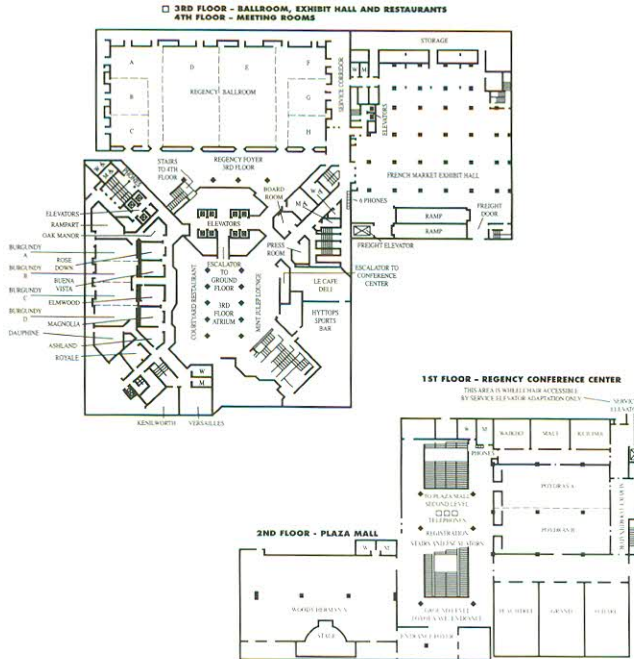

HOTEL STREET MAP



Poydras at Loyola Avenue
New Orleans, Louisiana 70140
504-561-1234
FAX 504-523-0488

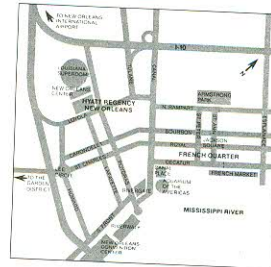

LOCATION

Located in the heart of the central business district near the New Orleans Convention Center and the French Quarter. Adjacent to the hotel is the Louisiana Superdome and the New Orleans Centre Shopping Mall. 12 miles from New Orleans International Airport, 8 miles from Lakefront Airport. 2 blocks from Union Passenger Terminal. Free shuttle to French Quarter.

GUEST ROOM INFORMATION

Number of rooms: 1,184
Suites/paques: 94
Kings/queens: 622
Double doubles: 587
Regency Club rooms: 46
Gold Passport rooms: 250
Accessible rooms: 20
Nonsmoking rooms: 557
Number of floors: 21
Check-in time: 3:00 p.m.
Check-out time: 12:00 noon

Guest room features:

- TV with remote control, cable movie channels.
- in-room pay movies
- telephone w/message light
- individual climate control
- full bath amenities
- AM/FM alarm clock
- hair dryer
- (suites and Gold Passport)
- bathrobes (Regency Club)
- dataports for computers and fax machines

GUEST SERVICES AND SHOPS

- Business Center
- 1-800-CHECK-IN
- assistive devices for persons with disabilities
- concierge
- complimentary transportation (to French Quarter)
- gift shop, hair and manicure salon, florist
- hotel adjacent to New Orleans Centre Shopping Mall
- room service
- valet parking
- valet service
- multilingual staff
- currency exchange
- baby-sitting
- safe-deposit box
- soda, ice machines

RECREATIONAL FACILITIES

- outdoor pool
- whirlpool spa
- exercise room (stair machine, Lifecycle®, treadmills, rowing machine, 2 weight stations, hand weights)
- golf and tennis nearby

MEETING AND BANQUET FACILITIES

Total meeting space = 100,000 sq. ft.
Prefunction space = 14,000 sq. ft.
Exhibit space = 25,000 sq. ft.
Freight elevator capacity = 16,000 lbs.
Freight elevator size = 12' x 22' x 10'

General comments:

- Regency Ballroom, located on the third floor, divides into 8 meeting rooms
- French Market Exhibit Hall adjacent to Regency Ballroom
- private drive-in freight elevator adjoining exhibit hall
- separate registration area, phones, restrooms
- off-premise catering available through Regency Caterers®
- 41 meeting rooms, including the Regency Conference Center, located throughout the hotel
- all meeting rooms have multiple electrical/microphone outlets, and individual controls for heat, air conditioning and sound.
- 912 Royal, an historic French Quarter carriage house and courtyard, is exclusively available to Hyatt clients for off-premise functions
- elegant poolside hospitality suites.

RESTAURANTS AND LOUNGES

Name	Seats/Capacity	Cuisine	Meals Served	Entertainment
Courtyard	240	Cajun/American	B,L,D	N/A
Le Cafe	60	Deli	B,L	N/A
Top of the Dome	150	Regional American	D	N/A
Hytops Sports Bar	120	Seafood/Pizza/Burgers	L,D	Video Games
Mint Julep Lounge	100	Hors d'oeuvres		Jazz

SPECIAL EVENTS

SUNDAY, NOVEMBER 3

OPENING NIGHT RECEPTION/CASH BAR
6:30 PM - 7:30 PM

Regency D

Join our host chapter and old and new friends at this opening night reception to start off the convention.

COFFEE BAR (Sunday - Thursday)
8:00 AM - 10:00 AM

Regency South Foyer

Share a cup of coffee with your colleagues before going to your morning meetings.

MONDAY, NOVEMBER 4

ATTENTION SESSION MODERATORS AND SPEAKERS

You are invited to attend an informative training session on **Monday, November 4**, in Regency B Room, from 7:00 AM - 8:30 AM. See page 56 for details.

STUDENTS' DAY LUNCHEON
NOON - 2:00 PM

\$18.00
Regency B

Encourage student participation in ACI! Join students and ACI convention attendees for lunch and hear luncheon speaker, *Walter Eggers*, talk about "Northumberland Strait Bridge." See page 57 for details. Please purchase your tickets by 10:00 AM on Sunday, November 3.

WOMEN OF ACI
5:30 - 6:30 PM

Ashland

This informal social event is a means for ACI women to network and get to know each other better, in an environment that is less structured than committee meetings and less populous than mixers. We will meet for soft drinks and wine, nibbles and camaraderie. It is free to anyone who wishes to attend. Bring your business cards.

TUESDAY, NOVEMBER 5

BY INVITATION ONLY

Technical and Educational Committee Chairmen Training Session

Tuesday, November 5

7:00 AM - 8:30 AM

Regency B

(Free continental breakfast for the first 50 attendees)

SPECIAL EVENTS

TUESDAY, NOVEMBER 5

CONTRACTORS' DAY LUNCHEON \$21.00
NOON - 2:00 PM Regency B

We hope you will join us for lunch and hear our luncheon speaker, *Mr. Frank Denton*, Secretary of the Louisiana Department of Transportation and Development, give an a talk on "Transportation Overview—Present and Future."

MOONLIGHT ON THE MISSISSIPPI
7:00 PM - 10:00 PM \$37.00/Cash Bar

See page 84 for details.

WEDNESDAY, NOVEMBER 6

RAP SESSION BREAKFAST
8:30 AM - 9:30 AM Regency E

Enjoy a complimentary continental breakfast and get answers to your questions from the ACI President and Executive Vice President. ACI is your organization. Don't miss this opportunity to learn more about it.

GENERAL SESSION/STANDARDS PRESENTATION
10:00 AM - 1:00 PM Regency D

Come to the General Session and hear our Phil M. Ferguson Lecturer, *Professor Hajime Okamura*, give a talk on "Self-Compacting High Performance Concrete." This will be followed by a keynote address from *Skip Bertman*, Baseball Head Coach of the Louisiana State University, who will speak on "Olympics, Baseball or Business—There Must be Teamwork to Succeed." Immediately, following the General Session is the Standards Presentation on the "Proposed New Standard Specification for Cast-in-Place Architectural Concrete (ACI 303.1-xx)".

CONCRETE MIXER Grand Ballroom
6:30 PM - 8:00 PM New Orleans Hilton Riverside & Towers

The ACI Louisiana Chapter invites you to an evening of fun and enjoyment and "A Taste of Mardi Gras." Your ticket is complimentary with a full week's registration fee. Business or casual attire.

GUEST PROGRAM

REGISTRATION HOURS: SEE PAGE 14

GUEST HOSPITALITY HOURS:

Monday
Tuesday - Thursday

8:00 AM - 11:00 AM
Regency D, 3rd Floor
LaSalle AB, 5th Floor

SUNDAY, NOVEMBER 3

NEW ORLEANS AND ALL ITS SPLENDOR

1:00 PM - 4:00 PM

\$19.00

The City Tour is a thorough and fascinating introduction to the endless variety of sights found in America's most European city. Board a deluxe motor coach - sit back and enjoy . . . this narrated tour includes Esplanade Avenue where you will see the mansions of Creole merchants nestled among 100-year old oak trees. The tour continues to St. Louis III Cemetery, often called the "the city of the dead" because of its above ground tombs. After going through City Park, New Orleans' largest municipal park, the tour proceeds along Lake Pontchartrain and the city's fine yacht harbor. Then you'll go on through the old town of Carrollton to St. Charles Avenue following the streetcar route where you'll see Tulane and Loyola Universities, Audubon Park, and beautifully restored mansions.

MONDAY, NOVEMBER 4

WELCOME TO NEW ORLEANS: AN OVERVIEW

10:00 AM - 11:00 AM

Regency D

This overview session will provide helpful hints to make your visit more pleasurable.

VIEUX CARRE PROMENADE

12:30 PM - 2:30 PM

\$23.00

A must for every visitor to New Orleans is a walking tour of the world-famous French Quarter. The original French and Spanish influences on this centuries old city are evidenced by the beautiful and unique architecture. Highlighted here are such famous landmarks as the Pontalba building (one of America's first apartment buildings), the St. Louis Cathedral flanked by the Cabildo and Presbytre, and Jackson Square with its old world flavor and its own colorful art colony. Take a step back in time down Rue Royal, while your tour guide tells fascinating stories of pirates, priests, haunted houses, and Voodoo Queens. Enjoy viewing ironlace balconies, romantic patios, and quaint antique shops, providing some of the South's finest selection of European and American antiques. Savor the aromatic perfumes of roasting coffees and bubbling molasses from praline shops. Tour Herman Grima House, an 1833 mansion that features slave quarters, a Creole kitchen, stable, and stately courtyard. The Herman Grima House is one of the earliest and best examples of American architecture in the French Quarter. *Light refreshments will be served in the house. Comfortable walking shoes are recommended.*

GUEST AFTERNOON TEA

3:00 PM - 5:00 PM

LaSalle AB

Hosted by Mrs. Dee Pierce.

GUEST PROGRAM

TUESDAY, NOVEMBER 5

GENTEEL CORNER OF NEW ORLEANS

9:00 AM - 1:00 PM

\$47.00

Just a few miles from the French Quarter lies the Garden District. In the 19th century, this was known as the American Section, where English rather than French was its language. As you journey down St. Charles Avenue, you'll view elegant houses built primarily in the Greek Revival and Italianate styles of architecture. Two private Garden District homes will graciously be offered for touring. You'll sense a bygone era as you visualize young ladies of the Old South entertaining their gentlemen callers, mint julep in hand. Following a stroll through the Garden District, you'll enjoy lunch at New Orleans' famous Commander's Palace, located in the heart of the Garden District. World-renowned for its Creole cuisine, dining in the grand manner at Commander's is a must since 1833. This adventure will truly make you drift back to the South's most elegant era. *Proper dress required at Commander's Palace (sports jacket or suit coat for men).*

Menu

Turtle Soup, Commander's Salad, Roasted Chicken or Shrimp Victoria
Creole Bread Pudding or Creme Brulee, Bread & Butter, Tea, Coffee

WEDNESDAY, NOVEMBER 6

THE PAST REVISITED: HOUMAS & NOTTAWAY PLANTATIONS

10:00 AM - 5:00 PM

\$49.00

Nottaway is an American castle, a gem of Italianate and Greek Revival style, boasting 53,000 square feet. In 1859, 10 years after construction began, Nottaway was completed. Nottaway brought innovative and unique features to the South, including indoor plumbing, gas lights, and coal fireplaces. Intricate lacy plaster friezework, hand-painted Dresden porcelain doorknobs, hand-carved marble mantels, Corinthian columns, and a 65-foot Grand White Ballroom are all part of this monument to a bygone era. You will lunch at Lafitte's landing (the "Old Viala" Plantation) in the shadows of the Sunshine Bridge. Here you will enjoy irresistible Cajun/Creole cuisine and share in tidbits of information from world-renowned Chef John Folse, host of "A Taste of Louisiana" program, produced by Louisiana Public Broadcasting.

After lunch, you will continue to Houmas House Plantation. Houmas House derives its name from the Houmas Indians, who originally held this strip of land on the Mississippi. The magnificent Greek Revival mansion, built in 1840, fronts the original 1790 Colonial house. The two homes are joined by an arched carriage-way both furnished with period antiques. Houmas House was the setting for the motion picture "Hush, Hush Sweet Charlotte" starring Bette Davis and has been featured in countless magazines.

Menu

Lafitte's Landing Salad, Chicken Andouille Pasta, Vegetable
Praline Mousse, Bread & Butter, Tea, Coffee

GUEST PROGRAM

WEDNESDAY, NOVEMBER 6

TEA AND TIMELESS TREASURES

1:30 PM - 5:30 PM

\$36.00

The newly popular Warehouse District, likened to New York's Soho section, provides a fabulous walking tour as it has become home of over a dozen contemporary art galleries. Located right off Canal Street, these quaint old warehouses once held precious commodities such as coffee and cotton and now hold artisans and their works of art. As you stroll through the District you will be able to share in the experience of many talented artisans as well as, shop in exclusive stores of finery and one-of-a-kind items.

THURSDAY, NOVEMBER 7

DISCOVER NEW ORLEANS' "OTHER" WILDLIFE

9:30 AM - 1:30 PM

\$45.00

Come with us only 30 minutes (20 miles) from downtown New Orleans to enjoy a journey by boat, Cajun style, into the heart of Louisiana's beautiful and natural swamplands. Your boat will travel deep into the swamps and meandering bayous of this exciting region. Be sure to bring your camera as you may encounter exciting and beautiful animals at any time. Alligators, snakes, nesting eagles, egrets, white-tailed deer, mink, and nutria all flourish in this untamed land. Your guide is a native of the area who knows firsthand, the various sources of food and plant life that thrive throughout the year in this "virgin" area. History comes alive as your guide recounts the exploits of the pirate, Jean Lafitte, and his bank that plied these waters during the infancy of this country. Come see for yourself, Louisiana's mysterious waters and moss-draped bayous made famous in song and story. The adventure of Jean Lafitte awaits you!!! After the swamp tour enjoy lunch at the Restaurant des Familles. Located in Crown Point on the bank of Bayou Barataria, Restaurant des Familles offers Cajun/Creole cuisine in a swamp setting. *Tennis shoes and comfortable clothes are highly recommended.*

Menu

Shrimp Po-Boy, Gumbo, Bread Pudding, Coffee or Tea

GENERAL INFORMATION

- * All tours depart from and return to the Hyatt Regency New Orleans.
- * All prices are per person and include round-trip tour buses, tour guides, and admission to special attractions. Special attractions include docent guided tours.
- * All tours with paid refreshments are noted and the refreshment cost is included.

DAILY EVENTS

[(Mtg.) = Meeting (SC) = Subcommittee (TG) = Task Group]

FRIDAY, NOVEMBER 1

7:00P - 10:00P

TAC	Technical Activities (M-1)	Burgundy C
-----	----------------------------	------------

SATURDAY, NOVEMBER 2

8:00A - 5:00P

TAC	Technical Activities (M-2)	Burgundy C
-----	----------------------------	------------

8:30A - 5:00P

EAC	Educational Activities (M-1)	Burgundy D
-----	------------------------------	------------

2:00P - 5:00P

359	Nuclear Vessels	Burgundy B
-----	-----------------	------------

SUNDAY, NOVEMBER 3

7:00A - 8:30A

E701	Materials for Concrete Construction	Buena Vista
------	-------------------------------------	-------------

8:00A - 6:00P

TAC	Review Group 1	Burgundy C
TAC	Review Group 2	Burgundy A
TAC	Review Group 3	Burgundy B
TAC	Review Group 4	Burgundy D

8:30A - 10:00A

CLC	Construction Liaison	Ashland
120	History of Concrete	Magnolia
350	Subcommittee Chairs	Cabildo B

8:30A - 11:30A

E801	Student Activities	Rosedown
315	Detailing	Delgado
341	Earthquake-Resistant Bridges	Audubon
373	Cir. Prstd. Tendons	Toulouse
408	Bond and Development	Versailles
437	Strength Evaluation	Carrollton

8:30A - 1:00P

E705/118	Educational Computer Activities	Prytania
ITG-1	TTTC Task Group 1	Kenilworth
336	Footings	Rampart
349-3	Embedment (M-1)	Gentilly

8:30A - 3:30P

445-3	Shear Issues	Cabildo A
-------	--------------	-----------

9:00A - NOON

440-D	FRP Research	Buena Vista
-------	--------------	-------------

10:00A - 1:00P

350	Environmental Structures (M-1)	Cabildo C
441	Reinforced Concrete Columns	Magnolia

SUNDAY

11:30A - 1:00P

345	Bridge Construction	Toulouse
E802	Teaching Methods & Educational Materials	Rosedown

NOON - 5:00P

	Student Program and Competition	Tulane University
--	---------------------------------	-------------------

2:00P - 3:30P

	Hot Topic Committee	Delgado
230	Soil Cement	Ashland
342	Bridges & Bridge Elements	Buena Vista
346	CIP Pipe	Elmwood
440-J	FRP Stay-in -Place Formwork	Magnolia

2:00P - 5:00P**SESSIONS**

	Use of High-Performance Fiber Reinforced Concrete for Infrastructural Repair & Retrofit: Part I	Poydras A
★	Aerated Concrete Performance in Disasters	Regency B
	Concrete Structures in the Gulf South	Regency C
	A New ACI Document: Education Bulletin E4-95— Admixtures in Concrete	Poydras B

2:00P - 5:00P

CPC-1	Certification Programs(M-1)	Versailles
E703	Concrete Construction Practices	Audubon
305	Hot Weather	Carrollton
309	Consolidation	Rosedown
349-2	Design	Rampart
350-A	Subcommittee Group A	Cabildo B
352	Joints	Kenilworth
355	Anchorage (M-1)	Gentilly
369	Seismic Rehab	Prytania

3:30P - 5:00P

	Membership Committee	Ashland
445-1	State-of-the-Art Report	Toulouse

3:30P - 6:30P

	Publications Committee	Oak Manor
227	Radioactive Hazardous Waste Management	Magnolia
343	Bridge Design	Cabildo A
440-F	FRP Repair	Buena Vista

5:00P - 6:30P

E905	Training Programs	Elmwood
348	Safety	Toulouse

6:30P - 7:30P

	Opening Night Reception/Cash Bar	Regency D
--	----------------------------------	-----------

MONDAY, NOVEMBER 4

7:00A - 8:30A

TMC	Metrication	Ashland
-----	-------------	---------

★THEME SESSION

MONDAY

8:30A - 9:30A

304-5R	Lightweight Subcommittee	Toulouse
304-6R	Lightweight Subcommittee	Toulouse

8:30A - 10:00A

	100th Anniversary Task Group	Buena Vista
C601-P	Plasterer Certification	Burgundy A
E702	Designing Concrete Structures	Elmwood
SCO	Scholarship Council	Versailles
213-A	High-Strength Lightweight	Burgundy D
325-09	Construction	Delgado
363-1	High Strength Structural	Rampart
548-D	Sulfur Concrete	Rosedown

8:30A - 11:30A

C610	Field Technician	Burgundy B
212	Chemical Admixtures	Burgundy C
232	Fly Ash & Natural Pozzolons	Cabildo B
304	Measure/Mix/Transport/Place	Toulouse
311	Inspection	Kenilworth
360-1	Slabs on Grade Subcommittee	Cabildo A
368	Earthquake Resistance	Esplanade A
440-H	FRP Reinforced Concrete	Carrollton
523	Cellular Concrete	Esplanade B

8:30A - 1:00P

209	Creep and Shrinkage	Elysian Fields
349-1&4	Materials & Waste and Repository Structures	Magnolia
349-3	Embedment (M-2)	Gentilly

8:30A - 5:00P

350-A	Subcommittee Group A	Esplanade C
350-B	Subcommittee Group B	Poydras B
543	Concrete Piles	Audubon

9:00A - NOON SESSIONS

Research in Progress	Regency C
Structural Concrete Under Severe Dynamic Loads	Regency E
Innovative Concrete Technology in Residential Construction	Regency F
Computers in Practice and Education	Regency G
Use of High-Performance Fiber Reinforced Concrete for Infrastructural Repair & Retrofit: Part II	Regency H

9:00A - 1:00P

318	Building Code (M-1)	Cabildo C
-----	---------------------	-----------

10:00A - 11:00A

Guest Overview	Regency D
----------------	-----------

10:00A - 11:30A

C601-T	Tilt-Up Certification	Burgundy A
213-B	Lightweight/Parking Structures & Bridge Decks	Burgundy D
225-TG	Hydraulic Task Group	Versailles
325-36	Concrete Pavement Strengths	Delgado
444	Experimental Analysis	Ashland
524	Plastering	Buena Vista
548-A	Polymer Modified Concrete	Rosedown

MONDAY

10:00A - 1:00P

THPC	TAC High Performance	Poydras A
207	Mass Concrete	Rampart
533	Precast Panels	Elmwood

11:30A - 1:00P

C601	New Programs	Burgundy A
C640	Craftsman Certification	Burgundy B
211-D	High Strength	Carrollton
213-C	By-Product Lightweight Aggregates	Burgundy D
325-33	Fast Track Pavements	Delgado
440-E	Professional Education	Buena Vista
440-G	FRP Student Education	Ashland
515-A	Protective Systems for Concrete - A	Burgundy C
548-E	Structural Design & Analysis	Rosedown

11:30A - 6:30P

360	Slabs on Grade	Cabildo A
-----	----------------	-----------

NOON - 1:00P

544-Ex	Executive Subcommittee	Toulouse
--------	------------------------	----------

NOON - 2:00P

● Student Luncheon	Regency B
--------------------	-----------

2:00P - 3:30P

C630T	Transportation Inspector	Burgundy B
116	Terminology and Notation	Rampart
213-D	Review of 213 Guide	Burgundy D
225	Hydraulic Cements	Versailles
229	Controlled Low-Strength	Burgundy C
325-35	Con. Paver Block Pavements	Delgado
544-A	Steel Fibers	Esplanade B
544-B	Glass Fibers	Toulouse

2:00P - 5:00P SESSIONS

Extreme Loads and Load Combinations	Regency C
★ Strength Evaluation Following a Disaster	Regency E
Research on Transportation Structures	Regency F
Hot Topic: Seismic and Wind Mitigation for Structures	Regency G

2:00P - 5:00P

IAC	International Activities	Rosedown
RC	Responsibility	Ashland
TSC	Specifications	Buena Vista
303	Architectural Concrete	Elmwood
308-S	Curing - Specifications	LaSalle
340	Design Aids for ACI Building Codes	Magnolia
355	Anchorage (M-2)	Gentilly
363	High-Strength	Esplanade A
445-2	Full Member Design	Elysian Fields
546	Repair	Poydras A
548-B	Polymer Concrete Overlays	Cabildo B

● SEPARATE FEE REQUIRED

★ THEME SESSION

MONDAY/TUESDAY

2:00P - 6:30P

318-A	General, Concrete Construction	Kenilworth Burgundy A Carrollton Cabildo C
318-E	Shear and Torsion	
318-G	Prestressed Precast	
318-H	Seismic Provisions	

3:30P - 5:00P

C630	Construction Inspector	Burgundy B
123	Research	Burgundy C
211-C	No Slump	Versailles
325-34	Rehabilitation & Restoration	Delgado
544-C	Synthetic Fibers	Esplanade B
544-D	Natural Fibers	Toulouse

3:30P - 6:30P

440-I	FRP Prestressed Concrete	Rampart
-------	--------------------------	---------

5:00P - 6:30P

E903	Convention Training	Elmwood Buena Vista Burgundy D Toulouse Burgundy C
TCRC	TAC Construction Review	
213	Lightweight	
544-E	FRC Seminars	
552	Geotechnical Grouting	

TUESDAY, NOVEMBER 5

7:00A - 8:30A

RCRC	Reinforced Concrete Research Council Technology Transfer	Ashland Carrollton
TTTC		

8:30A - 10:00A

325-32	Jointed Pavement	Delgado Toulouse Cabildo B Rosedown
423-B	Prestressed Concrete Bond Task Group	
544-F	Testing	
554	Bearing Systems	

8:30A - 11:30A

CAC	Chapter Activities	Gentilly Burgundy A Buena Vista Poydras B Versailles Burgundy C Prytania Cabildo A
C620	Laboratory Technician	
124	Concrete Aesthetics	
335	Composite and Hybrid Structures	
349	Nuclear Structures	
370	Dynamic & Vibratory Effects	
506	Shotcreting	
548	Polymers	

8:30A - 1:00P

EAC	Educational Activities (M-2)	Burgundy B Ashland Cabildo C Elmwood Magnolia Rampart Burgundy D Audubon
117	Tolerances	
318-B	Reinforcement and Development	
318-C	Serviceability/Safety	
318-D	Flexure and Axial Loads	
318-F	Two-Way Slabs	
550	Precast Concrete Structures	
551	Tilt-Up Construction	

8:30A - 5:00P

350-A	Subcommittee Group A	Esplanade A Esplanade C
350-B	Subcommittee Group B	

TUESDAY

9:00A - NOON SESSIONS		
	Serviceability of Cable-Stayed Bridges	Regency C
	Repair with FRP Composites	Regency E
	Influence of Binder Makeup on Durability: Part I	Regency F
	Contractors' Day, Part I: How Can Contractors Use Testing to Improve Quality of Construction?	Regency G

10:00A - 11:30A		
215	Fatigue	Rosedown
325-10	Roller Compacted Concrete	Delgado

10:00A - 1:00P		
211-A	Editorial and Coordination	Carrollton
222	Corrosion of Metals in Concrete	Esplanade B
306	Cold Weather	Elysian Fields
544-G	Design & Structural Uses	Cabildo B

11:30A - 1:00P		
	Adhoc on Material Science	Delgado
IJBRC	Int'l Joints & Bearing Research Council	Rosedown
221	Aggregates	Poydras A
302	Construction of Floors	Cabildo A
332-TG2	Residential Task Group 2	Buena Vista
503-A	Adhesives - Subcommittee	Toulouse
515-B	Protective Systems for Concrete - B	Burgundy C

NOON - 2:00P		
●	Contractors' Day Luncheon	Regency B

2:00P - 3:30P		
210	Erosion/Hydraulic Struct.	Magnolia
234	Silica Fume	Esplanade B
332-TG1	Residential Task Group 1	Buena Vista
446-3	Finite Element Analysis and Fracture	Burgundy B

2:00P - 5:00P SESSIONS		
	Developing Design Criteria for Essential Facilities	Regency C
	TAC Open Paper Session	Regency E
	Influence of Binder Makeup on Durability: Part II	Regency F
★	Bridge Evaluation in Disaster Mitigation	Regency H
	Contractors' Day, Part II: Session 1 - Future of Design Build Contracts: Pros and Cons Session 2 - Construction Education - What Can It Do For You?	Regency G

2:00P - 5:00P		
	Convention Committee	Poydras A
CRC	Concrete Research Council	Burgundy A
ITG-2	TTTC Task Group 2	Carrollton
126	Materials Database	Rosedown
216	Fire Resistance & Fire Protection of Structures	Toulouse
223	Expansive Cement	Kenilworth

● SEPARATE FEE REQUIRED

★ THEME SESSION

TUESDAY/WEDNESDAY

2:00P - 5:00P

231	Early Age	Elmwood
233	Ground Slag	Burgundy D
308-R	Curing - SOA Report	Prytania
325	Pavements	Delgado
347	Formwork	Audubon
351-2	Dynamic Subcommittee	Rampart
364-		
1/3/4/5	Requirements of Design/Evaluation	Elysian Fields
421	Slabs	Burgundy C
503	Adhesives	Cabildo A
544	Fiber Reinforced	Cabildo B

2:00P - 6:30P

228	Nondestructive Testing	Ashland
318	Building Code (M-2)	Cabildo C
440	Fiber Reinforced Plastic	Gentilly

3:00P - 5:30PM

506-A	Shotcreting Subcommittee	Magnolia
-------	--------------------------	----------

3:30P - 5:00P

446-4	Dynamic Fracture	Burgundy B
558	Protective Coatings	Buena Vista

3:30P - 6:30P

364-2	Rehabilitation Materials	Versailles
-------	--------------------------	------------

5:00P - 6:30P

211-E	Evaluation & Adjustment	Magnolia
446	Fracture Mechanics	Burgundy B

7:00P - 10:00P

- Moonlight on the Mississippi Dinner Cruise
(Buses will pick up at the entrance of the Hyatt Regency)

7:30P - 10:00P

Forum 123: Are the ACI CL Limits Acceptable?	Regency C
--	-----------

WEDNESDAY, NOVEMBER 6

7:00A - 8:30A

Joint Task Group on Improving Technical Sessions	Elmwood
--	---------

8:30A - 9:30A

RAP Session Breakfast	Regency E
-----------------------	-----------

8:30A - 10:00A

350	Environmental Structures (M-2)	Esplanade C
362	Parking Structures	Audubon
439-A	Reinforcement A	Magnolia
439-B	Reinforcement B	Elmwood

10:00A - NOON

General Session (Featuring Phil M. Ferguson Lecture Speaker: Prof. Hajime Okamura and Keynote Speaker: Skip Bertman)	Regency D
--	-----------

- SEPARATE FEE REQUIRED

WEDNESDAY

NOON - 1:00P

Standards Presentation Regency D

2:00P - 3:30P

211-B Lightweight Prytania
235 Knowledge Based Systems and Method Models Rampart
308 Curing Concrete Cabildo A
351 Equipment Foundations Buena Vista
439-C Reinforcement C Esplanade B
531 Masonry Research Audubon

2:00P - 5:00P

SESSIONS

Methods of Teaching the Design of Concrete Structures Cabildo C
Technology Transfer: Identification of Cutting Edge Technology Regency C
Lessons Learned from the Past Regency F
Polymer Concrete Overlays on Industrial Floors Regency G
ACI 301-96 Standard Specification for Structural Concrete: Not Just for Buildings Anymore Regency H

2:00P - 5:00P

Adhoc on Improving Conventions Burgundy D
ConREF Poydras A
CPC-2 Certification Programs(M-2) Burgundy B
121 Quality Assurance Magnolia
122 Energy Conservation Toulouse
214 Strength Tests Carrollton
224 Cracking Versailles
330 Parking Lots Rosedown
332 Residential Gentilly
357 Offshore and Marine Ashland
442 Lateral Forces Delgado
445 Shear and Torsion Poydras B
549 Ferrocement and Other Thin Reinforced Products Burgundy C

2:00P - 6:30P

307 Chimneys Burgundy A
350 Environmental Structures (M-3) Esplanade C
355/
CEB-TG Anchorage/CEB Task Group (M-1) Kenilworth
423 Prestressed Concrete Esplanade A

3:30P - 5:00P

365 Service Life Rampart
439 Steel Reinforcement Esplanade B

3:30P - 6:30P

211 Proportioning Cabildo A

6:30P - 8:00P

Concrete Mixer Grand Ballroom
(Buses will pick up at the entrance New Orleans
of the Hyatt Regency) Hilton Riverside & Towers

7:00P - 10:00P

530-MSJC Executive Committee Gentilly

THURSDAY

8:30A - 10:00A

530-10	Modulus of Elasticity Task Group	Buena Vista
530-12	Empirical Task Group	Elmwood
530-14	Allowable Stress. Reinf. Details Task Group	Magnolia
556	Demolition	Ashland

8:30A - 11:30A

435	Deflection	Rampart
-----	------------	---------

8:30A - 1:00P

372	Circ. Prstd. Wire Wrap	Rosedown
-----	------------------------	----------

8:30A - 2:00P

371	Pedestal Water Towers	Versailles
-----	-----------------------	------------

8:30A - 5:00P

301	Specifications	Gentilly
355/CEBTG	Anchorage/CEB Task Group (M-2)	Burgundy C

8:30A - NOON

	Board of Direction (M-1)	Cabildo A
--	--------------------------	-----------

9:00A - NOON

SESSIONS
 Behavior and Design Issues in Earthquake
 Response of Concrete Bridges

	Design of Two-Way Slab Systems Using Elastic Frame Analogies	Regency A
--	---	-----------

	Sulfur Polymer Concrete: A Truly Unique Product	Regency B
--	--	-----------

★ Blast Resistant Design: Part I

10:00A - 11:30A

530-18	Infilled Walls Task Group	Magnolia
530-19	Compressive Strength Task Group	Buena Vista
530-6	Editorial Task Group	Elmwood

10:00A - 1:00P

555	Removal and Reuse	Ashland
-----	-------------------	---------

11:30A - 1:00P

530-16	Veneers Task Group	Elmwood
530-20	Cavity Wall Task Group	Buena Vista
530-8	Glass Block Task Group	Magnolia

2:00P - 3:30P

201	Durability	Cabildo C
530-11	Inspection Task Group	Elmwood
530-15	Seismic Task Group	Magnolia
530-9	Coefficients Task Group	Buena Vista

2:00P - 5:00P

SESSIONS
 Design of Two-Way Slab Systems
 Using Theorems of Plasticity

★ Blast-Resistant Design: Part II

Regency B

Regency E

★ THEME SESSION

THURSDAY/FRIDAY/SATURDAY

2:00P - 5:00P	Board of Direction (M-2)	Cabildo A
3:30P - 5:00P	International Standards Subcommittee	Magnolia
5:00P - 6:30P	Design Procedures Task Group	Magnolia

FRIDAY, NOVEMBER 8

8:00A - 5:00P	Educational Seminar: 1995 Changes in ACI-318 Building Code	Esplanade A
8:30A - 11:30A	General Subcommittee	Magnolia
530-2	Limit States Subcommittee	Oak Manor
530-4		
11:30A - 1:00P	Specifications Subcommittee	Magnolia
530-5		
NOON - 1:00P	Educational Seminar Luncheon	Esplanade B
2:00P - 3:30P	Allow. Stress/Emp. Design Subcommittee	Magnolia
530-3		
3:30P - 5:00P	Prestressed Subcommittee	Magnolia
530-7		

SATURDAY, NOVEMBER 9

8:00A - 2:00P	Masonry	Esplanade A
530		

NUMERICAL COMMITTEE LISTING

[(Mtg.) = Meeting (SC) = Subcommittee (TG) = Task Group]

COMM.	COMMITTEE TITLE	DAY TIME	ROOM
	Board of Direction (M-1)	THU 8:30A- NOON	Cabildo A
	Board of Direction (M-2)	THU 2:00P- 5:00P	Cabildo A
TAC	Technical Activities (M-1)	FRI* 7:00P- 10:00P	Burgundy C
TAC	Technical Activities (M-2)	SAT 8:00A- 5:00P	Burgundy C
TAC	Review Group 1	SUN 8:00A- 6:00P	Burgundy C
TAC	Review Group 2	SUN 8:00A- 6:00P	Burgundy A
TAC	Review Group 3	SUN 8:00A- 6:00P	Burgundy B
TAC	Review Group 4	SUN 8:00A- 6:00P	Burgundy D
TCRC	TAC Construction Review	MON 5:00P- 6:30P	Buena Vista
THPC	TAC High Performance	MON 10:00A- 1:00P	Poydras A
TMC	Metrication	MON 7:00A- 8:30A	Ashland
TSC	Specifications	MON 2:00P- 5:00P	Buena Vista
TTTC	Technology Transfer	TUE 7:00A- 8:30A	Carrollton
ITG-1	TTTC Task Group 1	SUN 8:30A- 1:00P	Kenilworth
ITG-2	TTTC Task Group 2	TUE 2:00P- 5:00P	Carrollton
EAC	Educational Activities (M-1)	SAT 8:30A- 5:00P	Burgundy D
EAC	Educational Activities (M-2)	TUE 8:30A- 1:00P	Burgundy B
E701	Materials for Concrete Construction	SUN 7:00A- 8:30A	B. Vista
E702	Designing Concrete Structures	MON 8:30A- 10:00A	Elmwood
E703	Concrete Construction Practices	SUN 2:00P- 5:00P	Audubon
E705/	Educational		
118	Computer Activities	SUN 8:30A- 1:00P	Prytania
E801	Student Activities	SUN 8:30A- 11:30A	Rosedown
E802	Teaching Methods & Educational Materials	SUN 11:30A- 1:00P	Rosedown
E903	Convention Training	MON 5:00P- 6:30P	Elmwood
E905	Training Programs	SUN 5:00P- 6:30P	Elmwood
CPC-1	Certification Programs(M-1)	SUN 2:00P- 5:00P	Versailles
CPC-2	Certification Programs(M-2)	WED 2:00P- 5:00P	Burgundy B
C601	New Programs	MON 11:30A- 1:00P	Burgundy A
C601-P	Plasterer Certification	MON 8:30A- 10:00A	Burgundy A
C601-T	Tilt-Up Certification	MON 10:00A-11:30A	Burgundy A
C610	Field Technician	MON 8:30A- 11:30A	Burgundy B
C620	Laboratory Technician	TUE 8:30A- 11:30A	Burgundy A
C630	Construction Inspector	MON 3:30P- 5:00P	Burgundy B
C630T	Transportation Inspector	MON 2:00P- 3:30P	Burgundy B
C640	Craftsman Certification	MON 11:30A- 1:00P	Burgundy B
	Joint Task Group on Improving Tech. Sessions	WED 7:00A- 8:30A	Elmwood
	Adhoc on Convention Improvements	WED 2:00P- 5:00P	Burgundy D
	Adhoc on Material Science	TUE 11:30A- 1:00P	Delgado
CAC	Chapter Activities	TUE 8:30A- 11:30A	Gentilly
CRC	Concrete Research Council	TUE 2:00P- 5:00P	Burgundy A
	ConREF	WED 2:00P- 5:00P	Poydras A
CLC	Construction Liaison	SUN 8:30A- 10:00A	Ashland
	Convention Committee	TUE 2:00P- 5:00P	Poydras A
	Hot Topic Committee	SUN 2:00P- 3:30P	Delgado
IAC	International Activities	MON 2:00P- 5:00P	Rosedown
IJBRC	Int'l Joints & Bearing Research Council	TUE 11:30A- 1:00P	Rosedown
	Membership Committee	SUN 3:30P- 5:00P	Ashland
	Publications Committee	SUN 3:30P- 6:30P	Oak Manor
RC	Responsibility	MON 2:00P- 5:00P	Ashland

COMM.	COMMITTEE TITLE	DAY TIME	ROOM
RCRC	Reinforced Concrete Research Council	TUE 7:00A- 8:30A	Ashland
SCO	Scholarship Council	MON 8:30A- 10:00A	Versailles
	100th Anniversary Task Group	MON 8:30A-10:00A	Buena Vista
116	Terminology and Notation	MON 2:00P- 3:30P	Rampart
117	Tolerances	TUE 8:30A- 1:00P	Ashland
118/			
E705	Use of Computers	SUN 8:30A- 1:00P	Prytania
120	History of Concrete	SUN 8:30A- 10:00A	Magnolia
121	Quality Assurance	WED 2:00P- 5:00P	Magnolia
122	Energy Conservation	WED 2:00P- 5:00P	Toulouse
123	Research	MON 3:30P- 5:00P	Burgundy C
124	Concrete Aesthetics	TUE 8:30A- 11:30A	Buena Vista
126	Materials Database	TUE 2:00P- 5:00P	Rosedown
201	Durability	THU 2:00P- 3:30P	Cabildo C
207	Mass Concrete	MON 10:00A- 1:00P	Rampart
209	Creep and Shrinkage	MON 8:30A- 1:00P	E. Fields
210	Erosion/Hydraulic Struct.	TUE 2:00P- 3:30P	Magnolia
211	Proportioning	WED 3:30P- 6:30P	Cabildo A
211-A	Editorial and Coordination	TUE 10:00A- 1:00P	Carrollton
211-B	Lightweight	WED 2:00P- 3:30P	Prytania
211-C	No Slump	MON 3:30P- 5:00P	Versailles
211-D	High Strength	MON 11:30A- 1:00P	Carrollton
211-E	Evaluation & Adjustment	TUE 5:00P- 6:30P	Magnolia
212	Chemical Admixtures	MON 8:30A- 11:30A	Burgundy C
213	Lightweight	MON 5:00P- 6:30P	Burgundy D
213-A	High-Strength Lightweight	MON 8:30A- 10:00A	Burgundy D
213-B	Lightweight/Parking Structures & Bridge Decks	MON 10:00A-11:30A	Burgundy D
213-C	By-Product Lightweight Aggregates	MON 11:30A- 1:00P	Burgundy D
213-D	Review of 213 Guide	MON 2:00P- 3:30P	Burgundy D
214	Strength Tests	WED 2:00P- 5:00P	Carrollton
215	Fatigue	TUE 10:00A-11:30A	Rosedown
216	Fire Resistance & Fire Protection of Structures	TUE 2:00P- 5:00P	Toulouse
221	Aggregates	TUE 11:30A- 1:00P	Poydras A
222	Corrosion of Metals in Concrete	TUE 10:00A- 1:00P	Esplanade B
223	Expansive Cement	TUE 2:00P- 5:00P	Kenilworth
224	Cracking	WED 2:00P- 5:00P	Versailles
225	Hydraulic Cements	MON 2:00P- 3:30P	Versailles
225-TG	Hydraulic Task Group	MON 10:00A-11:30A	Versailles
227	Radioactive Hazardous Waste Management	SUN 3:30P- 6:30P	Magnolia
228	Nondestructive Testing	TUE 2:00P- 6:30P	Ashland
229	Controlled Low-Strength	MON 2:00P- 3:30P	Burgundy C
230	Soil Cement	SUN 2:00P- 3:30P	Ashland
231	Early Age	TUE 2:00P- 5:00P	Elmwood
232	Fly Ash & Natural Pozzolons	MON 8:30A- 11:30A	Cabildo B
233	Ground Slag	TUE 2:00P- 5:00P	Burgundy D
234	Silica Fume	TUE 2:00P- 3:30P	Esplanade B
235	Knowledge Based Systems and Method Models	WED 2:00P- 3:30P	Rampart
301	Specifications	THU 8:30A- 5:00P	Gentilly
302	Construction of Floors	TUE 11:30A- 1:00P	Cabildo A
303	Architectural Concrete	MON 2:00P- 5:00P	Elmwood
304	Measure/Mix/Transport/Place	MON 8:30A- 11:30A	Toulouse
304-5R	Lightweight Subcommittee	MON 8:30A- 9:30A	Toulouse
304-6R	Lightweight Subcommittee	MON 8:30A- 9:30A	Toulouse

COMM.	COMMITTEE TITLE	DAY TIME	ROOM
305	Hot Weather	SUN 2:00P- 5:00P	Carrollton
306	Cold Weather	TUE 10:00A- 1:00P	E. Fields
307	Chimneys	WED 2:00P- 6:30P	Burgundy A
308	Curing Concrete	WED 2:00P- 3:30P	Cabildo A
308-R	Curing - SOA Report	TUE 2:00P- 5:00P	Prytania
308-S	Curing - Specifications	MON 2:00P- 5:00P	LaSalle
309	Consolidation	SUN 2:00P- 5:00P	Rosedown
311	Inspection	MON 8:30A- 11:30A	Kenilworth
315	Detailing	SUN 8:30A- 11:30A	Delgado
318	Building Code (M-1)	MON 9:00A- 1:00P	Cabildo C
318	Building Code (M-2)	TUE 2:00P- 6:30P	Cabildo C
318-A	General, Concrete Construction	MON 2:00P- 6:30P	Kenilworth
318-B	Reinforcement and Development	TUE 8:30A- 1:00P	Cabildo C
318-C	Serviceability/Safety	TUE 8:30A- 1:00P	Elmwood
318-D	Flexure and Axial Loads	TUE 8:30A- 1:00P	Magnolia
318-E	Shear and Torsion	MON 2:00P- 6:30P	Burgundy A
318-F	Two-Way Slabs	TUE 8:30A- 1:00P	Rampart
318-G	Prestressed Precast	MON 2:00P- 6:30P	Carrollton
318-H	Seismic Provisions	MON 2:00P- 6:30P	Cabildo C
325	Pavements	TUE 2:00P- 5:00P	Delgado
325-09	Construction	MON 8:30A- 10:00A	Delgado
325-10	Roller Compacted Concrete	TUE 10:00A-11:30A	Delgado
325-32	Jointed Pavement	TUE 8:30A- 10:00A	Delgado
325-33	Fast Track Pavements	MON 11:30A- 1:00P	Delgado
325-34	Rehabilitation & Restoration	MON 3:30P- 5:00P	Delgado
325-35	Con. Paver Block Pavements	MON 2:00P- 3:30P	Delgado
325-36	Concrete Pavement Strengths	MON 10:00A- 11:30A	Delgado
330	Parking Lots	WED 2:00P- 5:00P	Rosedown
332	Residential	WED 2:00P- 5:00P	Gentilly
332-TG1	Residential Task Group 1	TUE 2:00P- 3:30P	Buena Vista
332-TG2	Residential Task Group 2	TUE 11:30A- 1:00P	Buena Vista
335	Composite and Hybrid Structures	TUE 8:30A- 11:30A	Poydras B
336	Footings	SUN 8:30A- 1:00P	Rampart
340	Design Aids for ACI Building Codes	MON 2:00P- 5:00P	Magnolia
341	Earthquake-Resistant Bridges	SUN 8:30A- 11:30A	Audubon
342	Bridges & Bridge Elements	SUN 2:00P- 3:30P	Buena Vista
343	Bridge Design	SUN 3:30P- 6:30P	Cabildo A
345	Bridge Construction	SUN 11:30A- 1:00P	Toulouse
346	CIP Pipe	SUN 2:00P-3:30P	Elmwood
347	Formwork	TUE 2:00P- 5:00P	Audubon
348	Safety	SUN 5:00P- 6:30P	Toulouse
349	Nuclear Structures	TUE 8:30A- 11:30A	Versailles
349-1	Materials & Waste & Repository Structures	MON 8:30A- 1:00P	Magnolia
349-2	Design	SUN 2:00P- 5:00P	Rampart
349-3	Embedment (M-1)	SUN 8:30A- 1:00P	Gentilly
349-3	Embedment (M-2)	MON 8:30A- 1:00P	Gentilly
350	Environmental Structures (M-1)	SUN 10:00A- 1:00P	Cabildo C
350	Environmental Structures (M-2)	WED 8:30A- 10:00A	Esplanade C
350	Environmental Structures (M-3)	WED 2:00P- 6:30P	Esplanade C
350	Subcommittee Chairs	SUN 8:30A- 10:00A	Cabildo B

COMM. COMMITTEE TITLE	DAY TIME	ROOM
350-A Subcommittee Group A	SUN 2:00P- 5:00P	Cabildo B
350-B Subcommittee Group B	SUN 8:30A- 5:00P	Cabildo C
350-A Subcommittee Group A	MON 8:30A- 5:00P	Esplanade C
350-B Subcommittee Group B	MON 8:30A- 5:00P	Poydras B
350-A Subcommittee Group A	TUE 8:30A- 5:00P	Esplanade A
350-B Subcommittee Group B	TUE 8:30A- 5:00P	Esplanade C
351 Equipment Foundations	WED 2:00P- 3:30P	Buena Vista
351-2 Dynamic Subcommittee	TUE 2:00P- 5:00P	Rampart
352 Joints	SUN 2:00P- 5:00P	Kenilworth
355 Anchorage (M-1)	SUN 2:00P- 5:00P	Gentilly
355 Anchorage (M-2)	MON 2:00P- 5:00P	Gentilly
355/ Anchorage/		
CEB-TG CEB Task Group (M-1)	WED 2:00P- 6:30P	Kenilworth
355/ Anchorage/		
CEB-TG CEB Task Group (M-2)	THU 8:30A- 5:00P	Burgundy C
357 Offshore and Marine	WED 2:00P- 5:00P	Ashland
359 Nuclear Vessels	SAT 2:00P- 5:00P	Burgundy B
360 Slabs on Grade	MON 11:30A- 6:30P	Cabildo A
360-1 Slabs on Grade		
Subcommittee	MON 8:30A- 11:30A	Cabildo A
362 Parking Structures	WED 8:30A- 10:00A	Audubon
363 High-Strength	MON 2:00P - 5:00P	Esplanade A
363-1 High Strength Structural	MON 8:30A- 10:00A	Rampart
364- Requirements of Design/		
1/3/4/5 Evaluation	TUE 2:00P- 5:00P	E. Fields
364-2 Rehabilitation Materials	TUE 3:30P- 6:30P	Versailles
365 Service Life	WED 3:30P- 5:00P	Rampart
368 Earthquake Resistance	MON 8:30A- 11:30A	Esplanade A
369 Seismic Rehab	SUN 2:00P- 5:00P	Prytania
370 Dynamic & Vibratory Effects	TUE 8:30A- 11:30A	Burgundy C
371 Pedestal Water Towers	THU 8:30A- 2:00P	Versailles
372 Circ. Prstd. Wire Wrap	THU 8:30A- 1:00P	Rosedown
373 Cir. Prstd. Tendons	SUN 8:30A- 11:30A	Toulouse
408 Bond and Development	SUN 8:30A- 11:30A	Versailles
421 Slabs	TUE 2:00P- 5:00P	Burgundy C
423 Prestressed Concrete	WED 2:00P- 6:30P	Esplanade A
423-B Prestressed Concrete		
Bond Task Group	TUE 8:30A- 10:00A	Toulouse
435 Deflection	THU 8:30A- 11:30A	Rampart
437 Strength Evaluation	SUN 8:30A- 11:30A	Carrollton
439 Steel Reinforcement	WED 3:30P- 5:00P	Esplanade B
439-A Reinforcement A	WED 8:30A- 10:00A	Magnolia
439-B Reinforcement B	WED 8:30A- 10:00A	Elmwood
439-C Reinforcement C	WED 2:00P- 3:30P	Esplanade B
440 Fiber Reinforced Plastic	TUE 2:00P- 6:30P	Gentilly
440-D FRP Research	SUN 9:00A- NOON	Buena Vista
440-E Professional Education	MON 11:30A- 1:00P	Buena Vista
440-F FRP Repair	SUN 3:30P- 6:30P	Buena Vista
440-G FRP Student Education	MON 11:30A- 1:00P	Ashland
440-H FRP Reinforced Concrete	MON 8:30A- 11:30A	Carrollton
440-I FRP Prestressed Concrete	MON 3:30P- 6:30P	Rampart
440-J FRP Stay-in-Place Formwork	SUN 2:00P- 3:30P	Magnolia
441 Reinforced Concrete		
Columns	SUN 10:00A- 1:00P	Magnolia
442 Lateral Forces	WED 2:00P- 5:00P	Delgado
444 Experimental Analysis	MON 10:00A- 11:30A	Ashland
445 Shear and Torsion	WED 2:00P- 5:00P	Poydras B
445-1 State-of-the-Art Report	SUN 3:30P- 5:00P	Toulouse
445-2 Full Member Design	MON 2:00P- 5:00P	E. Fields
445-3 Shear Issues	SUN 8:30A- 3:30P	Cabildo A
446 Fracture Mechanics	TUE 5:00P- 6:30P	Burgundy B

COMM. COMMITTEE TITLE	DAY TIME	ROOM
446-3 Finite Element Analysis and Fracture	TUE 2:00P- 3:30P	Burgundy B
446-4 Dynamic Fracture	TUE 3:30P- 5:00P	Burgundy B
503 Adhesives	TUE 2:00P- 5:00P	Cabildo A
503-A Adhesives - Subcommittee	TUE 11:30A- 1:00P	Toulouse
506 Shotcreting	TUE 8:30A- 11:30A	Prytania
506-A Shotcreting Subcommittee	TUE 3:00P- 5:30P	Magnolia
515-A Protective Systems for Concrete - A	MON 11:30A- 1:00P	Burgundy C
515-B Protective Systems for Concrete - B	TUE 11:30A- 1:00P	Burgundy C
523 Cellular Concrete	MON 8:30A- 11:30A	Esplanade B
524 Plastering	MON 10:00A- 11:30A	Buena Vista
530- MSJC Executive Committee	WED 7:00P- 10:00P	Gentilly
530-2 General Subcommittee	FRI 8:30A- 11:30A	Magnolia
530-3 Allow. Stress/Emp. Design Subcommittee	FRI 2:00P- 3:30P	Magnolia
530-4 Limit States Subcommittee	FRI 8:30A- 11:30A	Oak Manor
530-5 Specifications Subcommittee	FRI 11:30A- 1:00P	Magnolia
530-6 Editorial Task Group	THU 10:00A- 11:30A	Elmwood
530-7 Prestressed Subcommittee	FRI 3:30P- 5:00P	Magnolia
530-8 Glass Block Task Group	THU 11:30A- 1:00P	Magnolia
530-9 Coefficients Task Group	THU 2:00P- 3:30P	Buena Vista
530-10 Modulus of Elasticity Task Group	THU 8:30A- 10:00A	Buena Vista
530-11 Inspection Task Group	THU 2:00P- 3:30P	Elmwood
530-12 Empirical Task Group	THU 8:30A- 10:00A	Elmwood
530-13 International Standards Subcommittee	THU 3:30P- 5:00P	Magnolia
530-14 Allowable Stress. Reinf. Details Task Group	THU 8:30A- 10:00A	Magnolia
530-15 Seismic Task Group	THU 2:00P- 3:30P	Magnolia
530-16 Veneers Task Group	THU 11:30A-1:00P	Elmwood
530-17 Design Procedures Task Group	THU 5:00P- 6:30P	Magnolia
530-18 Infilled Walls Task Group	THU 10:00A- 11:30A	Magnolia
530-19 Compressive Strength Task Group	THU 10:00A- 11:30A	Buena Vista
530-20 Cavity Wall Task Group	THU 11:30A- 1:00P	Buena Vista
530 Masonry	SAT** 8:00A- 2:00P	Esplanade A
531 Masonry Research	WED 2:00P- 3:30P	Audubon
533 Precast Panels	MON 10:00A- 1:00P	Elmwood
543 Concrete Piles	MON 8:30A- 5:00P	Audubon
544 Fiber Reinforced	TUE 2:00P- 5:00P	Cabildo B
544-Ex Executive Subcommittee	MON NOON- 1:00P	Toulouse
544-A Steel Fibers	MON 2:00P- 3:30P	Esplanade B
544-B Glass Fibers	MON 2:00P- 3:30P	Toulouse
544-C Synthetic Fibers	MON 3:30P- 5:00P	Esplanade B
544-D Natural Fibers	MON 3:30P- 5:00P	Toulouse
544-E FRC Seminars	MON 5:00P- 6:30P	Toulouse
544-F Testing	TUE 8:30A- 10:00A	Cabildo B
544-G Design & Structural Uses	TUE 10:00A- 1:00P	Cabildo B
546 Repair	MON 2:00P- 5:00P	Poydras A
548 Polymers	TUE 8:30A- 11:30A	Cabildo A
548-A Polymer Modified Concrete	MON 10:00A- 11:30A	Rosedown
548-B Polymer Concrete Overlays	MON 2:00P- 5:00P	Cabildo B
548-D Sulfur Concrete	MON 8:30A- 10:00A	Rosedown
548-E Structural Design & Analysis	MON 11:30A- 1:00P	Rosedown

COMM. COMMITTEE TITLE	DAY TIME	ROOM
549 Ferrocement and Other Thin Reinforced Products	WED 2:00P- 5:00P	Burgundy C
550 Precast Concrete Structures	TUE 8:30A- 1:00P	Burgundy D
551 Tilt-Up Construction	TUE 8:30A- 1:00P	Audubon
552 Geotechnical Grouting	MON 5:00P- 6:30P	Burgundy C
554 Bearing Systems	TUE 8:30A- 10:00A	Rosedown
555 Removal and Reuse	THU 10:00A- 1:00P	Ashland
556 Demolition	THU 8:30A- 10:00A	Ashland
558 Protective Coatings	TUE 3:30P- 5:00P	Buena Vista

* Friday, November 1, 1996 **Saturday, November 9, 1996

NOTE: Committees not listed did not request a meeting at this convention or the committee has requested a closed meeting. Those committees having closed meetings have received a closed meeting schedule.

This schedule is subject to change. Please check the signs on-site to verify your meeting time.



Electronic Version
of ACI's Concrete Abstracts

CA QuickSearch delivers the same coverage of the worldwide literature of concrete technology as the bimonthly periodical *Concrete Abstracts*. The CD-ROM includes fourteen years--1982-1995--of international literature. And this year both DOS and Windows™ 3.1 versions are available on the CD-ROM.

The CA QuickSearch annual subscription service offers each current issue of *Concrete Abstracts* on floppy disk, coinciding with the print publication. Each bimonthly issue contains 250 new abstracts. Every covered article, report, or book is assigned an abstract number and includes the document title, original language of publication (if other than English), keywords, bibliographic information, abstract, and abstract credit.

What's the advantage? The search software is easy to use with context-sensitive online Help designed for first-time users. Each year the CD-ROM compilation is updated to include an additional year of literature, and currently offers instant reference to over 22,000 documents.

Call ACI Member Services Department at (810) 848-3800. Demo disks are available for \$25, which will be credited toward the purchase of any CA QuickSearch package.

FALL 1996 ACI EDUCATIONAL SEMINARS

ACI has scheduled ten more seminars this fall on the *Changes in the ACI 318-95 Building Code* and seven seminars on the *Design and Construction of Slabs on Grade*. More seminars on a variety of topics are planned for 1997. ACI instructors are considered the best and most professional in the concrete industry. All seminars are held in cooperation with your local ACI chapter.

► **318 Building Code** -- this one-day seminar covers significant changes to the ACI 318 Building Code. Sponsored by the American Concrete Institute and Portland Cement Association, these seminars are held every six years coinciding with each major Code revision.

New Orleans - **November 8**

Cleveland - **November 20**

Toledo - **November 21**

Cincinnati - **November 22**

Birmingham - **December 3**

Atlanta - **December 4**

Buffalo - **December 4**

Austin - **December 10**

Los Angeles/Anaheim - **December 11**

San Francisco/Oakland - **December 12**

► **Slabs on Grade** -- this one-day seminar will cover design, specification, and problem resolution on one of the most common of all concrete structures, the slab on grade.

Detroit - **November 14**

Dallas - **November 19**

Atlanta - **November 19**

Indianapolis - **November 21**

Ft. Myers - **December 3**

Philadelphia - **December 5**

Oklahoma City - **December 10**

SEMINARS FOR 1997

Stop by the convention registration area, or call the Seminar Registrar at 810/848-3815 or fax 810/848-3801 for more detailed information.

ONE-DAY SEMINARS

- ▶ **530 Masonry Code**—How to use the new 1995 edition of the 530 Masonry Code
- ▶ **Concrete Repair Basics**—Methods and Materials for Repair of Damaged Structures
- ▶ **Troubleshooting Concrete Construction**—Causes of Floor and Slab Surface Failures
- ▶ **Concrete Durability**—How to Design, Specify, and Construct Quality Concrete
- ▶ **Seismic Retrofit of Concrete Structures**— Evaluation, Analysis, Rehabilitation, Case Histories
- ▶ **Concrete Site Paving**—Achieving Economical Site Concrete to Minimize Future Problems & Maintenance
- ▶ **Structural Lightweight Concrete**— Design, Production, and Durability of Bridges and Parking Structures

TWO-DAY SEMINAR

- ▶ **Designing Reinforced Concrete**—Based on the ACI 318 Building Code and the ACI 340 Design Handbook

**NEWLY ISSUED
FOUR NEW VIDEOTAPES FROM ACI**

SLABS ON GRADE

Design, Specification, and Construction

ACI's popular series of seminars on concrete slabs-on-grade is now available as a series of four videotapes. This six and one-half hour program includes the entire ACI seminar that has been attended by over 3000 people. For about the same price as attending the seminar you can watch the videos in your offices or at a time convenient for you. The seminar slides have been transferred to video and the speakers were recorded in a studio to yield an extremely high quality video.

TOPICS COVERED

Program 1 - 120 minutes, EV2A96

- ◆ Introduction
- ◆ Overview
- ◆ Myths and Misconceptions
- ◆ Planning and Selection
- ◆ Subsurface Considerations
- ◆ Concrete Mix Designs
- ◆ Proper Floor Tolerances

Program 2 - 120 minutes, EV2B96

- ◆ Design Input Values
- ◆ Thickness Design Procedures
- ◆ Shrinkage-Compensating Concrete
- ◆ Fiber Reinforced Concrete
- ◆ Supporting Design Information
- ◆ Computer Solutions

Program 3 - 120 minutes, EV2C96

- ◆ Overview of Post Tensioning
- ◆ Post-Tensioning Design Procedure
- ◆ Design Details
- ◆ Specifications

Program 4 - 35 minutes, EV2D96

- ◆ Problems: Identification, Cause, and Prevention

SPEAKERS

BOYD C. RINGO is a consultant based in Cincinnati, Ohio. Dr. Ringo is a former Professor in Civil Engineering at the University of Cincinnati, and has consulted on slabs on grade for over 40 years. He is a former chairman of ACI Committee 360, Design of Slabs on Grade. Under his guidance, the committee produced the most comprehensive design document on slabs on grade ever produced by ACI.

JERRY A. HOLLAND, is a Structural Engineering Consultant with Lockwood Greene Engineers and Architects in Atlanta, Georgia. He has 25 years of experience in design, construction, and troubleshooting of slabs on grade, including superflat floors. Mr. Holland is currently the chairman of ACI Committee 360, Design of Slabs on Grade.

ROBERT B. ANDERSON is a Concrete Floor Consultant in New Orleans, Louisiana with more than 25 years of experience. He has been the primary designer for several million square feet of industrial and residential slabs. In 1964, he was responsible for the design and placement of the first residential post-tensioned slab in North America. Mr. Anderson and Dr. Ringo are the authors of *Designing Floor Slabs on Grade*.

<u>Video</u>	<u>PRICE</u>	
	<u>Non-Member</u>	<u>Member</u>
Program 1, EV2A96	\$125	\$100
Program 2, EV2B96	\$125	\$100
Program 3, EV2C96	\$125	\$100
Program 4, EV2D96	\$ 75	\$ 50
Package price for entire set of four tapes, EV2E96	\$399	\$299

**ORDERING INFORMATION AVAILABLE AT
THE ACI PUBLICATIONS DESK**

**It's not too early to plan to
attend the ...**

**1997
International
Conference**



***High-Performance Concrete:
Design and Materials
and
Recent Advances in
Concrete Technology***

***December 2 - 5, 1997
Kuala Lumpur, Malaysia***

This third international conference will disseminate new information in the rapidly developing areas of high-performance concrete, and concrete technology where major advances taking place and new materials, methodologies and techniques are being developed. The objective of this conference is to bring researchers, practicing engineers and technologists together to exchange new information and to explore new areas of needed research.

***For further information contact:
American Concrete Institute
Member Services Department
P.O. Box 9094
Farmington Hills, MI 48333
Tel: (810) 848-3800
Fax: (810) 848-3801***

STUDENT PROGRAM

SUNDAY, NOVEMBER 3
NOON - 5:00 PM

TULANE UNIVERSITY
Civil Engineering Building
Materials Testing Laboratory

CONCRETE CUBE COMPETITION

Sponsored by Committee E801 and the ACI Louisiana Chapter

Session Moderator: Kelly M. Page
Contract Training Coordinator
Portland Cement Association
Skokie, IL

Session Co-Moderator: John L. Niklaus
Professor
Department of Civil and
Environmental Engineering
Tulane University
New Orleans, LA

Students interested in traveling to Tulane by shuttle bus in a group are to meet at the New Orleans Chapter Hospitality Desk located near the registration area at the Hyatt Regency Hotel. **12:00**

Welcome by Tulane University Host **12:30**

ACI and Convention Overview **1:00**
Kelly M. Page, Contract Training Coordinator, Portland Cement Association, Skokie, IL

Mentor Program Overview **1:15**
John L. Niklaus, Professor, Department of Civil and Environmental Engineering, Tulane University, New Orleans, LA

Presentation by Winner of 1996 ACI Student Concrete Projects Competition **1:30**
Ryan W. Keiser, Student, Southern Illinois University at Edwardsville, Edwardsville, IL

FRP-Reinforced Concrete Beam Competition
The FRP-Reinforced Concrete Beam Competition will be held concurrently with the Concrete Cube Competition.

Adjournment **5:00**

TECHNICAL SESSION

SUNDAY, NOVEMBER 3
2:00 PM - 5:00 PM

ROOM: POYDRAS A

USE OF HIGH-PERFORMANCE FIBER REINFORCED CONCRETE FOR INFRASTRUCTURAL REPAIR AND RETROFIT: PART I

Sponsored by Committees 348 and 544

Session Moderator: Neven Krstulović-Opara
Assistant Professor
Department of Civil Engineering
North Carolina State University
Raleigh, NC

Session Co-Moderator: M. Ziad Bayasi
Associate Professor
Department of Civil and
Environmental Engineering
San Diego State University
San Diego, CA

Introduction	2:00
Neven Krstulović-Opara, Assistant Professor, Department of Civil Engineering, North Carolina State University, Raleigh, NC	
Concrete Repair at the Threshold of the 21st Century: Focus on the Strengthening of Existing Structures	2:05
Alexander M. Vaysburd, Director, Research and Development, and Peter H. Emmons, President, Structural Preservation Systems, Inc., Baltimore, MD	
National Science Foundation: Repair and Retrofit with HPFRC's	2:30
John B. Scalzi, Director, Civil and Mechanical Systems, National Science Foundation, Arlington, VA	
FRC-Encased Steel Joists for Seismic Upgrading	2:55
Subhash C. Goel, Professor, and Madhusudan Khuntia, Graduate Student, Department of Civil and Environmental Engineering, University of Michigan, Ann Arbor, MI	
Seismic Retrofit with SIMCON and SIFCON	3:25
Neven Krstulović-Opara, Assistant Professor, and Erdem Dogan, Research Assistant, Department of Civil Engineering, North Carolina State University, Raleigh, NC; James M. LaFave, Research Associate, Department of Civil and Environmental Engineering, University of Michigan, Ann Arbor, MI; and Chia-Ming Uang, Associate Professor, Department of Applied Mechanics and Engineering Sciences, University of California at San Diego, La Jolla, CA	

continued

TECHNICAL SESSION

SUNDAY, NOVEMBER 3
2:00 PM - 5:00 PM

ROOM: POYDRAS A

USE OF HIGH-PERFORMANCE FIBER REINFORCED CONCRETE FOR INFRASTRUCTURAL REPAIR AND RETROFIT: PART I

Sponsored by Committees 348 and 544

continued

- | | |
|--|-------------|
| Slurry Infiltrated Mat Concrete (SIMCON) for Rehabilitation of Bridges and Pavements | 3:50 |
| Jack Y. Zeng, Research/Teaching Associate;
Paul H. Klingenberg, Research Assistant; and
M. Ziad Bayasi, Associate Professor, Department of
Civil and Environmental Engineering, San Diego State
University, San Diego, CA | |
| Repair of Berth Faces at the Port of Montréal with Fiber Reinforced Shotcrete | 4:15 |
| Dudley R. Morgan, Chief Materials Engineer, AGRA Earth
and Environmental Ltd., Burnaby, British Columbia, Canada;
Allen C. Lobo, Civil Engineer, Port of Montréal, Montréal,
Québec, Canada; and Larry D. Rich, Senior Product
Development Specialist, 3M - Construction Markets Division,
St. Paul, MN | |
| Concrete with Three Percent Fibers for Repair and Retrofit | 4:40 |
| P. N. Balaguru, Professor, Department of Civil Engineering,
Rutgers, The State University of New Jersey, Piscataway,
NJ; H. Andrew Franklin, Project Engineer, Research and
Development, Bechtel Group, Inc., San Francisco, CA;
Ronald J. Stickel, Teichert Quality Assurance, Sacramento,
CA; and Sidney Mindess, Professor, Department of Civil
Engineering, University of British Columbia, Vancouver,
British Columbia, Canada | |

TECHNICAL SESSION

SUNDAY, NOVEMBER 3
2:00 PM - 5:00 PM

ROOM: REGENCY B

AERATED CONCRETE PERFORMANCE IN DISASTERS

Sponsored by Committee 523

- Session Moderator:** Fouad H. Fouad
Professor and Chairman
Department of Civil and
Environmental Engineering
University of Alabama at Birmingham
Birmingham, AL
- Introduction and Brief History** 2:00
Fouad H. Fouad, Professor and Chairman,
Department of Civil and Environmental Engineering,
University of Alabama at Birmingham, Birmingham, AL
- Testing Autoclaved Cellular Concrete Building
Materials for Fire Resistance** 2:10
Dean M. Golden, Senior Project Manager, Electric Power
Research Institute, Palo Alto, CA
- Shear Strength, Stiffness, and Wind Uplift
Resistance of Composite Cellular Insulating
Concrete Roof Deck Systems** 2:30
William R. MacDonald, Vice President and Director of
Technical Services, Celcore Inc., Black Mountain, NC
- Resistance of AAC to Earthquakes** 2:50
Peter Langer, Director of Application and Construction,
Hebel AG, Emmering, Germany
- AAC Resistance to Fire, Frost, Chemical Attack,
Biological Sources, and Extreme Wind Load** 3:10
Dieter D. G. Hums, Director, Research and Development
Center, Ytong AG, Schrobenhausen, Germany
- Impact Resistance and Energy Absorption of Cellular
Concrete during Earthquakes and Hurricanes** 3:30
Timothy D. Tonyan, Senior Member of Technical Staff,
Architectural Systems Laboratory, USG Corp., Libertyville, IL
- Damage Analysis of Autoclaved Aerated Concrete
Block Houses** 3:50
Romeo E. Miretti, Civil Engineer and Director of CECOVI;
Rudy O. Grether, Civil Engineer and Researcher; and
Carlos R. Passerino, Civil Engineer and Researcher,
University of National Technology, Santa Fe, Argentina
- Cellular Concrete Structural Behavior under
Seismic Conditions** 4:10
*Francisco Madla, Technical Manager, Contec Mexicana,
S. A., Monterrey, Mexico*
- Questions and Answers** 4:30

TECHNICAL SESSION

SUNDAY, NOVEMBER 3
2:00 PM - 5:00 PM

ROOM: REGENCY C

CONCRETE STRUCTURES IN THE GULF SOUTH

Sponsored by the ACI Louisiana Chapter

Session Moderator: Robert B. Anderson
Consulting Civil Engineer
Anderson Engineers, Inc.
New Orleans, LA

Introduction Robert B. Anderson, Consulting Civil Engineer, Anderson Engineers, Inc., New Orleans, LA	2:00
Inspecting and Repairing the Piling Supporting the World's Longest Bridge Guy F. LeMieux, Consulting Civil Engineer, Krebs, LaSalle, LeMieux Consultants, Metairie, LA	2:05
Mat Slab Design as a Deep Beam: An Uplifting Solution! Subhash V. Kulkarni, President, Kulkarni Consultants, APC, Metairie, LA	2:30
Fast-Track Design and Construction of Tall Retaining Walls William E. Rushing, Jr., Structural Engineer, Waldemar S. Nelson & Co., Inc., New Orleans, LA	2:55
Nashville Avenue Wharf William B. Cromartie, Structural Engineer, Port of New Orleans, New Orleans, LA	3:20
Enhancing Productivity and Maintenance with a Unique Two-Way Post-Tensioned, Light Reflective Floor Jerry A. Holland, Consulting Structural Engineer, and Wayne W. Walker, Senior Structural Engineer, Lockwood Greene Engineers, Atlanta, GA	3:45
Aquarium of the Americas Donald C. Makofsky, President, Morphy Makofsky, Inc., New Orleans, LA	4:10

EDUCATIONAL SESSION

SUNDAY, NOVEMBER 3
2:00 PM - 5:00 PM

ROOM: POYDRAS B

A NEW ACI DOCUMENT: *EDUCATION BULLETIN E4-96—ADMIXTURES IN CONCRETE*

Sponsored by Committee E701

This session will discuss a newly issued document that covers the basic uses of chemical and air-entraining admixtures for concrete. *Education Bulletin E4-96* has been developed to meet the educational needs of students, craftsmen, inspectors, technicians, and all others who need an introduction to this complex topic. Our speakers will describe *E4-96* in detail, and how it can be used as a valuable educational tool.

Session Moderator:	Morris V. Huffman Division Manager Pozzolanic Northwest Oregon City, OR	
Session Co-Moderator:	Patrick L. McDowell Quality Control Manager Eugene Sand and Gravel Eugene, OR	
Chapter I of <i>E4-96</i>: Introduction		2:00
Morris V. Huffman, Division Manager, Pozzolanic Northwest, Oregon City, OR		
Chapter II of <i>E4-96</i>: Introduction to Admixtures		2:05
Patrick L. McDowell, Quality Control Manager, Eugene Sand and Gravel, Eugene, OR		
Chapter III of <i>E4-96</i>: Air-Entraining Admixtures in Concrete		2:15
Paul J. Tikalsky, Associate Professor, Department of Civil Engineering, The Pennsylvania State University, University Park, PA		
Chapter IV of <i>E4-96</i>: Water-Reducing and Strength Enhancing Chemical Admixtures		2:35
Charles K. Nmai, Senior Technical Manager, Marketing Department, Master Builders, Inc., Cleveland, OH		
Chapter IV of <i>E4-96</i>: Set-Controlling Admixtures		3:05
Kenneth B. Rear, Manager of Technical Services, North America, Grace Construction Products, Cambridge, MA		
Admixture Case Studies		3:35
Tarek S. Khan, Marketing Manager, Ready-Mixed Concrete, Master Builders, Inc., Cleveland, OH		

continued

EDUCATIONAL SESSION

SUNDAY, NOVEMBER 3
2:00 PM - 5:00 PM

ROOM: POYDRAS B

A NEW ACI DOCUMENT: *EDUCATION BULLETIN E4-96—ADMIXTURES IN CONCRETE*

Sponsored by Committee E701

continued

An Introduction to Other Chemical Admixtures	4:05
David M. Suchorski, Technical Service Engineer, Lehigh Portland Cement Co., Iowa Falls, IA	
Chapter V of <i>E4-96</i>: Admixture Dispensers	4:20
Randall M. Fierke, National Technical Service and Design Specialist, Dispenser Operations, Grace Construction Products, Bedford Park, IL	
Closing Remarks	4:50



ACI PUBLICATIONS ON SALE!

Stop by the ACI Publications display next to the convention registration area. See what ACI has available for sale. Purchase the technical publications that you need.

On display at super convention savings will be over ninety publications representing what's new from ACI, hot topics that everyone is asking for, special publications developed with you in mind, and BARGAIN Books discounted to rock bottom prices.

* *Standards*

* *Reports*

* *Special Publications*

* *Handbooks*

* *Periodicals*

* *CD-ROM*

* *BARGAIN Books*

Publications will be on sale during the registration hours (see Page 14). You may purchase your selection with cash, check, travelers checks, VISA, MasterCard, or use your membership line-of-credit and we'll bill you. All publications are available on a first come first served basis so stop by early and purchase the publications you want!

DID YOU KNOW?

ACI administers programs to certify:

Concrete Field Testing Technicians
Concrete Laboratory Testing Technicians
Concrete Construction Inspectors
Concrete Transportation Construction
Inspectors
Concrete Flatwork Finishers
Concrete Flatwork Technicians

In addition, programs are under development for:

Concrete Strength Testing Technicians
Shotcrete Nozzlemen
Tilt-up Construction Supervisors

These national organizations participate (cooperate) with ACI in programs to improve the quality of concrete construction:

American Society for Concrete Construction
American Society for Testing and Materials
Cement and Concrete Reference Laboratory
Concrete Construction Magazine
National Ready Mixed Concrete Association
Portland Cement Association
U.S. Army Corps of Engineers

EDUCATIONAL SESSION

MONDAY, NOVEMBER 4
7:00 AM - 8:30 AM

ROOM: REGENCY B

BREAKFAST TRAINING SESSION FOR SESSION MODERATORS AND SPEAKERS

Sponsored by Committee E903

Session Moderator: Kenneth H. Murray
Civil Engineering Department Chair
North Carolina A&T State University
Greensboro, NC

Continental Breakfast	7:00
Convention Session Time-Lines	7:20
	David G. Kittridge Principal Engineer Boyle Engineering Corp. Orlando, FL
Discussion and Feedback	7:45
Evaluation and Adjournment	8:20

STUDENTS' DAY

MONDAY, NOVEMBER 4

8:00 AM - 2:00 PM

ACI and the ACI Louisiana Chapter are hosting a special day for the future leaders of our industry.

Mentor Program

8:00

Students and mentors will meet at the ACI Louisiana Chapter Hospitality Desk located near the registration area in the Hyatt Regency Hotel.

Registered students will be assigned a mentor with similar interests to attend committee meetings and technical sessions. All technical meetings are open to students.

Students to accompany their individual mentors in their morning convention activities.

8:30

Luncheon

NOON

The luncheon will be held in the Regency B room at the Hyatt Regency Hotel.

Program Commences

1:00

Announcement of winners and plaques given for the ACI Concrete Cube Competition.

Featured Speaker

1:15

"Northumberland Strait Bridge"

Walter Eggers, Senior Bridge Engineer, J. Muller International, San Diego, CA

Return to Convention Activities

2:00



Menu

Minestrone Soup
Baked Meat Marinara Lasagna
Garlic Bread and Rolls
Lattice Apple Pie
Coffee, Tea, Decaf
\$18.00 per person

TECHNICAL SESSION

MONDAY, NOVEMBER 4
9:00 AM - NOON

ROOM: REGENCY C

RESEARCH IN PROGRESS

Sponsored by Committee 123

Session Moderator: Nataliya Hearn
Assistant Professor
Department of Civil Engineering
University of Toronto
Toronto, Ontario, Canada

Introduction 9:00
Nataliya Hearn, Assistant Professor, Department of Civil Engineering, University of Toronto, Toronto, Ontario, Canada

Fatigue Life of Reinforced Concrete Beams Strengthened with CFRP Sheet 9:02
Pat J. Heffernan, Assistant Professor, and Marie-Anne Erki, Professor, Department of Civil Engineering; and David L. Duquensnay, Associate Professor, Department of Mechanical Engineering, Royal Military College of Canada, Kingston, Ontario, Canada

Study of Bond Strength Between Externally Applied Carbon Fiber Reinforcement and Concrete 9:16
Alexander M. Vaysburd, Director, Research and Development, Structural Preservation Systems, Inc., Baltimore, MD; and Miroslav Vadovic, Structural Engineer, and Glen L. Hair, Vice President and Manager, Structural Department, Gannett Fleming Inc., Harrisburg, PA

Basalt Fiber for Reinforcement of Concrete 9:30
Timothy J. Langan, Senior Staff Engineer and Scientist, Ashurst Technology Center Inc., A member of the EMTECH Group of Companies, Baltimore, MD; and Victor I. Prefilov, Institute Director; M. F. Mokhova, Head; V. P. Sergeev, Director; D. D. Dzhygiris, Head; and I. H. Bockararova, Research Secretary, Basalt Fibers Technology Department, Institute for Problems in Materials Science, The Academy of Science of The Ukraine, Kyiv, Ukraine

Restrained Shrinkage Cracking in Fiber Reinforced Shotcrete 9:44
Nemkumar P. Banthia, Professor, and Kevin Campbell, Graduate Student, Department of Civil Engineering, The University of British Columbia, Vancouver, British Columbia, Canada; and Dudley R. Morgan, Vice President and Chief Materials Engineer, AGRA Earth and Environmental, Burnaby, British Columbia, Canada

continued

TECHNICAL SESSION

MONDAY, NOVEMBER 4
9:00 AM - NOON

ROOM: REGENCY C

RESEARCH IN PROGRESS

Sponsored by Committee 123

continued

Enhancement of the Axial Load-Carrying Capacity of Reinforced Concrete Columns by Means of Fiberglass-Epoxy Jackets **9:58**

Ben L. DeVino, President, Composite Retrofit International, Montréal, Québec, Canada, and Jose I. Restrepo, Lecturer, Department of Civil Engineering, University of Canterbury, Christchurch, New Zealand

Durability Design of Post-Tensioned Bridge Substructure Elements **10:12**

Jeffrey S. West, Doctoral Candidate; John E. Breen, Nasser I. Al-Rashid Chair; and Michael E. Kreger, Professor, Department of Civil Engineering, Phil M. Ferguson Structural Engineering Laboratory, The University of Texas at Austin, Austin, TX

Design Provisions for Steel-Free Deck Slabs on Beams **10:26**

Aftab A. Mufti, Professor and Director, The Nova Scotia CAD/CAM Center, TUNS, The Center for Computer-Aided Engineering, Halifax, Nova Scotia, Canada, and Baidar Bakht, Principal Research Engineer, Research and Development Branch, Ministry of Transportation - Ontario, Downsview, Ontario, Canada

Application of Headed Reinforcement in Concrete Members **10:40**

Tarek R. Bashandy, Graduate Research Assistant, and James O. Jirsa, Professor, Department of Civil Engineering, Phil M. Ferguson Structural Engineering Laboratory, The University of Texas at Austin, Austin, TX

Use of Bonded Anchor Systems **10:54**

Rolf Eligehausen, Professor; Joerg Asmus, Doctoral Student; Bernahard Lehr, Doctoral Student; and Jurai Meszaros, Research Assistant, Construction Materials Institute, University of Stuttgart, Stuttgart, Germany

Concrete Technology on the World Wide Web **11:08**

Dale P. Bentz, Chemical Engineer; James R. Clifton, Chemist; Lawrence J. Kaetzel, Computer Specialist; Kenneth A. Snyder, Physicist; and Dai Zhenqing, Research Engineer (on appointment from the China Building Technology Development Center), Building Materials Division, Building and Fire Research Laboratory, National Institute of Standards and Technology, Gaithersburg, MD

continued

TECHNICAL SESSION

MONDAY, NOVEMBER 4
9:00 AM - NOON

ROOM: REGENCY C

RESEARCH IN PROGRESS

Sponsored by Committee 123

continued

Cement Hydration Observed with Synchrotron Radiation 11:22

Paulo J. M. Monteiro, Professor, and Kimberly E. Kurtis, Research Assistant, Department of Civil and Environmental Engineering, University of California at Berkeley, Richmond, CA

Preliminary Study of Permeability of Cracked Concrete 11:36

Kejin Wang, Graduate Student, NSF Center for Advanced Cement-Based Materials, Robert R. McCormick School of Engineering and Applied Science, Technological Institute, Northwestern University, Evanston, IL; Daniel C. Jansen, Assistant Professor, and Surendra P. Shah, Professor, Department of Civil and Environmental Engineering, Tufts University, Medford, MA; and Alan F. Karr, Associate Director, National Institute of Statistical Sciences, Research Triangle Park, NC

Phosphogypsum By-Product Aggregate Use in High-Strength Concrete 11:50

Mujahid T. Ali, Senior Project Engineer, Tasnim Uddin and Associates, Inc., Miami, FL, and Wen F. Chang, Professor Emeritus and Director Phosphate, Department of Engineering, University of Miami, Miami, FL

TECHNICAL SESSION

MONDAY, NOVEMBER 4
9:00 AM - NOON

ROOM: REGENCY E

STRUCTURAL CONCRETE UNDER SEVERE DYNAMIC LOADS

Sponsored by Committee 370

Session Moderator: Darrell D. Barker
Principal Engineer
Wilfred Baker Engineering
San Antonio, TX

Session Co-Moderator: Baren K. Talukdar
Principal Engineer
Westinghouse SRS
Aikem, SC

Introduction	9:00
Darrell D. Barker, Principal Engineer, Wilfred Baker Engineering, San Antonio, TX	
Performance of Fiber Reinforced Concrete Strengthening Methods under Dynamic Loads	9:05
Jay L. Thomas, Director, Sales and Marketing, and Alexander M. Vaysburd, Director, Research and Development, Structural Preservation Systems, Inc., Baltimore, MD; and Howard S. Kliger, Consultant, H. S. Kliger Associates, Edison, NJ	
Concrete Panel Response to Close In Blast Loading from Spherical and Cylindrical Charges	9:45
Doug R. Kaczmarek, Project Engineer, Mason and Hanger, Amarillo, TX	
Hydrocode Analysis of 12-Inch Reinforced Concrete Wall under Blast Loading	10:25
William H. Zehrt, Jr., Senior Structural Engineer, U. S. Army Engineering and Support Center - Huntsville, Huntsville, AL	
Investigation of Reinforced Concrete Test Cell Explosion Accident	11:05
Darrell D. Barker, Principal Engineer, Wilfred Baker Engineering, San Antonio, TX	

TECHNICAL SESSION

MONDAY, NOVEMBER 4
9:00 AM - NOON

ROOM: REGENCY F

INNOVATIVE TECHNOLOGY IN RESIDENTIAL CONSTRUCTION

Sponsored by Committee 332

Session Moderator: Raj K. Jalla
President
Consulting Engineers, Corp.
Vienna, VA

Introduction Raj K. Jalla, President, Consulting Engineers, Corp., Vienna, VA	9:00
Post-Tensioned Foundation Robert B. Anderson, President, Robert B. Anderson Consulting Engineers, Inc., New Orleans, LA	9:05
Cost-Efficient Design of Foundations in Expansive Soils Using State of the Art Interactive Graphics Computer Program H. S. Saxena, Project Engineer, and Scott Evans, Project Manager, Consulting Engineers, Corp., Vienna, VA	9:25
Hybrid Concrete Composite, Energy Efficient Home for Year 2001 and Beyond Gajanan M. Sabnis, Professor, Department of Civil Engineering, Howard University, Washington, DC	9:45
Fly Ash for Residential Concrete Richard R. Halverson, Division Manager, and Jennifer L. Hitch, Quality Assurance Manager, Pozzolanic North West, Mercer Island, WA	10:05
Inclined Concrete Roofing System with Self-Supported Insulation Francisco G. Bermudez, President, Arber and Associates, Miami, FL, and Jose Luis Henriquez, President, Envro Safe Concrete Roofing System, Miami, FL	10:25
Failure in Residential Concrete Robert L. Henry, National Secretary/Treasurer, Chi Epsilon, University of Texas at Arlington, Arlington, TX	10:45
Design of Structural Slabs in Residential Concrete Using State of the Art Interactive Graphics Computer Program H. S. Saxena, Project Engineer, and Scott Evans, Project Manager, Consulting Engineers, Corp., Vienna, VA	11:05
Insulated Concrete Forms Result in Super Energy Efficient Homes J. Lance Berrenberg, President, American Polysteel Forms, Albuquerque, NM	11:25

EDUCATIONAL SESSION

MONDAY, NOVEMBER 4
9:00 AM - NOON

ROOM: REGENCY G

COMPUTERS IN PRACTICE AND EDUCATION

Sponsored by Committees E705 and E802

Session Moderator: Nur Yazdani
Professor and Associate Chairman
Department of Civil Engineering
College of Engineering
Florida Agricultural and
Mechanical University --
Florida State University
Tallahassee, FL

Session Co-Moderator: Abbas Aminmansour
Professor
Department of Architectural Engineering
The Pennsylvania State University
University Park, PA

Introduction **9:00**
Abbas Aminmansour, Professor, Department of Architectural
Engineering, The Pennsylvania State University, University
Park, PA

Multimedia Instructional Aids: Use in the Classroom **9:05**
David R. Riley, Assistant Professor, Department of
Construction Management, University of Washington,
Seattle, WA

Educational Materials and the WWW **9:35**
Nelson C. Baker, Associate Professor, School of Civil and
Environmental Engineering, Georgia Institute of Technology,
Atlanta, GA

Use of Presentation Software in a Materials Course **10:05**
John J. Schemmel, Associate Professor, Department of
Civil Engineering, University of Arkansas, Fayetteville, AR

Daily Use of the WWW in the Engineering Classroom **10:35**
Jonathan R. Barnett, Professor, Center for Firesafety
Studies, Worcester Polytechnic Institute, Worcester, MA

**Using Multimedia for a More Effective Information
Presentation** **11:05**
Abbas Aminmansour, Professor, Department of Architectural
Engineering, The Pennsylvania State University, University
Park, PA

Computer Delivery of ACI Exams **11:35**
William A. McConarty, Managing Director, Training
Department, Sylvan Prometric, Columbia, MD

TECHNICAL SESSION

MONDAY, NOVEMBER 4
9:00 AM - NOON

ROOM: REGENCY H

USE OF HIGH-PERFORMANCE FIBER REINFORCED CONCRETE FOR INFRASTRUCTURAL REPAIR AND RETROFIT: PART II

Sponsored by Committees 348 and 544

Session Moderator: Neven Krstulović-Opara
Assistant Professor
Department of Civil Engineering
North Carolina State University
Raleigh, NC

Session Co-Moderator: M. Ziad Bayasi
Associate Professor
Department of Civil and
Environmental Engineering
San Diego State University
San Diego, CA

Introduction **9:00**
Neven Krstulović-Opara, Assistant Professor, Department of Civil
Engineering, North Carolina State University, Raleigh, NC

**Parameters Affecting High-Performance Response
in Fiber Reinforced Concrete** **9:05**
Surendra P. Shah, Director, ACBM Center, Northwestern
University, Evanston, IL, and Yixin Shao, Assistant
Professor, Department of Civil Engineering and Applied
Mechanics, McGill University, Montréal, Québec, Canada

**HPFRCC: Mechanical Properties and Applications in
Repair and Rehabilitation** **9:25**
Antoine E. Naaman, Professor, Department of Civil and
Environmental Engineering, University of Michigan,
Ann Arbor, MI

Design and Construction Procedures for SIFCON **9:50**
Bruce Schneider, Consulting Engineer, Peralta, NM

**Design Guidelines for Using High-Performance
Fiber Reinforced Concrete in Repair/Retrofit
Applications** **10:15**
Howard J. Hill, Consultant, Wiss, Janney, Elstner
Associates, Inc., Northbrook, IL, and Sigmund A. Freeman,
Consultant and Principal, Wiss, Janney, Elstner Associates,
Inc., Emeryville, CA

continued

TECHNICAL SESSION

MONDAY, NOVEMBER 4
9:00 AM - NOON

ROOM: REGENCY H

USE OF HIGH-PERFORMANCE FIBER REINFORCED CONCRETE FOR INFRASTRUCTURAL REPAIR AND RETROFIT: PART II

Sponsored by Committees 348 and 544

continued

- | | |
|---|--------------|
| Analytical Methods for Assessment of Retrofit/Repair Techniques of RC Subassemblage with HPFRC | 10:35 |
| Enrico Spacone, Assistant Professor, and Melissa M. Harter, Graduate Student, Department of Civil, Environmental, and Architectural Engineering, University of Colorado at Boulder, Boulder, CO; and Neven Krstulović-Opara, Assistant Professor, Department of Civil Engineering, North Carolina State University, Raleigh, NC | |
| Repair and Seismic Upgrade of Reinforced Concrete Columns using SIMCON | 10:55 |
| Gilbert C. Brunnhoeffler III, President, and Mark B. Farrell, Manager, New Products Division, Ribbon Technology Corp., Gahanna, OH; and Neil M. Hawkins, Professor and Head, and William L. Gamble, Professor, and Fatjon P. Shkurti, Graduate Student, Department of Civil Engineering, University of Illinois at Urbana-Champaign, Urbana, IL | |
| High-Performance Micro-Fiber Reinforced Concrete for Thin Repairs | 11:20 |
| Nemkumar P. Banthia, Associate Professor, and Cheng Yan, Research Associate, Department of Civil Engineering, University of British Columbia, Vancouver, British Columbia, Canada | |
| Properties and Applications of Fiber Reinforced Concretes in Infrastructural Repair and Retrofit | 11:40 |
| Maria M. Szerszen, Assistant Professor, and Krzysztof Dyduch, Professor, Department of Civil Engineering, Cracow University of Technology, Krakow, Poland | |

TECHNICAL SESSION

MONDAY, NOVEMBER 4
2:00 PM - 5:00 PM

ROOM: REGENCY C

EXTREME LOADS AND LOAD COMBINATIONS

Sponsored by Committees 343 and 348

Session Moderator: Andrzej S. Nowak
Professor
Department of Civil and
Environmental Engineering
University of Michigan
Ann Arbor, MI

- | | |
|---|-------------|
| Introduction
Andrzej S. Nowak, Professor, Department of Civil and
Environmental Engineering, University of Michigan,
Ann Arbor, MI | 2:00 |
| Designing for Extreme Events: The Need for a
Coupled Structure and Foundation Analysis Approach
Christopher Dumas, Geotechnical Engineer, Region Three,
Federal Highway Administration, Baltimore, MD | 2:05 |
| Quantitative Risk Assessment of Scour at Bridges
Allan McCracken, Consulting Geotechnical Engineer;
Hendrik A. D. Kirsten, Principal; and Anthony G. Dell,
Consulting Civil Engineer, Steffen Robertson and
Kirsten, Ltd., Cardiff, United Kingdom | 2:30 |
| Ship and Barge Collisions with Bridges
Michael A. Knott, Branch Manager, Moffatt and Nichol
Engineers, Richmond, VA | 2:55 |
| Concrete Structures Subjected to Automobile Impact
Himat T. Solanki, Structural Engineer, South West Florida
Water Management District, Sarasota, FL | 3:20 |
| Combination of Lateral and Gravity Loads for R/C
Bridge Piers
Dan M. Frangopol, Professor, Department of Civil
Engineering, University of Colorado, Boulder, CO | 3:45 |
| Proposed Load Combination Model for Extreme Events
Andrzej S. Nowak, Professor, Department of Civil and
Environmental Engineering, University of Michigan,
Ann Arbor, MI | 4:10 |

TECHNICAL SESSION

MONDAY, NOVEMBER 4
2:00 PM - 5:00 PM

ROOM: REGENCY E

STRENGTH EVALUATION FOLLOWING A DISASTER

Sponsored by Committee 437

Session Moderator: Brian J. Pashina
Principal Engineer
American Engineering Testing, Inc.
St. Paul, MN

Session Co-Moderator: Thomas L. Rewerts
Vice President/Chicago Regional Manager
Madsen, Kneppers & Associates, Inc.
Chicago, IL

- Introduction** 2:00
Brian J. Pashina, Principal Engineer, American Engineering Testing, Inc., St. Paul, MN
- Post-Disaster Evaluation of Structures:
When and for What Purpose?** 2:05
Florian G. Barth, Principal, Florian Barth & Associates, Inc., Redwood City, CA
- Strength Evaluation of Existing Concrete Structures Damaged by Hurricanes Andrew, Iniki, and Opal** 2:35
Thomas L. Rewerts, Vice President/Chicago Regional Manager, and Anne M. Scanlon, Consultant, Madsen, Kneppers & Associates, Inc., Chicago, IL
- It's Water Under the Bridge...and Possibly More** 3:05
Daniel G. Stromberg, Chief Structural Engineer, and Michael J. Garlich, Vice President, Collins Engineers, Inc., Chicago, IL
- Blast Damage: Oklahoma City and World Trade Center** 3:35
Stanley C. Woodson, Research Structural Engineer, Structures Laboratory, U. S. Army Waterways Experiment Station, Vicksburg, MS, and Richard L. Tillman, Structural Engineer, New Orleans District, U. S. Army Corps of Engineers, New Orleans, LA
- The Masonry Society's "Investigating Disasters" Program: An Example of a Unified Approach to Disaster Investigation** 4:05
Richard E. Klingner, Professor, Department of Civil Engineering, Phil M. Ferguson Structural Engineering Laboratory, The University of Texas at Austin, Austin, TX
- Case Studies of Fire-Damaged Concrete Structures: What Happens to the Reinforcing?** 4:35
Richard J. Kristie, Consultant, and Gary J. Klein, Senior Consultant, Wiss, Janney, Elstner Associates, Inc., Northbrook, IL

TECHNICAL SESSION

MONDAY, NOVEMBER 4
2:00 PM - 5:00 PM

ROOM: **REGENCY F**

RESEARCH ON TRANSPORTATION STRUCTURES

Sponsored by the ACI Louisiana Chapter

Session Moderator: Masood Rasoulian
Pavement/Systems Research
Engineer Manager
Louisiana Transportation Research Center
Louisiana Department of Transportation
and Development
Baton Rouge, LA

Introduction 2:00
Masood Rasoulian, Pavement/Systems Research Engineer
Manager, Louisiana Transportation Research Center,
Louisiana Department of Transportation and Development,
Baton Rouge, LA

I-10 Concrete Overlay 2:05
William M. King, Accelerated Loading Facility Manager,
Louisiana Transportation Research Center, Louisiana State
University, Baton Rouge, LA

**I-49 Construction Through Urban Areas of
Alexandria, LA** 2:30
Rhett A. Desselle, Project Engineer, Louisiana Department
of Transportation and Development, Alexandria, LA

I-20 Early Concrete Pavement Deterioration 3:00
Doug Hood, Geotechnical Engineer, Louisiana Department
of Transportation and Development, Baton Rouge, LA

Accelerated Loading Facility 3:30
John B. Metcalf, Freeport McMoRan Professor, Institute
of Recyclable Materials, Louisiana State University, Baton
Rouge, LA

Accelerated Curing of Concrete 4:00
J. Craig Duos, Concrete Research Engineer, Louisiana
Transportation Research Center, Louisiana Department
of Transportation and Development, Baton Rouge, LA

HOT TOPIC

MONDAY, NOVEMBER 4
2:00 PM - 5:00 PM

ROOM: REGENCY G

SEISMIC AND WIND MITIGATION FOR STRUCTURES

Sponsored by the ACI Louisiana Chapter, Convention Committee,
and Hot Topic Committee

Session Moderator: H. S. Lew
Chief, Structures Division
National Institute of
Standards and Technology
Gaithersburg, MD

Session Co-Moderator: Woodward L. Vogt
President
Paradigm Consultants
Houston, TX

Introduction 2:00
H. S. Lew, Chief, Structures Division, National Institute
of Standards and Technology, Gaithersburg, MD

**Recent Developments in Seismic Provisions
and Design Implications** 2:05
James R. Harris, President, J. R. Harris & Co., Denver, CO

**Recent Developments in Wind Load Provisions
and Design Implications** 2:40
Lawrence G. Griffis, Senior Vice President,
Walter P. Moore & Associates, Houston, TX

**PG & E Seismic Retrofit: Concrete Dual System
Used to Reinforce Historic Steel Frame Buildings** 3:15
Mark S. Jokerst, Principal, Forell/Elsesser Engineers, Inc.,
San Francisco, CA

**Wind Engineering of 88-Story Jin Mao Tower,
Shanghai, China** 3:50
Mark P. Sarkisian, Associate Partner; D. Stanton Korista,
Director of Structural and Civil Engineering; and
Ahmad K. Abdelrazaq, Associate, Skidmore, Owings &
Merrill LLP, Chicago, IL

**Transfer of Wind Forces to Existing Foundation
at Harrah's New Orleans Casino** 4:25
Subhash V. Kulkarni, President, Kulkarni Consultants,
Metairie, LA

TECHNICAL SESSION

TUESDAY, NOVEMBER 5
9:00 AM - NOON

ROOM: REGENCY C

SERVICEABILITY OF CABLE-STAYED BRIDGES

Sponsored by Committee 343

Session Moderator: Steven L. Stroh
Senior Bridge Engineer
Greiner, Inc.
Tampa, FL

Introduction	9:00
Steven L. Stroh, Senior Bridge Engineer, Greiner, Inc., Tampa, FL	
Serviceability Considerations for Hong Kong's Kap Shui Mun Bridge	9:05
Steven L. Stroh, Senior Bridge Engineer, Greiner, Inc., Tampa, FL	
Inspection and Maintenance Procedures for Cable-Stayed Bridges: A European Perspective	9:35
Reiner H. F. Saul, Managing Director, and Holger S. Svensson, Managing Director, Leonhardt, Andrä and Partner GmbH, Stuttgart, Germany	
Maintenance of the Talmadge Memorial Bridge	10:05
Man-Chung Tang, President, DRC Consultants, Inc., Flushing, NY	
Maintenance and Inspection of Cable-Stayed Bridges: An Owner's Perspective	10:35
Charles D. Oliver, Construction Project Manager, Florida Department of Transportation, St. Petersburg, FL	
A Cable-Stayed Bridge Designed for Inspection, Maintenance, and Durability	11:05
Ruchu Hsu, Supervising Structural Engineer, and Vijay Chandra, Vice President and Chief Bridge Engineer, Parsons Brinkerhoff, Inc., New York, NY	
Improved Corrosion Protection for Bridge Stay Cables	11:35
H. R. Hamilton III, Assistant Professor, Department of Civil and Architectural Engineering, University of Wyoming, Laramie, WY; and Jack E. Breen, Professor, and Karl H. Frank, Professor, Ferguson Structural Engineering Laboratory, The University of Texas at Austin, Austin, TX	

TECHNICAL SESSION

TUESDAY, NOVEMBER 5
9:00 AM - NOON

ROOM: REGENCY E

CONCRETE REPAIR WITH FRP COMPOSITES

Sponsored by Committee 440

Session Moderator: Russell L. McCullough
Vice President, Engineering
SCI Services Group, Inc.
Carrollton, GA

- | | |
|---|-------|
| Introduction | 9:00 |
| Russell L. McCullough, Vice President, Engineering, SCI Services Group, Inc., Carrollton, GA | |
| Precracked RC Beams Reinforced with FRP Sheets | 9:05 |
| Antonio Nanni, Professor, Department of Architectural Engineering, The Pennsylvania State University, University Park, PA; and Angelo D. Tommaso, Professor, and Marco Arduini, Technical Officer, Department of Civil Engineering, University of Bologna, Bologna, Italy | |
| Freeze-Thaw Durability of Concrete Beams Strengthened by Carbon Fiber Sheets | 9:40 |
| Khaled A. Soudki, Adjunct Assistant Professor, and Mark F. Green, Assistant Professor, Department of Civil Engineering, Queens University, Kingston, Ontario, Canada | |
| Strengthening of Concrete Connections with Carbon FRP | 10:15 |
| Brendon E. Dolan, Student; H. R. (Trey) Hamilton III, Assistant Professor; and Charles W. Dolan, Professor, Department of Civil and Architectural Engineering, University of Wyoming, Laramie, WY | |
| Tensile Testing and Durability Characteristics of Cementitious Composites Externally Wrapped with FRP Sheets | 10:50 |
| Houssam A. Toutanji, Associate Professor, Department of Civil Engineering, University of Puerto Rico, Mayaguez, PR; and Tahar El Korchi, Professor, and Shuji Tsubota, Doctoral Candidate, Department of Civil Engineering, Worcester Polytechnic Institute, Worcester, MA | |
| Development of a Repair Technique Using Confinement of Corrosion Damaged Concrete with Advanced Composite Materials | 11:25 |
| Nataliya Hearn, Assistant Professor; Michael D. Thomas, Assistant Professor; Shamim A. Sheikh, Professor; Stavroula J. Pantazopoulou, Associate Professor; and John F. Bonacci, Associate Professor, Department of Civil Engineering, University of Toronto, Toronto, Ontario, Canada | |

TECHNICAL SESSION

TUESDAY, NOVEMBER 5
9:00 AM - NOON

ROOM: REGENCY F

INFLUENCE OF BINDER MAKEUP ON DURABILITY: PART I

Sponsored by Committee 201

- Session Moderator:** Kenneth C. Hover
Professor and Associate Dean
Department of Civil Engineering
Cornell University
Ithaca, NY
- Introduction** 9:00
Donald J. Janssen, Associate Professor, Department of Civil Engineering, University of Washington, Seattle, WA
- Cementing Efficiency Factors for Fly Ash: Have They Any Value?** 9:05
Michael D. A. Thomas, Assistant Professor, Department of Civil Engineering, University of Toronto, Toronto, Ontario, Canada
- Evaluation of Supplementary Cementitious Materials** 9:30
Kenneth C. Hover, Professor and Associate Dean, Department of Civil Engineering, Cornell University Ithaca, NY; Clifford Gordon, Concrete QA Consultant, Hazan and Sawyer, PC, New York, NY; Paul J. St. John, Materials Engineer, New York State Department of Transportation, Albany, NY; and Paul Zoltanetzky, Jr., Deputy Director, New York City Bureau of Environmental Protection, Corona, NY
- Influence of Binder Composition on Chloride Penetration Resistance of Concrete** 9:55
Patrick F. McGrath, Construction Materials Consultant, James Neill and Associates Ltd., Vancouver, British Columbia, Canada, and R. Doug Hooton, Professor, Department of Civil Engineering, University of Toronto, Toronto, Ontario, Canada
- Influence of Ca/Si and W/(C+P) on Coulomb Values of Concrete Containing Fly Ash** 10:20
Richard R. Halverson, Manager, Western Washington Division, Pozzolanic Northwest, Mercer Island, WA

continued

TECHNICAL SESSION

TUESDAY, NOVEMBER 5
9:00 AM - NOON

ROOM: REGENCY F

INFLUENCE OF BINDER MAKEUP ON DURABILITY: PART I

Sponsored by Committee 201

continued

Selecting Cementitious Systems to Prevent ASR Expansion in Concrete **10:45**

Michael D. A. Thomas, Assistant Professor, and
R. Doug Hooton, Professor, Department of Civil Engineering,
University of Toronto, Toronto, Ontario, Canada

The Role of Binder in Sulfate Attack **11:10**

Paul J. Tikalsky, Associate Professor, Civil and
Environmental Engineering, The Pennsylvania State
University, University Park, PA

Closing Comments **11:35**

Kenneth C. Hover, Professor and Associate Dean,
Department of Civil Engineering, Cornell University,
Ithaca, NY

CONTRACTORS' DAY

TUESDAY, NOVEMBER 5
9:00 AM- NOON

ROOM: REGENCY G

HOW CAN CONTRACTORS USE TESTING TO IMPROVE QUALITY OF CONSTRUCTION?

Sponsored by the Construction Liaison Committee and
the ACI Louisiana Chapter

Session Moderator: Calvin J. Zenor
Marketing Manager
Delta Testing and Inspection, Inc.
New Orleans, LA

Session Co-Moderator: Frank B. Stritzinger
Project Manager
T. L. James Construction
Covington, LA

Introduction	9:00
Calvin J. Zenor, Marketing Manager, Delta Testing and Inspection, Inc., New Orleans, LA	
The Time to Address Material Quality Issues Is Now, Not After the Fact	9:05
Michael P. McGowan, Vice President, Delta Testing and Inspection, Inc., Baton Rouge, LA	
Using the Testing Lab to Help Investigate New Money-Saving Systems in Concrete	9:30
John J. Uhl, Vice President, Carlo Ditta, Inc., Harvey, LA	
What The Corps Requires of the Contractor in Providing Quality Assurance	10:00
Bruce A. Terrell, Chief of Quality Assurance, U. S. Army Corp of Engineers, New Orleans, LA	
Achieving a Consistently Superior Quality Slab for Your Clients Using "Floor Flatness" and "Floor Level" Technology during Construction	10:30
Harry G. LeBlanc, President, Cajun Concrete Services, Inc., Jefferson, LA	
Quality Control as a Profit Center	11:00
James M. Shilstone, Jr., President, The Shilstone Companies, Inc., Dallas, TX	
Questions and Answers	11:30

CONTRACTORS' DAY

CONTRACTORS' DAY LUNCHEON

ROOM REGENCY B

Time: **NOON - 2:00 PM**

Topic: "Transportation Overview:
Present and Future"

Speaker: **Frank M. Denton**, Secretary,
Louisiana Department of
Transportation, Department of
Transportation and Development,
Baton Rouge, LA



Menu

Black Bean & Andouille Soup
Bronzed Chicken Breast
Fresh Vegetables
Fresh Rolls & Butter
Pecan Pie
Coffee and Tea
\$21 per person

CONTRACTORS' DAY

TUESDAY, NOVEMBER 5
2:00 PM - 5:00 PM

ROOM: REGENCY G

Sponsored by the Construction Liaison Committee, the ACI Louisiana Chapter, and Committee E702

SESSION I: DESIGN BUILD CONTRACTS -- PROS AND CONS

Session Moderator: Adam Mehn, Jr.
Chief Field Engineer
Burk-Kleinpeter, Inc.
New Orleans, LA

Introduction	2:00
Debrethann R. Cagley Orsak, Manager, Business Development, Cagley & Associates, Inc., Rockville, MD	
Future of Design Build Construction: Contractor's View	2:05
Dipak T. Parekh, Quality Assurance/Quality Control Manager, Silverado Constructors, Irwin, CA	
Engineer's View of Design Build Construction	2:30
Richard Apple, Vice President, Cagley & Associates, Inc., Rockville, MD	
Advantages of Design Build Construction for Owners	2:55
Mark K. Erdly, Project Manager, U. S. Navy, EFA Chesapeake, Washington, DC	

SESSION II: CONSTRUCTION EDUCATION -- WHAT CAN IT DO FOR YOU?

Session Moderator: Adam Mehn, Jr.
Chief Field Engineer
Burk-Kleinpeter, Inc.
New Orleans, LA

What is Construction Education?	3:30
Luke M. Snell, Professor and Chair of Construction, Southern Illinois University, Edwardsville, IL	
A New Graduate's First Year	3:55
John W. Hooker, Project Superintendent, Korte Construction Co., Highland, IL	
Reflections of a Past Graduate	4:20
Thomas D. Verti, Vice President, Charles Pankow Builders, Ltd., Altadena, CA	
Status of Construction Education in Southeast U. S. A.	4:45
Adam Mehn, Jr., Chief Field Engineer, Burk-Kleinpeter, Inc., New Orleans, LA	

EDUCATIONAL SESSION

TUESDAY, NOVEMBER 5
2:00 PM - 5:00 PM

ROOM: REGENCY C

DEVELOPING DESIGN CRITERIA FOR ESSENTIAL FACILITIES

Sponsored by Committee E702

Session Moderator: David G. Kittridge
Principal Engineer
Boyle Engineering Corp.
Orlando, FL

Introduction David G. Kittridge, Principal Engineer, Boyle Engineering Corp., Orlando, FL	2:00
What Do You Mean There's a 64 Percent Chance My Building Will Fail? David G. Kittridge, Principal Engineer, Boyle Engineering Corp., Orlando, FL	2:10
Setting Wind Criteria Kishor C. Mehta, Professor, Department of Civil Engineering, and Director, Wind Engineering Research Center, Texas Technical University, Lubbock, TX	3:00
Setting Seismic Criteria S. K. Ghosh, Director, Portland Cement Association, Skokie, IL	3:45
Questions and Answers	4:30

TECHNICAL SESSION

TUESDAY, NOVEMBER 5
2:00 PM - 5:00 PM

ROOM: REGENCY E

OPEN PAPER SESSION

Sponsored by TAC

Session Moderator: Khaled S. Soubra
Bridge Design Engineer
T. Y. Lin International
Alexandria, VA

- Introduction** 2:00
Khaled S. Soubra, Bridge Design Engineer, T. Y. Lin International, Alexandria, VA
- Ductility of FRP Reinforced Concrete Beams: A Parametric Study** 2:05
P. N. Balaguru, Professor, and Ghassan Habib, Graduate Student, Department of Civil and Environmental Engineering, Rutgers, The State University of New Jersey, Piscataway, NJ
- Rational Development of Release Strength Criteria for Prestressed Concrete Members** 2:25
Sami W. Tabsh, Professor, Department of Civil and Environmental Engineering, University of Houston, Houston, TX; Alex Aswad, Professor, Department of Civil Engineering Technology, Penn State Harrisburg, Middleton, PA; and R. Jerome Frost, Structural Engineer, Sheladin and Associates, Camphill, PA
- High-Performance Concrete for Pavement Patching** 2:45
John J. Schemmel, Associate Professor, Department of Civil Engineering, University of Arkansas, Fayetteville, AK
- Improved Efficiency and Aesthetics for Short and Moderate Span Bridges** 3:05
Sarah L. Billington, Graduate Research Assistant, and John E. Breen, Professor, Department of Civil Engineering - Structures, Phil M. Ferguson Structural Engineering Laboratory; and D. Andrew Vernooy, Professor, School of Architecture, The University of Texas at Austin, Austin, TX
- Improved Shear Ductility of Pretensioned Concrete Beams by Inclusion of Horizontal Mild Reinforcement** 3:25
Bruce W. Russell, Assistant Professor, and James H. Allen III, Graduate Research Assistant, School of Civil Engineering and Environmental Science, University of Oklahoma, Norman, OK

continued

TECHNICAL SESSION

TUESDAY, NOVEMBER 5
2:00 PM - 5:00 PM

ROOM: REGENCY E

OPEN PAPER SESSION

Sponsored by TAC

continued

- | | |
|--|-------------|
| A New Design Approach for Slabs-on-Ground | 3:45 |
| Wayne W. Walker, Senior Structural Engineer, Lockwood Greene Engineers, Norcross, GA, and Jerry A. Holland, Structural Engineering Consultant, Lockwood Greene Engineers, Atlanta, GA | |
| 150 MPa Concrete with Large Ductility | 4:05 |
| Bendt K. Aarup, Manager of CRC Marketing, Aalborg Portland A/S, Aalborg, Denmark | |
| Physical Models for Concrete Structures: Their Role in the New Engineering Curriculum | 4:25 |
| Harry G. Harris, Professor, Department of Civil and Architectural Engineering, Drexel University, Philadelphia, PA, and Gajanan M. Sabnis, Professor, Department of Civil Engineering, Howard University, Washington, DC | |
| Prediction of the Adiabatic Temperature Rise of High-Strength Concrete Using Low Heat Portland Cement | 4:45 |
| Tatsumi Ohta, Research Engineer; Nobuyuki Yamazaki, Chief Research Engineer; and Akira Nishida, Research Engineer, Institute of Technology, Shimizu Corp., Tokyo, Japan | |

TECHNICAL SESSION

TUESDAY, NOVEMBER 5
2:00 PM - 5:00 PM

ROOM: REGENCY F

INFLUENCE OF BINDER MAKEUP ON DURABILITY: PART II

Sponsored by Committee 201

Session Moderator: R. Doug Hooton
Professor
Department of Civil
Engineering
University of Toronto
Toronto, Ontario, Canada

- | | |
|---|-------------|
| Introduction | 2:00 |
| Donald J. Janssen, Associate Professor, Department of Civil Engineering, University of Washington, Seattle, WA | |
| Paste Content, Air Content, and ACI Recommendations | 2:05 |
| Kenneth C. Hover, Professor and Associate Dean, Department of Civil Engineering, Cornell University, Ithaca, NY | |
| Aging Effects on the Freeze-Thaw and Deicing Salt Resistance of Concrete with Different Types of Cement | 2:30 |
| Rainer Auberg, Assistant Research Engineer, and Max J. Setzer, Professor, Department of Civil Engineering, Institute of Building Physics and Materials Science, University of Essen, Essen, Germany | |
| Freezing and Thawing Durability of Low Water to Cement Ratio Concretes | 2:55 |
| Richard E. Weyers, Professor, Department of Civil Engineering, Virginia Polytechnic, Institute and State University, Blacksburg, VA, and Mohsen G. Kashi, Visiting Professor, Department of Civil Engineering, Tufts University, Boston, MA | |
| Freeze-Thaw and Freeze-Deicing Salt Resistance of Concretes Containing Cement Rich in Granulated Blast Furnace Slag | 3:20 |
| Jochen Stark, Professor, and Horst-Michael Ludwig, Professor, Department of Civil Engineering, F. A. Finger Institute of Building Materials Science, Bauhaus University, Weimar, Germany | |

continued

TECHNICAL SESSION

TUESDAY, NOVEMBER 5
2:00 PM - 5:00 PM

ROOM: REGENCY F

INFLUENCE OF BINDER MAKEUP ON DURABILITY: PART II

Sponsored by Committee 201

continued

- | | |
|--|-------------|
| Influence of Supplementary Cementitious Materials on the Amount of Freezable Moisture in Concrete | 3:45 |
| Donald J. Janssen, Associate Professor, Department of Civil Engineering, University of Washington, Seattle, WA; Mark B. Snyder, Associate Professor, Department of Civil and Mineral Engineering, Minneapolis, MN; and Mark A. Buening, Project Engineer, Sellen Construction, Seattle, WA | |
| Deicer Scaling Resistance of GGBFS Concretes | 4:10 |
| Mark D. Luther, Manager of Technical Services-GranCem [Cement], HOLNAM, Inc., Weirton, WV | |
| Closing Remarks | 4:30 |
| R. Doug Hooton, Professor, Department of Civil Engineering, University of Toronto, Toronto, Ontario, Canada | |

TECHNICAL SESSION

TUESDAY, NOVEMBER 5
2:00 PM - 5:00 PM

ROOM: REGENCY H

ROLE OF BRIDGE EVALUATION IN DISASTER MITIGATION

Sponsored by Committee 342

Session Moderator: Harold R. Sandberg
Chairman of the Board
Alfred Benesch & Co.
Chicago, IL

Introduction	2:00
Harold R. Sandberg, Chairman of the Board, Alfred Benesch & Co., Chicago, IL	
Underwater Evaluation of Bridge Substructures	2:05
Richard Avent, Chairman, and Mohamed A. Alawady, Associate Professor, Department of Civil and Environmental Engineering, Louisiana State University, Baton Rouge, LA	
Effects of Formwork Fires during Bridge Construction	2:30
Fernando A. Branco, Professor; I. Cabrita Neves, Associate Professor; and Joaquim C. Valente, Assistant Professor, Department of Civil Engineering, IST Technical University of Lisbon, Lisbon, Portugal	
Preparation for Post-Disaster Response	3:00
Donald F. Sorgenfrei, Senior Vice President, Modjeski and Masters, Inc., New Orleans, LA	
Philosophy of Bridge Evaluation After a Catastrophic Event	3:30
Richard A. Lawrie, Senior Associate, T. Y. Lin International, Alexandria, VA, and W. Fred Dotson, Assistant Structural Bridge Engineer, Virginia Department of Transportation, Richmond, VA	
Post-Earthquake Evaluation of Bridges on California Highways	4:00
James E. Roberts, Director, Engineering Services, and Chief Structures Engineer, California Department of Transportation, Sacramento, CA	
General Discussion: "Planning for Post-Disaster Bridge Evaluation"	4:30

FORUM

TUESDAY, NOVEMBER 5
7:30 PM - 10:00 PM

ROOM: REGENCY C

CHLORIDE LIMITS FOR CONCRETE: WHO SETS THEM AND WHO CARES?

Sponsored by Committee 123

Session Moderator: Glenn W. DePuy
Consultant
Denver, CO

Session Co-Moderator: Robert L. Henry
National Secretary/Treasurer
Chi Epsilon
University of Texas at Arlington
Arlington, TX

Introduction **7:30**
Glenn W. DePuy, Consultant, Denver, CO, and
Robert L. Henry, National Secretary/Treasurer, Chi
Epsilon, University of Texas at Arlington, Arlington, TX

Educator's Viewpoint **7:40**
Brian B. Hope, Professor, Department of Civil Engineering,
Queen's University, Kingston, Ontario, Canada

Researcher's Viewpoint **7:50**
William F. Perenchio, Senior Consultant, Wiss, Janney,
Elstner Associates, Inc., Northbrook, IL

Investigator's Viewpoint **8:00**
Bernard E. Erlin, President, The Erlin Co., Latrobe, PA

Transportationist's Viewpoint **8:10**
Donald R. Jackson, Senior Project Manager, Office of
Technology Applications, Federal Highway Administration,
Washington, DC

Material Manufacturer's Viewpoint **8:20**
Kenneth B. Rear, Manager, Technical Services - North
America, W. R. Grace & Co., Cambridge, MA

Questions and General Discussion **8:30**

MOONLIGHT ON THE MISSISSIPPI DINNER CRUISE

7:00 PM - 10:00 PM

\$37.00/Cash Bar

A trip to New Orleans would not be complete without a toe-tapping night- time jazz adventure on the Mississippi River. Step on board the Cajun Queen paddlewheeler and cruise with us into the night, against a sparkling skyline where sleepless activity of America's busiest ports buzzes. Enjoy a Creole buffet and the excitement of a live Jazz Trio. After dinner, enjoy your cocktails and dance as the jazz is hot and river breeze is cool.



Menu

Seafood Gumbo with Steamed Rice, Tossed Green Salad w/Variety of Dressings, Louisiana Chicken & Andouille Sausage Jambalaya, New Orleans Style Red Beans & Rice, Prime Rib au Jus with Horseradish Creme, Cajun Green Beans , Apple Bread Pudding with Praline Chantilly Creme, French Bread and Butter, New Orleans Dark Roast Coffee, Iced Tea with Lemon Wheels

RAP SESSION/ CONTINENTAL BREAKFAST

**WEDNESDAY, NOVEMBER 7
8:30 AM - 9:30 AM**

ROOM: REGENCY D

RAP SESSION AND CONTINENTAL BREAKFAST

A complimentary continental breakfast will be served from 8:30 AM - 9:00 AM, with the Rap Session beginning at 9:00 AM. Complete the question card in your convention packet or present your question personally at the session.

WHAT DO YOU KNOW ABOUT ACI?

Jim Pierce
President
and
George F. Leyh
Executive Vice President

Invite YOU to ask them!

GENERAL SESSION

WEDNESDAY, NOVEMBER 6
10:00 AM - NOON

ROOM: REGENCY D

Session Moderator: Om P. Dixit
Vice President
Burk-Kleinpeter, Inc.
New Orleans, LA

Welcome to New Orleans
Om P. Dixit, Vice President, Burk-Kleinpeter, Inc.,
New Orleans, LA

Phil M. Ferguson Lecture
**"Self-Compacting High-
Performance Concrete"**
Hajime Okamura, Professor,
Department of Civil Engineering,
University of Tokyo, Tokyo, Japan

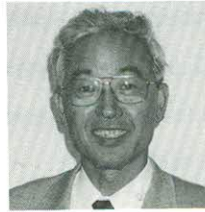

Certificates of Appreciation

Introduction of Officers of International Associations

Introduction of International Visitors

Recognition of Chapter Officers Present

Recognition of Past Presidents Present

Keynote Address:
**"Olympics, Baseball, or Business --
There Must be Teamwork to Succeed"**
Skip Bertman
Baseball Head Coach
Louisiana State University
Baton Rouge, LA
• 1996 National College Baseball Champions
• 1996 Head Coach of the U. S. Olympic Baseball Team

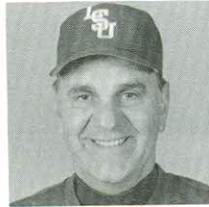

Closing Remarks

STANDARDS PRESENTATION

WEDNESDAY, NOVEMBER 6

ROOM: REGENCY D

To begin 5 minutes after the General Session.

Session Moderator: Jim Pierce
Leadership Team
Technical Service Center
U. S. Bureau of Reclamation
Denver, CO

**Proposed New Standard Specification for
"Cast-In-Place Architectural Concrete (ACI 303.1-XX)"**

Presented by Robert W. Nussmeier, Chairman, Committee 303

*Note: The General Session is anticipated
to conclude between 11:30 and NOON.

EDUCATIONAL SESSION

WEDNESDAY, NOVEMBER 6
2:00 PM - 5:00 PM

ROOM: CABILDO C

METHODS OF TEACHING THE DESIGN OF CONCRETE STRUCTURES

Sponsored by Committees E702 & E802

Session Moderator: Julian Snyder
Director of Civil Engineering
Duchscherer Oberst Design
Buffalo, NY

- | | |
|---|-------------|
| Introduction
Julian Snyder, Director of Civil Engineering, Duchscherer Oberst Design, Buffalo, NY | 2:00 |
| A New Approach to Teaching Structural Analysis and Design
Kenneth H. Murray, Professor and Chair, Department of Civil Engineering, and W. Mark McGinley, Associate Professor, Department of Architectural Engineering, North Carolina A&T State University, Greensboro, NC | 2:05 |
| Implementation of a Structured Design Project in a First Course in Structural Concrete Design
Andrew Scanlon, Professor, Department of Civil Engineering, The Pennsylvania State University, University Park, PA, and Mary E. Kendall, Director of Institutional Research, St. Mary's College, Notre Dame, IN | 2:35 |
| Teaching Reinforced Concrete Design: An Architectural Engineering Approach
Thomas E. Boothby, Assistant Professor, Department of Architectural Engineering, The Pennsylvania State University, University Park, PA | 3:05 |
| Reinforced Concrete Teaching is an Aggregate Endeavor
Richard W. Furlong, Professor, Department of Civil Engineering, The University of Texas at Austin, Austin, TX | 3:35 |
| Training for Duty
Robert B. Austin, Director of Technical Services, National Precast Concrete Association, Indianapolis, IN | 4:05 |
| Computer Aided Concrete Teaching: A New Medium for Teaching the Design of Prestressed Concrete
John B. Newman, Head of Structures Section and Director CRIC, Technology and Medicine, Department of Civil Engineering, Imperial College, London, England, UK | 4:35 |

TECHNICAL SESSION

WEDNESDAY, NOVEMBER 6
2:00 PM - 5:00 PM

ROOM: REGENCY C

TECHNOLOGY TRANSFER: IDENTIFICATION OF CUTTING EDGE TECHNOLOGY

Sponsored by the TAC Technology Transfer Committee

Session Moderator: Tony C. Liu
Directorate of Research and Development
U. S. Army Corps of Engineers
Washington, DC

- Introduction** 2:00
Tony C. Liu, Directorate of Research and Development,
U. S. Army Corps of Engineers, Washington, DC
- Anchor Requirements for Headed Reinforcement** 2:05
James O. Jirsa, Professor, Department of Civil Engineering,
and Tarek Bashandy, Graduate Research Assistant, Ferguson
Structural Engineering Laboratory, The University of Texas
at Austin, Austin, TX; and Richard N. DeVries, Assistant
Professor, Department of Civil Engineering, Oklahoma State
University, Stillwater, OK
- Use of Advanced Composites for Bridge
Infrastructure Renewal** 2:35
Frieder Seible, Professor, Division of Structural Engineering,
The University of California at San Diego, La Jolla, CA
- Use of High Strength Welded Reinforcement Grids
for Confining Concrete** 3:05
Hanns U. Baumann, President, Baumann Research and
Development Corp., Newport Beach, CA, and
Murat Saatcioglu, Professor, Department of Civil
Engineering, University of Ottawa, Ottawa, Ontario, Canada
- Durability Assessment of High-Performance Concrete** 3:35
R. Doug Hooton, Professor, Department of Civil Engineering,
University of Toronto, Toronto, Ontario, Canada
- Extrusion Technology: From Laboratory to Market** 4:05
Yixin Shao, Assistant Professor, Department of Civil
Engineering and Applied Mechanics, McGill University,
Montréal, Québec, Canada; and Herman J. Yost, Industrial
Program Director, and Surendra P. Shah, Professor and
Director, NSF Center of Advanced Cement Based Materials,
Northwestern University, Evanston, IL
- Development of Precast Pipe Products Using
Reactive Powder Concrete** 4:35
William M. Dowd, Executive Vice President, HDR Engineering,
Inc., Omaha, NE, and Edward F. O'Neil, Supervisory Civil
Engineer, U. S. Army Engineer Waterways Experiment
Station, Vicksburg, MS

TECHNICAL SESSION

WEDNESDAY, NOVEMBER 6
2:00 PM - 5:00 PM

ROOM: REGENCY F

LESSONS LEARNED FROM THE PAST

Sponsored by Committee 120

- Session Moderator:** *Laurel Dovich*
Assistant Professor
School of Engineering
Walla Walla College
College Place, WA
- Introduction** 2:00
Laurel Dovich, Assistant Professor, School of Engineering,
Walla Walla College, College Place, WA
- The First Use of Specified Strength Concrete in North America** 2:05
R. Doug Hooton, Professor, Department of Civil Engineering,
University of Toronto, Toronto, Ontario, Canada; and
P. K. Mukherjee, Principal Engineer, and H. Gil Caratin,
Senior Engineer, Ontario Hydro Technologies, Etobicoke,
Ontario, Canada
- The Erie Canal -- Creator of America's Concrete and Engineers** 2:34
Billie G. Snell, Educational Consultant, Snell's Educational
Enterprises, Edwardsville, IL, and Luke M. Snell, Professor
and Chair of Construction, Southern Illinois University at
Edwardsville, Edwardsville, IL
- Evaluation of Historic Concrete Structures** 3:03
Jerome P. O'Connor, Principal Engineer, Law Engineering
and Environmental Services, Inc., Itasca, IL; James M. Cutts,
President, Cutts and Associates, Washington, DC;
Gregory R. Yates, Associate Vice President, Frederick Harris,
Inc., Philadelphia, PA; and Carlton A. Olson, Senior Engineer,
Construction Technology Laboratories, Inc., Skokie, IL
- Turning Concrete to Gold** 3:32
Raymond C. Heun, Executive Director, New York Concrete
Construction Institute, Inc., New York, NY
- Architectural Cast-In-Place Concrete: Thirty Years of Transition** 4:01
James M. Shilstone, Sr., Chairman, The Shilstone
Companies, Inc., Dallas, TX
- A Lesson from Ancient Roman Concrete: Durability Based on Artificial Pozzolanic Mortar** 4:30
Joseph Davidovits, President, Cordi-Geopolymere SA,
Saint-Quentin, France, and Frédéric Davidovits, Researcher,
Center for Research and Study of Antiquities, University of
Caen, Caen, France

TECHNICAL SESSION

WEDNESDAY, NOVEMBER 6
2:00 PM - 5:00 PM

ROOM: REGENCY G

POLYMER CONCRETE OVERLAYS ON INDUSTRIAL FLOORS

Sponsored by Committee 548

Session Moderator: Floyd E. Dimmick, Sr.
Technical Director
Armitage Industries, Inc.
Thermal-Chem Division
Elk Grove Village, IL

Introduction to Polymer Concrete Floor Overlays 2:00
Floyd E. Dimmick, Sr., Technical Director, Armitage
Industries, Inc., Thermal-Chem Division, Elk Grove Village, IL

**Investigation of Waterspot and Blush Resistance
of Epoxy Industrial Floors** 2:30
Peter A. Lucas, Lead Application Chemist, and
Paula A. Clark, Principal Research Chemist, Air
Products and Chemicals, Inc., Allentown, PA

**Development and Performance of Antimicrobial
Reactive Acrylic Polymer Concrete Flooring Systems
Using a Polymeric Active Antimicrobial Agent** 3:00
Wilfried H. Riesterer, President, Silikal Resin Systems,
Waterbury, CT

Effect of Metallic Monomers in PC Floor Overlays 3:30
David W. Fowler, Professor, Department of Civil
Engineering, The University of Texas at Austin, Austin, TX

Decorative Thermoset Flooring 4:00
Robert R. Cain, President, KRC Associates, Inc., Milford, OH

General Discussion 4:30

TECHNICAL SESSION

WEDNESDAY, NOVEMBER 6
2:00 PM - 5:00 PM

ROOM: REGENCY H

ACI 301-96 STANDARD SPECIFICATION FOR STRUCTURAL CONCRETE: NOT JUST FOR BUILDINGS ANYMORE

Sponsored by Committee 301

Session Moderator:	Aimee Pergalsky National Specifications Consultant Engineering Services Group Master Builders, Inc. Cleveland, OH	
Introduction	Aimee Pergalsky, National Specifications Consultant, Engineering Services Group, Master Builders, Inc., Cleveland, OH	2:00
The Development of ACI 301-96, Format and Organization	Timothy L. Moore, Senior Civil/Structural Engineer, San Diego Gas & Electric, San Diego, CA	2:05
Section 1 - General Requirements	Domingo J. Carreira, President, D. J. Carreira & Associates, Chicago, IL	2:25
Section 2 - Formwork and Form Accessories	Oleh B. Ciuk, Project Engineering Manager, Raytheon Engineers & Constructors, Inc., Philadelphia, PA	2:40
Section 3 - Reinforcement and Reinforcement Support	David P. Gustafson, Vice President of Engineering, Concrete Reinforcing Steel Institute, Schaumburg, IL	2:55
Section 4 - Concrete Mixtures	Gilbert Haddad, Chief Specialist, Concrete and Materials, SNC♦Lavalin Environment Inc., St. Laurent, Québec, Canada	3:10
Section 5 - Handling, Placing and Constructing	Timothy L. Moore, Senior Civil/Structural Engineer, San Diego Gas & Electric, San Diego, CA	3:25
Section 6 - Architectural Concrete	Oswin Keifer, Jr., Materials Engineer, U.S. Army Corps of Engineers, North Pacific Division, Portland, OR	3:40

continued

TECHNICAL SESSION

WEDNESDAY, NOVEMBER 6
2:00 PM - 5:00 PM

ROOM: REGENCY H

ACI 301-96 STANDARD SPECIFICATION FOR STRUCTURAL CONCRETE: NOT JUST FOR BUILDINGS ANYMORE

Sponsored by Committee 301

continued

- | | |
|--|-------------|
| Section 7 - Lightweight Concrete
Roy H. Keck, Director of Marketing, Blue Circle Williams,
Marietta, GA | 3:55 |
| Section 8 - Mass Concrete
James A. Lee, Senior Engineer, Duke Engineering & Services,
Inc., Charlotte, NC | 4:10 |
| Section 9 - Prestressed Concrete
Steven R. Close, Principal, Jorgensen, Hendrickson and
Close Engineering, Inc., Denver, CO | 4:25 |

TECHNICAL SESSION

THURSDAY, NOVEMBER 7
9:00 AM - NOON

ROOM: REGENCY A

BEHAVIOR AND DESIGN ISSUES IN EARTHQUAKE RESPONSE OF CONCRETE BRIDGES

Sponsored by Committee 341

Session Moderator: Andrew W. Taylor
Research Structural Engineer
Building and Fire Research Laboratory
National Institute of
Standards and Technology
Gaithersburg, MD

Co-Moderator: Nancy E. Bobb
Division Bridge Engineer
Federal Highway Administration
Sacramento, CA

- Introduction** 9:00
Andrew W. Taylor, Research Structural Engineer, Building
and Fire Research Laboratory, National Institute of
Standards and Technology, Gaithersburg, MD
- A Summary Report on the State of the Art
of Seismic Analysis and Design of Concrete
Bridge Systems** 9:05
Steven L. Stroh, Senior Structural Engineer,
Greiner, Inc., Tampa, FL
- Federal Highway Administration's Seismic
Design of Bridges** 9:35
Robert F. Mast, Senior Principal, and M. Lee Marsh,
Project Engineer, BERGER/ ABAM Engineers, Inc.,
Federal Way, WA; and James W. Keeley, Bridge Design
Engineer, Federal Highway Administration, Central
Federal Lands Highway Division, Denver, CO
- Seismic Shear Capacity of Reinforced
Concrete Bridge Columns** 10:00
Julio A. Ramirez, Professor, and Mete A. Sozen, Kettelhut
Distinguished Professor of Structural Engineering,
School of Civil Engineering, Purdue University, West
Lafayette, IN; and Colleen M. Konwinski, Structural
Engineer, Teng and Associates, Chicago, IL

continued

TECHNICAL SESSION

THURSDAY, NOVEMBER 7
9:00 AM - NOON

ROOM: REGENCY A

BEHAVIOR AND DESIGN ISSUES IN EARTHQUAKE RESPONSE OF CONCRETE BRIDGES

Sponsored by Committee 341

continued

**Seismic Retrofitting of Reinforced Concrete
Columns Using Carbon Tow Sheet** **10:30**

John F. Stanton, Professor; Gregory A. MacRae,
Assistant Professor; and Kirk J. Nosh, Graduate
Research Assistant, Department of Civil Engineering,
University of Washington, Seattle, WA

**Seismic Retrofitting of Bridge Column -
Pier Cap Connections** **11:00**

David H. Sanders, Associate Professor, and
M. "Saiid" Saiidi, Professor, Department of Civil
Engineering, University of Nevada at Reno, Reno, NV; and
Troy L. Martin, Associate Engineer, Bridge Division,
Nevada Department of Transportation, Carson City, NV

**Colton Interchange Fault Rupture Study
and Seismic Retrofit** **11:30**

John M. Tehaney, Senior Engineer; John C. Scales,
Supervising Engineer; and Thomas K. Cooper,
Supervising Engineer, Parsons Brinckerhoff Quade and
Douglas, Inc., Sacramento, CA; and Alex Krimotat,
Vice President, and Robyn M. Mutobe, Engineer,
SC Solutions, Inc., Mountain View, CA

TECHNICAL SESSION

THURSDAY, NOVEMBER 7
9:00 AM - NOON

ROOM: REGENCY B

DESIGN OF TWO-WAY SLAB SYSTEMS USING ELASTIC FRAME ANALOGIES

Sponsored by Committee 421

Session Moderator: Hershell Gill
President
Hershell Gill Consulting Engineers, Inc.
Coral Gables, FL

Concept and Background of Elastic Frame Analogies for Two-Way Slab Design 9:00

Sidney H. Simmonds, Professor Emeritus, Department of Civil Engineering, University of Alberta, Edmonton, Alberta, Canada

Analysis Formulation for Plane Frame Programs 9:30

William L. Gamble, Professor, Department of Civil Engineering, University of Illinois at Urbana - Champaign, Urbana, IL

Flexural Design and Selection of Reinforcement 10:00

S. K. Ghosh, Director of Engineering Services, Codes, and Standards, Portland Cement Association, Skokie, IL

Deflection Considerations in Slab Design 10:30

Andrew Scanlon, Professor, Department of Civil Engineering, The Pennsylvania State University, University Park, PA

Post-Tensioned Slabs 11:00

Ned H. Burns, Zarrow Centennial Professor - Engineering, Department of Civil Engineering, The University of Texas at Austin, Austin, TX

Design for Punching Shear 11:30

Sami H. Megally, Doctoral Candidate, and Amin Ghali, Professor, Department of Civil Engineering, University of Calgary, Calgary, Alberta, Canada

TECHNICAL SESSION

THURSDAY, NOVEMBER 7
9:00 AM - NOON

ROOM: REGENCY C

SULFUR POLYMER CONCRETE

Sponsored by Committee 548

Session Moderator: Alan H. Vroom
Chairman
Starcrete Technologies, Inc.
Calgary, Alberta, Canada

Examinations of Early Sulfur Concrete Installations 9:00
Howard A. Okumura, Process Engineer, Cominco, Ltd.,
Trail, British Columbia, Canada

Composition for Durability of a Chempruf-Modified Sulfur Concrete 9:25
Bo Göran Hellers, Associate Professor, and
Amon Raphael Makenya, Research Scientist, Building
Engineering Division, Royal Institute of Technology,
Stockholm, Sweden

Sulfur Concrete Application in Commercial Scale Projects - Field Considerations 9:50
David W. Whitmore, National Sales Manager, Vector
Construction, Ltd., Winnipeg, Manitoba, Canada, and
Sean M. Crick, Regional Manager, Vector Construction,
Ltd., Saskatoon, Saskatchewan, Canada

Comparison of Performance of Sulfur Concrete Applied by Different Methods 10:15
Peter J. Nevin, General Manager, Projects, Construction
Equipment Services, Kya Sand, Randburg, South Africa

Sulfur Concrete - An Ideal Material for Precast Products 10:40
Alan H. Vroom, Chairman, Starcrete Technologies, Inc.,
Calgary, Alberta, Canada

Chempruf Concrete: Research and Technology Developments, Construction Equipment Evolution, and Project Case Histories 11:00
James A. Reece, President, GRC, Inc. - Chempruf,
Clarksville, TN

Slide Showcase of Chilean Experience with Sulfur Concrete 11:25
C. Andreas Vorwerk, President, Vorwerk y Cia, S.A.,
Santiago, Chile

General Discussion 11:45

TECHNICAL SESSION

THURSDAY, NOVEMBER 7
9:00 AM - NOON

ROOM: REGENCY E

BLAST-RESISTANT DESIGN: PART I

Sponsored by Committee 370

Session Co-Moderators: *Abi Assadi*
Manager of Structural Engineering
AEC Engineering, Inc.
Minneapolis, MN

Theodor Krauthammer
Professor
Department of Civil and
Environmental Engineering
The Pennsylvania State University
University Park, PA

Stanley C. Woodson
Research Structural Engineer
U.S. Army Engineer Waterways
Experiment Station
Vicksburg, MS

Loads and Design Capabilities

9:00

Stanley C. Woodson, Research Structural Engineer, U.S. Army Engineer Waterways Experiment Station, Vicksburg, MS; *William H. Zehrt, Jr.*, Structural Engineer, U.S. Army Corps of Engineers, Huntsville Division, Huntsville, AL; and *Darrell D. Barker, Jr.*, Principal Engineer, Wilfred Baker Engineering, San Antonio, TX

Computational and Simulation Capabilities

9:45

David W. Hyde, Research Structural Engineer, Structures Laboratory, U.S. Army Engineer Waterways Experiment Station, Vicksburg, MS; *Theodor Krauthammer*, Professor, Department of Civil and Environmental Engineering, The Pennsylvania State University, University Park, PA

Structural Behavior

10:30

Abi Assadi, Manager of Structural Engineering, and *Hussain Shanaa*, Structural Engineer, AEC Engineering, Inc., Minneapolis, MN; and *Theodor Krauthammer*, Professor, Department of Civil and Environmental Engineering, The Pennsylvania State University, University Park, PA

Blast-Resistant Closures and Accessories

11:15

Timothy S. Blackburn, Manager, Design Group, Overly Manufacturing Co., Greensburg, PA, and *David R. Coltharp*, Research Physicist, Structures Laboratory, U.S. Army Engineer Waterways Experiment Station, Vicksburg, MS

TECHNICAL SESSION

THURSDAY, NOVEMBER 7
2:00 PM - 5:00 PM

ROOM: REGENCY E

BLAST-RESISTANT DESIGN: PART II

Sponsored by Committee 370

Session Co-Moderators: Abi Assadi
Manager of Structural Engineering
AEC Engineering, Inc.
Minneapolis, MN

Theodor Krauthammer
Professor
Department of Civil and
Environmental Engineering
The Pennsylvania State University
University Park, PA

Stanley C. Woodson
Research Structural Engineer
U.S. Army Engineer Waterways
Experiment Station
Vicksburg, MS

**Design Application 1 - Internal Blast,
Small Explosive Charge** **2:00**
Abi Assadi, Manager of Structural Engineering, and
Hussain Shanaa, Structural Engineer, AEC Engineering,
Inc., Minneapolis, MN

**Design Application 2 - Internal Blast,
Large Explosive Charge** **2:50**
William H. Zehrt, Jr., Structural Engineer, U.S. Army
Corps of Engineers, Huntsville Division, Huntsville, AL,
and Stanley C. Woodson Research Structural Engineer,
U.S. Army Engineer Waterways Experiment Station,
Vicksburg, MS

Design Application 3 - External Blast **3:40**
William L. Bounds, Principal Design Engineer, Structural
Engineering Department, Fluor Daniel, Inc., Sugar Land,
TX, and Darrell D. Barker, Jr., Principal Engineer, Wilfred
Baker Engineering, San Antonio, TX

General Discussion and Questions **4:30**
Sam A. Kiger, Professor and Chairman, Department
of Civil Engineering, West Virginia University,
Morgantown, WV, and Theodor Krauthammer, Professor,
Department of Civil and Environmental Engineering, The
Pennsylvania State University, University Park, PA

TECHNICAL SESSION

THURSDAY, NOVEMBER 7
2:00 PM - 5:00 PM

ROOM: REGENCY B

DESIGN OF TWO-WAY SLAB SYSTEMS USING THEOREMS OF PLASTICITY

Sponsored by Committee 421

Session Moderator: Thomas C. Schaeffer
Principal
Stan Lindsey and Associates
Nashville, TN

**Design of Two-Way Slab Systems Using Theorems
of Plasticity: History and Concept** 2:00

Sidney H. Simmonds, Professor Emeritus, Department of
Civil Engineering, University of Alberta, Edmonton, Alberta,
Canada

Yield-Line Theory 2:30

William L. Gamble, Professor, Department of Civil
Engineering, University of Illinois at Urbana - Champaign,
Urbana, IL

**The Strip Method for Flexural Design of
Two-Way Slabs** 3:00

Scott D. B. Alexander, Professor, Department of Civil
Engineering, University of Alberta, Edmonton, Alberta,
Canada

A Strip Method of Design for Punching Shear 3:30

Scott D. B. Alexander, Professor, Department of Civil
Engineering, University of Alberta, Edmonton, Alberta,
Canada

Detailing for Serviceability 4:00

David M. Rogowsky, Professor, Department of Civil
Engineering, University of Alberta, Edmonton, Alberta,
Canada

Design for Severe Dynamic Loads 4:30

Stanley C. Woodson, Research Structural Engineer, U. S.
Army Engineer Waterways Experiment Station, Vicksburg,
MS, and Theodor Krauthammer, Professor, Department of
Civil Engineering, The Pennsylvania State University,
University Park, PA

EDUCATIONAL SEMINAR

FRIDAY, NOVEMBER 8
8:00 AM - 5:00 PM

ROOM: ESPLANADE A

1995 CHANGES IN THE ACI-318 BUILDING CODE

The Rules Have Changed

For design and construction of reinforced concrete buildings, the rules are the ACI 318 Building Code. *And the rules have changed!* Learn about all the changes at an intensive one-day seminar. Whether you work with the code once a year or several times a day, this seminar is not to be missed!

Sponsored by the American Concrete Institute, the Portland Cement Association, and the ACI Louisiana Chapter.

Seminar Moderator: Mike A. Choudhry
Vice President
Rahman and Associates, Inc.
Metairie, LA

Registration Opens	8:00
Session I Starts	8:30
Lunch (included in your registration fee)	NOON
Session II Starts	1:00
Questions and Answers	4:30
Session Ends	5:00

Registration includes a free copy of ACI 318-95 and PCA Notes on 318, a \$150.00 value!

Speakers are:

Robert F. Mast, Chairman of the Board, BERGER/ABAM Engineers, Inc., Federal Way, WA. Mr. Mast is the immediate Past President of ACI and serves as a member of ACI 318.

S. K. Ghosh, Director of Engineering Services, Codes and Standards, Portland Cement Association, Skokie, IL. Dr. Ghosh also serves as a member of ACI 318.

Registration for this seminar is not included in the convention registration fee. There is an additional fee of \$279 for ACI members or \$324 for nonmembers.

•SEPARATE REGISTRATION FEE

PERSONAL LOG

1996 FALL CONVENTION

Delegate's Name _____

SUNDAY, NOVEMBER 3, 1996

8:30 AM - _____

10:00 AM _____

10:00 AM - _____

11:30 AM _____

11:30 AM - _____

NOON - **Student Program and Competition Tulane University**
5:00 PM

1:00 PM _____

2:00 PM - _____

3:30 PM _____

2:00 PM - **SESSIONS:**
5:00 PM Use of High-Performance Fiber Reinforced
Concrete for Infrastructural Repair &
Retrofit: Part I **Poydras A**

Aerated Concrete Performance in Disasters **Regency B**

Concrete Structures in the Gulf South **Regency C**

A New ACI Document: Education Bulletin
E4-95—Admixtures in Concrete **Poydras B**

3:30 PM - _____

5:00 PM _____

5:00 PM - _____

6:30 PM _____

6:30 PM - Opening Night Reception/Cash Bar **Regency D**

7:30 PM

MONDAY, NOVEMBER 4, 1996

8:30 AM - _____

10:00 AM _____

9:00 AM - **SESSIONS:**
NOON Research in Progress **Regency C**

Structural Concrete Under Severe Dynamic
Loads **Regency E**

Innovative Concrete Technology in
Residential Construction **Regency F**

Computers in Practice and Education **Regency G**

MONDAY, NOVEMBER 4, 1996

9:00 AM - **SESSIONS:**
NOON Use of High-Performance Fiber Reinforced
Concrete for Infrastructural Repair &
Retrofit: Part II **Regency H**

10:00 AM - _____

11:30 AM _____

11:30 AM - _____

1:00 PM _____

NOON - **Student Luncheon** **Regency B**
2:00 PM

2:00 PM - _____

3:30 PM _____

2:00 PM - **SESSIONS:**
5:00 PM Extreme Loads and Load Combinations **Regency C**

Strength Evaluation Following a Disaster **Regency E**

Research on Transportation Structures **Regency F**

Hot Topic: Seismic and Wind Mitigation
for Structures **Regency G**

3:30 PM - _____

5:00 PM _____

5:00 PM - _____

6:30 PM _____

TUESDAY, NOVEMBER 5, 1996

8:30 AM - _____

10:00 AM _____

9:00 AM - **SESSIONS:**
NOON Serviceability of Cable-Stayed Bridges **Regency C**

Repair with FRP Composites **Regency E**

Influence of Binder Makeup on Durability:
Part I **Regency F**

Contractors' Day, Part I: How Can
Contractors Use Testing to Improve Quality
of Construction? **Regency G**

10:00 AM - _____

11:30 AM _____

11:30 AM - _____

1:00 PM _____

TUESDAY, NOVEMBER 6, 1996

- NOON - **Contractors' Day Luncheon** **Regency B**
2:00 PM
- 2:00 PM - _____
3:30 PM _____
- 2:00 PM - **SESSIONS:**
5:00 PM **Developing Design Criteria for Essential Facilities** **Regency C**
- TAC Open Paper Session** **Regency E**
- Influence of Binder Makeup on Durability: Part II** **Regency F**
- Bridge Evaluation in Disaster Mitigation** **Regency H**
- Contractors' Day, Part II:**
Session 1 - Future of Design Build Contracts: Pros and Cons
Session 2 - Construction Education: What Can It Do For You? **Regency G**
- 3:30 PM - _____
5:00 PM _____
5:00 PM - _____
6:30 PM _____
- 7:00 PM - **Moonlight on the Mississippi Dinner Cruise**
10:00 PM
- 7:30 PM - **Forum 123: Are the ACI CL Limits Acceptable?** **Regency C**
10:00 PM

WEDNESDAY, NOVEMBER 6, 1996

- 8:30 AM - **RAP Session Breakfast** **Regency E**
9:30 AM
- 8:30 AM - _____
10:00 AM _____
- 10:00 AM - **General Session** **Regency D**
NOON
- NOON - **Standards Presentation** **Regency D**
1:00 PM
- 2:00 PM - _____
3:30 PM _____
- 2:00 PM - **SESSIONS:**
5:00 PM **Methods of Teaching the Design of Concrete Structures** **Cabildo C**
- Technology Transfer: Identification of Cutting Edge Technology** **Regency C**

WEDNESDAY, NOVEMBER 6, 1996

2:00 PM - **SESSIONS:**
5:00 PM Lessons Learned from the Past **Regency F**

Polymer Concrete Overlays on Industrial Floors **Regency G**

3:30 PM ACI 301-96 Standard Specification for
5:00 PM Structural Concrete: Not Just for Buildings
Anymore **Regency H**

5:00 PM - _____
6:30 PM _____
6:30 PM - _____
8:00 PM _____

- Concrete Mixer **Grand Ballroom**
New Orleans Hilton Riverside & Towers

THURSDAY, NOVEMBER 7, 1996

8:30 AM - _____

10:00 AM _____

9:00 AM - **SESSIONS:**
NOON Behavior and Design Issues in Earthquake
Response of Concrete Bridges **Regency A**

Design of Two-Way Slab Systems Using
Elastic Frame Analogies **Regency B**

Sulfur Polymer Concrete: A Truly Unique
Product **Regency C**

Blast-Resistant Design: Part I **Regency E**

10:00 AM - _____
11:30 AM _____
11:30 AM - _____
1:00 PM _____
2:00 PM - _____
3:30 PM _____

2:00 PM - **SESSIONS:**
5:00 PM Design of Two-Way Slab Systems Using
Theorems of Plasticity **Regency B**

Blast-Resistant Design: Part II **Regency E**

3:30 PM - _____
5:00 PM _____
5:00 PM - _____
6:30 PM _____



**ACI
FUTURE
CONVENTIONS**

1997 Spring Convention
April 6-11
Seattle Westin Hotel
Warwick Hotel
Seattle, Washington
Convention Theme:
Concrete and the Environment



1997 Fall Convention
November 9-14
Atlanta Hilton & Towers
Atlanta, Georgia
Convention Theme:
Durability

1998 Spring Convention
March 29-April 3
Hyatt Regency Houston
Houston, Texas
Convention Theme:
Structural Design

1998 Fall Convention
October 25-30
Westin Century Plaza
Los Angeles, California
Convention Theme:
Seismic Constructibility



1999 Spring Convention
March 14-18
Hyatt Regency Chicago
Chicago, Illinois
Convention Theme:
High-Performance Concrete



ACI International
P.O. Box 9094
Farmington Hills, MI 48333
Phone: 810-848-3700
FAX: 810-848-3701
Member Services
FAX: 810-848-3800



*Thank you for attending the
ACI 1996 Fall Convention.
See you in Seattle!*